

Sectional drawing, SP pump 6" (SP 85S - 300S)

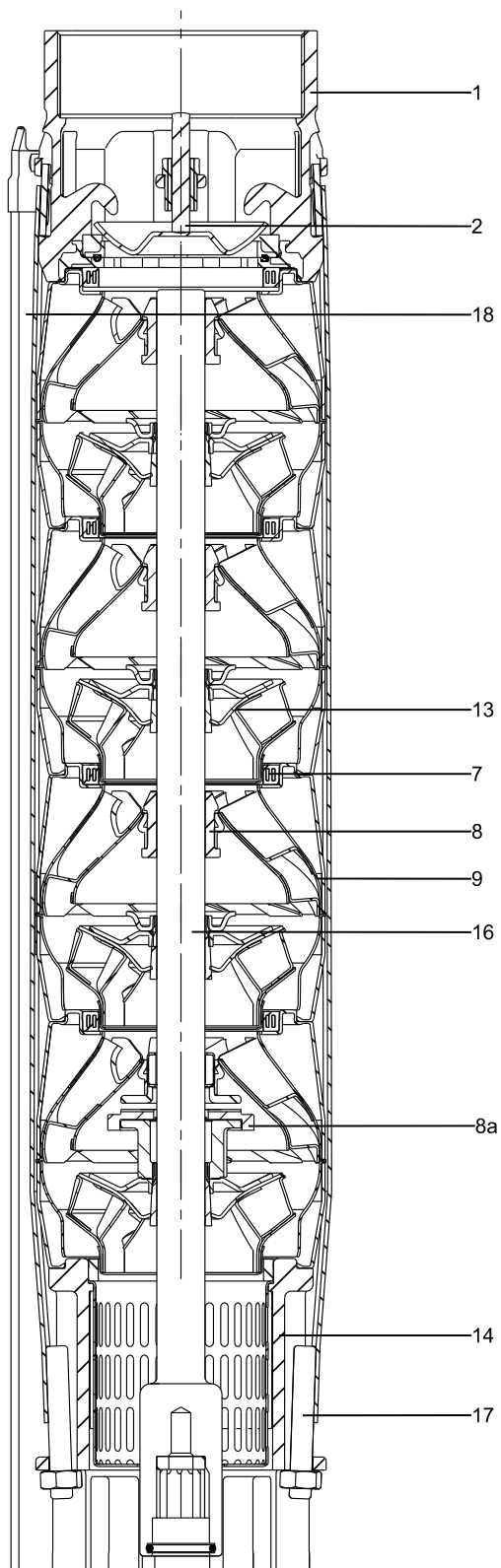

Material specification

Pos.	Component	Material	Standard	N-version	R-version
			[AISI (EN)]		
1	Valve casing	Stainless steel	304 (1.4301)	316 (1.4401)	904L (1.4539)
2	Valve cup	Stainless steel	304 (1.4301)	316 (1.4401)	904L (1.4539)
	Valve seat	NBR-FKM	NBR-FKM	NBR-FKM	NBR-FKM
7	Neck ring	NBR-FKM	NBR-FKM	NBR-FKM	NBR-FKM
8	Bearing	NBR-FKM-LSR	NBR-FKM-LSR	NBR-FKM-LSR	NBR-FKM-LSR
	Washer for stop ring	Carbon/graphite HY22 in PTFE mass			
9	Chamber	Stainless steel	304 (1.4301)	316 (1.4401)	904L (1.4539)
13	Impeller	Stainless steel	304 (1.4301)	316 (1.4401)	904L (1.4539)
14	Suction interconnector	Cast stainless steel	304 (1.4308)	316 (1.4408)	904L (1.4517)
	Strainer	Stainless steel	304 (1.4301)	316 (1.4401)	904L (1.4539)
16	Shaft complete	Stainless steel	431 (1.4057)	329 (1.4460)	904L (1.4462)
17	Strap	Stainless steel	304 (1.4301)	316 (1.4401)	904L (1.4539)
18	Cable guard	Stainless steel	304 (1.4301)	316 (1.4401)	904L (1.4539)

Fig. 15 Example, 6" (SP 85S - 300S)

TM06 1521 1614

6" and larger wells - continued

SP 150S (150 gpm) / 4 inch motor

Pump model	Nom. head [ft]	Ph	Volts [V]	Motor [Hp]	Dimensions					Net weight (complete) [lb]	
					A [in. (mm)]	B [in. (mm)]	C [in. (mm)]	D [in. (mm)]	E [in. (mm)]		
150S - Motor dia. 4 inch, 3 wire motor, 60 Hz, rated flow 150 gpm (3" NPT)											
150S20-1	33	1	230	2	●	33.67 (855)	19.57 (497)	14.10 (358)	3.75 (95)	5.28 (134)	49.5
		3	230	2	■	29.34 (745)	15.24 (387)	14.10 (358)	3.75 (95)	5.28 (134)	45.0
		3	460	2	■	29.34 (745)	15.24 (387)	14.10 (358)	3.75 (95)	5.28 (134)	45.0
150S50-2	71	1	230	5	●	44.53 (1131)	26.66 (677)	17.88 (454)	3.75 (95)	5.28 (134)	67.5
		3	230	5	●	40.56 (1030)	22.68 (576)	17.88 (454)	3.75 (95)	5.28 (134)	42.3
		3	460	5	●	40.56 (1030)	22.68 (576)	17.88 (454)	3.75 (95)	5.28 (134)	42.3
150S75-3	108	3	230	7.5	●	48.27 (1226)	26.62 (676)	21.66 (550)	3.75 (95)	5.28 (134)	51.3
		3	460	7.5	●	48.27 (1226)	26.62 (676)	21.66 (550)	3.75 (95)	5.28 (134)	82.8
150S75-4	146	3	230	7.5	●	52.05 (1322)	26.62 (676)	25.44 (646)	3.75 (95)	5.28 (134)	85.5
		3	460	7.5	●	52.05 (1322)	26.62 (676)	25.44 (646)	3.75 (95)	5.28 (134)	85.5
150S100-5	184	3	460	10	●	59.77 (1518)	30.56 (776)	29.22 (742)	3.75 (95)	5.28 (134)	135.9
150S - Motor dia. 6 inch, 60 Hz, rated flow 150 gpm (3" NPT)											
150S75-4	146	3	230	7.5	▲	49.69 (1262)	23.51 (597)	26.19 (665)	5.52 (140)	5.52 (140)	99.9
		3	460	7.5	▲	49.69 (1262)	23.51 (597)	26.19 (665)	5.52 (140)	5.52 (140)	99.9
		3	230	10	▲	54.65 (1388)	24.69 (627)	29.97 (761)	5.52 (140)	5.52 (140)	73.8
150S100-5	184	3	230	10	▲	54.65 (1388)	24.69 (627)	29.97 (761)	5.52 (140)	5.52 (140)	73.8
		3	460	10	▲	54.65 (1388)	24.69 (627)	29.97 (761)	5.52 (140)	5.52 (140)	73.8
150S150-6	222	3	230	15	▲	60.79 (1544)	27.05 (687)	33.75 (857)	5.52 (140)	5.52 (140)	119.7
		3	460	15	▲	60.79 (1544)	27.05 (687)	33.75 (857)	5.52 (140)	5.52 (140)	119.7
		3	230	15	▲	64.57 (1640)	27.05 (687)	37.52 (953)	5.52 (140)	5.52 (140)	127.8
150S150-7	260	3	460	15	▲	64.57 (1640)	27.05 (687)	37.52 (953)	5.52 (140)	5.52 (140)	127.8
		3	230	15	▲	68.35 (1736)	27.05 (687)	41.30 (1049)	5.52 (140)	5.52 (140)	137.7
150S150-8	297	3	460	15	▲	68.35 (1736)	27.05 (687)	41.30 (1049)	5.52 (140)	5.52 (140)	137.7
		3	230	20	▲	74.69 (1897)	29.61 (752)	45.08 (1145)	5.52 (140)	5.52 (140)	141.3
150S200-9	335	3	460	20	▲	74.69 (1897)	29.61 (752)	45.08 (1145)	5.52 (140)	5.52 (140)	141.3
		3	230	20	▲	78.47 (1993)	29.61 (752)	48.86 (1241)	5.52 (140)	5.52 (140)	151.2
150S200-10	373	3	460	20	▲	78.47 (1993)	29.61 (752)	48.86 (1241)	5.52 (140)	5.52 (140)	151.2
		3	230	20	▲	82.25 (2089)	29.61 (752)	52.64 (1337)	5.52 (140)	5.52 (140)	166.5
150S200-11	411	3	460	20	▲	82.25 (2089)	29.61 (752)	52.64 (1337)	5.52 (140)	5.52 (140)	166.5
		3	230	25	▲	88.19 (2240)	31.78 (807)	56.42 (1433)	5.52 (140)	5.52 (140)	188.1
150S250-12	448	3	460	25	▲	88.19 (2240)	31.78 (807)	56.42 (1433)	5.52 (140)	5.52 (140)	188.1
		3	230	25	▲	91.97 (2336)	31.78 (807)	60.20 (1529)	5.52 (140)	5.52 (140)	201.6
150S250-13	486	3	460	25	▲	91.97 (2336)	31.78 (807)	60.20 (1529)	5.52 (140)	5.52 (140)	201.6
		3	230	25	▲	95.75 (2432)	31.78 (807)	63.98 (1625)	5.52 (140)	5.52 (140)	206.1
150S250-14	524	3	460	25	▲	95.75 (2432)	31.78 (807)	63.98 (1625)	5.52 (140)	5.52 (140)	206.1

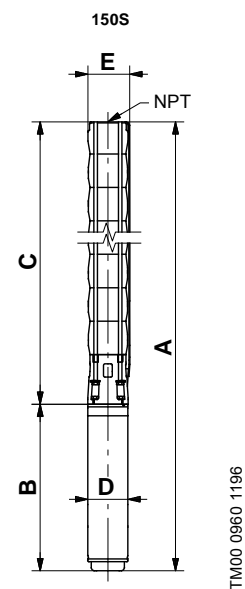

E = Maximum diameter of pump including cable guard and motor.

TM00 0960 1196

Notes:

Control box is required for 3-wire, single-phase applications. Data does not include control box. Performance conforms to ISO 9906: 1999 (E) Annex A. Minimum submergence is 2 feet.

- MS 402 motor.
- MS 4000 motor.
- ▲ MS 6000C motor.

6" and larger wells - continued

SP 150S (150 gpm) / 6, 8 inch motor

Pump model	Nom. head [ft]	Ph	Volts [V]	Motor [Hp]	Dimensions					Net weight (complete) [lb]
					A [in. (mm)]	B [in. (mm)]	C [in. (mm)]	D [in. (mm)]	E [in. (mm)]	
150S - Motor dia. 6 inch, 60 Hz, rated flow 150 gpm (3" NPT)										
150S300-15	562	3	230	30	▲ 101.89 (2588)	34.14 (867)	67.76 (1721)	5.52 (140)	5.52 (140)	209.7
		3	460	30	▲ 101.89 (2588)	34.14 (867)	67.76 (1721)	5.52 (140)	5.52 (140)	209.7
150S300-16	600	3	230	30	▲ 105.67 (2684)	34.14 (867)	71.54 (1817)	5.52 (140)	5.52 (140)	211.5
		3	460	30	▲ 105.67 (2684)	34.14 (867)	71.54 (1817)	5.52 (140)	5.52 (140)	211.5
150S300-17	637	3	230	30	▲ 109.45 (2780)	34.14 (867)	75.32 (1913)	5.52 (140)	5.52 (140)	216.0
		3	460	30	▲ 109.45 (2780)	34.14 (867)	75.32 (1913)	5.52 (140)	5.52 (140)	246.6
150S400-18	675	3	460	40	▲ 118.35 (3006)	39.26 (997)	79.10 (2009)	5.52 (140)	5.52 (140)	246.6
150S400-19	713	3	460	40	▲ 122.13 (3102)	39.26 (997)	82.88 (2105)	5.52 (140)	5.52 (140)	248.4
150S400-20	751	3	460	40	▲ 125.91 (3198)	39.26 (997)	86.66 (2201)	5.52 (140)	5.52 (140)	291.0
150S400-21	789	3	460	40	▲ 129.69 (3294)	39.26 (997)	90.44 (2297)	5.52 (140)	5.52 (140)	271.8
150S400-22	826	3	460	40	▲ 133.47 (3390)	39.26 (997)	94.22 (2393)	5.52 (140)	5.52 (140)	305.9
150S400-23	864	3	460	40	▲ 137.25 (3486)	39.26 (997)	98.00 (2489)	5.52 (140)	5.52 (140)	277.2
150S500-24	902	3	460	50	☼ 157.88 (4010)	56.11 (1425)	101.78 (2585)	5.67 (144)	5.67 (144)	411.8
150S500-25	940	3	460	50	☼ 161.66 (4106)	56.11 (1425)	105.56 (2681)	5.67 (144)	5.67 (144)	419.0
150S500-26	977	3	460	50	☼ 165.44 (4202)	56.11 (1425)	109.34 (2777)	5.67 (144)	5.67 (144)	426.2
150S500-27	1015	3	460	50	☼ 169.22 (4298)	56.11 (1425)	113.12 (2873)	5.67 (144)	5.67 (144)	433.4
150S500-28	1053	3	460	50	☼ 173.00 (4394)	56.11 (1425)	116.89 (2969)	5.67 (144)	5.67 (144)	440.6
150S600-29DS	1091	3	460	60	-	-	134.53 (3417)	-	6.89 (175)	-
150S600-31DS	1166	3	460	60	-	-	142.09 (3609)	-	6.89 (175)	-
150S600-33DS	1242	3	460	60	-	-	149.65 (3801)	-	6.89 (175)	-
150S - Motor dia. 8 inch, 60 Hz, rated flow 150 gpm (3" NPT)										
150S500-24	902	3	460	50	* 162.45 (4126)	45.67 (1160)	116.78 (2966)	7.56 (192)	7.56 (192)	484.5
150S500-25	940	3	460	50	* 166.23 (4222)	45.67 (1160)	120.56 (3062)	7.56 (192)	7.56 (192)	491.7
150S500-26	977	3	460	50	* 170.00 (4318)	45.67 (1160)	124.34 (3158)	7.56 (192)	7.56 (192)	498.9
150S500-27	1015	3	460	50	* 173.78 (4414)	45.67 (1160)	128.12 (3254)	7.56 (192)	7.56 (192)	506.1
150S500-28	1053	3	460	50	* 177.56 (4510)	45.67 (1160)	131.89 (3350)	7.56 (192)	7.56 (192)	513.3
150S600-29DS	1091	3	460	60	* 182.33 (4631)	50.00 (1270)	132.33 (3361)	7.56 (192)	7.56 (192)	612.7
150S600-31DS	1166	3	460	60	* 189.89 (4823)	50.00 (1270)	139.89 (3553)	7.56 (192)	7.56 (192)	623.7
150S600-33DS	1242	3	460	60	* 197.45 (5015)	50.00 (1270)	147.45 (3745)	7.56 (192)	7.56 (192)	639.1
150S750-36DS	1355	3	460	75	* 211.93 (5383)	53.15 (1350)	158.78 (4033)	7.56 (192)	7.56 (192)	689.2
150S750-39DS	1469	3	460	75	* 223.27 (5671)	53.15 (1350)	170.12 (4321)	7.56 (192)	7.56 (192)	704.6

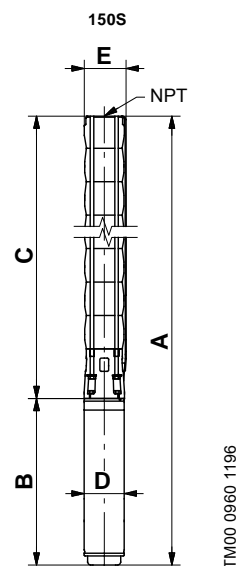

E = Maximum diameter of pump including cable guard and motor.

TM00 0960 1196

Notes:

Control box is required for 3-wire, single-phase applications. Data does not include control box.

DS designation = Built into sleeve, 1 - 1/2" NPT, 6" minimum well diameter.

Performance conforms to ISO 9906. 1999 (E) Annex A. Minimum submergence is 2 feet.

- ▲ MS 6000C motor.
- ☼ Takes MMS 6 motor; not available as complete.
- * Takes MMS 8000 motor; not available as complete.