

Specifications:

Poly Basin:

18" (457mm) Diameter x 30" (762mm) Depth polyethylene basin, impact resistant, rotationally molded, corrosion resistant. Comes with hole in basin to accommodate a 4" (102mm) Flexible Pipe Fitting 10.50" (267mm) from top of basin. Basin capacity is 30 gallons (114 liters), weight is 10.5 lbs (5kg) and a wall thickness of 3/16" (5mm).

P/N: 076119

BAF Mounting Studs For Basin:

The studs are mounted in the bottom of the basin to mount Break Away Fittings. The studs are stainless steel and welded in a 1/4" (6mm) steel plate which another laminate of fiberglass is molded to the bottom to complete the basin construction. Studs are for Simplex or Duplex Installations. **MUST** Specify part number of BAF, and if it is Simplex or Duplex when ordering.

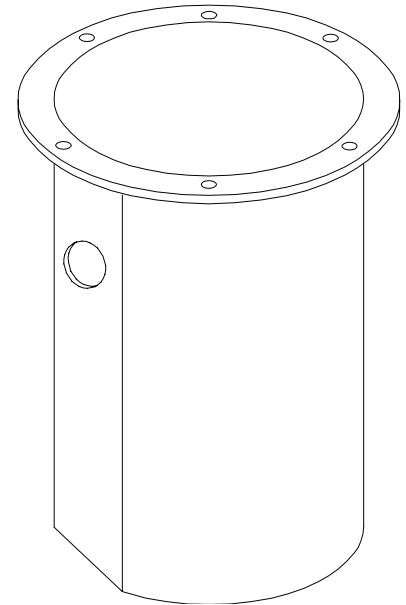

Poly Basin

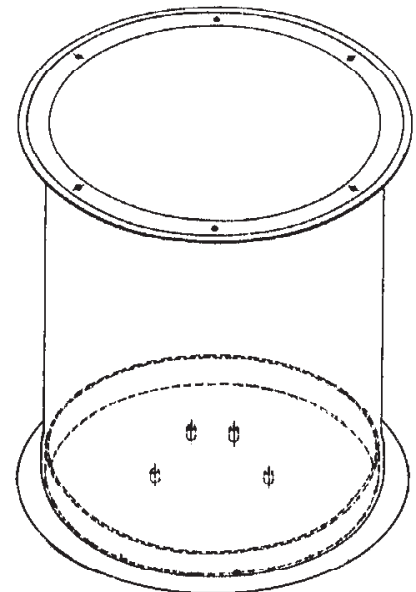

Mounting Studs

Basins & Accessories

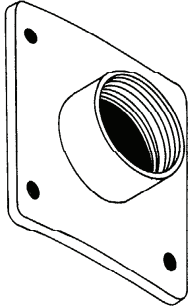

Electrical Conduit

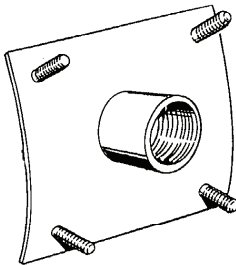

Discharge Coupling

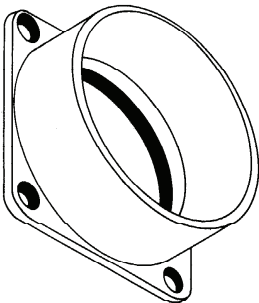

Inlet Hub

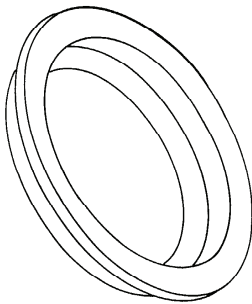

Flexible Pipe Fitting

Specifications:

Electrical Conduit Hub:

Bolt-On Hub. Constructed of glass filled nylon. Includes; gasket. stainless steel cap screws, sealing washers and hex nuts.

P/N:	Description:
078470	1-1/4" NPT Hub
078471	1-1/2" NPT Hub
078471D	2" NPT Hub

Discharge Coupling:

Stainless Steel Bolt-On Couplings Stainless

P/N:	Description
094790	1-1/4" NPT, Female
094801	1-1/2" NPT, Female
094802	2" NPT, Female
094964	2-1/2" NPT, Female
094965	3" NPT, Female

Cast Iron Inlet Hubs:

Cast iron inlet hubs are recommended for cast iron, ceramic, plastic or ductile iron gravity sewer pipe, designed to fit curvature of basin. Shipped loose for field installation. Includes gasket and four fasteners for mounting to basin.

P/N:	Description
063847	4" (102mm) Caulking Type
063848	6" (152mm) Caulking Type
063850	8" (203mm) Caulking Type

Flexible Pipe Fittings:

The Flexible Pipe fitting is super-tuff for weather and corrosion resistance. The fitting has superior vapor and water leakproof sealing ability. Shipped loose for field installation.

P/N:	Description
076149	4" (102mm) PVC, Sch. 40-80
075898	4" (102mm) PVC, SDR-35
076941*	6" (152mm) PVC, Sch. 40-80

(*) 6" Sch 40 inlet can only be used on 36" diameter and larger basins

Specifications:

Bug-Free Vent, 2" NPT:

The Bug-Free vent has a rustproof vinyl coating that resists gases, acids, alkalis, sun and weather. The vent is constructed of heavy 14 gauge top hat with a galvanized coupling and bronze screen. The screen area is 5.00 sq. in. (3226 sq. mm).

P/N: 075831

Flexible Discharge Couplings:

The Flexible Discharge Couplings are designed to dampen or suppress noise, absorb vibration (horizontal, vertical, angular), accommodate thermal expansion and stresses, and adjust or correct for misalignment in piping systems. The Flexible Couplings have the unique properties of metals; high strength and high resistance to temperature and corrosion. Each Coupling is equipped with an outer braid to prevent elongation under internal pressure. The braid is a tubular sheath of metal wires woven in a basket weave fashion. It is made to fit snugly over the hose, and is fastened to the ends of the hose. It is designed to be strong enough to withstand elongation for the full pressure rating of the hose.

- Inner Corrugated Hose:** 300 Series Stainless Steel
- Outer Braid:** 300 Series Stainless Steel
- Maximum Permanent Offset From Center Line:** 1/2" (13mm)
- Maximum Intermittent Offset From Center Line:** 1/4" (6.3mm)

PART NO.	PIPE NPT	"A" DIM ± .12" (3)	MAX. WORKING PRESS. @ 70°F (21°C)
100159	1.25	10 (254mm)	250 PSI (17.5 kg/cm ²)
100571	1.50	12 (305mm)	250 PSI (17.5 kg/cm ²)
100160	2.00	14 (356mm)	250 PSI (17.5 kg/cm ²)
100572	2.50	16 (406mm)	250 PSI (17.5 kg/cm ²)
126935	1.25" M x 1.50" F	12 (305mm)	250 PSI (17.5 kg/cm ²)

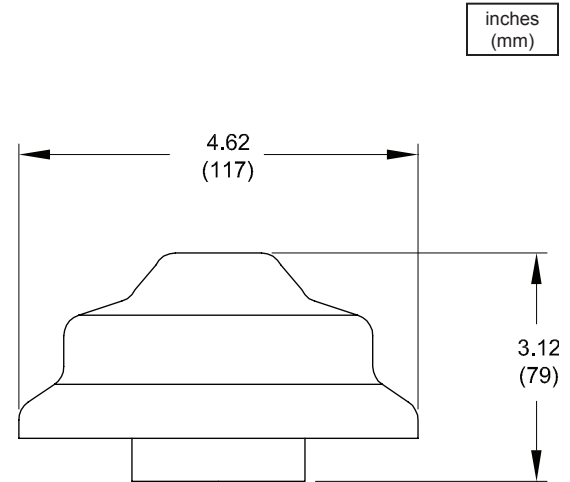

Bug-free Vent 2" NPT

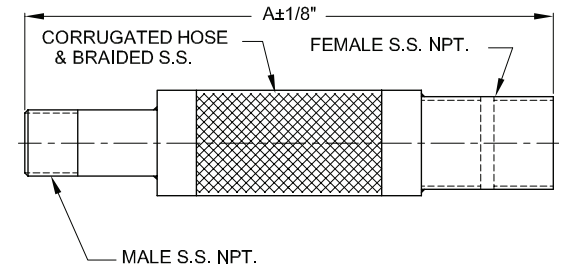

Flexible Discharge Couplings