

BERKELEY® 6T-155

Submersible Turbine

Nominal RPM: 3450
Based on Fresh Water @ 68 F.
Maximum Working Pressure: 606 PSI

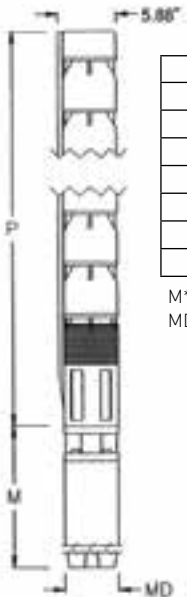
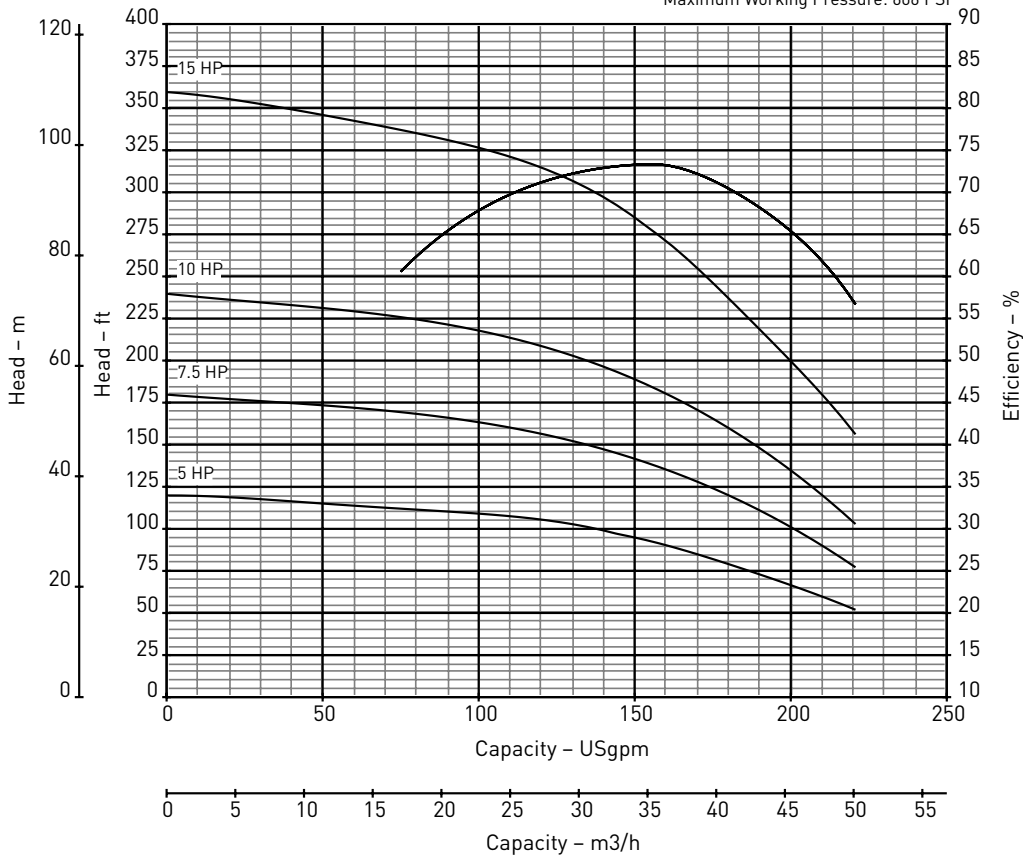

Outline Dimensions / Weights

HP	Stages	Motor Size	P Length	M* Length	MD* Diameter	Motor Weight	Pump Weight
5	2	4"	23.25	27.00	3.75	95	73
5	2	6"	23.25	27.00	5.51	95	73
7.5	3	4"	27.88	27.60	3.75	114	91
7.5	3	6"	27.88	27.60	5.51	114	91
10	4	6"	32.50	29.80	5.51	127	109
15	6	6"	41.75	30.40	5.51	130	145

Note: Dimensions=Inches; Weight=U.S. Lbs.

M*-Maximum Length (Pentair Motor)
MD*-Motor Diameter (Pentair Motor)

Specifications

Minimum Well I.D.	6.0 Inches
Minimum Submergence @ BEP (above inlet)	10.0 Feet
Capacity Range	48 - 210 GPM
Discharge	3" F NPT

See manufacturer's data for motor cooling requirements

BERKELEY® 6T-155

Submersible Turbine

Nominal RPM: 3450
Based on Fresh Water @ 68 F.
Maximum Working Pressure: 606 PSI

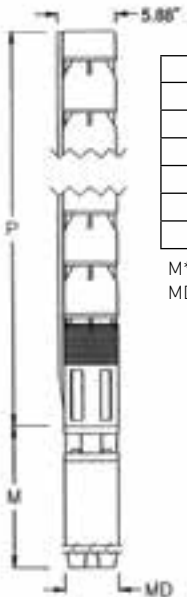
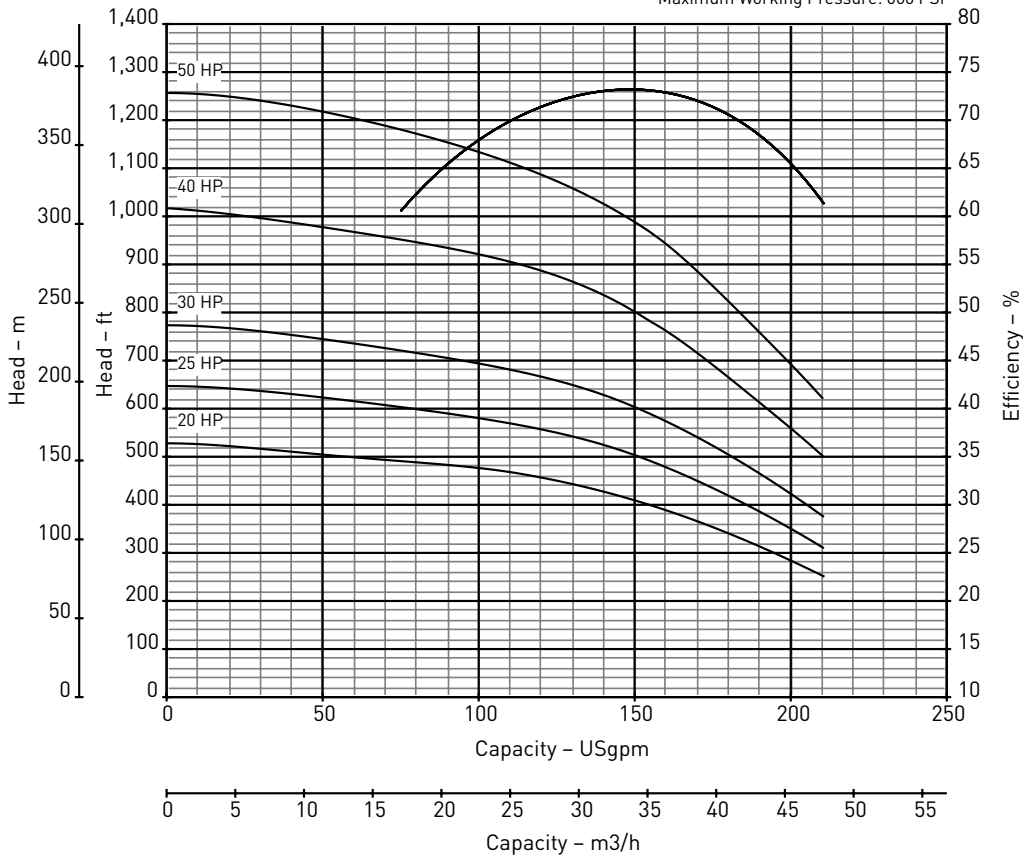

Outline Dimensions / Weights

HP	Stages	Motor Size	P Length	M* Length	MD* Diameter	Motor Weight	Pump Weight
20	9	6"	55.63	35.50	5.51	160	199
25	11	6"	64.88	47.20	5.51	224	235
30	13	6"	74.13	49.50	5.51	236	270
40	17	6"	92.63	50.30	5.51	239	342
50	21	6"	111.13	52.20	5.51	251	414

Note: Dimensions=Inches; Weight=U.S. Lbs.

M*-Maximum Length (Pentair Motor)
MD*-Motor Diameter (Pentair Motor)

Specifications

Minimum Well I.D.	6.0 Inches
Minimum Submergence @ BEP (above inlet)	10.0 Feet
Capacity Range	48 - 210 GPM
Discharge	3" F NPT

See manufacturer's data for motor cooling requirements

BERKELEY® 6T-155

Submersible Turbine - Single Stage Performance

Nominal RPM: 3450
Based on Fresh Water @ 68 F.
Maximum Working Pressure: 606 PSI

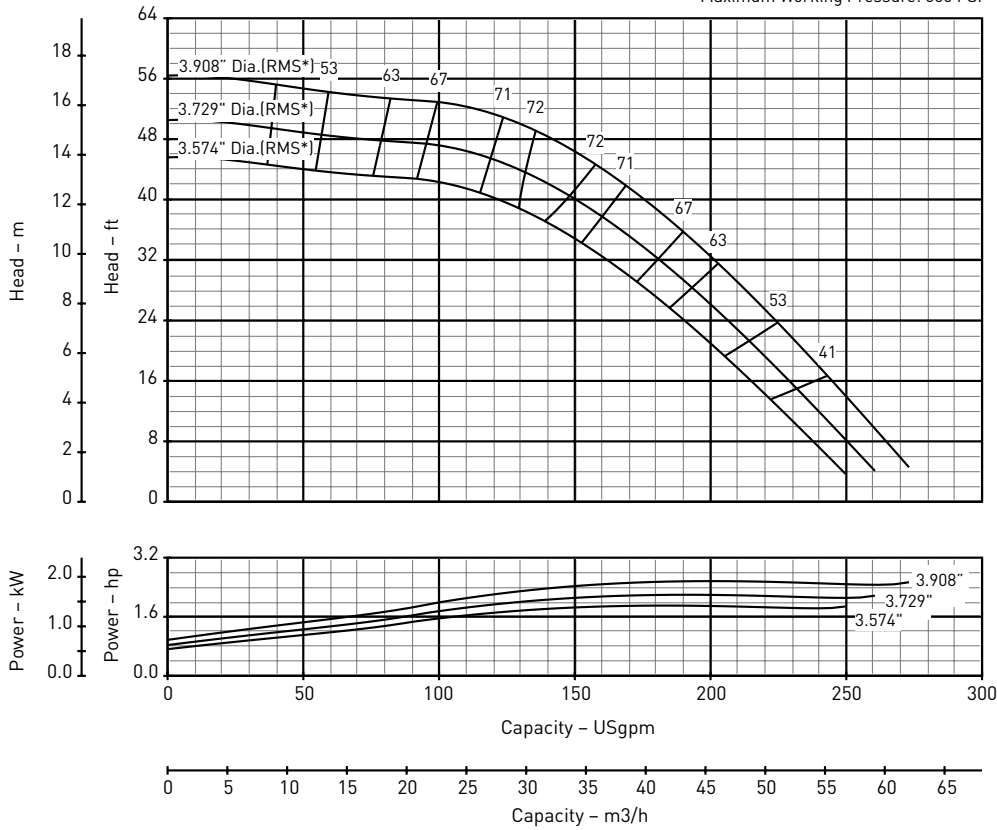

Impeller Dimensions

RMS* Diameter	A Diameter	B Diameter	C Angle
3.908	4.070	3.740	21
3.729	3.890	3.560	21
3.574	3.740	3.400	21

*Root-Mean-Square

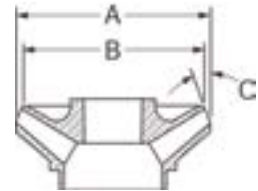

Materials of Construction

Part Name	Common Material Name	Material Spec Number
Discharge Adapter	Cast Iron	ASTM A48 Class 30
Top Bowl	Cast Iron	ASTM A48 Class 30
Intermediate Bowl	Cast Iron	ASTM A48 Class 30
Bearings, Top and Suction Case	Rubber	Neoprene
Impeller	Stainless Steel	ASTM A743 UNS C30400
Pump Shaft	Stainless Steel	ASTM AISI 416
Impeller Collets	Steel	AISI 1226
Suction Bracket	Cast Iron	ASTM A48 Class 30
Bowl Bearing	Rubber	Neoprene
Strainer	Stainless Steel	AISI 302 UNS S30200
Cable Guard	Stainless Steel	AISI 302 UNS S30200
Shaft Coupling	Stainless Steel	AISI 416 UNS S41600

Note: Efficiency based on average staging

