

PARTS LIST

---

**SERIES 4360**

VERTICAL  
MOTOR MOUNTED PUMP

"B" SIZE



## SERIES 4360 - POWER FRAMES - ALL SPEEDS

MOTOR SPEED	1800 RPM	MOTOR HORSEPOWER																	
		1/4	1/3	1/2	3/4	1					1	1 1/2	2	3					
								1 1/2	2	3	5					3	5	7 1/2	10
PUMP SIZE	FRAME SIZE	56C	56C	56C	56C	56C	56C	56C	56C	56C	143JM	145JM	145JM	182JM	145JM	182JM	184JM	213JM	215JM
1 1/4 B	-	B	B	B			B	B	B										
1 1/2 B	-	B	B	B	B		B	B	B	B									
2 B	-		B	B	B	B		B	B	B									
1 1/2 D	-			D	D						D	D			D	D	D	D	
2 D	-		D	D	D						D	D	D		D	D	D	D	D
3 D	-				D						D	D	D	D		D	D	D	D

"B" DESIGNATION - 3/8" IMPELLER BORE, 1/2" MECHANICAL SEAL

"D" DESIGNATION - 7/8" IMPELLER BORE, 1 1/4" MECHANICAL SEAL

# TYPICAL SECTION VIEW MODEL 4360 "B" SIZE

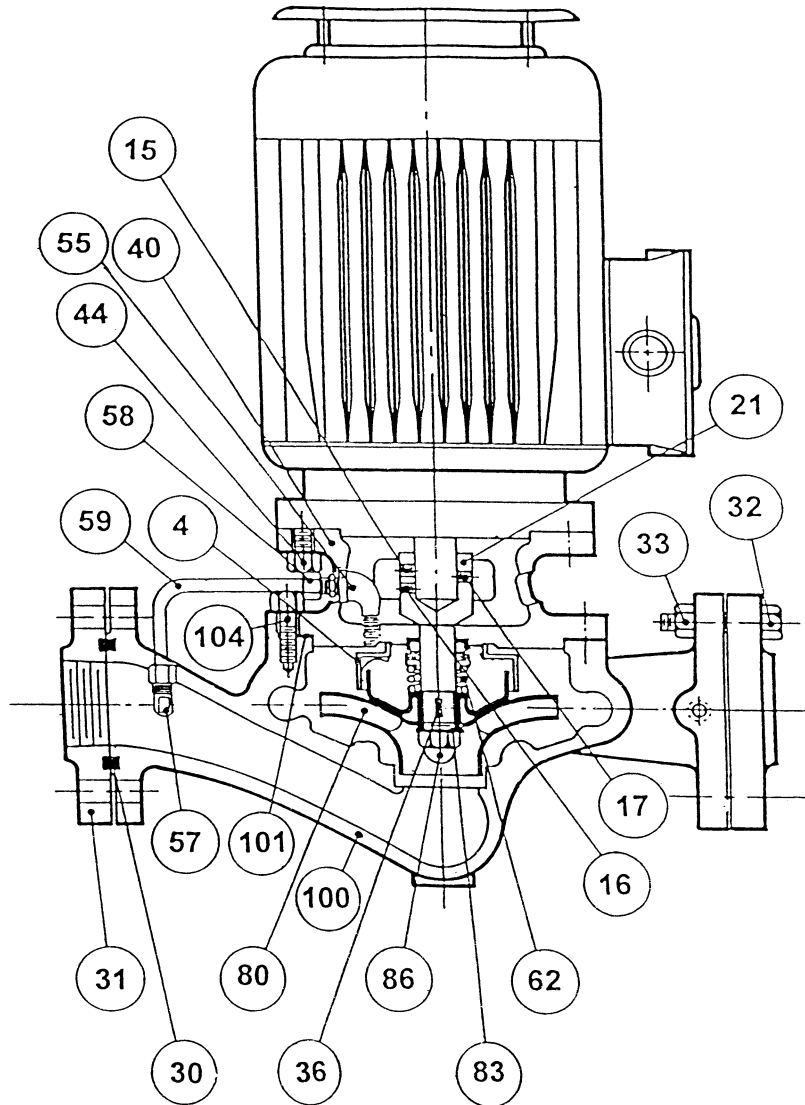

ITEM NO.	DESCRIPTION	PAGE NO.	ITEM NO.	DESCRIPTION	PAGE NO.	ITEM NO.	DESCRIPTION	PAGE NO.
4	BALANCE RING	5	33	FLANGE CAPS. NUT	9	62	MECH. SEAL ASSY.	4
15	SET SCREW	6	36	IMPELLER KEY	6	80	IMPELLER	3
16	SET SCREW	6	40	STUFF. BOX/ADAPTER	4	83	IMP. LOCKWASHER	5
17	SET SCREW	6	44	MOTOR CAPSCREW	6	86	IMPELLER NUT	5
21	SHAFT EXTENSION	6	55	STREET ELBOW	7	100	CASING	4
30	FLANGE GASKET	8	57	MALE ELBOW	7	101	CASING GASKET	6
31	FLANGE	8	58	CONNECTOR	7	104	CASING CAPSCREW	6
32	FLANGE CAPSCREW	9	59	FLUSHLINE TUBING	7			

# MODEL 4360

## VERTICAL MOTOR MOUNTED

### "B" SIZE, 1/2" MECHANICAL SEAL

<b>ITEM 100 CASING</b>			
<b>PUMP SIZE</b>	<b>MATERIAL</b>	<b>PART NUMBER</b>	<b>BAR CODE</b>
1 1/4 B	CAST IRON	116337-011	
1 1/4 B	BRONZE	116337-041	
1 1/2B	CAST IRON	116337-011	
1 1/2B	BRONZE	116337-041	
2B	CAST IRON	116338-011	
2B	BRONZE	116338-041	

<b>ITEM 80 IMPELLER**</b>			
<b>PUMP SIZE</b>	<b>MATERIAL</b>	<b>PART NUMBER</b>	<b>BAR CODE</b>
1 1/4 B	STEEL	816302-017	
1 1/4 B	BRONZE	816302-047	
1 1/2B	STEEL	816303-017	
1 1/2B	BRONZE	816303-047	
2 B	STEEL	816304-017	
2 B	BRONZE	816304-047	

\*\* Impeller Part Numbers are for full or maximum diameter Impellers. Always specify Pump Serial Number and where possible, measure and advise the diameter of the Impeller being replaced on these Pumps.

# MODEL 4360

VERTICAL MOTOR MOUNTED

"B" SIZE, 1/2" MECHANICAL SEAL

<b>ITEM 40 STUFFING BOX/ADAPTER</b>			
<b>PUMP SIZE</b>	<b>CONST.</b>	<b>PART NUMBER</b>	<b>NOTES</b>
1 1/4B TO 2B	B. F.	428320-011	
1 1/4B TO 2B	A. I.	428320-071	
1 1/4B TO 2B	A. B.	428320-041	

<b>ITEM 62 MECHANICAL SEAL ASSEMBLY</b>			
<b>PUMP SIZE</b>	<b>CONST.</b>	<b>PART NUMBER</b>	<b>NOTES</b>
1 1/4B TO 2B	ALL	816706-021	1/2" BUNA STANDARD SEAL
1 1/4B TO 2B	ALL	816706-023	1/2" VITON SEAL

# MODEL 4360

VERTICAL MOTOR MOUNTED

"B" SIZE, 1/2" MECHANICAL SEAL

## ITEM 83 IMPELLER LOCKWASHER

PUMP SIZE	CONST.	PART NUMBER	BAR CODE
1 1/4B TO 2B	B. F.	927411-700	
1 1/4B TO 2B	A. I.	927411-100	
1 1/4B TO 2B	A. B.	927411-700	

## ITEM 86 IMPELLER NUT

PUMP SIZE	CONST.	PART NUMBER	BAR CODE
1 1/4B TO 2B	B. F.	106076-000	
1 1/4B TO 2B	A. I.	913171-100	
1 1/4B TO 2B	A. B.	106076-000	

## ITEM 4 BALANCE RING

PUMP SIZE	CONST.	PART NUMBER	BAR CODE
1 1/4B TO 2B	B. F.	106091-012	
1 1/4B TO 2B	A. I.	106091-000	
1 1/4B TO 2B	A. B.	NOT REQUIRED	

# MODEL 4360

## VERTICAL MOTOR MOUNTED

### "B" SIZE, 1/2" MECHANICAL SEAL

<b>COMMON PARTS</b>			
<b>ITEM NO.</b>	<b>DESCRIPTION</b>	<b>PART NUMBER</b>	<b>BAR CODE</b>
15*	SET SCREW (1 REQ'D)	916517-005	
16*	SET SCREW (1 REQ'D)	916519-104	
17*	SET SCREW (2 REQ'D)	916517-205	
21	SHAFT EXTENSION	814910-001	
36	IMPELLER KEY	974507-100	
44	MOTOR CAPSCREW ( 4 REQ'D 3/8-16X3/4" LG. )	911121-106	
101	CASING GASKET	106158-000	
104	CASING CAPSCREW ( 8 REQ'D 5/16-18X3/4" LG. )	911119-106	

\* NOTES: Set Screws, Items #15,16 & 17 are included in Shaft Extension Item # 21



# MODEL 4360

VERTICAL MOTOR MOUNTED

"B" SIZE, 1/2" MECHANICAL SEAL

## ITEM 55 STREET ELBOW (FLUSHLINE)

PUMP SIZE	CONST.	PART NUMBER	BAR CODE
1 1/4B TO 2B	B. F. - A.I.	931110-000	
1 1/4B TO 2B	A. B.	939024-102	

## ITEM 57 MALE ELBOW (FLUSHLINE)

PUMP SIZE	CONST.	PART NUMBER	BAR CODE
1 1/4B TO 2B	A.B. - B.F.	939003-105	
1 1/4B TO 2B	A. I.	939003-205	

## ITEM 58 CONNECTOR (FLUSHLINE)

PUMP SIZE	CONST.	PART NUMBER	BAR CODE
1 1/4B TO 2B	A.B. - B.F.	939001-105	
1 1/4B TO 2B	A. I.	939001-205	

## ITEM 59 FLUSHLINE TUBING

PUMP SIZE	CONST.	LENGTH	PART NUMBER	BAR CODE
1 1/4B TO 2B	B. F. - A.I.	12"	997529-003	
1 1/4B TO 2B	A. B.	12"	997529-004	

# MODEL 4360

## VERTICAL MOTOR MOUNTED

### "B" SIZE, 1/2" MECHANICAL SEAL

<b>ITEM 30 FLANGE GASKET</b>					
<b>PUMP MODEL</b>	<b>CONST.</b>	<b>PIPE SIZE</b>	<b>NO. REQ'D</b>	<b>PART NUMBER</b>	<b>BAR CODE</b>
1 1/4B	ALL	1 1/4" NPT	2	105176-001	
1 1/2B	ALL	1 1/2" NPT	2	105176-001	
2B	ALL	2" NPT	2	116117-000	

<b>ITEM 31 FLANGE</b>				
<b>PUMP MODEL</b>	<b>CONST.</b>	<b>PIPE SIZE</b>	<b>PART NUMBER</b>	<b>BAR CODE</b>
1 1/4B	B.F - A.I.	1 1/4" NPT	116011-011	
1 1/4B	A.B.	1 1/4" NPT	116011-041	
1 1/2B	B.F - A.I.	1 1/2" NPT	116009-011	
1 1/2B	A.B.	1 1/2" NPT	116009-041	
2B	B.F - A.I.	2" NPT	106074-011	
2B	A.B.	2" NPT	106074-041	

# MODEL 4360

VERTICAL MOTOR MOUNTED

"B" SIZE, 1/2" MECHANICAL SEAL

## ITEM 32 FLANGE CAPSCREW

PUMP MODEL	NO. REQ'D	SIZE	PART NUMBER	BAR CODE
1 1/4B	2	7/16-14 X1 3/4" STL.	911123-114	
1 1/2B	2	7/16-14 X1 3/4" STL.	911123-114	
2B	2	1/2-13 X 2 1/4" STL.	911125-118	

## ITEM 33 FLANGE CAPSCREW NUT

PUMP MODEL	NO. REQ'D	SIZE	PART NUMBER	BAR CODE
1 1/4B	2	7/16-14 HEX STL.	913123-100	
1 1/2B	2	7/16-14 HEX STL.	913123-100	
2B	2	1/2-13 HEX STL.	913125-100	

**PARTS LIST**

---

**SERIES 4360**

"VERTICAL"  
OR  
MOTOR MOUNTED PUMP

CENTERLINE DISCHARGE  
"D" DESIGNATION

1-1/4" IMPELLER BORE -- 1-5/8" MECHANICAL SEAL

**NEW DESIGN**



## 4360 POWER FRAMES: ALL SPEEDS

SPEED	MOTOR HORSEPOWER																	
1800 RPM	1/4	1/3	1/2	3/4	1					1	1 1/2	2	3					
3600 RPM						1 1/2	2	3	5					3	5	7 1/2	10	15
FRAME	56C	56C	56C	56C	56C	56C	56C	56C	56C	143JM	145JM	145JM	182JM	145JM	182JM	184JM	213JM	215JM
PUMP SIZE																		
1 1/4 B	B	B	B			B	B	B										
1 1/2 B	B	B	B	B		B	B	B	B									
2 B		B	B	B	B		B	B	B									
1 1/2 D			D	D						D	D			D	D	D	D	
2 D		D	D	D						D	D	D		D	D	D	D	D
3 D				D						D	D	D	D		D	D	D	D

"B" DESIGNATION - 3/8" IMPELLER BORE, 1/2" MECHANICAL SEAL

"D" DESIGNATION - 7/8" IMPELLER BORE, 1 1/4" MECHANICAL SEAL

# TYPICAL EXPLODED VIEW MODEL 4360 "D" SIZE

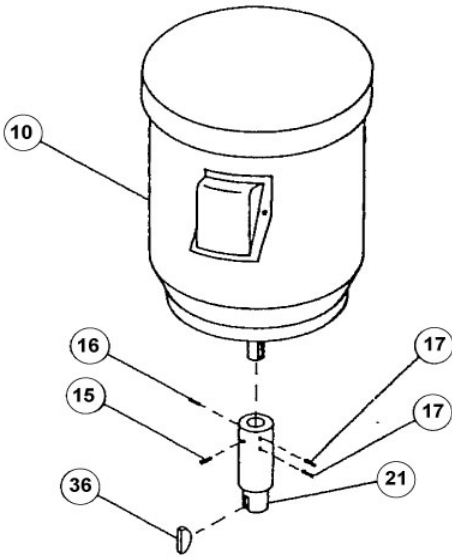

Frame 56 C Shaft Arrangement

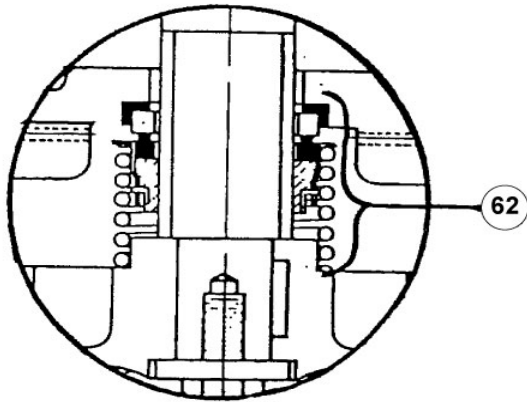

Seal arrangement for pumps built prior to Serial Number 99808

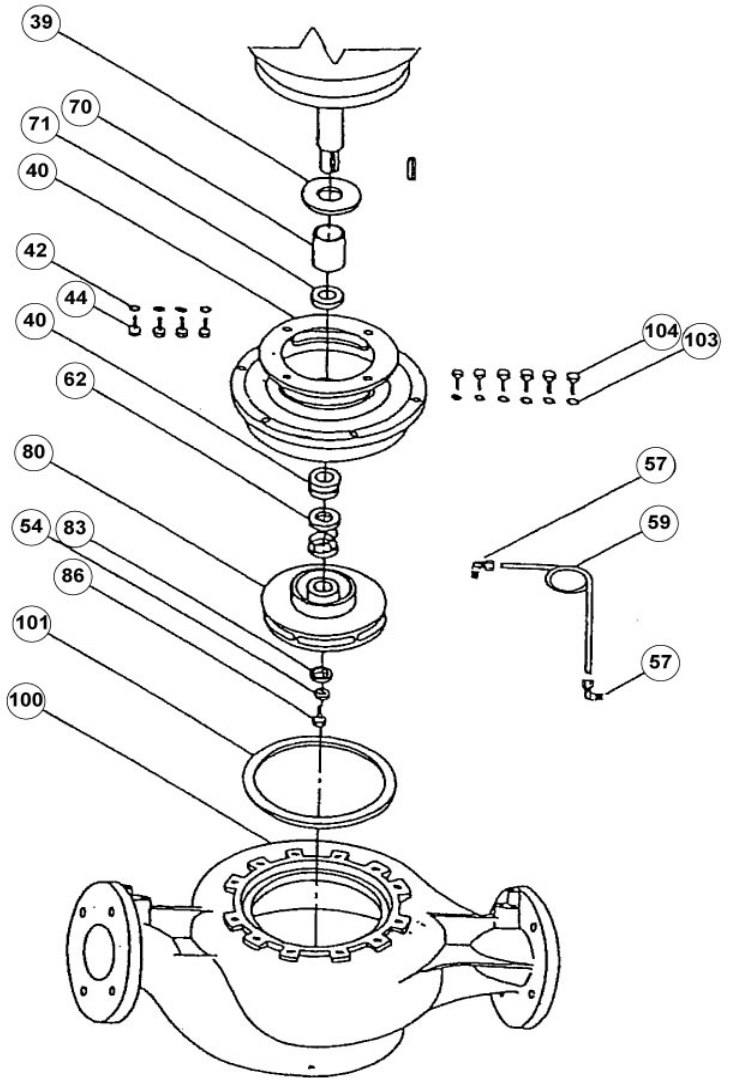

## INDEX

ITEM	DESCRIPTION	PAGE	ITEM	DESCRIPTION	PAGE	ITEM	DESCRIPTION	PAGE
15	SET SCREW	7	40	STUFF. BOX/ADAPTER	4	62	MECH. SEAL ASSY.	5
16	SET SCREW	7		For Pumps Built After Ser. No. 99807			For Pumps Built Prior To Ser. No. 99807	
17	SET SCREW	7	40	STUFF. BOX/ADAPTER	5	70	SHAFT SLEEVE	7
21	SHAFT EXTENSION	7		For Pumps Built Prior To Ser. No. 99808		71	SHFT. SLV. SPACER	7
30	FLANGE GASKET	9	43	MTR. CAPS. WASHER	6	70	SHAFT. SLV. KIT	7
31	FLANGE	9	44	MOTOR CAPSCREW	6	80	IMPELLER	3
32	FLANGE CAPSCREW	10	57	MALE ELBOW	8	83	IMPELLER WASHER	7
33	FLANGE CAPS. NUT	10	59	FLUSHLINE TUBING	8	86	IMPELLER NUT	7
36	IMPELLER KEY	7	62	MECH. SEAL ASSY.	4	100	CASING	3
39	WATER SLINGER	7		For Pumps Built After Ser. No. 99807		101	CASING GASKET	7
						103	CASCAPS. WASHER	6

# MODEL 4360

VERTICAL MOTOR MOUNTED

"D" SIZE 7/8" IMPELLER BORE - 1 1/4" MECHANICAL SEAL

<b>ITEM 100 CASING</b>			
<b>PUMP SIZE</b>	<b>CONST.</b>	<b>PART NUMBER</b>	<b>BAR CODE</b>
1 1/2 D	CAST IRON	116397-011	
1 1/2 D	BRONZE	116397-041	
2 D	CAST IRON	116174-011	
2 D	BRONZE	116174-041	
3 D	CAST IRON	116646-011	
3 D	BRONZE	116646-041	

<b>ITEM 80 IMPELLER**</b>			
<b>PUMP SIZE</b>	<b>CONST.</b>	<b>PART NUMBER</b>	<b>BAR CODE</b>
1 1/2 D	STEEL	426993-011	
1 1/2 D	BRONZE	426993-041	
2 D	STEEL	411860-011	
2 D	BRONZE	411860-041	
3 D	STEEL	426994-011	
3 D	BRONZE	426994-041	

\*\* Impeller Part Numbers are for full or maximum diameter Impellers, Always specify Pump Serial Number and where possible, measure and advise the diameter of the Impeller being replaced on these Pumps.



# MODEL 4360

VERTICAL MOTOR MOUNTED

"D" SIZE 7/8" IMPELLER BORE - 1 1/4" MECHANICAL SEAL

## ITEM 40 STUFFING BOX/ADAPTER

FOR PUMPS BUILT AFTER SERIAL NUMBERS 99807\*

PUMP SIZE	CONST.	MOTOR FRAME		BAR CODE
		56C 143-184JM	213-215JM	
1 1/2 D TO 3D	B.F. & A.I.	426988-011		
1 1/2 D TO 3D	A.B.	426988-041		
1 1/2 D TO 3D	BF.&A.I		426989-011	
1 1/2 D TO 3D	A.B.		426989-041	

## ITEM 62 MECHANICAL SEAL KIT

FOR PUMPS BUILT AFTER SERIAL NUMBERS 99807\*

PUMP SIZE	CONST.	PART NUMBER	
1 1/2 D TO 3D	B.F.	975000-982**	
1 1/2 D TO 3D	A.I.	975000-982**	
1 1/2 D TO 3D	A.B.	975000-982**	

\*\* Suitable for Potable / Drinking water. For non-potable water use 9975000-981

FOR PUMPS BUILT PRIOR TO SERIAL NUMBER 99808 SEE PAGE 5

# MODEL 4360

VERTICAL MOTOR MOUNTED

"D" SIZE 7/8" IMPELLER BORE - 1 1/4" MECHANICAL SEAL

## ITEM 40 STUFFING BOX/ADAPTER

FOR PUMPS BUILT PRIOR TO SERIAL NUMBERS 99808\*

PUMP SIZE	CONST.	MOTOR FRAME		BAR CODE
		56C 143-184JM	213-215JM	
1 1/2 D TO 3D	B.F. & A.I.	426990-011		
1 1/2 D TO 3D	A.B.	426990-041		
1 1/2 D TO 3D	BF.&A.I		426991-011	
1 1/2 D TO 3D	A.B.		426989-041	

## ITEM 62 MECHANICAL SEAL KIT

FOR PUMPS BUILT PRIOR TO SERIAL NUMBERS 99808\*

PUMP SIZE	CONST.	PART NUMBER	
1 1/2 D TO 3D	B.F.	825458-001	
1 1/2 D TO 3D	A.I.	825458-001	
1 1/2 D TO 3D	A.B.	825458-001	

# MODEL 4360

VERTICAL MOTOR MOUNTED

"D" SIZE 7/8" IMPELLER BORE - 1 1/4" MECHANICAL SEAL

## ITEM 43 MOTOR CAPS. LOCKWASHER

PUMP SIZE	NO. REQ'D	SIZE	MOTOR FRAME		BAR CODE
			56C 143-184JM	213-215JM	
1 1/2 D TO 3D	4	3/8"	927211-100		
1 1/2 D TO 3D	4	1/2"		927213-100	

## ITEM 44 MOTOR CAPSCREW

PUMP SIZE	NO. REQ'D	SIZE	MOTOR FRAME		BAR CODE
			56C 143-184JM	213-215JM	
1 1/2 D TO 3D	4	3/8-16X1"	911121-108		
1 1/2 D TO 3D	4	1/2-13X1 1/4"		911125-100	

## ITEM 103 CASING CAPSCREW WASHER

PUMP SIZE	NO. REQ'D	SIZE	PART NUMBER	BAR CODE
1 1/2 D TO 3D	8	3/8" PLAIN	927114-100	

## ITEM 104 CASING CAPSCREW

PUMP SIZE	NO. REQ'D	SIZE	PART NUMBER	BAR CODE
1 1/2 D TO 3D	8	3/8"-16X1	927114-100	

# MODEL 4360

VERTICAL MOTOR MOUNTED

"D" SIZE 7/8" IMPELLER BORE - 1 1/4" MECHANICAL SEAL

<b>COMMON PARTS</b>			
<b>ITEM NO.</b>	<b>DESCRIPTION</b>	<b>PART NUMBER</b>	<b>BAR CODE</b>
15*	SET SCREW (1 REQ'D)	916517-005	
	FRAME 56 ONLY		
16*	SET SCREW (1 REQ'D)	916519-104	
	FRAME 56 ONLY		
17*	SET SCREW (2 REQ'D)	916517-205	
	FRAME 56 ONLY		
21	SHAFT EXTENSION	426992-071	
	FRAME 56 ONLY		
36	IMPELLER KEY	974515-400	
	FRAME 56 ONLY		
39	WATER SLINGER	406622-000	
44	SHAFT SLEEVE	425869-001	
	B.F. AND A.B. CONSTRUCTION		
70	SHAFT SLEEVE	425869-002	
	A.I. CONSTRUCTION		
71	SHAFT SLEEVE SPACER	425868-001	
	ALL CONSTRUCTION		
NOT SHOWN	SHAFT SLV. & SPACER KIT	835085-001	
	B.F. AND A.B. CONSTRUCTION		
NOT SHOWN	SHAFT SLV. & SPACER KIT	835085-002	
	A.I. CONSTRUCTION		
83	IMPELLER CAPS. WASHER	425742-001	
86	IMPELLER CAPSCREW	911900-114	
101	CASING GASKET	106592-000	

# MODEL 4360

VERTICAL MOTOR MOUNTED

"D" SIZE 7/8" IMPELLER BORE - 1 1/4" MECHANICAL SEAL

## ITEM 57 MALE ELBOW

PUMP SIZE	MATERIAL SIZE NO. REQ'D	CONST.	PART NUMBER	BAR CODE
ALL	BRASS 3/8" TUBE X 1/4" NPT 2	B.F. & A.B.	939001-114	
ALL	STEEL 3/8" TUBE X 1/4" NPT 2	A.I.	939001-214	

## ITEM 59 FLUSH LINE TUBING

PUMP SIZE	MATERIAL SIZE NO. REQ'D	CONST.	PART NUMBER	BAR CODE
ALL	SOFT. COPPER X 0.032 WALL 3/8" X 12" 1	B.F. & A.B.	997531-004	
ALL	STEEL X 0.035 WALL 3/8" X 12" 1	A.I.	997153-004	

# MODEL 4360

VERTICAL MOTOR MOUNTED

"D" SIZE 7/8" IMPELLER BORE - 1 1/4" MECHANICAL SEAL

## ITEM 30 FLANGE GASKET

PUMP MODEL	CONST.	PIPE SIZE	NO. REQ'D	PART NUMBER	BAR CODE
1 1/2D	ALL	1 1/2" NPT	2	104034-000	
2D	ALL	2" NPT	2	116117-000	
3D	ALL	3" NPT	2	125605-106	

## ITEM 31 FLANGE

PUMP MODEL	CONST.	PIPE SIZE	PART NUMBER	BAR CODE
1 1/2D	B.F - A.I.	1 1/2" NPT	104301-011	
1 1/2D	A.B	1 1/2" NPT	104301-041	
2D	B.F - A.I.	2" NPT	106074-011	
2D	A.B	2" NPT	106074-041	
3D	B.F - A.I.	3" NPT	133615-011	
3D	A.B	3" NPT	133615-041	

# MODEL 4360

VERTICAL MOTOR MOUNTED

"D" SIZE 7/8" IMPELLER BORE - 1 1/4" MECHANICAL SEAL

<b>ITEM 32 FLANGE CAPSCREW</b>				
<b>PUMP MODEL</b>	<b>NO. REQ'D</b>	<b>SIZE</b>	<b>PART NUMBER</b>	<b>BAR CODE</b>
1 1/2D	2	7/16-14 X 1 3/4" STL.	911123-114	
2D	2	1/2-13X2 1/4" STL.	911125-118	
3D	2	5/8-11X2 1/2"	911125-120	

<b>ITEM 33 FLANGE CAPSCREW NUT</b>				
<b>PUMP</b>	<b>NO.</b>	<b>SIZE</b>	<b>PART NUMBER</b>	<b>BAR CODE</b>
1 1/2D	2	7/16-14 HEX STL.	913123-100	
2D	2	1/2-13 HEX STL.	913125-100	
3D	2	5/8-11 HEX STL.	913129-100	