

Model 007 Cartridge Circulator

The Taco 007 Cartridge Circulator is the most popular hydronic circulator sold today. With its field serviceable cartridge design, the compact 007 provides quiet, efficient operation and unmatched reliability. The self-lubricating, maintenance free design and flow characteristics make it the ideal hydronic circulator for a wide range of applications.



Stainless Steel



Low Lead
Compliant



Submittal Data Information Model 007 Cartridge Circulator

Submittal Data # 101-029
Supersedes: 03/25/13

Effective: 06/10/15

Features

- Standard High Capacity Output-Compact Design
- Quiet, Efficient Operation
- Direct Drive-Low Power Consumption
- Unique Replaceable Cartridge Design-Field Serviceable
- Self Lubricating
- No Mechanical Seal
- Unmatched Reliability-Maintenance Free
- Universal Flange to Flange Dimensions
- Cast Iron or Stainless Steel Construction

Materials of Construction

Casing (Volute):..... Cast Iron or Stainless Steel
 Stator Housing:..... Steel
 Cartridge:..... Stainless Steel
 Impeller: Non-Metallic
 Shaft:..... Ceramic
 Bearings:..... Carbon
 O-Ring & Gaskets:..... EPDM

Model Nomenclature

F - Cast Iron, Flanged
 SF - Stainless Steel, Flanged

Performance Data

Max. Flow: 23 GPM
 Max. Head: 10 Feet
 Min. Fluid Temperature: 40°F (4°C)
 Max. Fluid Temperature: 230°F (110°C)
 Max. Working Pressure: 125 psi
 Connection Sizes: 3/4", 1", 1-1/4", 1-1/2" Flanged

Certifications & Listings

UL US LISTED FOR INDOOR USE ONLY

NSF Low Lead Compliant
Certified to NSF/ANSI 372

Application

The Taco 007 is a cartridge style, maintenance free, wet-rotor, in-line, single stage circulator pump. It is designed for quiet operation in Hydronic heating, Radiant heating, Hydro-Air fan coils, Indirect water heaters, Chilled fresh water, and Domestic Water Recirculation systems. Available in Cast Iron or Stainless Steel construction with universal flanged connections. The unique replaceable cartridge contains all of the moving parts and allows the circulator to be easily serviced instead of replacing the entire unit. Ideal for a wide range of applications.

Pump Dimensions & Weights

Models	Casing	Flange Type*	A		B		C		D		F		G		Ship Wt.	
			in.	mm	in.	mm	in.	mm	in.	mm	in.	mm	in.	mm	lbs.	Kg
007-F5	Cast Iron	S	6-3/8	162	4-1/2	114	3-3/16	81	3-15/16	75	4-3/4	121	6-3/8	162	8.0	3.6
007-F5-5	Cast Iron	R	6-1/2	156	4-1/2	114	3-3/16	81	3-15/16	75	4-3/4	121	6-3/8	162	8.0	3.6
007-SF5	St. Steel	S	6-3/8	162	4-1/2	114	3-3/16	81	3-15/16	75	4-3/4	121	6-3/8	162	7.0	3.2

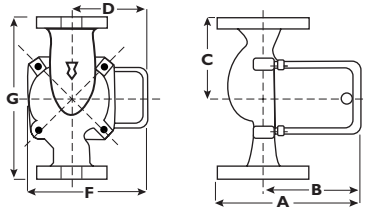

Mounting Positions

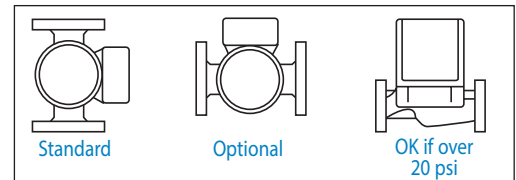

Electrical Data

Model	Volts	Hz	Ph	Amps	RPM	HP
Cast Iron	115	60	1	.74	3250	1/25
St. Steel	115	60	1	.76	3250	1/25

Motor Type: Permanent Split Capacitor Impedance Protected

Motor Options: 220/50/1, 220/60/1, 230/60/1, 100/110/50/60/1

*Flange Orientation Type

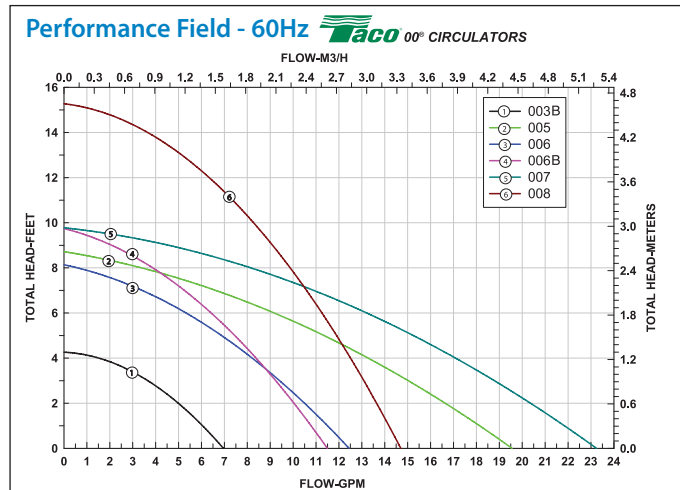
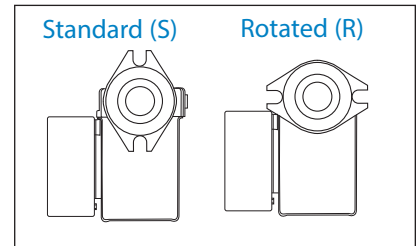

Model 007-IFC® Cartridge Circulator

The 007-IFC features a removable Integral Flow Check designed to improve pump performance, simplify piping and reduce installation costs. The spring-loaded IFC replaces a separate in-line-flow check to ensure protection against reverse flow and gravity flow.



Stainless Steel



Low Lead
Compliant



Submittal Data Information Model 007-IFC® Cartridge Circulator

Submittal Data # 101-077
Supersedes: 06/07/10

Effective: 02/25/12

Features

- Integral Flow Check (IFC®)
 - Simplifies piping
 - Prevents reverse flow and gravity flow
 - Eliminates separate in-line flow check
 - Reduces installed cost
 - Improves system performance
 - Easy to service
- Unique replaceable cartridge-field serviceable
- Unmatched reliability-maintenance free
- Quiet, efficient operation
- Self lubricating, No mechanical seal
- Wide range of applications
- Cast Iron or Stainless Steel construction
- Flanged connections

Materials of Construction

Casing (Volute): Cast Iron or Stainless Steel

Integral Flow Check (IFC®):
 Body, Plunger.....Acetal
 O-ring Seals.....EPDM
 Spring.....Stainless Steel

Stator Housing: Steel
 Cartridge: Stainless Steel
 Impeller: Non-Metallic
 Shaft: Ceramic
 Bearings: Carbon
 O-Ring & Gaskets: EPDM

Model Nomenclature

F – Cast Iron, Flanged
 SF – Stainless Steel, Flanged
 IFC® – Integral Flow Check

Performance Data

Max. Flow: 0 - 17 GPM
 Max. Head: 0 - 8.5 Feet
 Minimum Fluid Temperature: 40°F (4°C)
 Maximum Fluid Temperature: 230°F (110°C)
 Maximum Working Pressure: 125 psi
 Connection Sizes: 3/4", 1", 1-1/4", 1-1/2" Flanged

Certifications & Listings

UL US LISTED FOR INDOOR USE ONLY

NSF Low-Lead Compliant
 Certified to NSF/ANSI 372

Application

- Hydronic Heating/Cooling
- Radiant
- Indirect Water Heaters
- Hydro-Air Fan Coils
- Domestic Water Recirculation (Stainless Steel only)

The 007-IFC is designed to simplify piping, reduce installation costs and improve system performance when zoning with 00" circulators. By locating the IFC inside the pump, a separate in-line flow check is eliminated. The low pressure drop of the IFC increases flow performance vs. in-line flow checks. Both the IFC and the cartridge are easily accessed for removal and service.

Pump Dimensions & Weights

Model	Casing	Flange Type*	A		B		C		D		E		F		Ship Wt.	
			in.	mm	in.	mm	in.	mm	in.	mm	in.	mm	in.	mm	lbs.	Kg
007-F5-7 IFC	Cast Iron	S	6-1/8	156	4-1/2	114	3-3/16	81	2-15/16	75	5	127	6-3/8	162	9	4.0
007-F5-8 IFC	Cast Iron	R	5-7/8	149	4-1/2	114	3-3/16	81	2-15/16	75	5	127	6-3/8	162	9	4.0
007-SF5-7 IFC	S. Steel	S	6-1/8	156	4-1/2	114	3-3/16	81	2-15/16	75	5	127	6-3/8	162	9	4.0

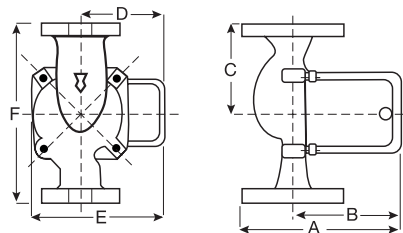

Mounting Positions

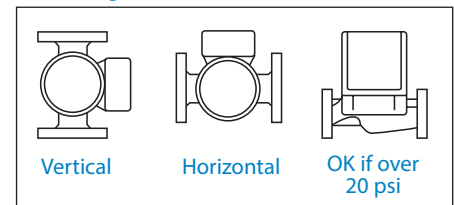

Electrical Data

Model	Volts	Hz	Ph	Amps	RPM	HP
Cast Iron	115	60	1	.71	3250	1/25
St. Steel	115	60	1	.76	3250	1/25

Motor Type: Permanent Split Capacitor Impedance Protected

Motor Options: 220/50/1, 220/60/1, 230/60/1, 100/110/50/60/1

*Flange Orientation Type

