

## Model 005 Cartridge Circulator

The compact Taco 005 Cartridge Circulator is designed for quiet, efficient operation in hydronic heating, chilled water, and domestic water systems. Its unique field-serviceable cartridge contains all moving parts. Replacing the cartridge rebuilds the circulator. With no mechanical seal, the self-lubricating, maintenance free design provides unmatched reliability. Flow characteristics for the 005 make it the ideal circulator for a wide range of applications. Available in Cast Iron or Stainless Steel construction.



Stainless Steel



Low-Lead  
Compliant



# Submittal Data Information Model 005 Cartridge Circulator

Submittal Data # 101-030  
Supersedes: 06/01/11

Effective: 04/09/13

## Features

- Standard High Capacity Output-Compact Design
- Quiet, Efficient Operation
- Unique Replaceable Cartridge - Field Serviceable
- Self Lubricating
- No Mechanical Seal
- Unmatched Reliability - Maintenance Free
- Universal Flange to Flange Dimensions
- Cast Iron or Stainless Steel Construction

## Materials of Construction

Casing (Volute): Cast Iron or Stainless Steel  
Stator Housing:.....Steel  
Cartridge:.....Stainless Steel  
Impeller:.....Non-Metallic  
Shaft:.....Ceramic  
Bearings:.....Carbon  
O-Ring & Gaskets:.....EPDM

## Model Nomenclature

F – Cast Iron, Flanged  
SF – Stainless Steel, Flanged

## Performance Data

Flow Range: 0 - 19 GPM  
Head Range: 0 - 9 Feet  
Min. Fluid Temperature: 40°F (4°C)  
Max. Fluid Temperature, Cast Iron: 230°F (110°C)  
Max. Fluid Temperature, St. Steel: 220°F (104°C)  
Max. Working Pressure: 125 psi  
Connection Sizes: 3/4", 1", 1-1/4", 1/2" Flanged

## Certifications & Listings

**UL** US LISTED FOR INDOOR USE ONLY

**NSF** Low-Lead Compliant  
Certified to NSF/ANSI 372

## Application

- Hydronic Heating/Cooling
- Radiant
- Indirect Water Heaters
- Hydro Fan Coils
- Domestic Water Recirculation
- Solar Thermal

The Taco 005 is designed for a wide range of residential and light commercial water circulating applications. It's unique replaceable cartridge contains all of the moving parts and allows for easy service, instead of replacing the entire circulator. Compact, direct-drive, low power consumption design is ideal for high efficiency jobs.

## Pump Dimensions & Weights

Model	Casing	A		B		C		D		F		G		Ship Wt.	
		in.	mm	in.	mm	in.	mm	in.	mm	in.	mm	in.	mm	lbs.	Kg
005-F2	Cast Iron	5-5/8	143	4	102	3-3/16	81	2-15/16	75	4-3/4	121	6-3/8	162	7.0	3.2
005-SF2	Stainless Steel	5-5/8	143	4	102	3-3/16	81	2-15/16	75	4-3/4	121	6-3/8	162	7.0	3.2

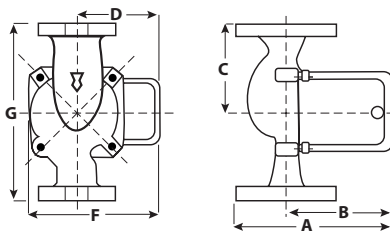

## Mounting Positions

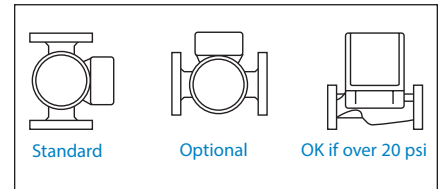

## Electrical Data

Model	Volts	Hz	Ph	Amps	RPM	HP
005-F2	115	60	1	.52	3250	1/35
005-SF2	115	60	1	.54	3250	1/35
Motor Type	Permanent Split Capacitor Impedance Protected					
Motor Options	220/50/1, 220/60/1, 230/60/1, 100/110/50/60/1					

## Flange Orientation

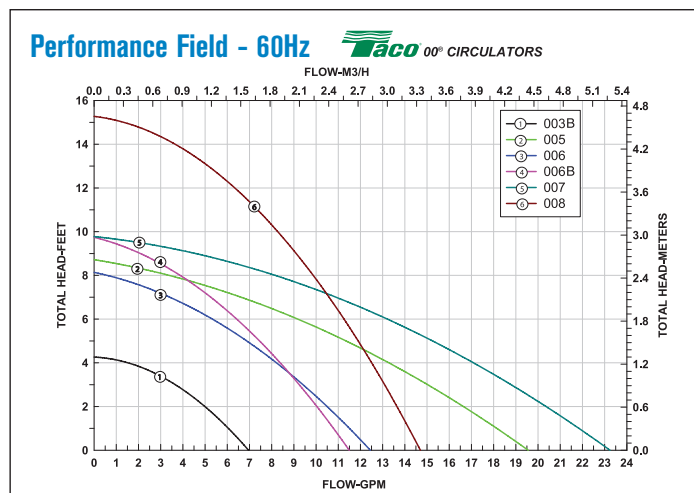
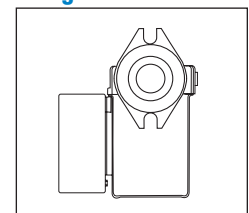

### **Model 005-IFC<sup>®</sup> Cartridge Circulator**

The 005-IFC features a removable Integral Flow Check, designed to improve pump performance, simplify piping and reduce installation costs. The spring loaded IFC<sup>®</sup> replaces a separate in-line flow check to ensure protection against reverse flow and gravity flow.



Stainless Steel



Low-Lead  
Compliant



# Submittal Data Information

## Model 005-IFC® Cartridge Circulator

Submittal Data # 101-083  
Supersedes: 06/01/11

Effective: 04/08/13

### Features

- Integral Flow Check (IFC®)  
Simplifies piping  
Prevents reverse flow and gravity flow  
Eliminates separate in-line flow check  
Reduces installed cost  
Improves system performance  
Easy to service
- Unique replaceable cartridge-field serviceable
- Unmatched reliability-maintenance free
- Quiet, efficient operation
- Self lubricating, No mechanical seal
- Wide range of applications
- Cast Iron or Stainless Steel construction
- Flanged connections

### Materials of Construction

Casing (Volute): Cast Iron or St. Steel  
Integral Flow Check (IFC®):  
Body, Plunger.....Acetal  
O-ring Seals.....EPDM  
Spring.....Stainless Steel  
Stator Housing:.....Steel  
Cartridge:.....Stainless Steel  
Impeller: .....Non-Metallic  
Shaft: .....Ceramic  
Bearings: .....Carbon  
O-Ring & Gaskets: .....EPDM

### Model Nomenclature

F – Cast Iron, Flanged  
SF – Stainless Steel, Flanged  
IFC – Integral Flow Check

### Performance Data

Flow Range: 0 - 13.5 GPM  
Head Range: 0 - 7.5 Feet  
Min. Fluid Temperature: 40°F (4°C)  
Max. Fluid Temperature: 230°F (110°C)  
Max. Working Pressure: 125 psi  
Connection Sizes:  
3/4", 1", 1-1/4", 1-1/2" Flanged

### Certifications & Listings



### Application

- Hydronic Heating/Cooling
- Radiant
- Indirect Water Heaters
- Hydro-Air Fan Coils
- Domestic Water Recirculation (Stainless Steel)

The 005-IFC is designed to simplify piping, reduce installation costs and improve system performance when zoning with 00" circulators. By locating the IFC inside the pump, a separate in-line flow check is eliminated. The low pressure drop of the IFC increases flow performance vs. in-line flow checks. Both the IFC and the cartridge are easily accessed for removal and service.

### Pump Dimensions & Weights

Model	Casing	Flange Type*	A		B		C		D		E		F		Ship Wt.	
			in.	mm	in.	mm	in.	mm	in.	mm	in.	mm	lbs.	Kg		
005-F2-2 IFC	Cast Iron	S	5-5/8	143	4-1/8	105	3-3/16	81	2-15/16	75	5	127	6-3/8	162	8	3.6
005-F2-3 IFC	Cast Iron	R	5-3/8	137	4-1/8	105	3-3/16	81	2-15/16	75	5	127	6-3/8	162	8	3.6
005-SF2-IFC	St. Steel	S	5-5/8	143	4-1/8	105	3-3/16	81	2-15/16	75	5	127	6-3/8	162	8	3.6

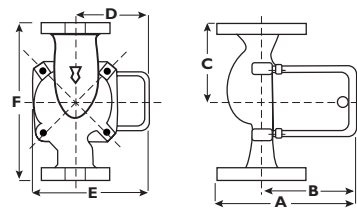

### Mounting Positions

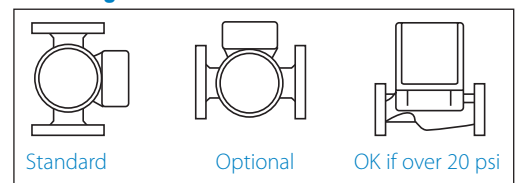

### Electrical Data

Model	Volts	Hz	Ph	Amps	RPM	HP
Cast Iron	115	60	1	.52	3250	1/25
St. Steel	115	60	1	.54	3250	1/25
Motor Type	Permanent Split Capacitor Impedance Protected					
Motor Options	220/50/1, 220/60/1, 230/60/1, 100/110/50/60/1					

### \*Flange Orientation Type

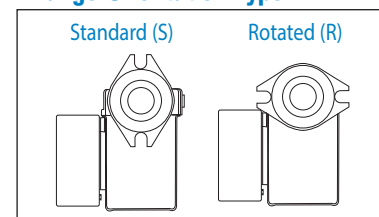

### Performance Field - 60Hz

