



Replacement Parts List

REV A G. TABER

PARTS LIST FOR MODEL : VC-2500

| ITEM NO. | REQUIRED | DESCRIPTION | PART NO. |
|----------|----------|--------------------------|-----------------------------------|
| ASSY | | | |
| 17-1 | 1 | CASING | 31164-430-124-Z N/A |
| 17-2 | 1 | WEAR RING - BRONZE | 34114-211-445-1 ✓ |
| 17-2 | 1 | WEAR RING - CAST IRON | 34114-211-124-1 ✓ |
| 5-3 | 1 | IMPELLER - BRONZE | 31677-329-445-0 ✓ |
| 5-3 | 1 | IMPELLER - CAST IRON | 31677-329-124-0 |
| 8-4 | 1 | IMPELLER BOLT | 21762-332-951-7 10-262 |
| 6-5 | 1 | IMPELLER WASHER | 950-048-7 950-047 |
| 7-6 | 1 | ADAPTOR | 951-208C ✓ |
| 119-7 | 1 | COVER | 950-187 |
| 61-8 | 1 | SHAFT | 951-203 |
| 11-9 | 1 | SHAFT SLEEVE | 951-199 |
| 128-10 | 1 | SHAFT SLEEVE NUT | 951-198 |
| 15-11 | 1 | SHAFT SLEEVE "O" RING | 951-255 |
| 125-12 | 1 | RETAINER CAP | 951-204 |
| 124-13 | 1 | RETAINER CAP GASKET | 951-200 |
| 219 [14 | 1 | SEAL TYPE "B" | 950-664-5 950-665 |
| 14 | 1 | SEAL TYPE "D" | 950-667-8 950-668 |
| 14 | 1 | SEAL TYPE "E" | 950-670-1 950-671 |
| 120-15 | 2 | SPLIT RING RING PUMP END | 951-201 |
| 38-16 | 1 | COUPLER KEY PUMP END | 13-113 |
| 9-19 | 1 | IMPELLER KEY | 13-119 |

| | | | |
|--------|---|---------------------------|-----------------|
| 120-17 | 2 | FOR MOTOR FRAME 145 | B CODE |
| 121-18 | 1 | SPLIT RING RING MOTOR END | 951-251 |
| 69-20 | 1 | COUPLER | 951-206 |
| | | KEY - MOTOR | 13-113 |
| 120-17 | 2 | FOR MOTOR FRAME 182-286 | C, D, E, F CODE |
| 121-18 | 1 | SPLIT RING RING MOTOR END | 951-201 |
| 69-20 | 1 | COUPLER | 951-202 |
| | | KEY - MOTOR | 13-124 |

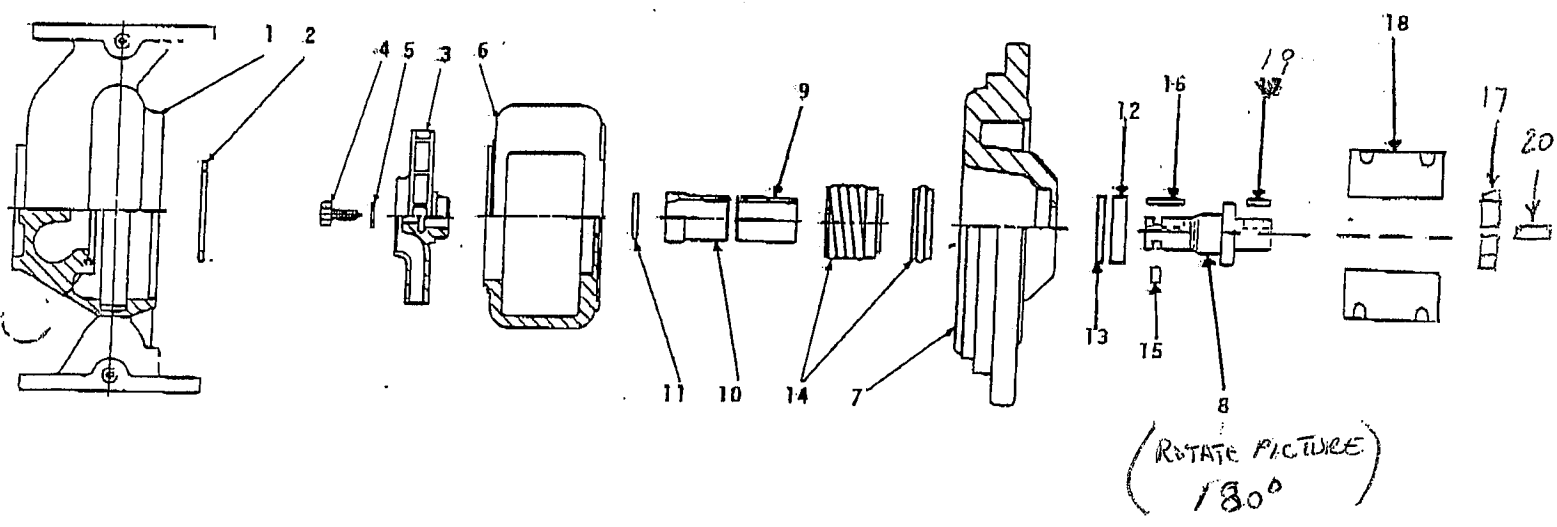



Replacement Parts List

304- 323

VC 3013

WHEN SELECTING AND ORDERING PARTS, ALWAYS REFER TO SERIAL NUMBER ON NAMEPLATE

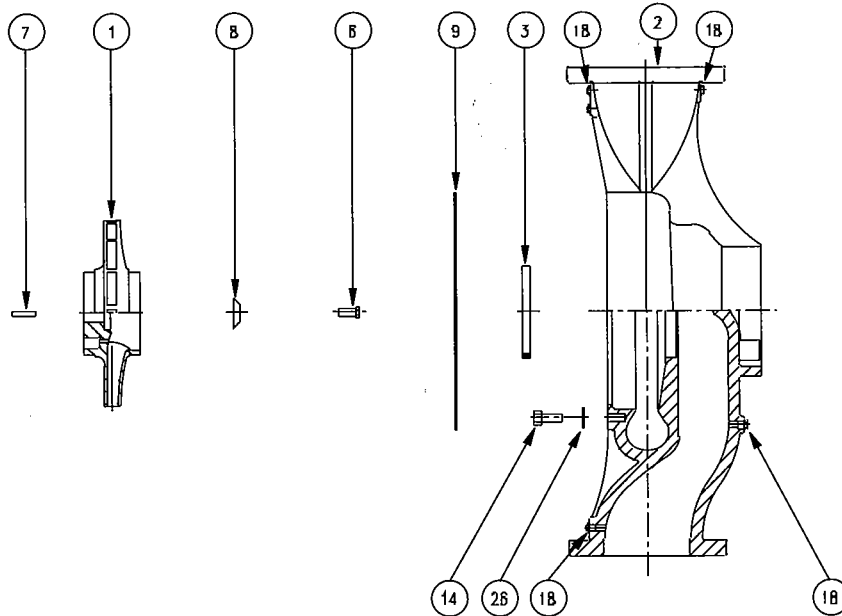
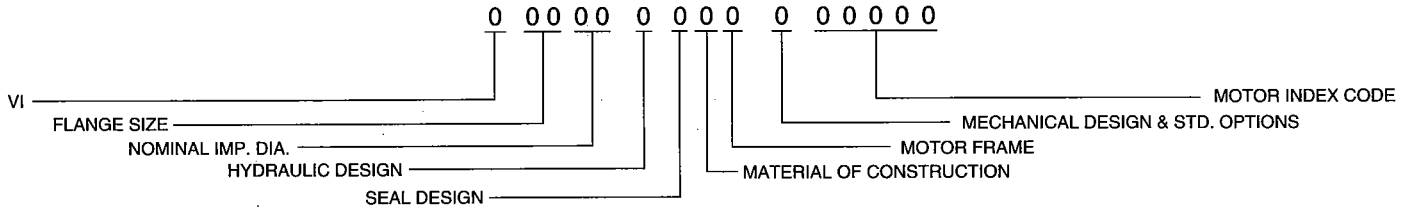

| ITEM NO. | NO. REQ. | DESCRIPTION | 3013 | 3013 | 4013 | 4013 |
|----------|----------|--------------------------|--------------|--------------|--------------|--------------|
| | | | FRAME B OR C | FRAME D OR E | FRAME B OR C | FRAME D OR E |
| 1 | 1 | IMPELLER (CI) | 953-1120RP | 953-1121RP | 953-1136RP | 953-1137RP |
| 1 | 1 | IMPELLER (BRZ) | 953-1122RP | 953-1123RP | 953-1138RP | 953-1139RP |
| 2 | 1 | CASING (125#)(W/WR OPT) | 953-1126RP | 953-1126RP | 953-1142RP | 953-1142RP |
| 2 | 1 | CASING (250#)(W/WR OPT) | 953-1127RP | 953-1127RP | 953-1143RP | 953-1143RP |
| 2 | 1 | CASING (125#)(NO WR STD) | 953-1469RP | 953-1469RP | 953-1475RP | 953-1475RP |
| 2 | 1 | CASING (250#)(NO WR STD) | 953-1471RP | 953-1471RP | 953-1477RP | 953-1477RP |
| 3 | 1(W/R) | WEAR RING (BRZ) (OPT) | LE5689-12RP | LE5689-12RP | 953-1145RP | 953-1145RP |
| 6 | 1 | IMPELLER BOLT | ← HARDWARE → | | | |
| 7 | 1 | IMPELLER KEY | ← HARDWARE → | | | |
| 8 | 1 | IMPELLER WASHER | 953-828RP | 953-829RP | 953-829RP | 953-829RP |
| 9 | 1 | GASKET (CASING) | 953-1011RP | 953-1011RP | 953-1011RP | 953-1011RP |
| 14 | 16 | CASING BOLT | ← HARDWARE → | | | |
| 18 | 5 | PIPE PLUG | ← HARDWARE → | | | |
| 26 | 16 | CASING WASHER | ← HARDWARE → | | | |

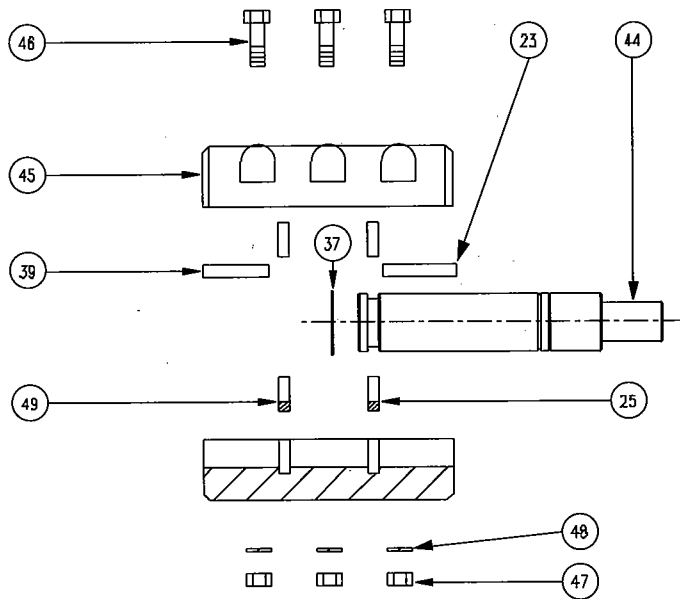

PUMP MODELS

| ITEM NO. | NO. REQ. | DESCRIPTION | PUMP MODELS | | | | |
|----------|----------|----------------------|-------------|------------|------------|------------|------------|
| | | | FRAME B | FRAME C | FRAME D | FRAME E | FRAME F |
| | | | 6009 | 6009 | 6009 | 6009 | ----- |
| | | | 6011 | 6011 | 6011 | 6011 | ----- |
| | | | 3013 | 3013 | 3013 | 3013 | ----- |
| | | | 4013 | 4013 | 4013 | 4013 | ----- |
| | | | 6013 | 6013 | 6013 | 6013 | 6013 |
| | | | ----- | ----- | 8013 | 8013 | 8013 |
| | | | FRAME B | FRAME C | FRAME D | FRAME E | FRAME F |
| 23 | 1 | KEY-PUMP | HARDWARE | HARDWARE | HARDWARE | HARDWARE | HARDWARE |
| 25 | 1 | CIRCULAR KEY-PUMP | 953-1313RP | 953-1313RP | 953-1314RP | 953-1314RP | 953-1316RP |
| 37 | 1 | RETAINING RING-SEAL | HARDWARE | HARDWARE | HARDWARE | HARDWARE | HARDWARE |
| 39 | 1 | KEY-MOTOR | HARDWARE | HARDWARE | HARDWARE | HARDWARE | HARDWARE |
| 44 | 1 | SHAFT | 953-1298RP | 953-1298RP | 953-1297RP | 953-1297RP | 953-1296RP |
| 45 | 1 | COUPLING | 953-1311RP | 951-202RP | 953-1310RP | 953-1309RP | 953-1527RP |
| 46 | 6 | BOLT-COUPLING | HARDWARE | HARDWARE | HARDWARE | HARDWARE | HARDWARE |
| 47 | 6 | NUT-COUPLING | HARDWARE | HARDWARE | HARDWARE | HARDWARE | HARDWARE |
| 48 | 6 | LOCK WASHER-COUPLING | HARDWARE | HARDWARE | HARDWARE | HARDWARE | HARDWARE |
| 49 | 1 | CIRCULAR KEY-MOTOR | 953-1312RP | 953-1313RP | 953-1313RP | 953-1315RP | 953-1315RP |

DO IT ONCE. DO IT RIGHT.

TACO, INC., 1160 Cranston Street, Cranston, RI 02920 Telephone: (401) 942-8000 FAX: (401) 942-2360.

TACO (Canada), Ltd., 6180 Ordan Drive, Mississauga, Ontario L5T 2B3. Telephone: 905/564-9422. FAX: 905/564-9436.

Printed in USA
Copyright 1999
TACO, Inc.

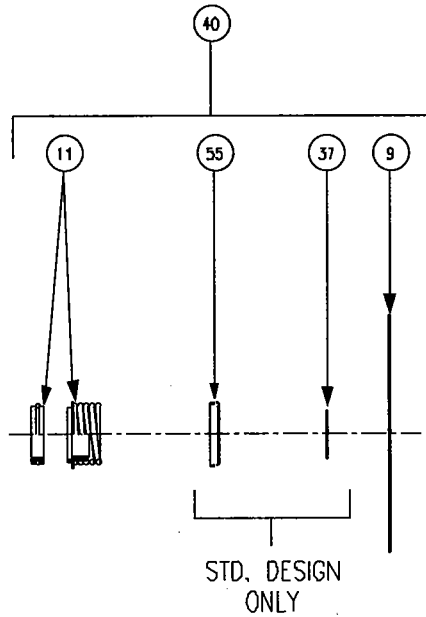

PUMP MODELS

| | | PUMP MODELS | | | | | | | |
|----------|----------|----------------------|-------------------------------|--------------|--------------|-------------------------------|---------------|---------------|-----------------|
| | | 6009 | 6009 | 6009 | 6009 | 6009 | 6009 | | |
| | | 6011 | 6011 | 6011 | 6011 | 6011 | 6011 | | |
| | | 3013 | 3013 | 3013 | 3013 | 3013 | 3013 | | |
| | | 4013 | 4013 | 4013 | 4013 | 4013 | 4013 | | |
| | | 6013 | 6013 | 6013 | 6013 | 6013 | 6013 | | |
| | | ----- | 8013 | 8013 | ----- | 8013 | 8013 | | |
| ITEM NO. | NO. REQ. | DESCRIPTION | MOTOR FRAME | | | | | | STANDARD DESIGN |
| | | | B OR C | D OR E | F | B OR C | D OR E | F | |
| | | | MECHANICAL DES. A OR C (125#) | | | MECHANICAL DES. B OR D (250#) | | | |
| 9 | 1 | GASKET (CASING) | SEE PAGE 1 | SEE PAGE 1 | SEE PAGE 1 | SEE PAGE 1 | SEE PAGE 1 | SEE PAGE 1 | |
| 37 | 1 | RETAINING RING | 15-147 | 15-148 | 15-149 | 15-147 | 15-148 | 15-149 | |
| 55 | 1 | SPRINGHOLDER | 953-1529RP | 953-1530RP | 953-1531RP | ----- | ----- | ----- | |
| 11 | 1 | SEAL (TYPE B) | 951-3157RP | 951-3158RP | 951-2966RP | 951-3766RP | 951-5158RP | 951-5151RP | |
| 11 | 1 | SEAL (TYPE D) | 951-3159RP | 951-3160RP | 951-2967RP | 951-3781RP | 951-5159RP | 951-5152RP | |
| 11 | 1 | SEAL (TYPE E) | 951-3161RP | 951-3162RP | 951-2968RP | 951-3782RP | 951-5160RP | 951-5153RP | |
| 40 | 1 | SEAL KIT (TYPE B) SS | 953-1548-1RP | 953-1548-4RP | 953-1548-7RP | 953-1548-10RP | 953-1548-13RP | 953-1548-16RP | |
| 40 | 1 | SEAL KIT (TYPE D) SS | 953-1548-2RP | 953-1548-5RP | 953-1548-8RP | 953-1548-11RP | 953-1548-14RP | 953-1548-17RP | |
| 40 | 1 | SEAL KIT (TYPE E) SS | 953-1548-3RP | 953-1548-6RP | 953-1548-9RP | 953-1548-12RP | 953-1548-15RP | 953-1548-18RP | |
| 9 | 1 | GASKET (CASING) | SEE PAGE 1 | SEE PAGE 1 | SEE PAGE 1 | EXTERNAL DESIGN | | | |
| 11 | 1 | SEAL (TYPE U) | 953-1326RP | 953-1327RP | 953-1328RP | | | | |
| 11 | 1 | SEAL (TYPE V) | 953-1329RP | 953-1330RP | 953-1331RP | | | | |
| 11 | 1 | SEAL (TYPE W) | 953-1332RP | 953-1333RP | 953-1334RP | | | | |



Replacement Parts List

304-324

VC 4013

WHEN SELECTING AND ORDERING PARTS, ALWAYS REFER TO SERIAL NUMBER ON NAMEPLATE

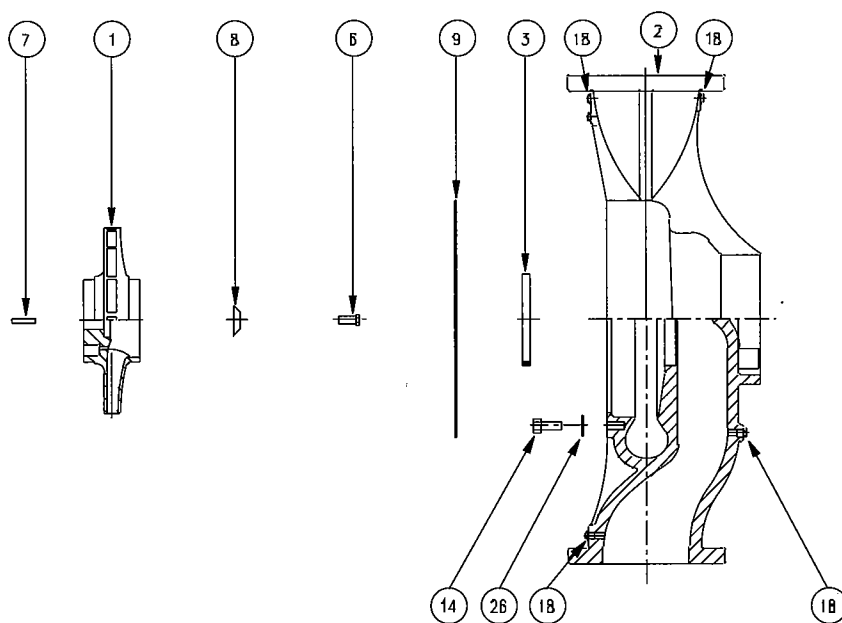
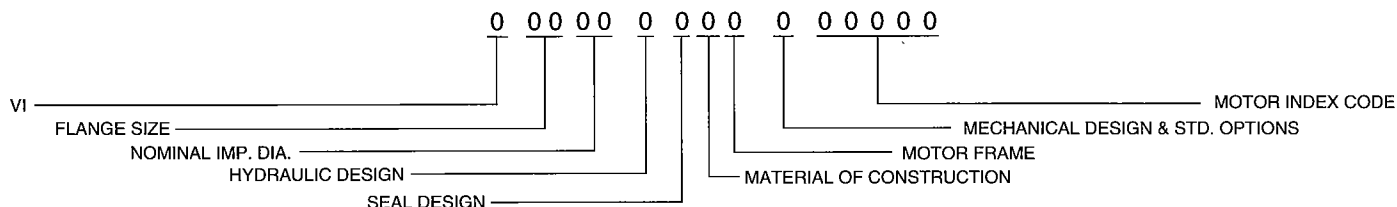

| ITEM NO. | NO. REQ. | DESCRIPTION | 3013 | 3013 | 4013 | 4013 |
|----------|----------|--------------------------|------------------------|--------------|--------------|--------------|
| | | | FRAME B OR C | FRAME D OR E | FRAME B OR C | FRAME D OR E |
| 1 | 1 | IMPELLER (CI) | 953-1120RP | 953-1121RP | 953-1136RP | 953-1137RP |
| 1 | 1 | IMPELLER (BRZ) | 953-1122RP | 953-1123RP | 953-1138RP | 953-1139RP |
| 2 | 1 | CASING (125#)(W/WR OPT) | 953-1126RP | 953-1126RP | 953-1142RP | 953-1142RP |
| 2 | 1 | CASING (250#)(W/WR OPT) | 953-1127RP | 953-1127RP | 953-1143RP | 953-1143RP |
| 2 | 1 | CASING (125#)(NO WR STD) | 953-1469RP | 953-1469RP | 953-1475RP | 953-1475RP |
| 2 | 1 | CASING (250#)(NO WR STD) | 953-1471RP | 953-1471RP | 953-1477RP | 953-1477RP |
| 3 | 1(W/R) | WEAR RING (BRZ) (OPT) | LE5689-12RP | LE5689-12RP | 953-1145RP | 953-1145RP |
| 6 | 1 | IMPELLER BOLT | ←————— HARDWARE —————→ | | | |
| 7 | 1 | IMPELLER KEY | ←————— HARDWARE —————→ | | | |
| 8 | 1 | IMPELLER WASHER | 953-828RP | 953-829RP | 953-829RP | 953-829RP |
| 9 | 1 | GASKET (CASING) | 953-1011RP | 953-1011RP | 953-1011RP | 953-1011RP |
| 14 | 16 | CASING BOLT | ←————— HARDWARE —————→ | | | |
| 18 | 5 | PIPE PLUG | ←————— HARDWARE —————→ | | | |
| 26 | 16 | CASING WASHER | ←————— HARDWARE —————→ | | | |

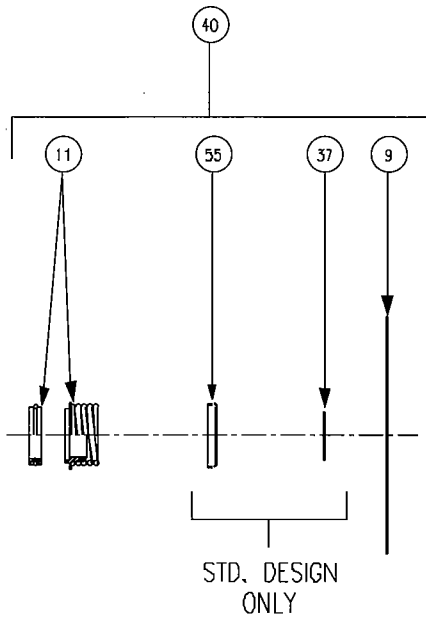

PUMP MODELS

| | | | | | |
|-------|------|------|-------|------|------|
| 6009 | 6009 | 6009 | 6009 | 6009 | 6009 |
| 6011 | 6011 | 6011 | 6011 | 6011 | 6011 |
| 3013 | 3013 | 3013 | 3013 | 3013 | 3013 |
| 4013 | 4013 | 4013 | 4013 | 4013 | 4013 |
| 6013 | 6013 | 6013 | 6013 | 6013 | 6013 |
| ----- | 8013 | 8013 | ----- | 8013 | 8013 |

| ITEM NO. | NO. REQ. | DESCRIPTION | MOTOR FRAME | | | | | | STANDARD DESIGN |
|----------|----------|----------------------|-------------------------------|--------------|--------------|-------------------------------|---------------|---------------|-----------------|
| | | | B OR C | D OR E | F | B OR C | D OR E | F | |
| | | | MECHANICAL DES. A OR C (125#) | | | MECHANICAL DES. B OR D (250#) | | | |
| | | | SEE PAGE 1 | SEE PAGE 1 | SEE PAGE 1 | SEE PAGE 1 | SEE PAGE 1 | SEE PAGE 1 | |
| 9 | 1 | GASKET (CASING) | SEE PAGE 1 | SEE PAGE 1 | SEE PAGE 1 | SEE PAGE 1 | SEE PAGE 1 | SEE PAGE 1 | |
| 37 | 1 | RETAINING RING | 15-147 | 15-148 | 15-149 | 15-147 | 15-148 | 15-149 | |
| 55 | 1 | SPRINGHOLDER | 953-1529RP | 953-1530RP | 953-1531RP | ----- | ----- | ----- | |
| 11 | 1 | SEAL (TYPE B) | 951-3157RP | 951-3158RP | 951-2966RP | 951-3766RP | 951-5158RP | 951-5151RP | |
| 11 | 1 | SEAL (TYPE D) | 951-3159RP | 951-3160RP | 951-2967RP | 951-3781RP | 951-5159RP | 951-5152RP | |
| 11 | 1 | SEAL (TYPE E) | 951-3161RP | 951-3162RP | 951-2968RP | 951-3782RP | 951-5160RP | 951-5153RP | |
| 40 | 1 | SEAL KIT (TYPE B) SS | 953-1548-1RP | 953-1548-4RP | 953-1548-7RP | 953-1548-10RP | 953-1548-13RP | 953-1548-16RP | |
| 40 | 1 | SEAL KIT (TYPE D) SS | 953-1548-2RP | 953-1548-5RP | 953-1548-8RP | 953-1548-11RP | 953-1548-14RP | 953-1548-17RP | |
| 40 | 1 | SEAL KIT (TYPE E) SS | 953-1548-3RP | 953-1548-6RP | 953-1548-9RP | 953-1548-12RP | 953-1548-15RP | 953-1548-18RP | |

| | | | | | | |
|----|---|-----------------|------------|------------|------------|-----------------|
| 9 | 1 | GASKET (CASING) | SEE PAGE 1 | SEE PAGE 1 | SEE PAGE 1 | EXTERNAL DESIGN |
| 11 | 1 | SEAL (TYPE U) | 953-1326RP | 953-1327RP | 953-1328RP | |
| 11 | 1 | SEAL (TYPE V) | 953-1329RP | 953-1330RP | 953-1331RP | |
| 11 | 1 | SEAL (TYPE W) | 953-1332RP | 953-1333RP | 953-1334RP | |

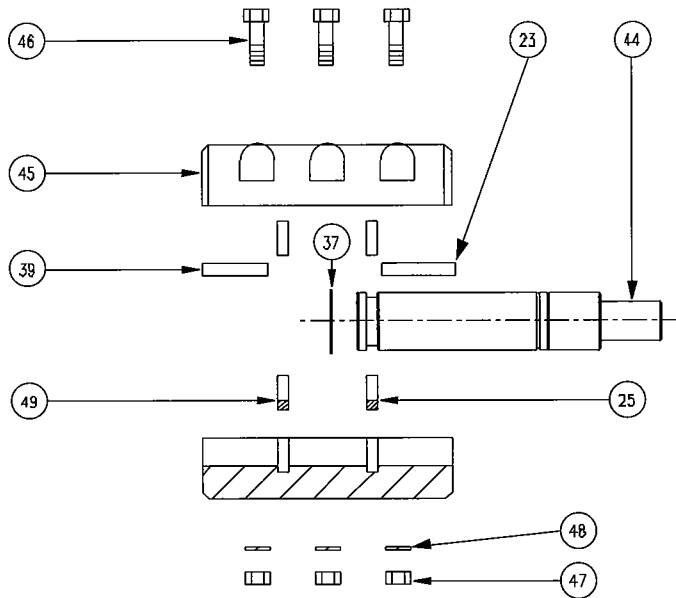

PUMP MODELS

| ITEM NO. | NO. REQ. | DESCRIPTION | PUMP MODELS | | | | |
|----------|----------|----------------------|-------------|------------|------------|------------|------------|
| | | | FRAME B | FRAME C | FRAME D | FRAME E | FRAME F |
| | | | 6009 | 6009 | 6009 | 6009 | ----- |
| | | | 6011 | 6011 | 6011 | 6011 | ----- |
| | | | 3013 | 3013 | 3013 | 3013 | ----- |
| | | | 4013 | 4013 | 4013 | 4013 | ----- |
| | | | 6013 | 6013 | 6013 | 6013 | 6013 |
| | | | ----- | ----- | 8013 | 8013 | 8013 |
| 23 | 1 | KEY-PUMP | HARDWARE | HARDWARE | HARDWARE | HARDWARE | HARDWARE |
| 25 | 1 | CIRCULAR KEY-PUMP | 953-1313RP | 953-1313RP | 953-1314RP | 953-1314RP | 953-1316RP |
| 37 | 1 | RETAINING RING-SEAL | HARDWARE | HARDWARE | HARDWARE | HARDWARE | HARDWARE |
| 39 | 1 | KEY-MOTOR | HARDWARE | HARDWARE | HARDWARE | HARDWARE | HARDWARE |
| 44 | 1 | SHAFT | 953-1298RP | 953-1298RP | 953-1297RP | 953-1297RP | 953-1296RP |
| 45 | 1 | COUPLING | 953-1311RP | 951-202RP | 953-1310RP | 953-1309RP | 953-1527RP |
| 46 | 6 | BOLT-COUPLING | HARDWARE | HARDWARE | HARDWARE | HARDWARE | HARDWARE |
| 47 | 6 | NUT-COUPLING | HARDWARE | HARDWARE | HARDWARE | HARDWARE | HARDWARE |
| 48 | 6 | LOCK WASHER-COUPLING | HARDWARE | HARDWARE | HARDWARE | HARDWARE | HARDWARE |
| 49 | 1 | CIRCULAR KEY-MOTOR | 953-1312RP | 953-1313RP | 953-1313RP | 953-1315RP | 953-1315RP |

Do it ONCE. Do it RIGHT.

TACO, INC., 1160 Cranston Street, Cranston, RI 02920 Telephone: (401) 942-8000 FAX: (401) 942-2360.

TACO (Canada), Ltd., 6180 Ordan Drive, Mississauga, Ontario L5T 2B3. Telephone: 905/564-9422. FAX: 905/564-9436.

Printed in USA
Copyright 1999
TACO, Inc.



Replacement Parts List

5x8

PARTS LIST FOR MODEL : VC-5008

| ITEM NO. | REQUIRED | DESCRIPTION | PART NO. |
|----------|----------|--------------------------|-----------------|
| 1 | 1 | CASING | 31165-135-124-Z |
| 2 | 1 | WEAR RING - BRONZE | 34115-174-445-8 |
| 2 | 1 | WEAR RING - CAST IRON | 34115-174-124-8 |
| 3 | 1 | IMPELLER - BRONZE | 31682-327-445-8 |
| 3 | 1 | IMPELLER - CAST IRON | 31682-327-124-8 |
| 4 | 1 | IMPELLER BOLT | 21763-332-951-7 |
| 5 | 1 | IMPELLER WASHER | 950-046 |
| 6 | 1 | ADAPTOR | 951-210C |
| 7 | 1 | COVER | 950-190 |
| 8 | 1 | SHAFT | 951-203 |
| 9 | 1 | SHAFT SLEEVE | 951-199 |
| 10 | 1 | SHAFT SLEEVE NUT | 951-198 |
| 11 | 1 | SHAFT SLEEVE "O" RING | 951-255 |
| 12 | 1 | RETAINER CAP | 951-204 |
| 13 | 1 | RETAINER CAP GASKET | 951-200 |
| 14 | 1 | SEAL TYPE "B" | 950-665 RP |
| 14 | 1 | SEAL TYPE "D" | 950-668 RP |
| 14 | 1 | SEAL TYPE "E" | 950-671 RP |
| 15 | 2 | SPLIT RING RING PUMP END | 951-201 |
| 16 | 1 | COUPLER KEY | 13-113 |

| | | | |
|----|---|---------------------------|---------|
| 17 | 2 | FOR MOTOR FRAME 213-256 | |
| 18 | 1 | SPLIT RING RING MOTOR END | 951-201 |
| | | COUPLER | 951-202 |

| | | | |
|----|---|---------------------------|---------|
| 17 | 2 | FOR MOTOR FRAME 324-326 | |
| 18 | 1 | SPLIT RING RING MOTOR END | 951-252 |
| 6* | 1 | COUPLER | 951-207 |
| | 1 | ADAPTOR | 951-211 |

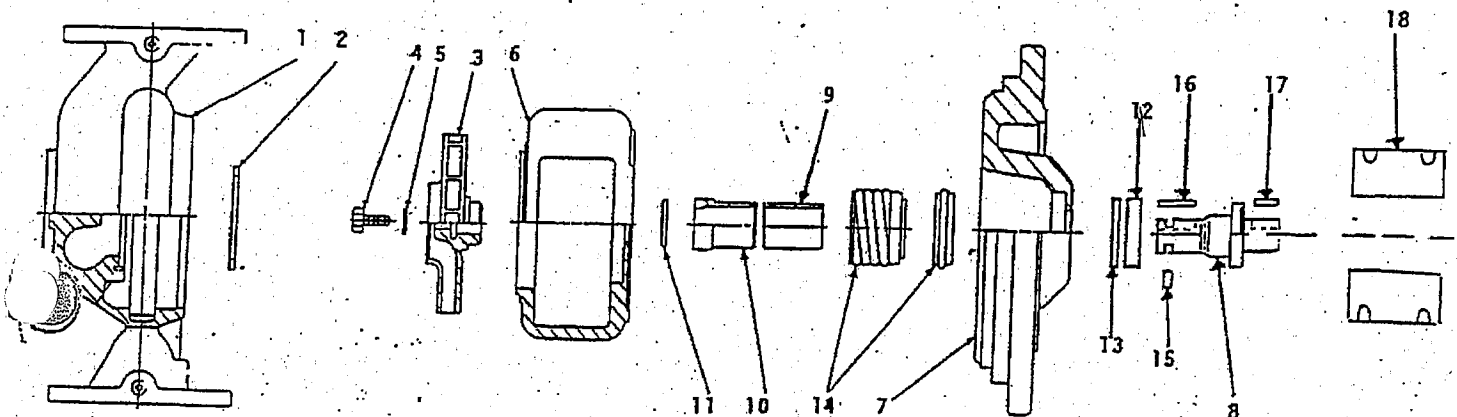



Replacement Parts List

304- 321

VC 6011

WHEN SELECTING AND ORDERING PARTS, ALWAYS REFER TO SERIAL NUMBER ON NAMEPLATE

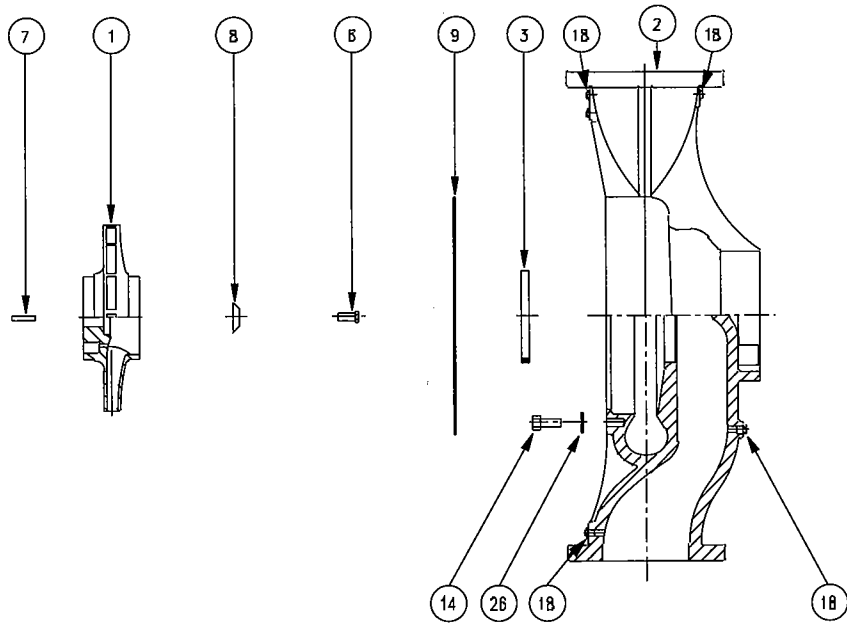
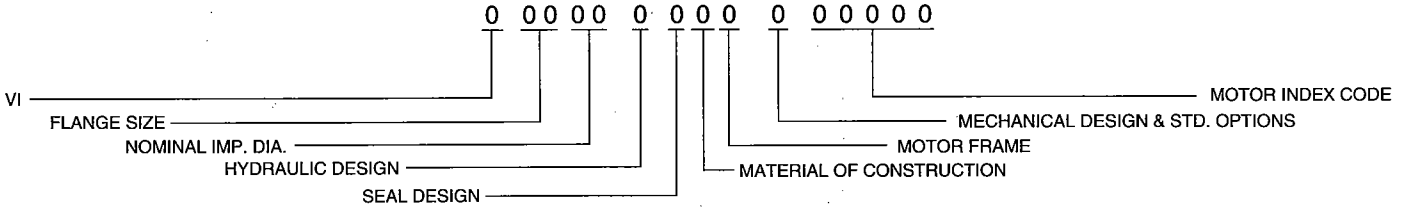

| ITEM NO. | NO. REQ. | DESCRIPTION | 6011 | 6011 | 8011 | 8011 | 8011 | |
|----------|----------|--------------------------|------------------------|--------------|--------------|--------------|------------|--|
| | | | FRAME B OR C | FRAME D OR E | FRAME B OR C | FRAME D OR E | FRAME F | |
| 1 | 1 | IMPELLER (CI) | 953-1100RP | 953-1101RP | ----- | 953-1181RP | 953-1183RP | |
| 1 | 1 | IMPELLER (BRZ) | 953-1102RP | 953-1103RP | ----- | 953-1182RP | 953-1184RP | |
| 2 | 1 | CASING (125#)(W/WR OPT) | 953-1106RP | 953-1106RP | ----- | 953-1115RP | 953-1115RP | |
| 2 | 1 | CASING (250#)(W/WR OPT) | 953-1107RP | 953-1107RP | ----- | 953-1116RP | 953-1116RP | |
| 2 | 1 | CASING (125#)(NO WR STD) | 953-1457RP | 953-1457RP | ----- | 953-1439RP | 953-1439RP | |
| 2 | 1 | CASING (250#)(NO WR STD) | 953-1459RP | 953-1459RP | ----- | 953-1441RP | 953-1441RP | |
| 3 | 1(W/R) | WEAR RING (BRZ) (OPT) | LE5263-12RP | LE5263-12RP | ----- | 953-1180RP | 953-1180RP | |
| 6 | 1 | IMPELLER BOLT | ←----- HARDWARE -----→ | | | | | |
| 7 | 1 | IMPELLER KEY | ←----- HARDWARE -----→ | | | | | |
| 8 | 1 | IMPELLER WASHER | 953-828RP | 953-829RP | ----- | 953-829RP | 953-1099RP | |
| 9 | 1 | GASKET (CASING) | 953-1010RP | 953-1010RP | ----- | 953-1010RP | 953-1010RP | |
| 14 | 12 | CASING BOLT | ←----- HARDWARE -----→ | | | | | |
| 18 | 5 | PIPE PLUG | ←----- HARDWARE -----→ | | | | | |
| 26 | 12 | CASING WASHER | ←----- HARDWARE -----→ | | | | | |

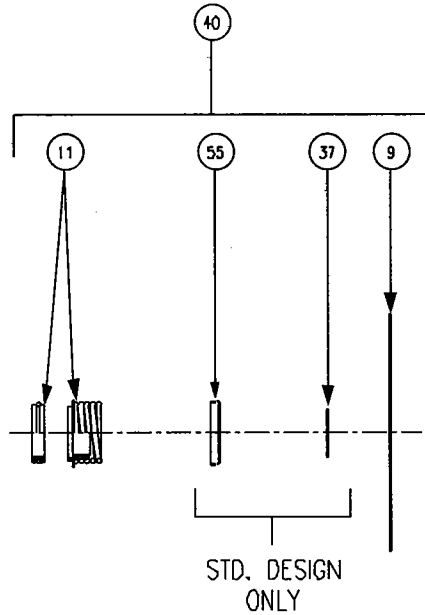

PUMP MODELS

| | | | | | |
|-------|------|------|-------|------|------|
| 6009 | 6009 | 6009 | 6009 | 6009 | 6009 |
| 6011 | 6011 | 6011 | 6011 | 6011 | 6011 |
| 3013 | 3013 | 3013 | 3013 | 3013 | 3013 |
| 4013 | 4013 | 4013 | 4013 | 4013 | 4013 |
| 6013 | 6013 | 6013 | 6013 | 6013 | 6013 |
| ----- | 8013 | 8013 | ----- | 8013 | 8013 |

| ITEM NO. | NO. REQ. | DESCRIPTION | MOTOR FRAME | | | | | |
|----------|----------|----------------------|-------------------------------|--------------|--------------|-------------------------------|---------------|---------------|
| | | | B OR C | | D OR E | | F | |
| | | | MECHANICAL DES. A OR C (125#) | | | MECHANICAL DES. B OR D (250#) | | |
| 9 | 1 | GASKET (CASING) | SEE PAGE 1 | SEE PAGE 1 | SEE PAGE 1 | SEE PAGE 1 | SEE PAGE 1 | SEE PAGE 1 |
| 37 | 1 | RETAINING RING | 15-147 | 15-148 | 15-149 | 15-147 | 15-148 | 15-149 |
| 55 | 1 | SPRINGHOLDER | 953-1529RP | 953-1530RP | 953-1531RP | ----- | ----- | ----- |
| 11 | 1 | SEAL (TYPE B) | 951-3157RP | 951-3158RP | 951-2966RP | 951-3766RP | 951-5158RP | 951-5151RP |
| 11 | 1 | SEAL (TYPE D) | 951-3159RP | 951-3160RP | 951-2967RP | 951-3781RP | 951-5159RP | 951-5152RP |
| 11 | 1 | SEAL (TYPE E) | 951-3161RP | 951-3162RP | 951-2968RP | 951-3782RP | 951-5160RP | 951-5153RP |
| 40 | 1 | SEAL KIT (TYPE B) SS | 953-1548-1RP | 953-1548-4RP | 953-1548-7RP | 953-1548-10RP | 953-1548-13RP | 953-1548-16RP |
| 40 | 1 | SEAL KIT (TYPE D) SS | 953-1548-2RP | 953-1548-5RP | 953-1548-8RP | 953-1548-11RP | 953-1548-14RP | 953-1548-17RP |
| 40 | 1 | SEAL KIT (TYPE E) SS | 953-1548-3RP | 953-1548-6RP | 953-1548-9RP | 953-1548-12RP | 953-1548-15RP | 953-1548-18RP |

STANDARD DESIGN

| | | | | | | |
|----|---|-----------------|------------|------------|------------|-----------------|
| 9 | 1 | GASKET (CASING) | SEE PAGE 1 | SEE PAGE 1 | SEE PAGE 1 | EXTERNAL DESIGN |
| 11 | 1 | SEAL (TYPE U) | 953-1326RP | 953-1327RP | 953-1328RP | |
| 11 | 1 | SEAL (TYPE V) | 953-1329RP | 953-1330RP | 953-1331RP | |
| 11 | 1 | SEAL (TYPE W) | 953-1332RP | 953-1333RP | 953-1334RP | |

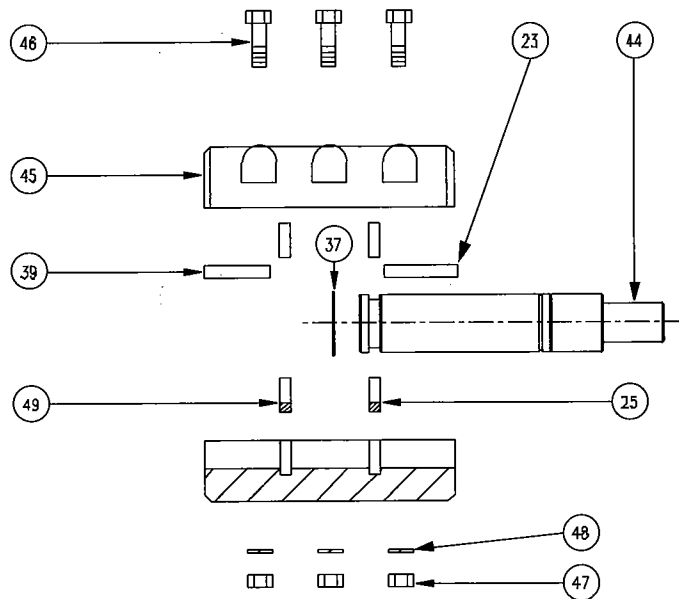

PUMP MODELS

| ITEM NO. | NO. REQ. | DESCRIPTION | PUMP MODELS | | | | |
|----------|----------|----------------------|-------------|------------|------------|------------|------------|
| | | | FRAME B | FRAME C | FRAME D | FRAME E | FRAME F |
| | | | 6009 | 6009 | 6009 | 6009 | ----- |
| | | | 6011 | 6011 | 6011 | 6011 | ----- |
| | | | 3013 | 3013 | 3013 | 3013 | ----- |
| | | | 4013 | 4013 | 4013 | 4013 | ----- |
| | | | 6013 | 6013 | 6013 | 6013 | 6013 |
| | | | ----- | ----- | 8013 | 8013 | 8013 |
| 23 | 1 | KEY-PUMP | HARDWARE | HARDWARE | HARDWARE | HARDWARE | HARDWARE |
| 25 | 1 | CIRCULAR KEY-PUMP | 953-1313RP | 953-1313RP | 953-1314RP | 953-1314RP | 953-1316RP |
| 37 | 1 | RETAINING RING-SEAL | HARDWARE | HARDWARE | HARDWARE | HARDWARE | HARDWARE |
| 39 | 1 | KEY-MOTOR | HARDWARE | HARDWARE | HARDWARE | HARDWARE | HARDWARE |
| 44 | 1 | SHAFT | 953-1298RP | 953-1298RP | 953-1297RP | 953-1297RP | 953-1296RP |
| 45 | 1 | COUPLING | 953-1311RP | 951-202RP | 953-1310RP | 953-1309RP | 953-1527RP |
| 46 | 6 | BOLT-COUPLING | HARDWARE | HARDWARE | HARDWARE | HARDWARE | HARDWARE |
| 47 | 6 | NUT-COUPLING | HARDWARE | HARDWARE | HARDWARE | HARDWARE | HARDWARE |
| 48 | 6 | LOCK WASHER-COUPLING | HARDWARE | HARDWARE | HARDWARE | HARDWARE | HARDWARE |
| 49 | 1 | CIRCULAR KEY-MOTOR | 953-1312RP | 953-1313RP | 953-1313RP | 953-1315RP | 953-1315RP |

Do it ONCE. Do it RIGHT.

TACO, INC., 1160 Cranston Street, Cranston, RI 02920 Telephone: (401) 942-8000 FAX: (401) 942-2360.

TACO (Canada), Ltd., 6180 Ordan Drive, Mississauga, Ontario L5T 2B3. Telephone: 905/564-9422. FAX: 905/564-9436.

Printed in USA
Copyright 1999
TACO, Inc.



Replacement Parts List

304- 325

VC 6013

WHEN SELECTING AND ORDERING PARTS, ALWAYS REFER TO SERIAL NUMBER ON NAMEPLATE

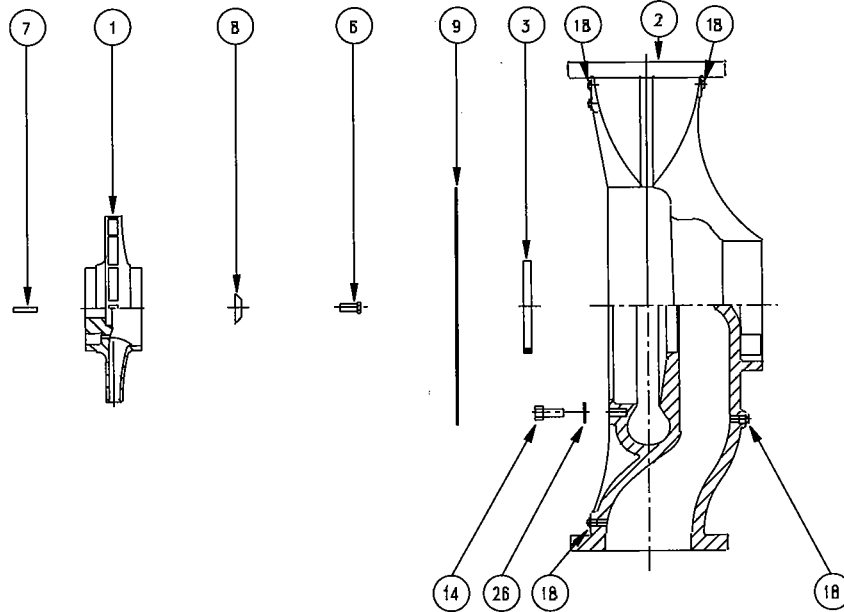
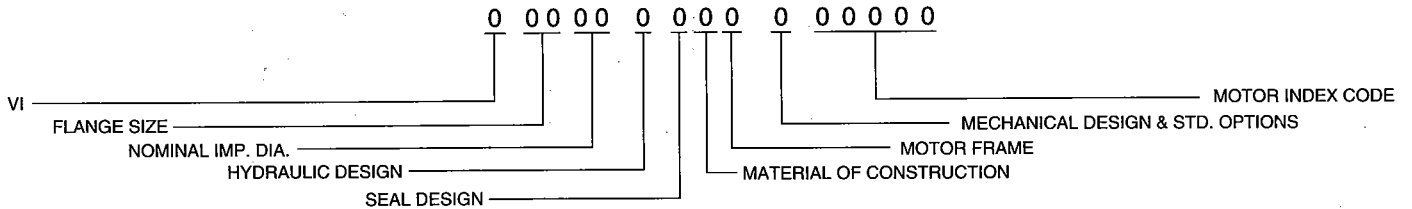

| ITEM NO. | NO. REQ. | DESCRIPTION | 6013 | 6013 | 6013 | 8013 | 8013 | |
|----------|----------|--------------------------|--------------|--------------|------------|--------------|-------------|---|
| | | | FRAME B OR C | FRAME D OR E | FRAME F | FRAME D OR E | FRAME F | |
| 1 | 1 | IMPELLER (CI) | 953-1158RP | 953-1148RP | 953-1156RP | 953-1193RP | 953-1195RP | |
| 1 | 1 | IMPELLER (BRZ) | 953-1159RP | 953-1149RP | 953-1157RP | 953-1194RP | 953-1196RP | |
| 2 | 1 | CASING (125#)(W/WR OPT) | 953-1152RP | 953-1152RP | 953-1152RP | 953-1199RP | 953-1199RP | |
| 2 | 1 | CASING (250#)(W/WR OPT) | 953-1153RP | 953-1153RP | 953-1153RP | 953-1200RP | 953-1200RP | |
| 2 | 1 | CASING (125#)(NO WR STD) | 953-1481RP | 953-1481RP | 953-1481RP | 953-1487RP | 953-1487RP | |
| 2 | 1 | CASING (250#)(NO WR STD) | 953-1483RP | 953-1483RP | 953-1483RP | 953-1489RP | 953-1489RP | |
| 3 | 1(W/R) | WEAR RING (BRZ) (OPT) | 953-1155RP | 953-1155RP | 953-1155RP | LE5319-12RP | LE5319-12RP | |
| 6 | 1 | IMPELLER BOLT | ← HARDWARE → | | | | | → |
| 7 | 1 | IMPELLER KEY | ← HARDWARE → | | | | | → |
| 8 | 1 | IMPELLER WASHER | 953-828RP | 953-829RP | 953-1099RP | 953-829RP | 953-1099RP | |
| 9 | 1 | GASKET (CASING) | 953-1011RP | 953-1011RP | 953-1011RP | 953-1011RP | 953-1011RP | |
| 14 | 16 | CASING BOLT | ← HARDWARE → | | | | | → |
| 18 | 5 | PIPE PLUG | ← HARDWARE → | | | | | → |
| 26 | 16 | CASING WASHER | ← HARDWARE → | | | | | → |

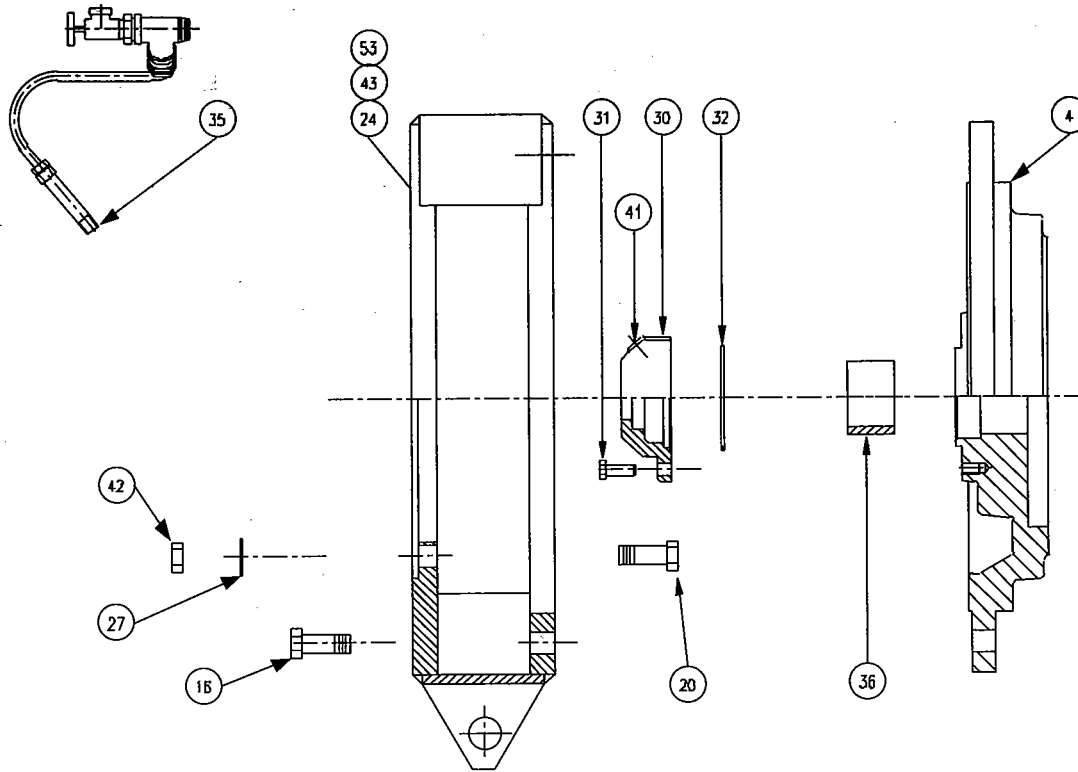

| ITEM NO. | NO. REQ. | DESCRIPTION | 6013 | 6013 | 6013 | 6013 |
|----------|----------|-------------------------|--------------|------------|------------|------------|
| | | | FRAME B OR C | FRAME D | FRAME E | FRAME F |
| 4 | 1 | COVER | 953-1265RP | 953-1262RP | 953-1262RP | 953-1261RP |
| 16 | 8 | COVER SCREW | HARDWARE | HARDWARE | HARDWARE | ----- |
| 20 | 4 | MOTOR BOLT | HARDWARE | HARDWARE | HARDWARE | HARDWARE |
| 24 | 1 | SUPPORT HEAD | 953-1305RP | 953-1303RP | 953-1301RP | 953-1299RP |
| 27 | 4 | MOTOR WASHER | HARDWARE | HARDWARE | HARDWARE | HARDWARE |
| 30 | 1 | SEAL CAP (STD) | 953-728RP | 953-1319RP | 953-1319RP | 953-1318RP |
| 30 | 1 | SEAL CAP (EXTERIOR DES) | 953-1323RP | 953-1324RP | 953-1324RP | 953-1325RP |
| 31 | 2 | SEAL CAP SCREW | HARDWARE | HARDWARE | HARDWARE | HARDWARE |
| 32 | 1 | SEAL CAP GASKET | 953-761RP | 953-762RP | 953-762RP | 953-763RP |
| 35 | 1 | TUBE KIT | 953-1547RP | 953-1547RP | 953-1547RP | 953-1547RP |
| 36 | 1 | THROTTLE BUSHING | 953-1320RP | 953-1321RP | 953-1321RP | 953-1322RP |
| 41 | 1 | SEAL CAP PLUG | HARDWARE | HARDWARE | HARDWARE | HARDWARE |
| 42 | 4 | MOTOR NUT | HARDWARE | HARDWARE | HARDWARE | HARDWARE |
| 43 | 1 | CPLG GUARD | 953-1537RP | 953-1538RP | 953-1536RP | 953-1534RP |
| 53 | 12 | CPLG GUARD SCREW | HARDWARE | HARDWARE | HARDWARE | HARDWARE |
| | | | | | | |
| | | | | | | |
| | | | | | | |

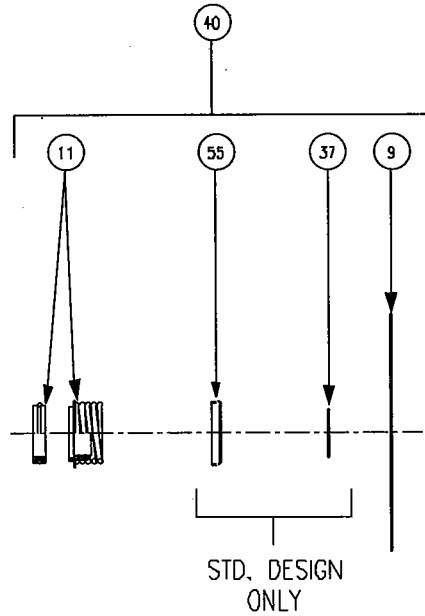

PUMP MODELS

| | | | | | |
|-------|------|------|-------|------|------|
| 6009 | 6009 | 6009 | 6009 | 6009 | 6009 |
| 6011 | 6011 | 6011 | 6011 | 6011 | 6011 |
| 3013 | 3013 | 3013 | 3013 | 3013 | 3013 |
| 4013 | 4013 | 4013 | 4013 | 4013 | 4013 |
| 6013 | 6013 | 6013 | 6013 | 6013 | 6013 |
| ----- | 8013 | 8013 | ----- | 8013 | 8013 |

| ITEM NO. | NO. REQ. | DESCRIPTION | MOTOR FRAME | | | | | |
|----------|----------|----------------------|-------------------------------|--------------|--------------|-------------------------------|---------------|---------------|
| | | | B OR C | D OR E | F | B OR C | D OR E | F |
| | | | MECHANICAL DES. A OR C (125#) | | | MECHANICAL DES. B OR D (250#) | | |
| 9 | 1 | GASKET (CASING) | SEE PAGE 1 | SEE PAGE 1 | SEE PAGE 1 | SEE PAGE 1 | SEE PAGE 1 | SEE PAGE 1 |
| 37 | 1 | RETAINING RING | 15-147 | 15-148 | 15-149 | 15-147 | 15-148 | 15-149 |
| 55 | 1 | SPRINGHOLDER | 953-1529RP | 953-1530RP | 953-1531RP | ----- | ----- | ----- |
| 11 | 1 | SEAL (TYPE B) | 951-3157RP | 951-3158RP | 951-2966RP | 951-3766RP | 951-5158RP | 951-5151RP |
| 11 | 1 | SEAL (TYPE D) | 951-3159RP | 951-3160RP | 951-2967RP | 951-3781RP | 951-5159RP | 951-5152RP |
| 11 | 1 | SEAL (TYPE E) | 951-3161RP | 951-3162RP | 951-2968RP | 951-3782RP | 951-5160RP | 951-5153RP |
| 40 | 1 | SEAL KIT (TYPE B) SS | 953-1548-1RP | 953-1548-4RP | 953-1548-7RP | 953-1548-10RP | 953-1548-13RP | 953-1548-16RP |
| 40 | 1 | SEAL KIT (TYPE D) SS | 953-1548-2RP | 953-1548-5RP | 953-1548-8RP | 953-1548-11RP | 953-1548-14RP | 953-1548-17RP |
| 40 | 1 | SEAL KIT (TYPE E) SS | 953-1548-3RP | 953-1548-6RP | 953-1548-9RP | 953-1548-12RP | 953-1548-15RP | 953-1548-18RP |

STANDARD DESIGN

| | | | | | | |
|----|---|-----------------|------------|------------|------------|-----------------|
| 9 | 1 | GASKET (CASING) | SEE PAGE 1 | SEE PAGE 1 | SEE PAGE 1 | EXTERNAL DESIGN |
| 11 | 1 | SEAL (TYPE U) | 953-1326RP | 953-1327RP | 953-1328RP | |
| 11 | 1 | SEAL (TYPE V) | 953-1329RP | 953-1330RP | 953-1331RP | |
| 11 | 1 | SEAL (TYPE W) | 953-1332RP | 953-1333RP | 953-1334RP | |

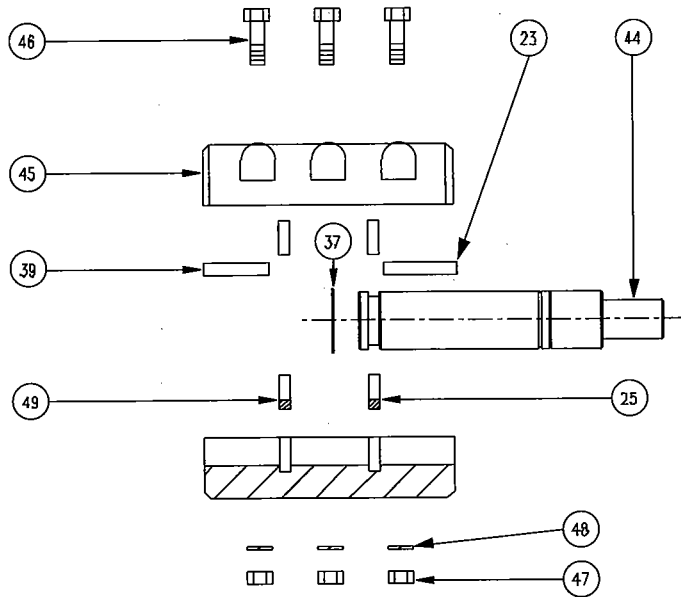

PUMP MODELS

| ITEM NO. | NO. REQ. | DESCRIPTION | PUMP MODELS | | | | |
|----------|----------|----------------------|-------------|------------|------------|------------|------------|
| | | | FRAME B | FRAME C | FRAME D | FRAME E | FRAME F |
| | | | 6009 | 6009 | 6009 | 6009 | ----- |
| | | | 6011 | 6011 | 6011 | 6011 | ----- |
| | | | 3013 | 3013 | 3013 | 3013 | ----- |
| | | | 4013 | 4013 | 4013 | 4013 | ----- |
| | | | 6013 | 6013 | 6013 | 6013 | 6013 |
| | | | ----- | ----- | 8013 | 8013 | 8013 |
| 23 | 1 | KEY-PUMP | HARDWARE | HARDWARE | HARDWARE | HARDWARE | HARDWARE |
| 25 | 1 | CIRCULAR KEY-PUMP | 953-1313RP | 953-1313RP | 953-1314RP | 953-1314RP | 953-1316RP |
| 37 | 1 | RETAINING RING-SEAL | HARDWARE | HARDWARE | HARDWARE | HARDWARE | HARDWARE |
| 39 | 1 | KEY-MOTOR | HARDWARE | HARDWARE | HARDWARE | HARDWARE | HARDWARE |
| 44 | 1 | SHAFT | 953-1298RP | 953-1298RP | 953-1297RP | 953-1297RP | 953-1296RP |
| 45 | 1 | COUPLING | 953-1311RP | 951-202RP | 953-1310RP | 953-1309RP | 953-1527RP |
| 46 | 6 | BOLT-COUPLING | HARDWARE | HARDWARE | HARDWARE | HARDWARE | HARDWARE |
| 47 | 6 | NUT-COUPLING | HARDWARE | HARDWARE | HARDWARE | HARDWARE | HARDWARE |
| 48 | 6 | LOCK WASHER-COUPLING | HARDWARE | HARDWARE | HARDWARE | HARDWARE | HARDWARE |
| 49 | 1 | CIRCULAR KEY-MOTOR | 953-1312RP | 953-1313RP | 953-1313RP | 953-1315RP | 953-1315RP |

DO IT ONCE. DO IT RIGHT.

TACO, INC., 1160 Cranston Street, Cranston, RI 02920 Telephone: (401) 942-8000 FAX: (401) 942-2360.

TACO (Canada), Ltd., 6180 Ordan Drive, Mississauga, Ontario L5T 2B3. Telephone: 905/564-9422. FAX: 905/564-9436.

Printed in USA
Copyright 1999
TACO, Inc.



Replacement Parts List

304-322

VC 8011

WHEN SELECTING AND ORDERING PARTS, ALWAYS REFER TO SERIAL NUMBER ON NAMEPLATE

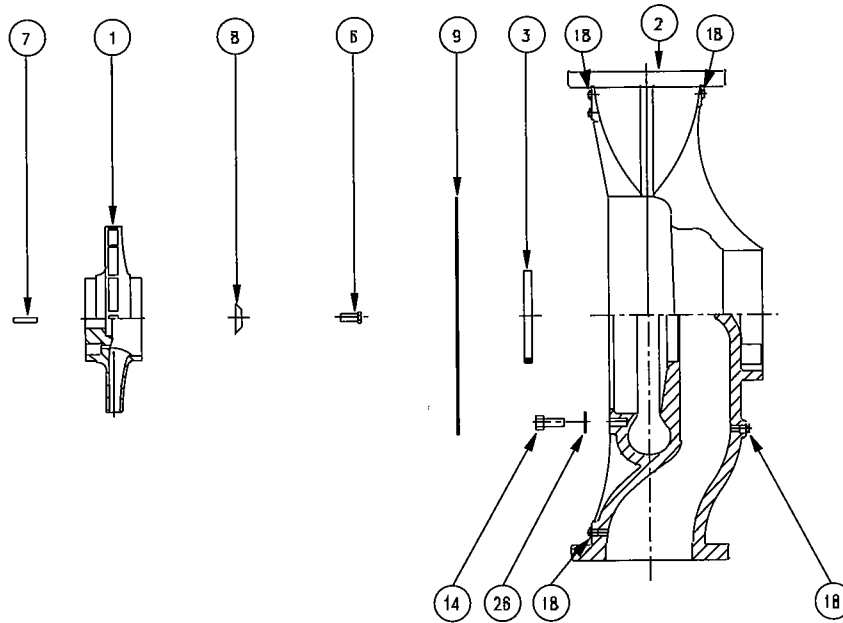
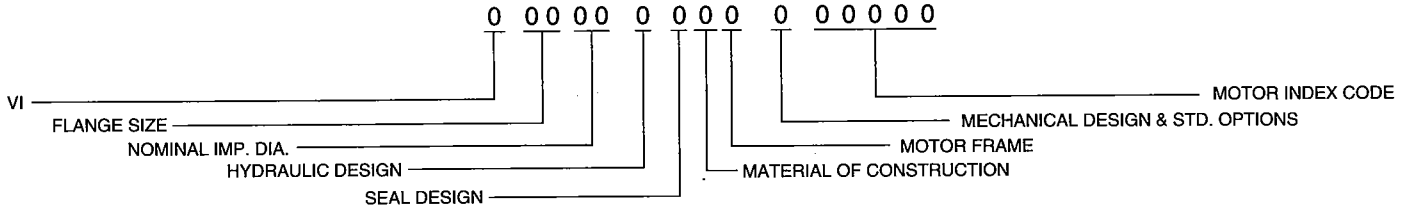

| ITEM NO. | NO. REQ. | DESCRIPTION | 6011 | 6011 | 8011 | 8011 | 8011 | |
|----------|----------|--------------------------|------------------------|--------------|--------------|--------------|------------|---|
| | | | FRAME B OR C | FRAME D OR E | FRAME B OR C | FRAME D OR E | FRAME F | |
| 1 | 1 | IMPELLER (CI) | 953-1100RP | 953-1101RP | ----- | 953-1181RP | 953-1183RP | |
| 1 | 1 | IMPELLER (BRZ) | 953-1102RP | 953-1103RP | ----- | 953-1182RP | 953-1184RP | |
| 2 | 1 | CASING (125#)(W/WR OPT) | 953-1106RP | 953-1106RP | ----- | 953-1115RP | 953-1115RP | |
| 2 | 1 | CASING (250#)(W/WR OPT) | 953-1107RP | 953-1107RP | ----- | 953-1116RP | 953-1116RP | |
| 2 | 1 | CASING (125#)(NO WR STD) | 953-1457RP | 953-1457RP | ----- | 953-1439RP | 953-1439RP | |
| 2 | 1 | CASING (250#)(NO WR STD) | 953-1459RP | 953-1459RP | ----- | 953-1441RP | 953-1441RP | |
| 3 | 1(W/R) | WEAR RING (BRZ) (OPT) | LE5263-12RP | LE5263-12RP | ----- | 953-1180RP | 953-1180RP | |
| 6 | 1 | IMPELLER BOLT | ←----- HARDWARE -----→ | | | | | → |
| 7 | 1 | IMPELLER KEY | ←----- HARDWARE -----→ | | | | | → |
| 8 | 1 | IMPELLER WASHER | 953-828RP | 953-829RP | ----- | 953-829RP | 953-1099RP | |
| 9 | 1 | GASKET (CASING) | 953-1010RP | 953-1010RP | ----- | 953-1010RP | 953-1010RP | |
| 14 | 12 | CASING BOLT | ←----- HARDWARE -----→ | | | | | → |
| 18 | 5 | PIPE PLUG | ←----- HARDWARE -----→ | | | | | → |
| 26 | 12 | CASING WASHER | ←----- HARDWARE -----→ | | | | | → |

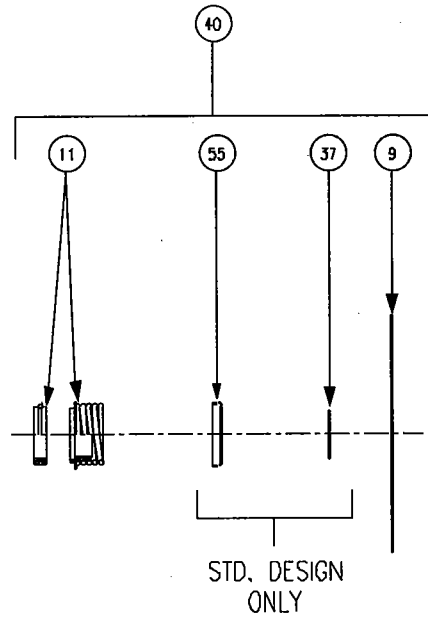

PUMP MODELS

| | | | | | |
|-------|------|------|-------|------|------|
| 6009 | 6009 | 6009 | 6009 | 6009 | 6009 |
| 6011 | 6011 | 6011 | 6011 | 6011 | 6011 |
| ----- | 8011 | 8011 | ----- | 8011 | 8011 |
| 3013 | 3013 | 3013 | 3013 | 3013 | 3013 |
| 4013 | 4013 | 4013 | 4013 | 4013 | 4013 |
| 6013 | 6013 | 6013 | 6013 | 6013 | 6013 |
| ----- | 8013 | 8013 | ----- | 8013 | 8013 |

| ITEM NO. | NO. REQ. | DESCRIPTION | MOTOR FRAME | | | | | |
|----------|----------|----------------------|-------------------------------|--------------|--------------|-------------------------------|---------------|---------------|
| | | | B OR C | D OR E | F | B OR C | D OR E | F |
| | | | MECHANICAL DES. A OR C (125#) | | | MECHANICAL DES. B OR D (250#) | | |
| 9 | 1 | GASKET (CASING) | SEE PAGE 1 | SEE PAGE 1 | SEE PAGE 1 | SEE PAGE 1 | SEE PAGE 1 | SEE PAGE 1 |
| 37 | 1 | RETAINING RING | 15-147 | 15-148 | 15-149 | 15-147 | 15-148 | 15-149 |
| 55 | 1 | SPRINGHOLDER | 953-1529RP | 953-1530RP | 953-1531RP | ----- | ----- | ----- |
| 11 | 1 | SEAL (TYPE B) | 951-3157RP | 951-3158RP | 951-2966RP | 951-3766RP | 951-5158RP | 951-5151RP |
| 11 | 1 | SEAL (TYPE D) | 951-3159RP | 951-3160RP | 951-2967RP | 951-3781RP | 951-5159RP | 951-5152RP |
| 11 | 1 | SEAL (TYPE E) | 951-3161RP | 951-3162RP | 951-2968RP | 951-3782RP | 951-5160RP | 951-5153RP |
| 40 | 1 | SEAL KIT (TYPE B) SS | 953-1548-1RP | 953-1548-4RP | 953-1548-7RP | 953-1548-10RP | 953-1548-13RP | 953-1548-16RP |
| 40 | 1 | SEAL KIT (TYPE D) SS | 953-1548-2RP | 953-1548-5RP | 953-1548-8RP | 953-1548-11RP | 953-1548-14RP | 953-1548-17RP |
| 40 | 1 | SEAL KIT (TYPE E) SS | 953-1548-3RP | 953-1548-6RP | 953-1548-9RP | 953-1548-12RP | 953-1548-15RP | 953-1548-18RP |

STANDARD DESIGN

| | | | | | | |
|----|---|-----------------|------------|------------|------------|-----------------|
| 9 | 1 | GASKET (CASING) | SEE PAGE 1 | SEE PAGE 1 | SEE PAGE 1 | EXTERNAL DESIGN |
| 11 | 1 | SEAL (TYPE U) | 953-1326RP | 953-1327RP | 953-1328RP | |
| 11 | 1 | SEAL (TYPE V) | 953-1329RP | 953-1330RP | 953-1331RP | |
| 11 | 1 | SEAL (TYPE W) | 953-1332RP | 953-1333RP | 953-1334RP | |

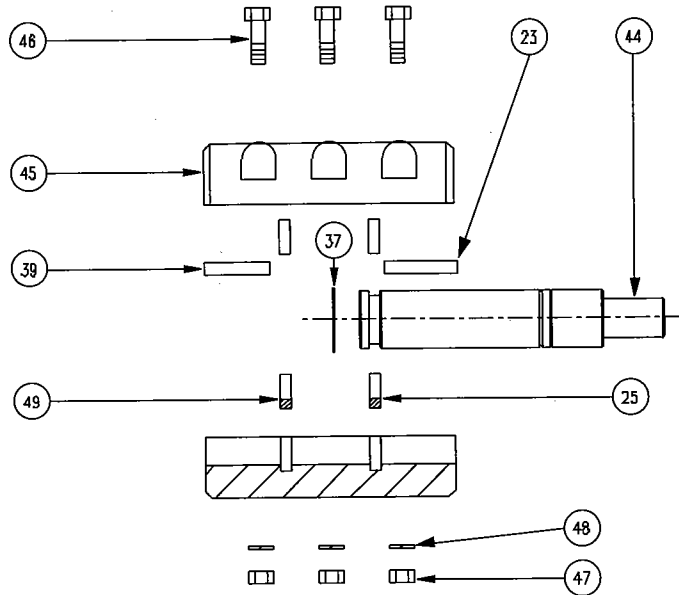

| PUMP MODELS | | | | | | | |
|-------------|----------|----------------------|------------|------------|------------|------------|------------|
| ITEM NO. | NO. REQ. | DESCRIPTION | 6009 | 6009 | 6009 | 6009 | ----- |
| | | | 6011 | 6011 | 6011 | 6011 | ----- |
| | | | ----- | ----- | 8011 | 8011 | 8011 |
| | | | 3013 | 3013 | 3013 | 3013 | ----- |
| | | | 4013 | 4013 | 4013 | 4013 | ----- |
| | | | 6013 | 6013 | 6013 | 6013 | 6013 |
| | | | ----- | ----- | 8013 | 8013 | 8013 |
| | | | FRAME B | FRAME C | FRAME D | FRAME E | FRAME F |
| 23 | 1 | KEY-PUMP | HARDWARE | HARDWARE | HARDWARE | HARDWARE | HARDWARE |
| 25 | 1 | CIRCULAR KEY-PUMP | 953-1313RP | 953-1313RP | 953-1314RP | 953-1314RP | 953-1316RP |
| 37 | 1 | RETAINING RING-SEAL | HARDWARE | HARDWARE | HARDWARE | HARDWARE | HARDWARE |
| 39 | 1 | KEY-MOTOR | HARDWARE | HARDWARE | HARDWARE | HARDWARE | HARDWARE |
| 44 | 1 | SHAFT | 953-1298RP | 953-1298RP | 953-1297RP | 953-1297RP | 953-1296RP |
| 45 | 1 | COUPLING | 953-1311RP | 951-202RP | 953-1310RP | 953-1309RP | 953-1527RP |
| 46 | 6 | BOLT-COUPLING | HARDWARE | HARDWARE | HARDWARE | HARDWARE | HARDWARE |
| 47 | 6 | NUT-COUPLING | HARDWARE | HARDWARE | HARDWARE | HARDWARE | HARDWARE |
| 48 | 6 | LOCK WASHER-COUPLING | HARDWARE | HARDWARE | HARDWARE | HARDWARE | HARDWARE |
| 49 | 1 | CIRCULAR KEY-MOTOR | 953-1312RP | 953-1313RP | 953-1313RP | 953-1315RP | 953-1315RP |

Do it ONCE. Do it RIGHT.

TACO, INC., 1160 Cranston Street, Cranston, RI 02920 Telephone: (401) 942-8000 FAX: (401) 942-2360.

TACO (Canada), Ltd., 6180 Ordan Drive, Mississauga, Ontario L5T 2B3. Telephone: 905/564-9422. FAX: 905/564-9436.

Printed in USA
Copyright 1999
TACO, Inc.



Replacement Parts List

304- 326

VC 8013

WHEN SELECTING AND ORDERING PARTS, ALWAYS REFER TO SERIAL NUMBER ON NAMEPLATE

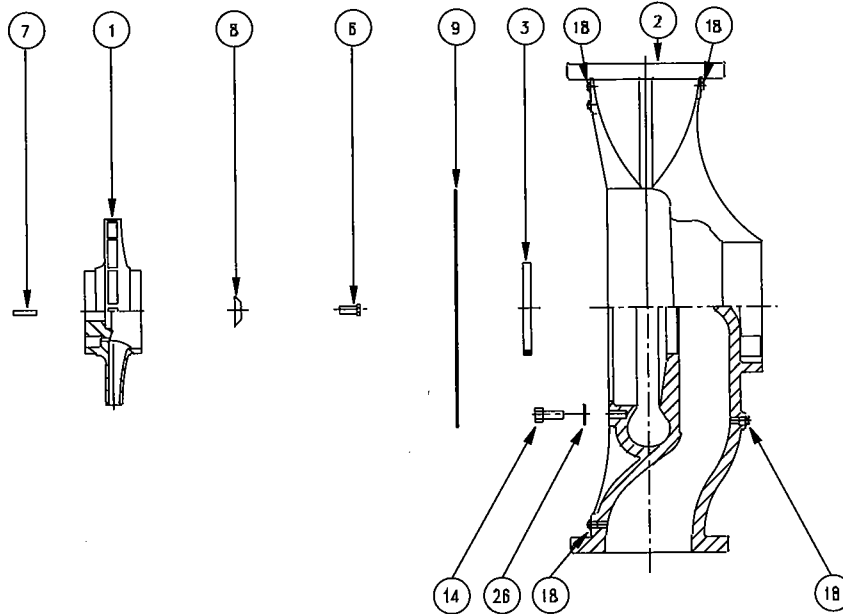
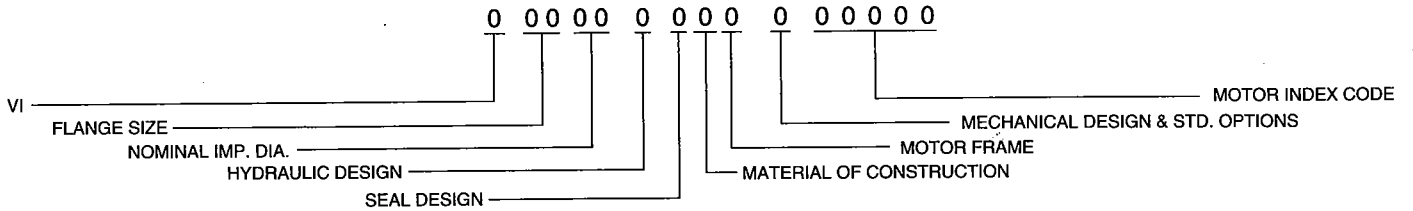

| ITEM NO. | NO. REQ. | DESCRIPTION | 6013 | 6013 | 6013 | 8013 | 8013 | |
|----------|----------|--------------------------|--------------|--------------|------------|--------------|-------------|---|
| | | | FRAME B OR C | FRAME D OR E | FRAME F | FRAME D OR E | FRAME F | |
| 1 | 1 | IMPELLER (CI) | 953-1158RP | 953-1148RP | 953-1156RP | 953-1193RP | 953-1195RP | |
| 1 | 1 | IMPELLER (BRZ) | 953-1159RP | 953-1149RP | 953-1157RP | 953-1194RP | 953-1196RP | |
| 2 | 1 | CASING (125#)(W/WR OPT) | 953-1152RP | 953-1152RP | 953-1152RP | 953-1199RP | 953-1199RP | |
| 2 | 1 | CASING (250#)(W/WR OPT) | 953-1153RP | 953-1153RP | 953-1153RP | 953-1200RP | 953-1200RP | |
| 2 | 1 | CASING (125#)(NO WR STD) | 953-1481RP | 953-1481RP | 953-1481RP | 953-1487RP | 953-1487RP | |
| 2 | 1 | CASING (250#)(NO WR STD) | 953-1483RP | 953-1483RP | 953-1483RP | 953-1489RP | 953-1489RP | |
| 3 | 1(W/R) | WEAR RING (BRZ) (OPT) | 953-1155RP | 953-1155RP | 953-1155RP | LE5319-12RP | LE5319-12RP | |
| 6 | 1 | IMPELLER BOLT | ← HARDWARE → | | | | | → |
| 7 | 1 | IMPELLER KEY | ← HARDWARE → | | | | | → |
| 8 | 1 | IMPELLER WASHER | 953-828RP | 953-829RP | 953-1099RP | 953-829RP | 953-1099RP | |
| 9 | 1 | GASKET (CASING) | 953-1011RP | 953-1011RP | 953-1011RP | 953-1011RP | 953-1011RP | |
| 14 | 16 | CASING BOLT | ← HARDWARE → | | | | | → |
| 18 | 5 | PIPE PLUG | ← HARDWARE → | | | | | → |
| 26 | 16 | CASING WASHER | ← HARDWARE → | | | | | → |

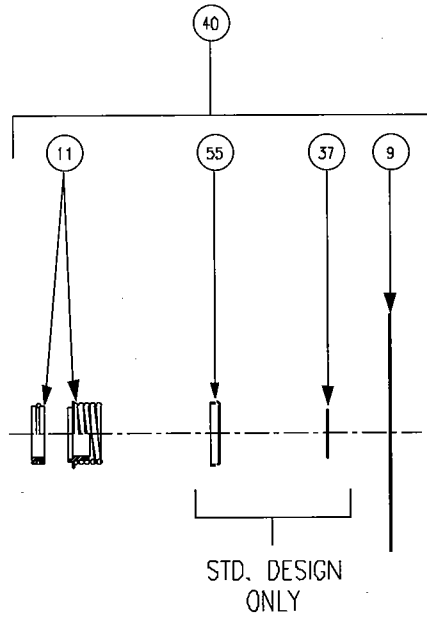

| PUMP MODELS | | | | | |
|--------------------|------|------|-------|------|------|
| 6009 | 6009 | 6009 | 6009 | 6009 | 6009 |
| 6011 | 6011 | 6011 | 6011 | 6011 | 6011 |
| 3013 | 3013 | 3013 | 3013 | 3013 | 3013 |
| 4013 | 4013 | 4013 | 4013 | 4013 | 4013 |
| 6013 | 6013 | 6013 | 6013 | 6013 | 6013 |
| ----- | 8013 | 8013 | ----- | 8013 | 8013 |

| ITEM NO. | NO. REQ. | DESCRIPTION | MOTOR FRAME | | | | | |
|----------|----------|----------------------|-------------------------------|--------------|--------------|-------------------------------|---------------|---------------|
| | | | B OR C | D OR E | F | B OR C | D OR E | F |
| | | | MECHANICAL DES. A OR C (125#) | | | MECHANICAL DES. B OR D (250#) | | |
| 9 | 1 | GASKET (CASING) | SEE PAGE 1 | SEE PAGE 1 | SEE PAGE 1 | SEE PAGE 1 | SEE PAGE 1 | SEE PAGE 1 |
| 37 | 1 | RETAINING RING | 15-147 | 15-148 | 15-149 | 15-147 | 15-148 | 15-149 |
| 55 | 1 | SPRINGHOLDER | 953-1529RP | 953-1530RP | 953-1531RP | ----- | ----- | ----- |
| 11 | 1 | SEAL (TYPE B) | 951-3157RP | 951-3158RP | 951-2966RP | 951-3766RP | 951-5158RP | 951-5151RP |
| 11 | 1 | SEAL (TYPE D) | 951-3159RP | 951-3160RP | 951-2967RP | 951-3781RP | 951-5159RP | 951-5152RP |
| 11 | 1 | SEAL (TYPE E) | 951-3161RP | 951-3162RP | 951-2968RP | 951-3782RP | 951-5160RP | 951-5153RP |
| 40 | 1 | SEAL KIT (TYPE B) SS | 953-1548-1RP | 953-1548-4RP | 953-1548-7RP | 953-1548-10RP | 953-1548-13RP | 953-1548-16RP |
| 40 | 1 | SEAL KIT (TYPE D) SS | 953-1548-2RP | 953-1548-5RP | 953-1548-8RP | 953-1548-11RP | 953-1548-14RP | 953-1548-17RP |
| 40 | 1 | SEAL KIT (TYPE E) SS | 953-1548-3RP | 953-1548-6RP | 953-1548-9RP | 953-1548-12RP | 953-1548-15RP | 953-1548-18RP |

STANDARD DESIGN

| | | | | | | |
|----|---|-----------------|------------|------------|------------|-----------------|
| 9 | 1 | GASKET (CASING) | SEE PAGE 1 | SEE PAGE 1 | SEE PAGE 1 | EXTERNAL DESIGN |
| 11 | 1 | SEAL (TYPE U) | 953-1326RP | 953-1327RP | 953-1328RP | |
| 11 | 1 | SEAL (TYPE V) | 953-1329RP | 953-1330RP | 953-1331RP | |
| 11 | 1 | SEAL (TYPE W) | 953-1332RP | 953-1333RP | 953-1334RP | |

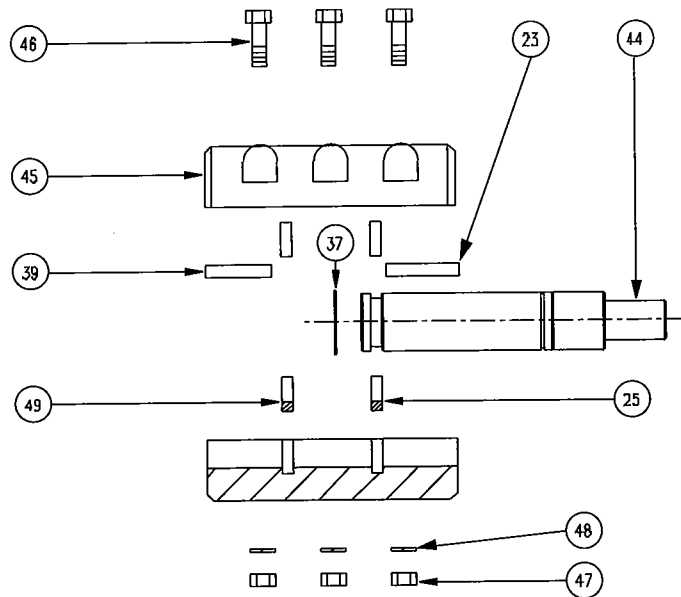

PUMP MODELS

| ITEM NO. | NO. REQ. | DESCRIPTION | PUMP MODELS | | | | |
|----------|----------|----------------------|-------------|------------|------------|------------|------------|
| | | | FRAME B | FRAME C | FRAME D | FRAME E | FRAME F |
| | | | 6009 | 6009 | 6009 | 6009 | ----- |
| | | | 6011 | 6011 | 6011 | 6011 | ----- |
| | | | 3013 | 3013 | 3013 | 3013 | ----- |
| | | | 4013 | 4013 | 4013 | 4013 | ----- |
| | | | 6013 | 6013 | 6013 | 6013 | 6013 |
| | | | ----- | ----- | 8013 | 8013 | 8013 |
| 23 | 1 | KEY-PUMP | HARDWARE | HARDWARE | HARDWARE | HARDWARE | HARDWARE |
| 25 | 1 | CIRCULAR KEY-PUMP | 953-1313RP | 953-1313RP | 953-1314RP | 953-1314RP | 953-1316RP |
| 37 | 1 | RETAINING RING-SEAL | HARDWARE | HARDWARE | HARDWARE | HARDWARE | HARDWARE |
| 39 | 1 | KEY-MOTOR | HARDWARE | HARDWARE | HARDWARE | HARDWARE | HARDWARE |
| 44 | 1 | SHAFT | 953-1298RP | 953-1298RP | 953-1297RP | 953-1297RP | 953-1296RP |
| 45 | 1 | COUPLING | 953-1311RP | 951-202RP | 953-1310RP | 953-1309RP | 953-1527RP |
| 46 | 6 | BOLT-COUPLING | HARDWARE | HARDWARE | HARDWARE | HARDWARE | HARDWARE |
| 47 | 6 | NUT-COUPLING | HARDWARE | HARDWARE | HARDWARE | HARDWARE | HARDWARE |
| 48 | 6 | LOCK WASHER-COUPLING | HARDWARE | HARDWARE | HARDWARE | HARDWARE | HARDWARE |
| 49 | 1 | CIRCULAR KEY-MOTOR | 953-1312RP | 953-1313RP | 953-1313RP | 953-1315RP | 953-1315RP |

Do it ONCE. Do it RIGHT.

TACO, INC., 1160 Cranston Street, Cranston, RI 02920 Telephone: (401) 942-8000 FAX: (401) 942-2360.

TACO (Canada), Ltd., 6180 Ordan Drive, Mississauga, Ontario L5T 2B3. Telephone: 905/564-9422. FAX: 905/564-9436.

Printed in USA
Copyright 1999
TACO, Inc.