

P382XPRG102 (B94)

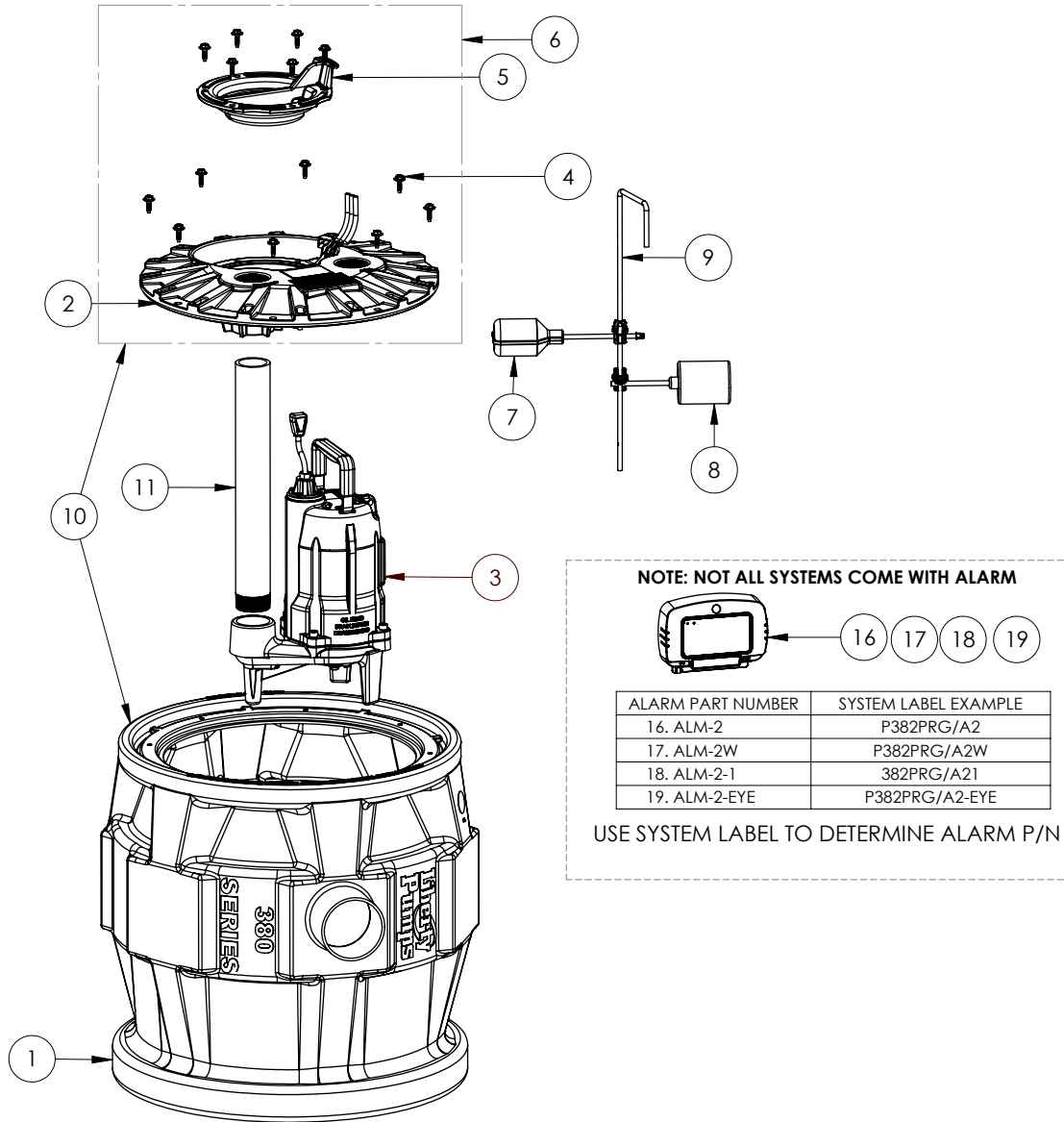

P382XPRG102 (B94)

| # | PART # | DESCRIPTION | QTY | Note |
|----|-------------------------------|--|-----|------|
| 1 | K001133 | 380XL TANK 16 BOLTS | 1 | |
| 2 | 50340B0 | 2X2 COVER, 16 BOLT | 1 | |
| 3 | SEE NOTE FOR PUMP MODEL # | LIBERTY PUMP | 1 | [1] |
| 4 | 8155000 | WASHER HEAD HEX SCREW | 22 | |
| 5 | K001233 | INSPECTION COVER, INCLUDES MOUNTING SCREWS (6) | 1 | |
| 6 | K001127 | 2X2 COVER ASSEMBLY, 16 BOLT, PVC | 1 | |
| 7 | Pro Series Alarm switch (B94) | REPLACEMENT SWITCH BASED ON SYSTEM LABEL | 1 | [2] |
| 8 | SEE NOTE FOR PUMP SWITCH | PUMP SWITCH ONLY | 1 | [3] |
| 9 | K001123 | QUICKTREE KIT, ROD & CLAMPS ONLY | 1 | |
| 10 | K001137 | P382XL TANK AND COVER | 1 | |
| 11 | K001399 | PRO SERIES PIPE KIT 2" SCH80 X17.50" | 1 | |
| 16 | ALM-2 | ALARM 115V SWT-ACTV 20' | 1 | |
| 17 | ALM-2W | 115V ALARM, WEATHERPROOF | 1 | |
| 18 | ALM-2-1 | ALARM 115V 10FT CORD | 1 | |
| 19 | ALM-2-EYE | ALARM 115V SWT-ACTV 20' NIGHTEYE | 1 | |
| 20 | K001134 | FLOAT SWITCH, 20FT CORD, INCLUDES 1 SWITCH PER KIT | 1 | |
| 21 | K001566 | KIT, SWITCH PILOT DUTY, 10' 3-PIN | 1 | |
| 22 | K001569 | KIT, SWITCH PILOT DUTY, 20' 3-PIN | 1 | |

PART NOTES:

[1] - Part requires factory authorized service. Contact Liberty Pumps at 1-800-543-2550

****NOTE****

Select PROSERIES Pump below to show sewage pump assembly parts

ex: P382XPRG101/A2

PRG101M

PRG101M-2

[2] - ****NOTE****

ALARM SWITCH KITS

For /A2 Suffix of model number use Part No. K001569

For /A21 Suffix of model number use Part No. K001566

For /A2W Suffix of model number use Part No. K001134

For /A2-EYE Suffix of model number use Part No. K001569

P382XPRG102 (B94)

- [3] - Part requires factory authorized service. Contact Liberty Pumps at 1-800-543-2550

****NOTE****

Switch Kits:

for pump PRG102: K001019

for pump PRG102-2: K001431