

REPLACEMENT PARTS

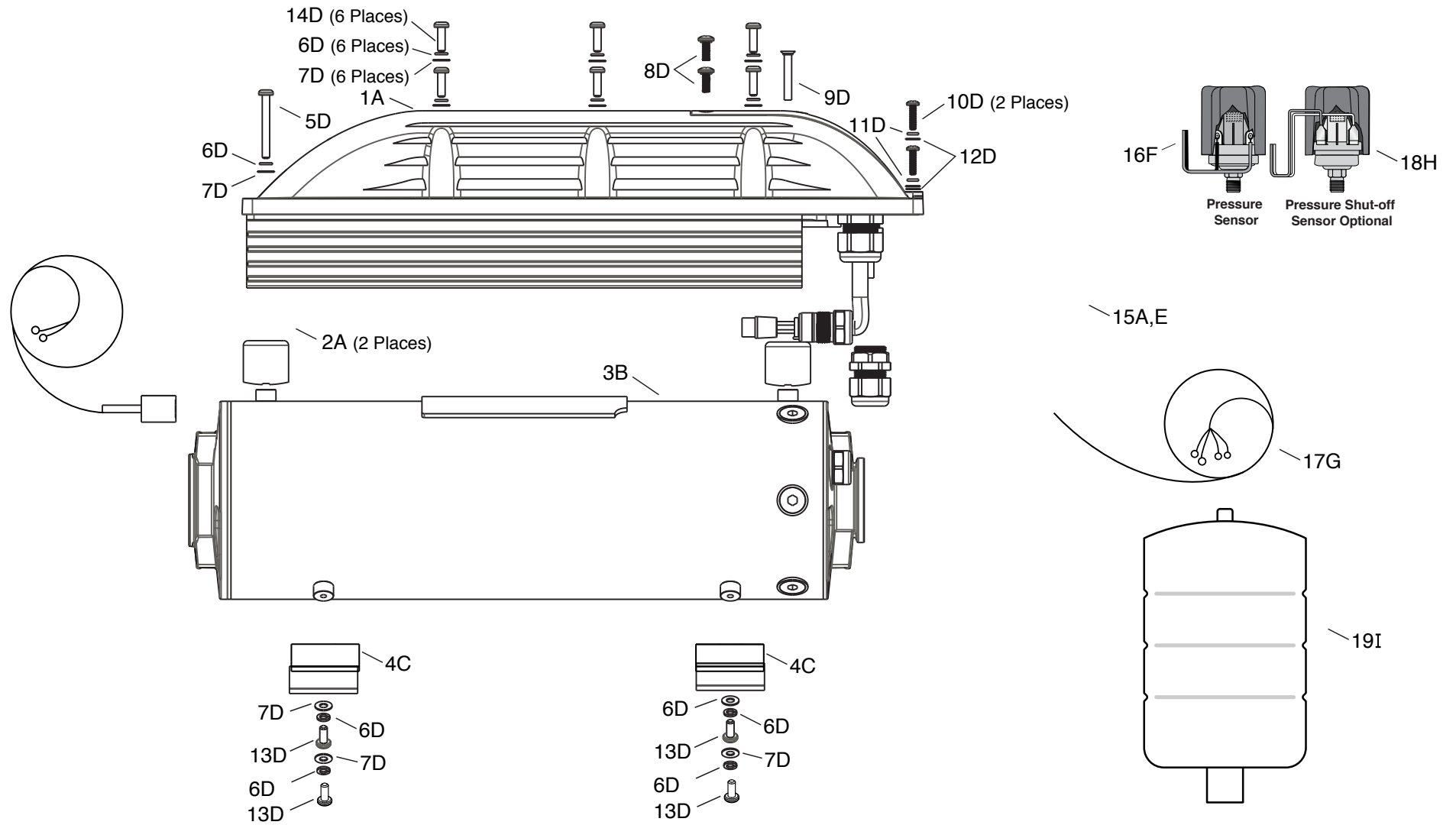

REPLACEMENT PARTS - CONTINUED

Spare Parts Kits for Inline 1100: FE			
Number	Description	Kit Grouping Identifier	Repair Part Order Codes
1	Drive Assembly	A*	305707901
2	Mounting Posts		
3	Pump Motor Assembly	B*	305707902
4	Mounting Feet	C*	305707903
5	#10-24x1.625 Pan Head Torx	D	305707904
6	#10 Lock Washer		
7	#10 Flat Washer		
8	#8-32x0.438 Pan Head Phillips Sealing		
9	#10-24x1.25 Flat Head Phillips Sealing		
10	#8-32x0.625 Pan Head Phillips		
11	#8 Lock Washer		
12	#8 Flat Washer		
13	#10-24x0.438 Pan Head Torx		
14	#10-24x0.625 Pan Head Torx		
15	Pressure Switch Cable (2 Wires)	A,E	305707905
16	Pressure Switch	F	305707906
17	Pressure Switch Cable (4 Wires)	G	305707908
18	Overpressure Switch	H	305707909
19	2 Gallon Pump Tank Kit	I	305707910
20	Over-Temperature Switch	J	305707916

Spare Parts Kits for Inline 1100: LG			
Number	Description	Kit Grouping Identifier	Repair Part Order Codes
1	Drive Assembly	A*	305707907
2	Mounting Posts		
3	Pump Motor Assembly	B*	305707902
4	Mounting Feet	C*	305707903
5	#10-24x1.625 Pan Head Torx	D	305707904
6	#10 Lock Washer		
7	#10 Flat Washer		
8	#8-32x0.438 Pan Head Phillips Sealing		
9	#10-24x1.25 Flat Head Phillips Sealing		
10	#8-32x0.625 Pan Head Phillips		
11	#8 Lock Washer		
12	#8 Flat Washer		
13	#10-24x0.438 Pan Head Torx		
14	#10-24x0.625 Pan Head Torx		
15	Pressure Switch Cable (2 Wires)	A, E	305707905
16	Pressure Switch	F	305707906
17	Pressure Switch Cable (4 Wires)	G	305707908
18	Overpressure Switch	H	305707909
19	2 Gallon Pump Tank Kit	I	14942302
20	Over-Temperature Switch	J	305707916

(1) * Item ships with fastener kit D