



Submittal Data Information

KS Series Vertical Split Coupled Pumps

301-1714

EFFECTIVE: MAY 31, 2017

SUPERSEDES: JUNE 25, 2016

1160 RPM MODEL 1213B

JOB _____ ENGINEER _____

CONTRACTOR _____ REP. _____

ITEM NO.	MODEL NO.	IMPELLER DIA.	G.P.M.	HEAD/FT.	H.P.	ELEC. CHAR.
----------	-----------	---------------	--------	----------	------	-------------

WEIGHT _____ PUMP/MOTOR _____

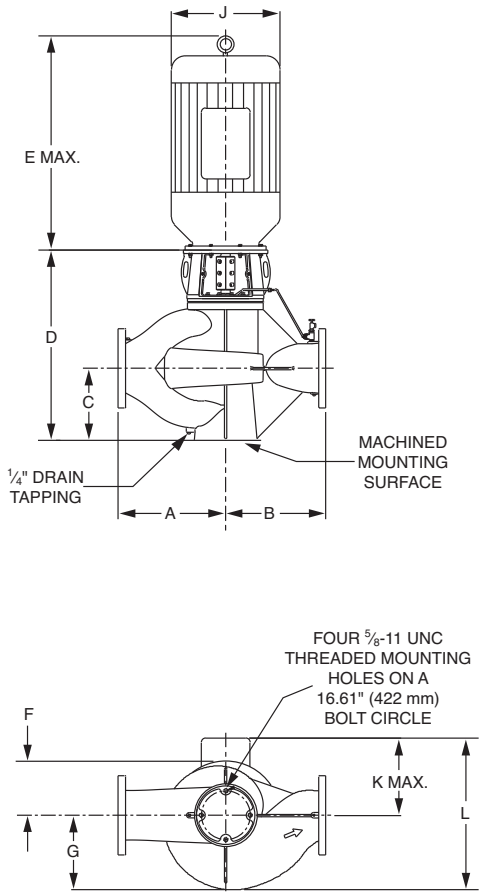

PUMP WITH OPTIONAL SUPPORT STAND

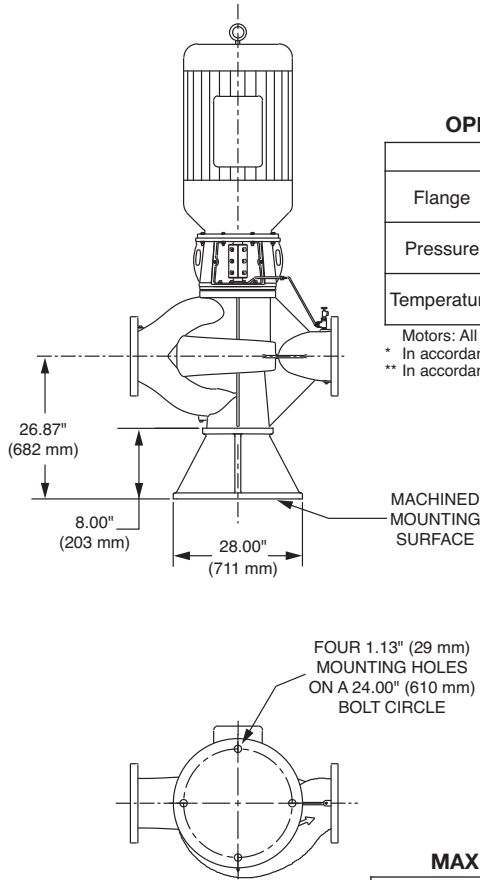

OPERATING SPECIFICATIONS

	Standard		Optional
	ANSI Class 125	ANSI Class 250	
Flange	ANSI Class 125	ANSI Class 250	
Pressure	175 PSIG* (1210 KPA)	300 PSIG** (2070 KPA)	CF
Temperature	250°F (120°C)	250°F (120°C)	CF

Motors: All NEMA Standard ODP Frame (CZ Shaft)
 * In accordance with ANSI Standard B16.1 Class 125
 ** In accordance with ANSI Standard B16.1 Class 250 Dim.

SUPPORT STAND OPTION	
Support Stand	Ductile Iron ASTM A536-84 Grade 65-45-12
<input type="checkbox"/>	<input type="checkbox"/>
YES	NO

MAXIMUM ASSEMBLY WEIGHT

Motor Frame	Weight without Optional Stand Lbs (Kg)	Weight with Optional Stand Lbs (Kg)
284CZ - 286CZ	2689 (1220)	3000 (1361)
324CZ - 326CZ	2772 (1257)	3083 (1398)
364CZ - 365CZ	2972 (1348)	3283 (1489)
404CZ - 405CZ	3293 (1494)	3604 (1635)
444CZ - 445CZ	3802 (1725)	4113 (1866)

DIMENSIONS

*A & B Dimensions apply for all pump sizes.

Model No.	Conn.	Motor Frame	HP 1160 RPM	Flange Size ASA	A*	B*	C	D	E MAX	F	G	H	J DIA MAX	K MAX	L
1213B	12 x 12 (305 x 305)	286CZ	20	12 (305)	30.25 (768) if ANSI Class 125	24.25 (616) if ANSI Class 125	18.87 (479)	51.26 (1302)	28.70 (729)	11.24 (285)	16.66 (423)	0.25 (6)	15.29 (388)	13.11 (333)	29.70 (754)
		324CZ	25						31.07 (789)				17.35 (441)	14.12 (359)	30.78 (782)
		326CZ	30						32.53 (826)				17.35 (441)	14.12 (359)	30.78 (782)
		364CZ	40						34.40 (874)				19.25 (489)	14.97 (380)	31.63 (803)
		365CZ	50		35.29 (896)	19.25 (489)			14.97 (380)				31.63 (803)		
		404CZ	60		38.53 (979)	21.42 (544)			18.65 (474)				35.31 (897)		
		405CZ	75		38.53 (979)	21.42 (544)			18.65 (474)				35.31 (897)		
444CZ	100	43.49 (1105)	24.56 (624)	20.75 (527)	37.41 (950)										

English dimensions are in inches. Metric dimensions are in millimeters. Metric data is presented in (). Do not use for construction purposes unless certified.

MATERIALS OF CONSTRUCTION

	BRONZE FITTED		
	STANDARD PUMP CONSTRUCTION		OPTIONAL
	125# Flange	250# Flange	125# or 250#
Casing	Cast Iron ASTM A48/ A48M-03 Class 30A	Ductile Iron ASTM A536-84 Grade 65-45-12	N/A
Impeller	Bronze ASTM B584 ALLOY C83600 or C84400	Bronze ASTM B584 ALLOY C83600 or C84400	N/A
Wear Ring	N/A	N/A	Bronze ASTM B584-98A C92200
Shaft	Stainless Steel TYPE 416"™" or 410"™" ASTM A582	Stainless Steel TYPE 416"™" or 410"™" ASTM A582	N/A
Coupling	Aluminum Alloy 6061-T6	Aluminum Alloy 6061-T6	N/A
Mechanical Seal	Ceramic/EPT	Ceramic/EPT	Tungsten Carbide/EPT or Silicon Carbide/EPT
Seal Flush Line	Copper & Brass C3600	Copper & Brass C3600	N/A

N/A = Not available

Revised: 05/31/2017

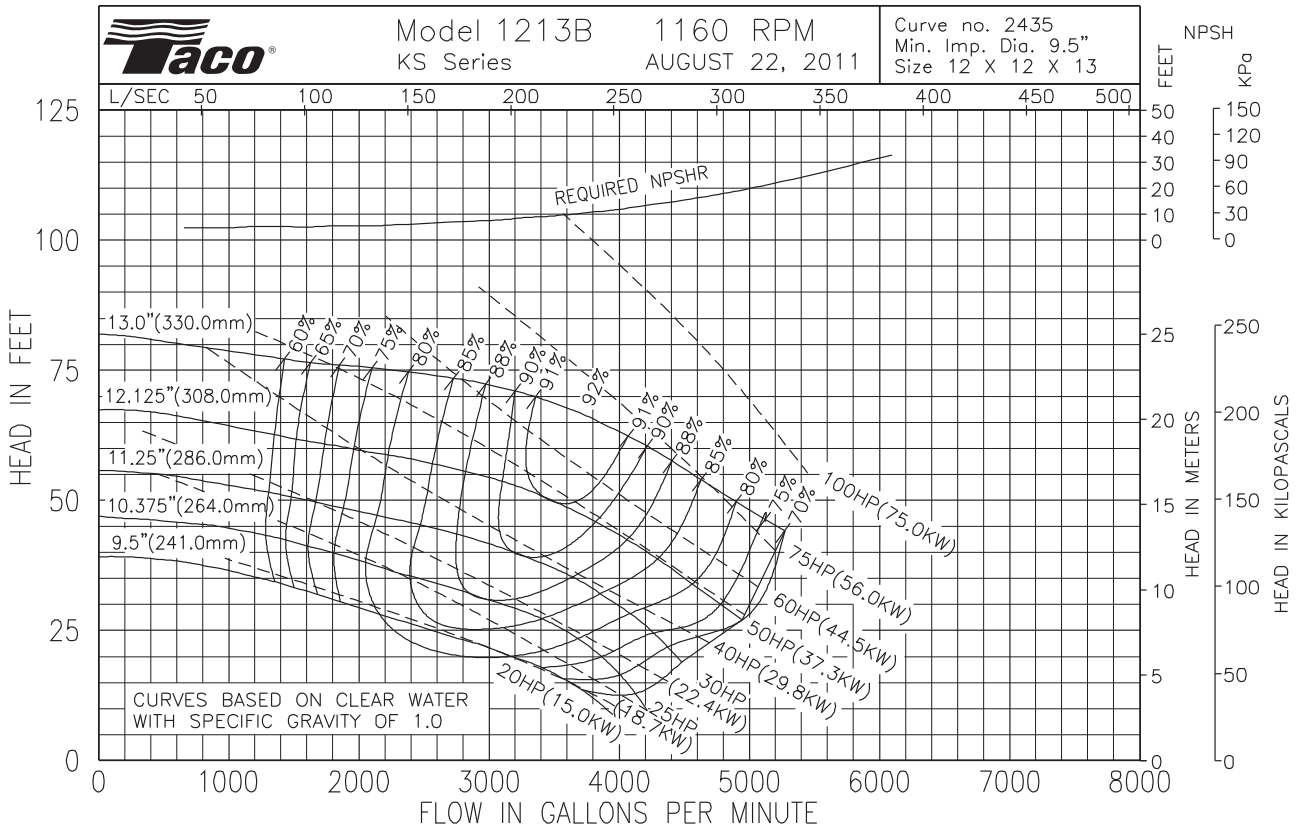

Comments: _____



Taco, Inc., 1160 Cranston Street, Cranston, RI 02920 | Tel: (401) 942-8000 | FAX: (401) 942-2360

Taco (Canada), Ltd., 8450 Lawson Road, Suite #3, Milton, Ontario L9T 0J8 | Tel: (905) 564-9422 | FAX: (905) 564-9436

Visit our web site: www.TacoComfort.com | Printed in USA | ©2017 Taco, Inc.





Submittal Data Information

KS Series Vertical Split Coupled Pumps (50 Hz)

301-1719 I

EFFECTIVE: MAY 31, 2017

SUPERSEDES: SEPTEMBER 1, 2011

1450 RPM MODEL 1213B

JOB _____ ENGINEER _____

CONTRACTOR _____ REP. _____

ITEM NO.	MODEL NO.	IMPELLER DIA.	G.P.M.	HEAD/FT.	H.P.	ELEC. CHAR.
----------	-----------	---------------	--------	----------	------	-------------

WEIGHT _____ PUMP/MOTOR _____

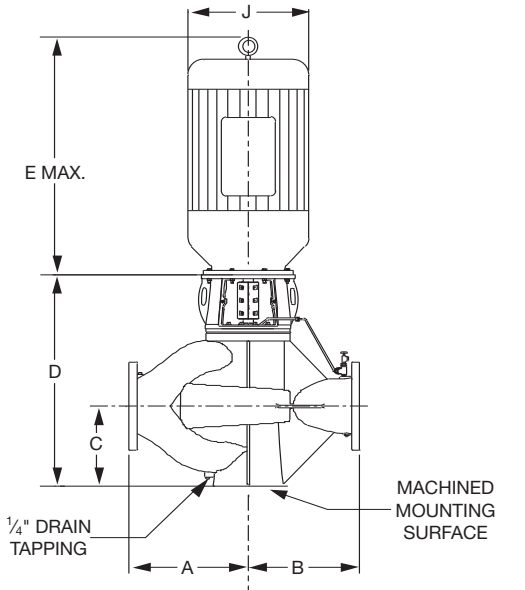

PUMP WITH OPTIONAL SUPPORT STAND

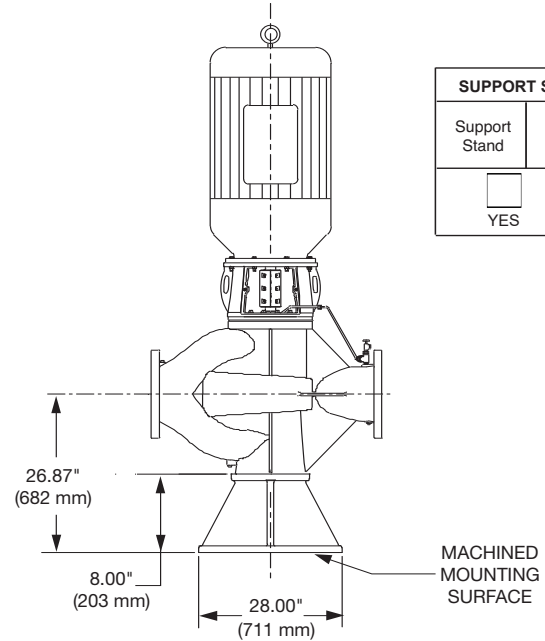

SUPPORT STAND OPTION	
Support Stand	Ductile Iron ASTM A536-84 Grade 65-45-12
<input type="checkbox"/> YES	<input type="checkbox"/> NO

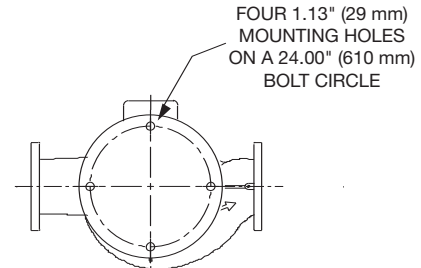
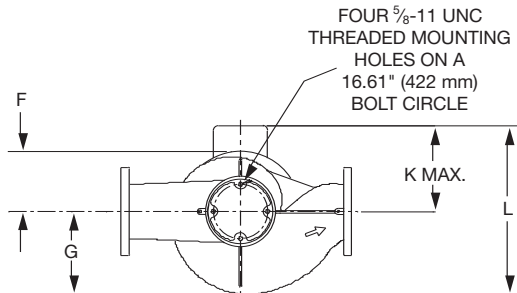

DIMENSIONS

*A & B Dimensions apply for all pump sizes.

Model No.	Conn.	Motor Frame	HP (KW) 1450 RPM	Flange Size ASA	A*	B*	C	D	E MAX	F	G	H	J DIA MAX	K MAX	L
1213B	12 x 12 (305 x 305)	324CZ	40 (29.8)	12 (305)	30.25 (768) if ANSI Class 125	24.25 (616) if ANSI Class 125	18.87 (479)	51.26 (1302)	31.07 (789)	11.24 (285)	16.66 (423)	0.25 (6)	17.35 (441)	14.12 (359)	30.78 (782)
		326CZ	50 (37.3)						32.53 (826)				17.35 (441)	14.12 (359)	30.78 (782)
		364CZ	60 (44.7)						34.40 (874)				19.25 (489)	14.97 (380)	31.63 (803)
		365CZ	75 (56.0)						35.29 (896)				19.25 (489)	14.97 (380)	31.63 (803)
		405CZ	100 (74.5)						38.53 (979)				21.42 (544)	18.65 (474)	35.31 (897)
		444HP	125 (93.2)						43.49 (1105)				24.56 (624)	20.75 (527)	37.41 (950)
		445HP	150 (112.0)						43.49 (1105)				24.56 (624)	20.75 (527)	37.41 (950)
		447HP	200 (149.2)						52.50 (1333)				24.56 (624)	21.71 (551)	38.37 (975)

English dimensions are in inches. Metric dimensions are in millimeters. Metric data is presented in ().
Do not use for construction purposes unless certified.

MATERIALS OF CONSTRUCTION

	BRONZE FITTED		
	STANDARD PUMP CONSTRUCTION		OPTIONAL
	125# Flange	250# Flange	125# or 250#
Casing	Cast Iron ASTM A48/ A48M-03 Class 30A	Ductile Iron ASTM A536-84 Grade 65-45-12	N/A
Impeller	Bronze ASTM B584 ALLOY C83600 or C84400	Bronze ASTM B584 ALLOY C83600 or C84400	N/A
Wear Ring	N/A	N/A	Bronze ASTM B584-98A C92200
Shaft	Stainless Steel TYPE 416"Ti" or 410"Ti" ASTM A582	Stainless Steel TYPE 416"Ti" or 410"Ti" ASTM A582	N/A
Coupling	Aluminum Alloy 6061-T6	Aluminum Alloy 6061-T6	N/A
Mechanical Seal	Ceramic/EPT	Ceramic/EPT	Tungsten Carbide/EPT or Silicon- Carbide/EPT
Seal Flush Line	Copper & Brass C3600	Copper & Brass C3600	N/A

N/A = Not available

Revised: 05/31/2017

OPERATING SPECIFICATIONS

	Standard		Optional
Flange	ANSI Class 125	ANSI Class 250	
Pressure	175 PSIG* (1210 KPA)	300 PSIG** (2070 KPA)	CF
Temperature	250°F (120°C)	250°F (120°C)	CF

Motors: All NEMA Standard ODP Frame (CZ Shaft)
 * In accordance with ANSI Standard B16.1 Class 125
 ** In accordance with ANSI Standard B16.1 Class 250 Dim.

MAXIMUM ASSEMBLY WEIGHT

Motor Frame	Weight without Optional Stand Lbs (Kg)	Weight with Optional Stand Lbs (Kg)
324CZ - 326CZ	3009 (1365)	3320 (1506)
364CZ - 365CZ	3335 (1513)	3646 (1654)
404CZ - 405CZ	3706 (1681)	4017 (1822)
444CZ - 445CZ	4248 (1927)	4559 (2068)
447CZ - 449CZ	5251 (2382)	5562 (2523)

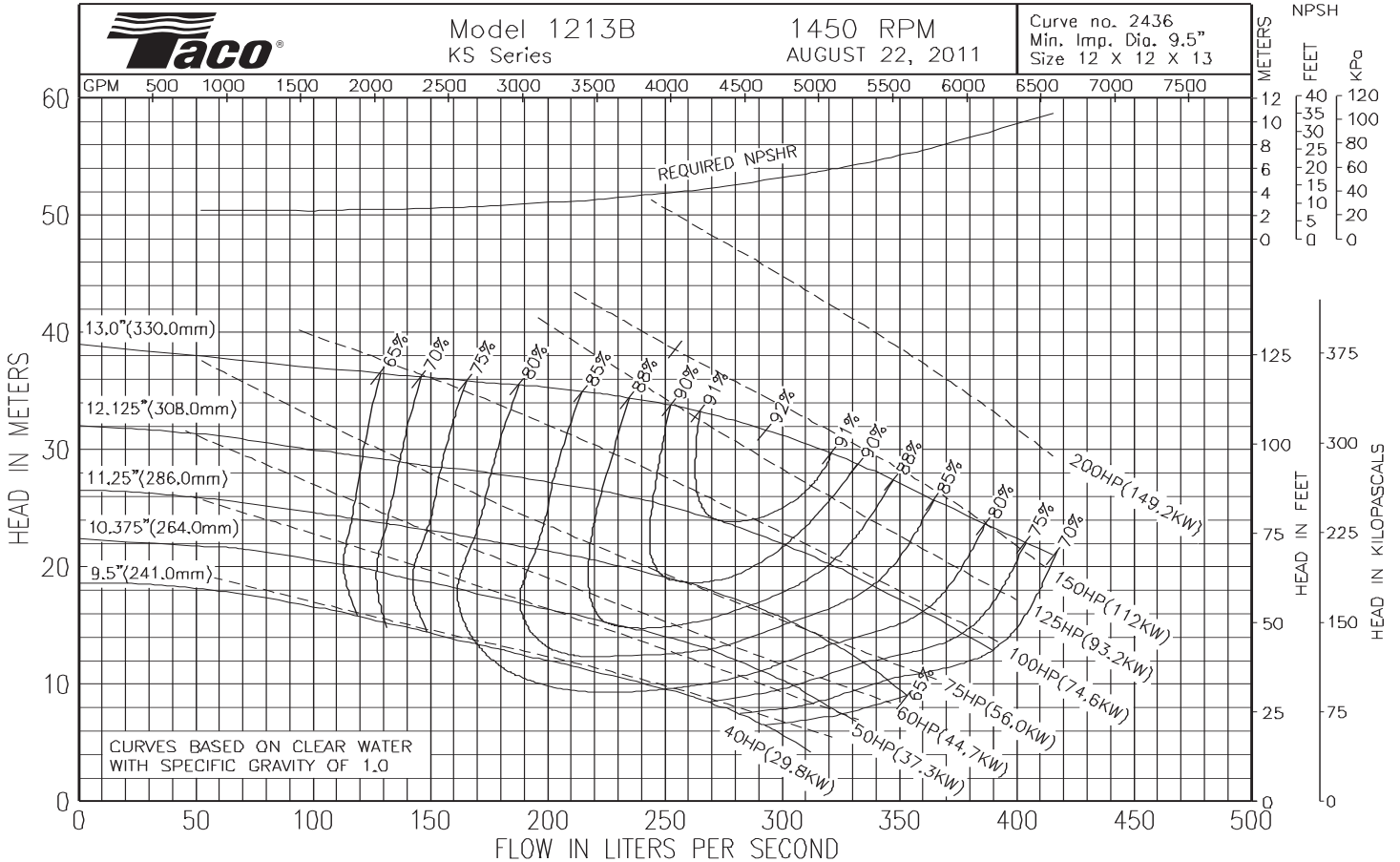

Comments:



Submittal Data Information

KS Series Vertical Split Coupled Pumps

301-1715

EFFECTIVE: MAY 31, 2017

SUPERSEDES: JUNE 25, 2016

1760 RPM MODEL 1213B

JOB _____ ENGINEER _____

CONTRACTOR _____ REP. _____

ITEM NO.	MODEL NO.	IMPELLER DIA.	G.P.M.	HEAD/FT.	H.P.	ELEC. CHAR.
----------	-----------	---------------	--------	----------	------	-------------

WEIGHT _____ PUMP/MOTOR _____

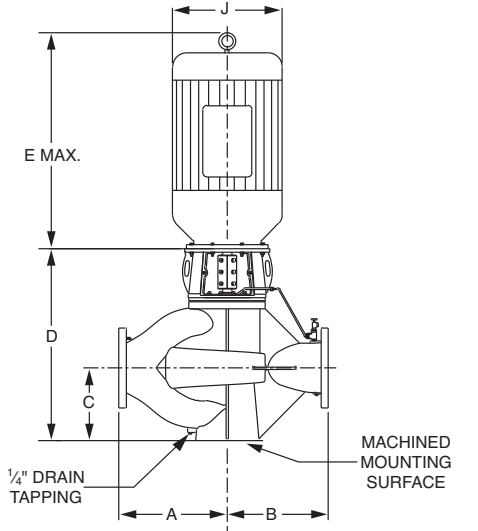

PUMP WITH OPTIONAL SUPPORT STAND

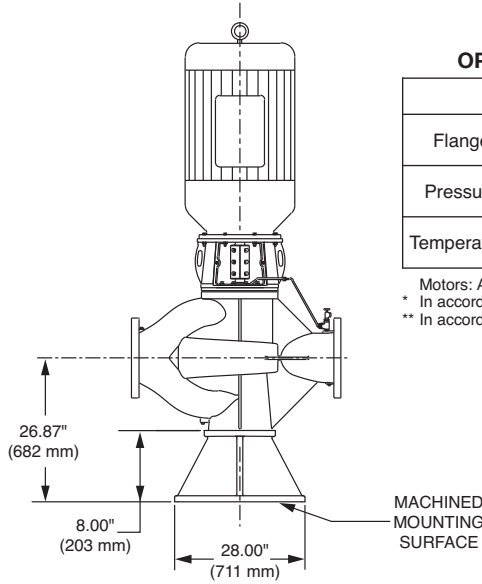

OPERATING SPECIFICATIONS

	Standard		Optional
	ANSI Class 125	ANSI Class 250	
Flange	ANSI Class 125	ANSI Class 250	
Pressure	175 PSIG* (1210 KPA)	300 PSIG** (2070 KPA)	CF
Temperature	250°F (120°C)	250°F (120°C)	CF

Motors: All NEMA Standard ODP Frame (CZ Shaft)
 * In accordance with ANSI Standard B16.1 Class 125
 ** In accordance with ANSI Standard B16.1 Class 250 Dim.

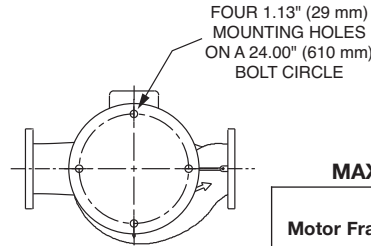
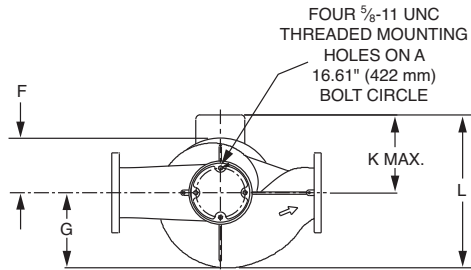

SUPPORT STAND OPTION	
Support Stand	Ductile Iron ASTM A536-84 Grade 65-45-12
<input type="checkbox"/>	<input type="checkbox"/>
YES	NO

MAXIMUM ASSEMBLY WEIGHT

Motor Frame	Weight without Optional Stand Lbs (Kg)	Weight with Optional Stand Lbs (Kg)
364CZ - 365CZ	3032 (1375)	3343 (1516)
404CZ - 405CZ	3369 (1528)	3680 (1669)
444CZ - 445CZ	3862 (1752)	4173 (1893)
447CZ - 449CZ	4774 (2165)	5085 (2307)

DIMENSIONS

*A & B Dimensions apply for all pump sizes.

Model No.	Conn.	Motor Frame	Horsepower		Flange Size ASA	A*	B*	C	D	E MAX	F	G	H	J DIA MAX	K MAX	L	
			ODP	TEFC													
1213B	12 x 12 (305 x 305)	365CZ	75	75	12 (305)	30.25 (768) if ANSI Class 125	24.25 (616) if ANSI Class 125	18.87	51.26	35.29 (896)	11.24	16.66	0.25	19.25 (489)	14.97 (380)	31.63 (803)	
		404CZ	100							38.53 (979)				21.42 (544)	18.65 (474)	35.31 (897)	
		405CZ	125	100						38.53 (979)				21.42 (544)	18.65 (474)	35.31 (897)	
		444HP	150	125						43.49 (1105)				24.56 (624)	20.75 (527)	37.41 (950)	
		445HP	200	150						43.49 (1105)				24.56 (624)	20.75 (527)	37.41 (950)	
		445HP	250							43.49 (1105)				24.56 (624)	20.75 (527)	37.41 (950)	
		447HP		200						52.50 (1333)				24.56 (624)	21.71 (551)	38.37 (975)	
		449HP		250						52.50 (1333)				24.56 (624)	21.71 (551)	38.37 (975)	
		449HP		300						300				52.50 (1333)	24.56 (624)	21.71 (551)	38.37 (975)

English dimensions are in inches. Metric dimensions are in millimeters. Metric data is presented in ().
 Do not use for construction purposes unless certified.

MATERIALS OF CONSTRUCTION

	BRONZE FITTED		
	STANDARD PUMP CONSTRUCTION		OPTIONAL
	125# Flange	250# Flange	125# or 250#
Casing	Cast Iron ASTM A48/ A48M-03 Class 30A	Ductile Iron ASTM A536-84 Grade 65-45-12	N/A
Impeller	Bronze ASTM B584 ALLOY C83600 or C84400	Bronze ASTM B584 ALLOY C83600 or C84400	N/A
Wear Ring	N/A	N/A	Bronze ASTM B584-98A C92200
Shaft	Stainless Steel TYPE 416"T" or 410"T" ASTM A582	Stainless Steel TYPE 416"T" or 410"T" ASTM A582	N/A
Coupling	Aluminum Alloy 6061-T6	Aluminum Alloy 6061-T6	N/A
Mechanical Seal	Ceramic/EPT	Ceramic/EPT	Tungsten Carbide/EPT or Silicon- Carbide/EPT
Seal Flush Line	Copper & Brass C3600	Copper & Brass C3600	N/A

N/A = Not available

Revised: 05/31/2017

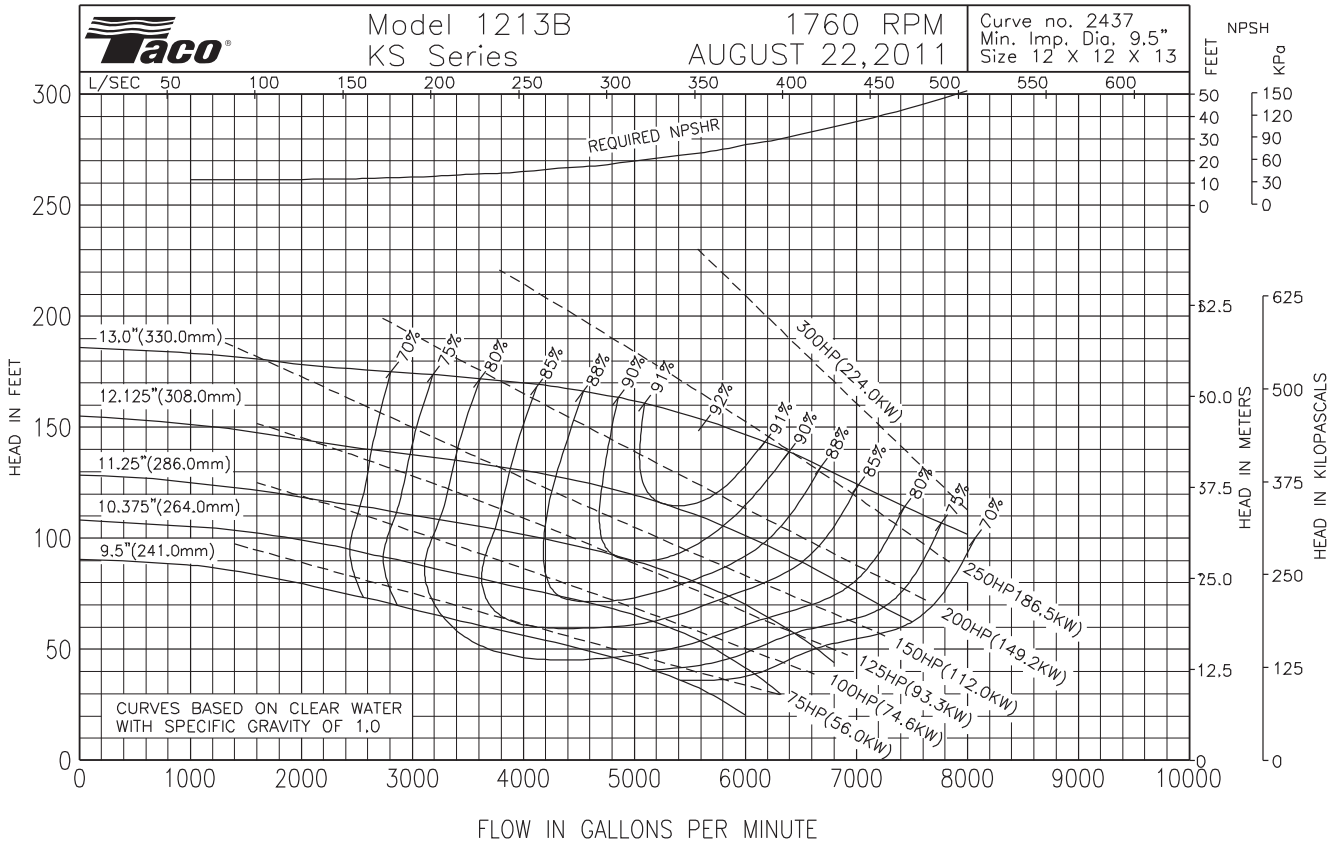

Comments: _____

Taco Comfort Solutions® A Taco Family Company

Taco, Inc., 1160 Cranston Street, Cranston, RI 02920 | Tel: (401) 942-8000 | FAX: (401) 942-2360

Taco (Canada), Ltd., 8450 Lawson Road, Suite #3, Milton, Ontario L9T 0J8 | Tel: (905) 564-9422 | FAX: (905) 564-9436

Visit our web site: www.TacoComfort.com | Printed in USA | ©2017 Taco, Inc.

