

FRAME PARTS

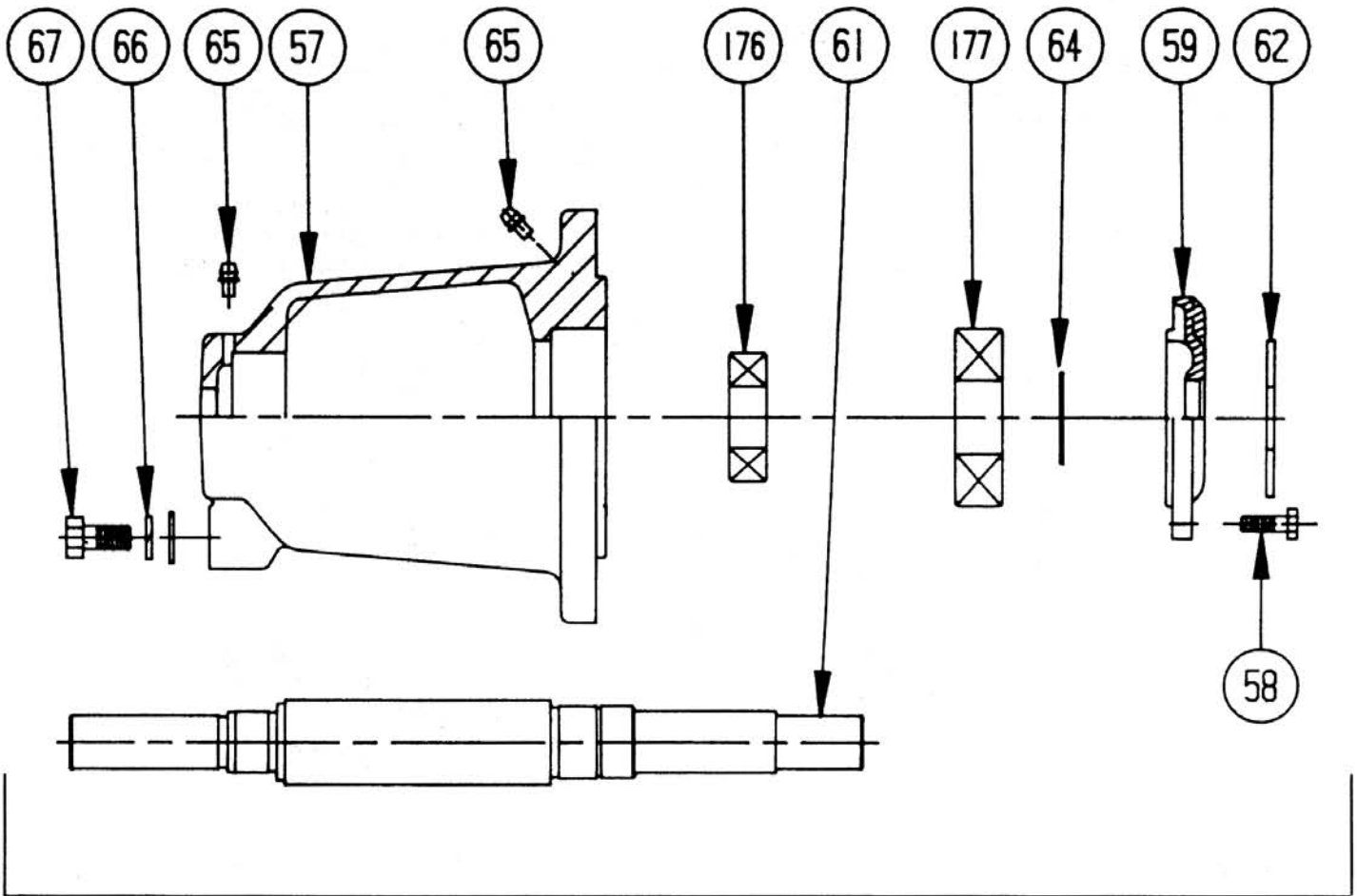

72

FRAME PARTS FOR "E" SIZE PUMP

ITEM NO.	NO. REQ.	DESCRIPTION	PART NO.	REMARKS
72	1	FRAME ASSEMBLY (CS)	951-2481RP	CARBON STEEL SHAFT
72	1	FRAME ASSEMBLY (SS)	951-2952RP	STAINLESS STEEL SHAFT
57	1	FRAME	N/A	
58	4	HEX HD. SCREWS	HARDWARE	
59	1	BEARING COVER	951-2402RP	
176	1	BALL BEARING	951-2482RP	
177	1	BALL BEARING	820-067RP	
61	1	SHAFT (CS)	951-2396RP	CARBON STEEL
61	1	SHAFT (SS)	951-2949RP	STAINLESS STEEL
62	1	DEFLECTOR	N/A	
64	1	RETAINING RING	15-125RP	
65	2	GREASE FITTING	15-203RP	
66	1	WASHER	HARDWARE	
67	1	BOLT	HARDWARE	

MECHANICAL SEAL DESIGN

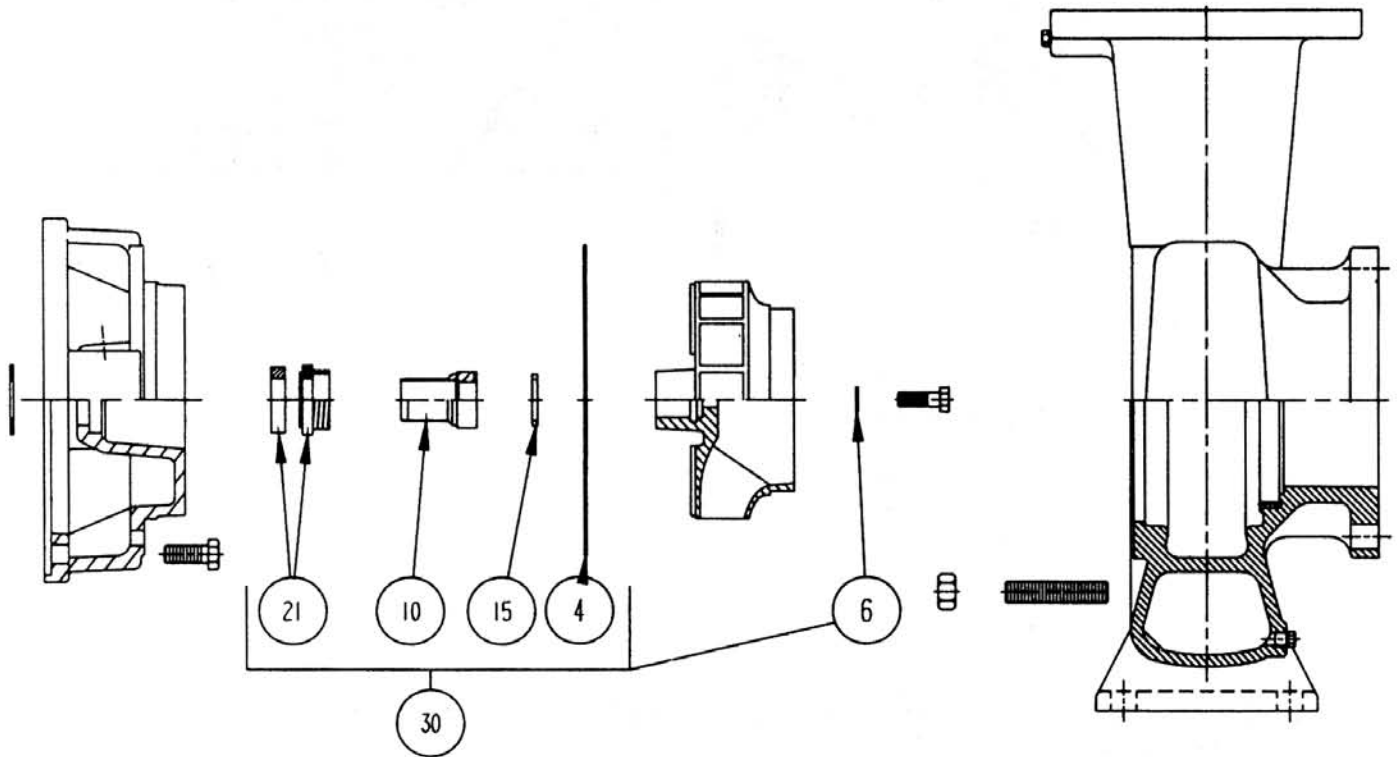

TYPE "E" STANDARD, TYPE "D" HI TEMP

ITEM NO.	NO. REQ.	DESCRIPTION	SEAL DESIGN	
			TYPE "E"	TYPE "D"
4	1	GASKET	SEE PAGE 1	
6	1	IMPELLER WASHER	951-2578RP	
10	1	SLEEVE (SS)	951-3034RP	
10	1	SLEEVE (BRZ)	951-3034BRP	
15	1	SLEEVE GASKET	951-3041RP	
30	1	SEAL KIT	951-3161SRP	951-3159SRP
30	1	SEAL KIT	951-3161BRP	951-3159BRP
21	1	WATER SEAL	951-3161RP	951-3159RP

SEAL KIT INCLUDES ITEMS NUMBER 4, 6, 10, 15 & 21.

MOTOR PARTS

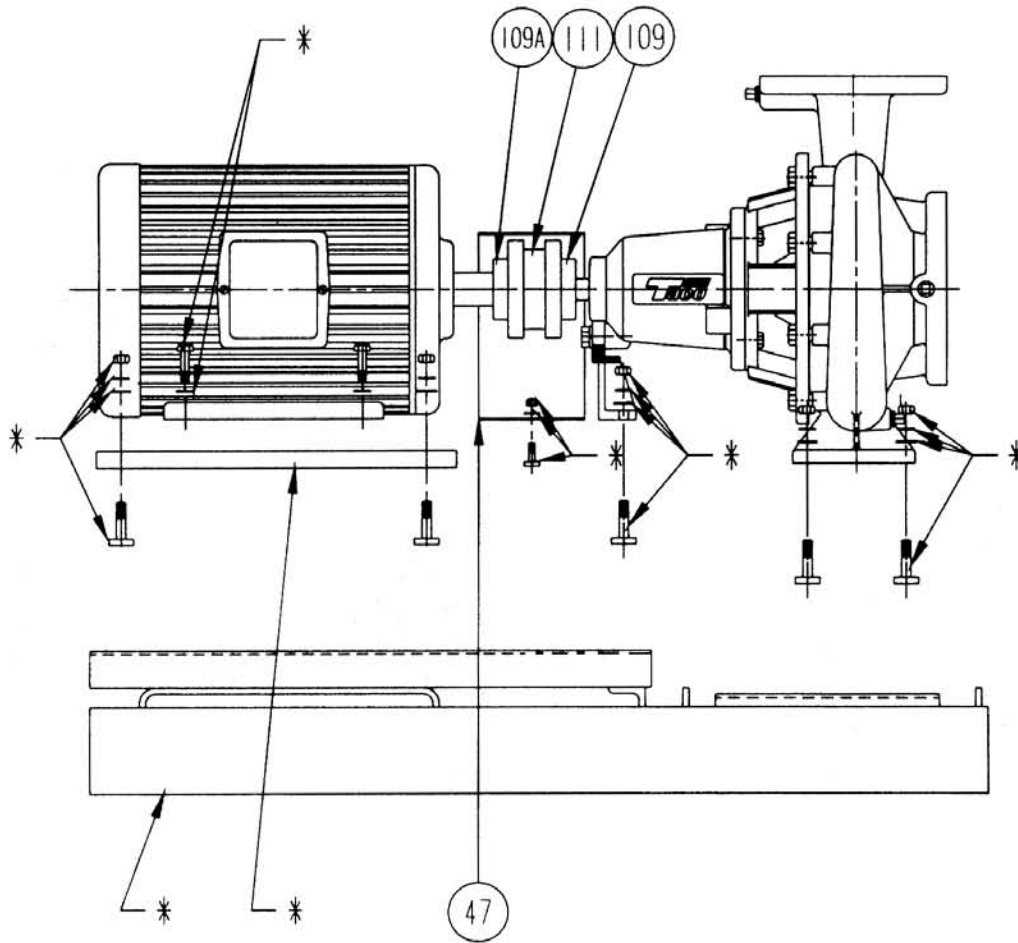

***SEE FE BASE HARDWARE SPREAD SHEET FOR ALL PUMPS**

FOR FE PUMPS NO. 1206			MOTOR FRAME SIZE (NEMA STD.) "T"				
ITEM NO.	NO. REQ.	DESCRIPTION	56	143T	145T	182T	184T
47	1	COUPL. GUARD	951-3074RP		951-3075RP		
109	1	PUMP COUPL. HALF	900-322RP				
109A	1	MTR. COUPL. HALF	900-321RP	900-322RP		900-324RP	
111	1	COUPL. INSERT	900-512RP				

FOR FE PUMPS NO. 1506			MOTOR FRAME SIZE (NEMA STD.) "T"						
ITEM NO.	NO. REQ.	DESCRIPTION	56	143T	145T	182T	184T	213T	215T
47	1	COUPL. GUARD	951-3074RP			951-3076RP			
109	1	PUMP COUPL. HALF	900-322RP					900-325RP	
109A	1	MTR. COUPL. HALF	900-321RP	900-322RP		900-324RP		900-328RP	
111	1	COUPL. INSERT	900-512RP					900-513RP	

FOR FE PUMPS NO. 2006			MOTOR FRAME SIZE (NEMA STD.) "T"						
ITEM NO.	NO. REQ.	DESCRIPTION	56	143T	145T	182T	184T	213T	215T
47	1	COUPL. GUARD	951-3074RP			951-3076RP			
109	1	PUMP COUPL. HALF	900-322RP					900-325RP	
109A	1	MTR. COUPL. HALF	900-321RP	900-322RP		900-324RP		900-328RP	
111	1	COUPL. INSERT	900-512RP					900-513RP	

Do it Once. Do it Right.®

TACO INC., 1160 Cranston Street, Cranston, RI 02920 Telephone: (401) 942-8000 Fax: 942-2360
 TACO (Canada), Ltd., 6180 Ordan Drive, Mississauga, Ontario L5T 2B3 Telephone: (905) 564-9422 Fax: (905) 564-9436

Visit our website at: www.taco-hvac.com

Printed in USA
 Copyright 2007
 TACO, Inc.

FRAME PARTS

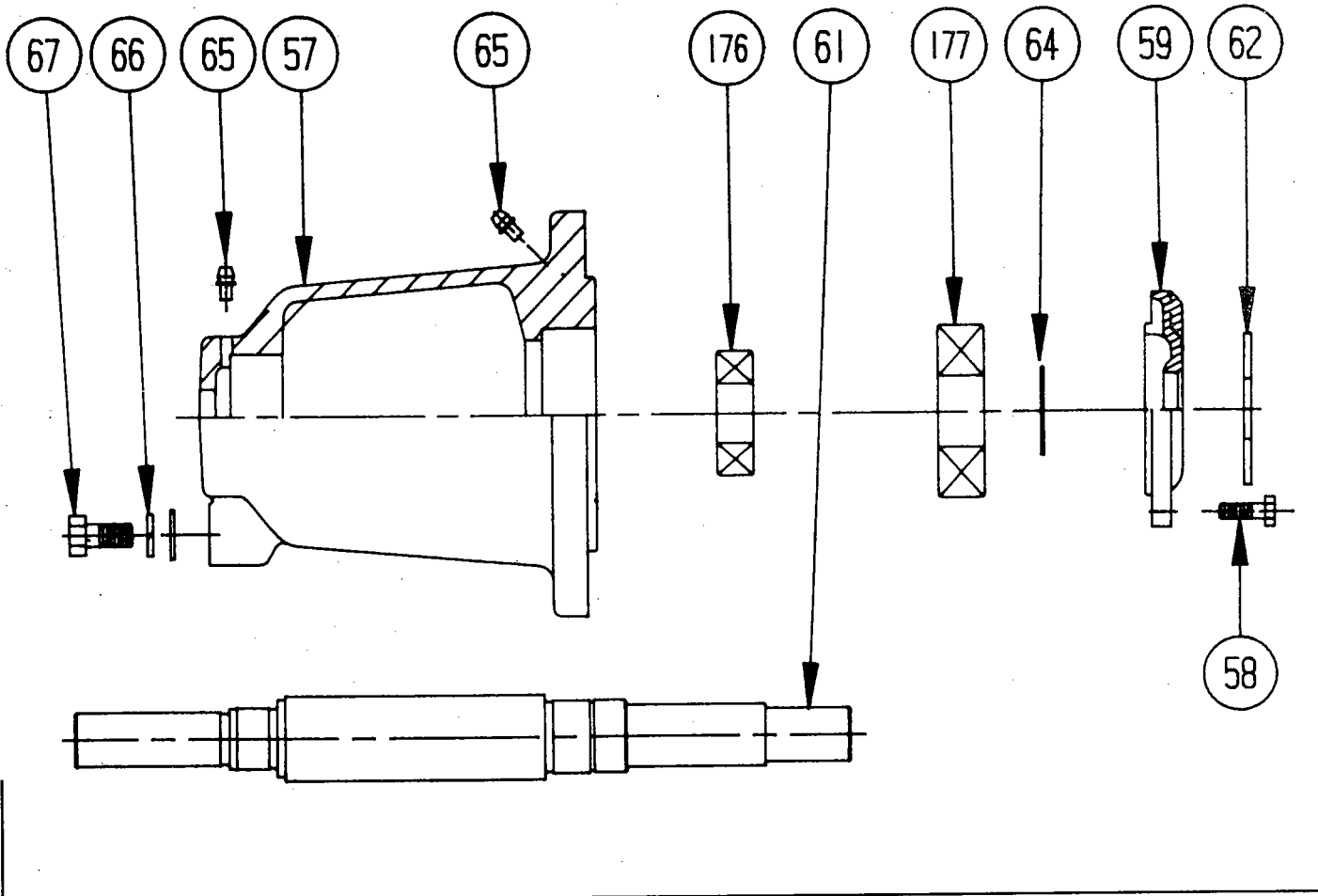

72

FRAME PARTS FOR "E" SIZE PUMP

ITEM NO.	NO. REQ.	DESCRIPTION	PART NO.	REMARKS
72	1	FRAME ASSEMBLY (CS)	951-2481RP	CARBON STEEL SHAFT
72	1	FRAME ASSEMBLY (SS)	951-2952RP	STAINLESS STEEL SHAFT
57	1	FRAME	N/A	
58	4	HEX HD. SCREWS	HARDWARE	
59	1	BEARING COVER	951-2402RP	
176	1	BALL BEARING	951-2482RP	
177	1	BALL BEARING	820-067RP	
61	1	SHAFT (CS)	951-2396RP	CARBON STEEL
61	1	SHAFT (SS)	951-2949RP	STAINLESS STEEL
62	1	DEFLECTOR	N/A	
64	1	RETAINING RING	15-125RP	
65	2	GREASE FITTING	15-203RP	
66	1	WASHER	HARDWARE	
67	1	BOLT	HARDWARE	

MECHANICAL SEAL DESIGN

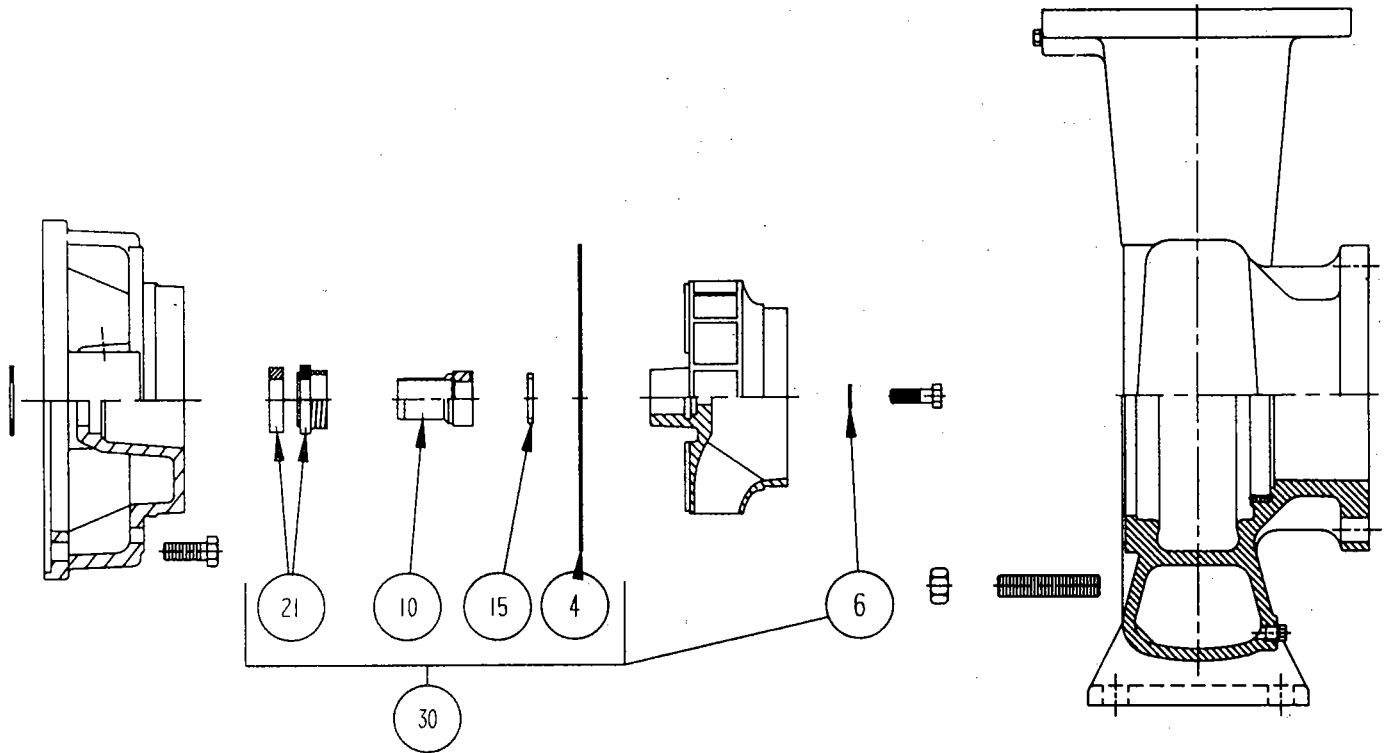

TYPE "E" STANDARD, TYPE "D" HI TEMP

ITEM NO.	NO. REQ.	DESCRIPTION	SEAL DESIGN	
			TYPE "E"	TYPE "D"
4	1	GASKET	SEE PAGE 1	
6	1	IMPELLER WASHER	951-2578RP	
10	1	SLEEVE (SS)	951-3034RP	
10	1	SLEEVE (BRZ)	951-3034BRP	
15	1	SLEEVE GASKET	951-3041RP	
30	1	SEAL KIT	951-3161SRP	951-3159SRP
30	1	SEAL KIT	951-3161BRP	951-3159BRP
21	1	WATER SEAL	951-3161RP	951-3159RP

SEAL KIT INCLUDES ITEMS NUMBER 4, 6, 10, 15 & 21.

MOTOR PARTS

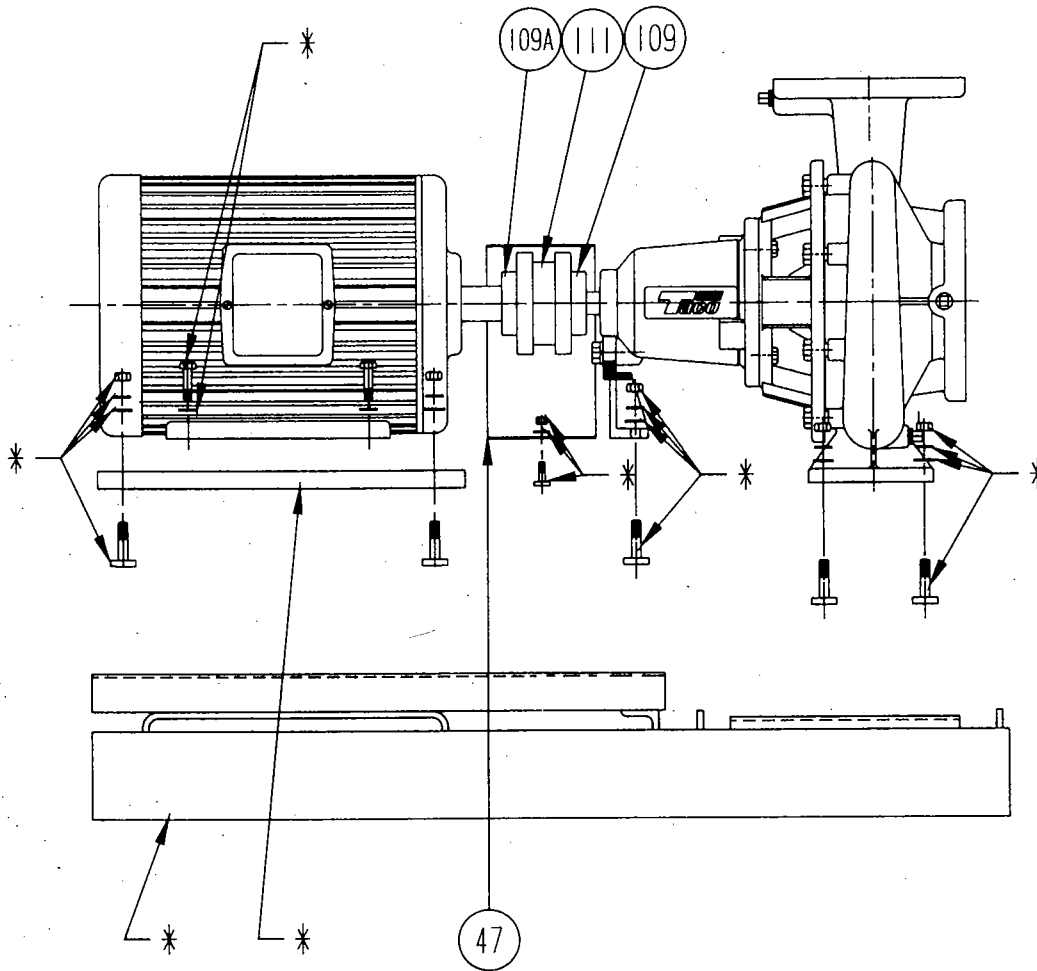

*SEE FE BASE HARDWARE SPREAD SHEET FOR ALL PUMPS

FOR FE PUMPS NO. 2506												
ITEM NO.	NO. REQ.	DESCRIPTION	MOTOR FRAME SIZE (NEMA STD.) "T"									
			56	143T	145T	182T	184T	213T	215T	254T	256T	
47	1	COUPL. GUARD	951-3075RP					951-3077RP				
109	1	PUMP COUPL. HALF	900-322RP				900-325RP					
109A	1	MTR. COUPL. HALF	900-322RP		900-324RP	900-327RP	900-328RP		900-367RP			
111	1	COUPL. INSERT	900-512RP				900-513RP					

FOR FE PUMPS NO. 1207											
ITEM NO.	NO. REQ.	DESCRIPTION	MOTOR FRAME SIZE (NEMA STD.) "T"								
			56	143T	145T	182T	184T	213T	215T	254T	256T
47	1	COUPL. GUARD	951-3074P				951-3076RP				
109	1	PUMP COUPL. HALF	900-322RP				900-325RP				
109A	1	MTR. COUPL. HALF	900-321RP	900-322RP		900-324RP		900-328RP			
111	1	COUPL. INSERT	900-512RP				900-513RP				

FOR FE PUMPS NO. 1507											
ITEM NO.	NO. REQ.	DESCRIPTION	MOTOR FRAME SIZE (NEMA STD.) "T"								
			56	143T	145T	182T	184T	213T	215T	254T	256T
47	1	COUPL. GUARD	951-3074RP				951-3076RP				
109	1	PUMP COUPL. HALF	900-322RP				900-325RP				
109A	1	MTR. COUPL. HALF	900-321RP	900-322RP		900-324RP		900-328RP			
111	1	COUPL. INSERT	900-512RP				900-513RP				



Replacement Parts List

304-304

FE 1210, 1510 & 2010

SUPERSEDES: 304-304 November 1, 1993

EFFECTIVE: April 15, 1995

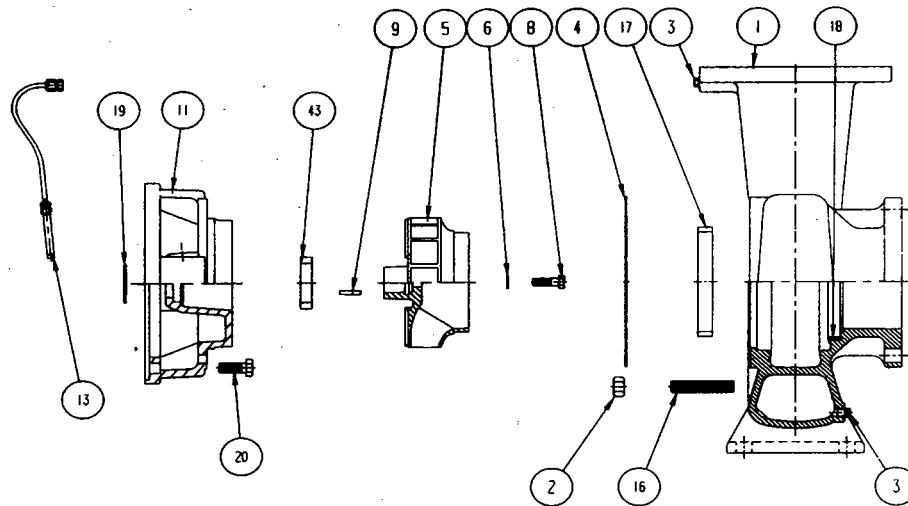
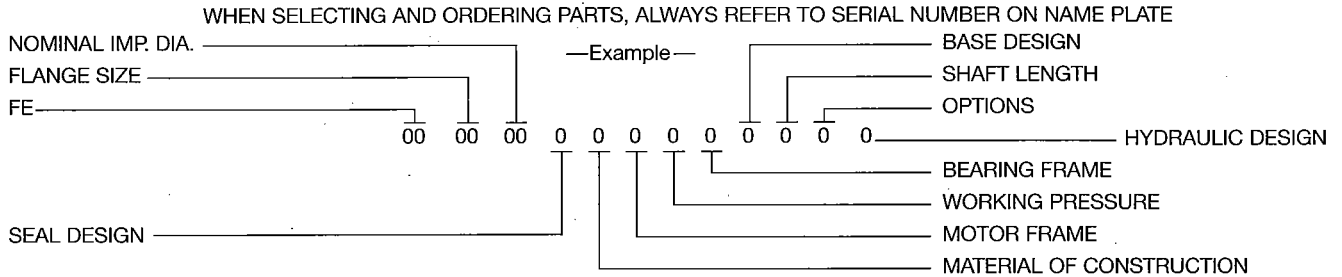

ITEM NO.	NO. REQ.	DESCRIPTION	1210	1510	2010
1	1	CASING	950-1013RP	950-1014RP	950-1015RP
2	8	NUT	HARDWARE	HARDWARE	HARDWARE
3	2	SQ. HEAD PLUG	HARDWARE	HARDWARE	HARDWARE
4	1	GASKET	950-119RP	950-119RP	950-119RP
5	1	IMPELLER (CI)	950-1074RP	950-1075RP	950-1076RP
5	1	IMPELLER (BRZ)	950-1074BRP	950-1075BRP	950-1076BRP
6	1	IMPELLER WASHER	951-2579RP	951-2579RP	951-2579RP
8	1	IMPELLER BOLT (SS)	HARDWARE	HARDWARE	HARDWARE
9	1	IMPELLER KEY (SS)	HARDWARE	HARDWARE	HARDWARE
11	1	COVER	951-2304RP	951-2304RP	951-2304RP
13	1	TUBE FITTING KIT	951-247RP	951-247RP	951-247RP
16	8	STUD	950-1305RP	950-1305RP	950-1305RP
17	1	WEAR RING (CI)	950-1164RP	950-1165RP	950-1166RP
17	1	WEAR RING (BRZ)	950-1164BRP	950-1165BRP	950-1166BRP
18	1	DOWEL PIN	N/A	N/A	N/A
20	1	BOLT		HARDWARE	
43	1	COVER WEAR RING (CI)	N/A	N/A	N/A
43	1	COVER WEAR RING (BRZ)	N/A	N/A	N/A

COMPARE. YOU'LL TAKE TACO.

TACO, INC., 1160 Cranston Street, Cranston, RI 02920 Telephone: (401) 942-8000 FAX: (401) 942-2360.

TACO (Canada), Ltd., 6180 Ordan Drive, Mississauga, Ontario L5T 2B3. Telephone: 905/564-9422. FAX: 905/564-9436.

Printed in USA
 Copyright 1995
 TACO, Inc.

FRAME PARTS

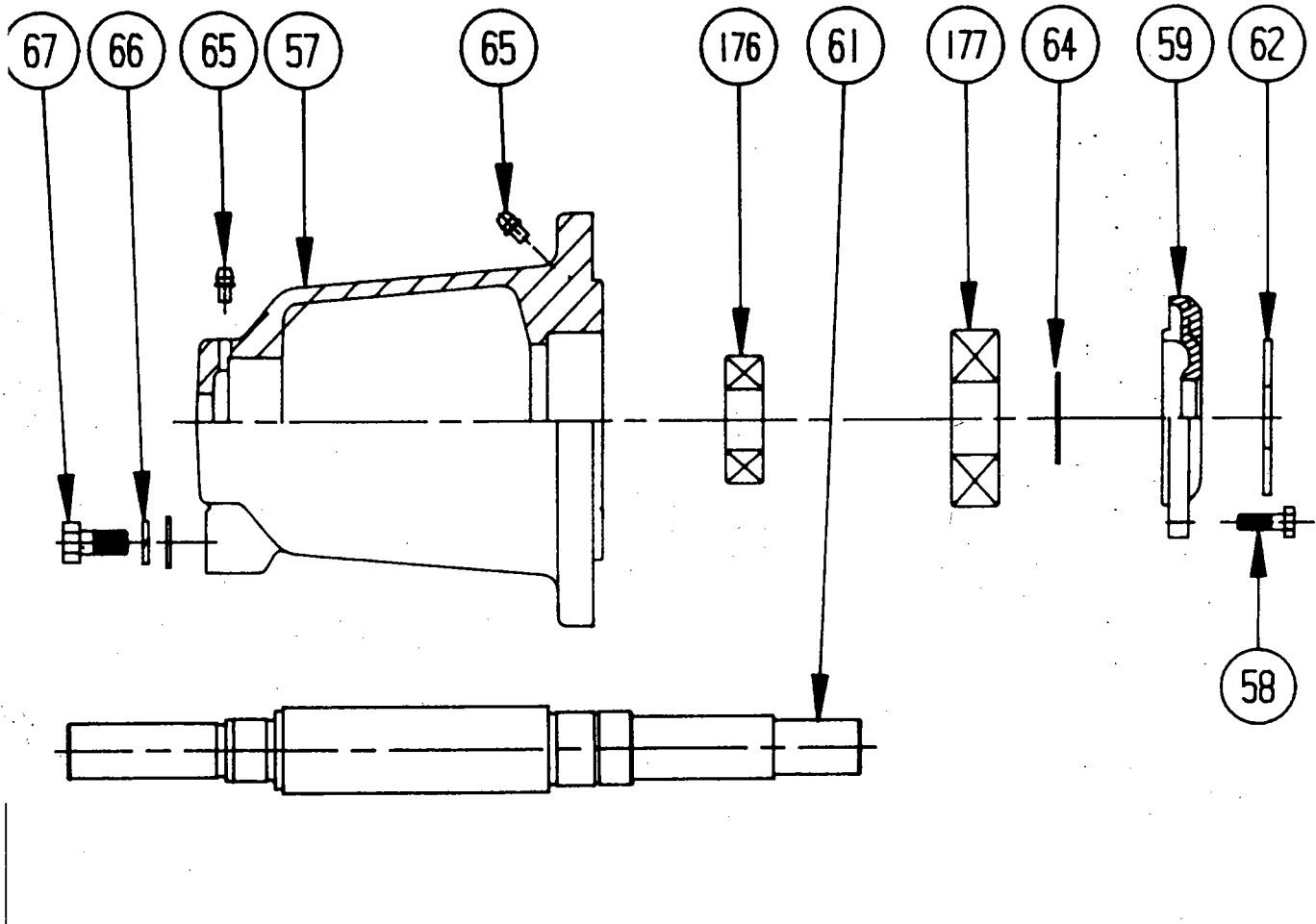

72

FRAME PARTS FOR "F" SIZE PUMP

ITEM NO.	NO. REQ.	DESCRIPTION	PART NO.	REMARKS
72	1	FRAME ASSEMBLY (CS)	951-2493RP	CARBON STEEL SHAFT
72	1	FRAME ASSEMBLY (SS)	951-2953RP	STAINLESS STEEL SHAFT
57	1	FRAME	N/A	
58	4	HEX HD. SCREWS	HARDWARE	
59	1	BEARING COVER	951-2405RP	
176	1	BALL BEARING	951-2491RP	
177	1	BALL BEARING	950-963RP	
61	1	SHAFT (CS)	951-2407RP	CARBON STEEL
61	1	SHAFT (SS)	951-2950RP	STAINLESS STEEL
62	1	DEFLECTOR	N/A	
64	1	RETAINING RING	15-140RP	
65	2	GREASE FITTING	15-203RP	
66	1	WASHER	HARDWARE	
67	1	BOLT	HARDWARE	

MECHANICAL SEAL DESIGN

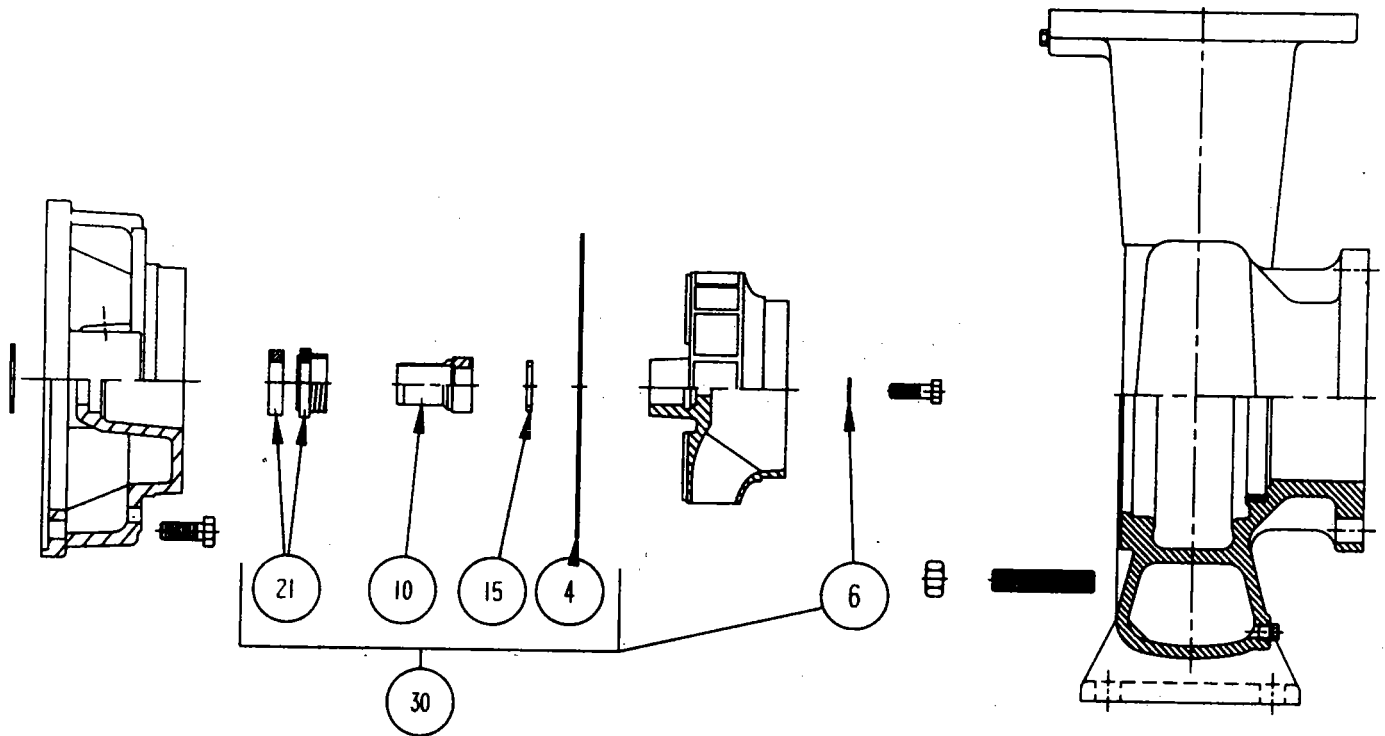

TYPE "E" STANDARD, TYPE "D" HI TEMP

ITEM NO.	NO. REQ.	DESCRIPTION	SEAL DESIGN	
			TYPE "E"	TYPE "D"
4	1	GASKET	SEE PAGE 1	
6	1	IMPELLER WASHER	951-2579RP	
10	1	SLEEVE (SS)	951-3035RP	
10	1	SLEEVE (BRZ)	951-3035BRP	
15	1	SLEEVE GASKET	951-3042RP	
30	1	SEAL KIT	951-3162SRP	951-3160SRP
30	1	SEAL KIT	951-3162BRP	951-3160BRP
21	1	WATER SEAL	951-3162RP	951-3160RP

SEAL KIT INCLUDES ITEMS NUMBER 4, 6, 10, 15 & 21.

MOTOR PARTS

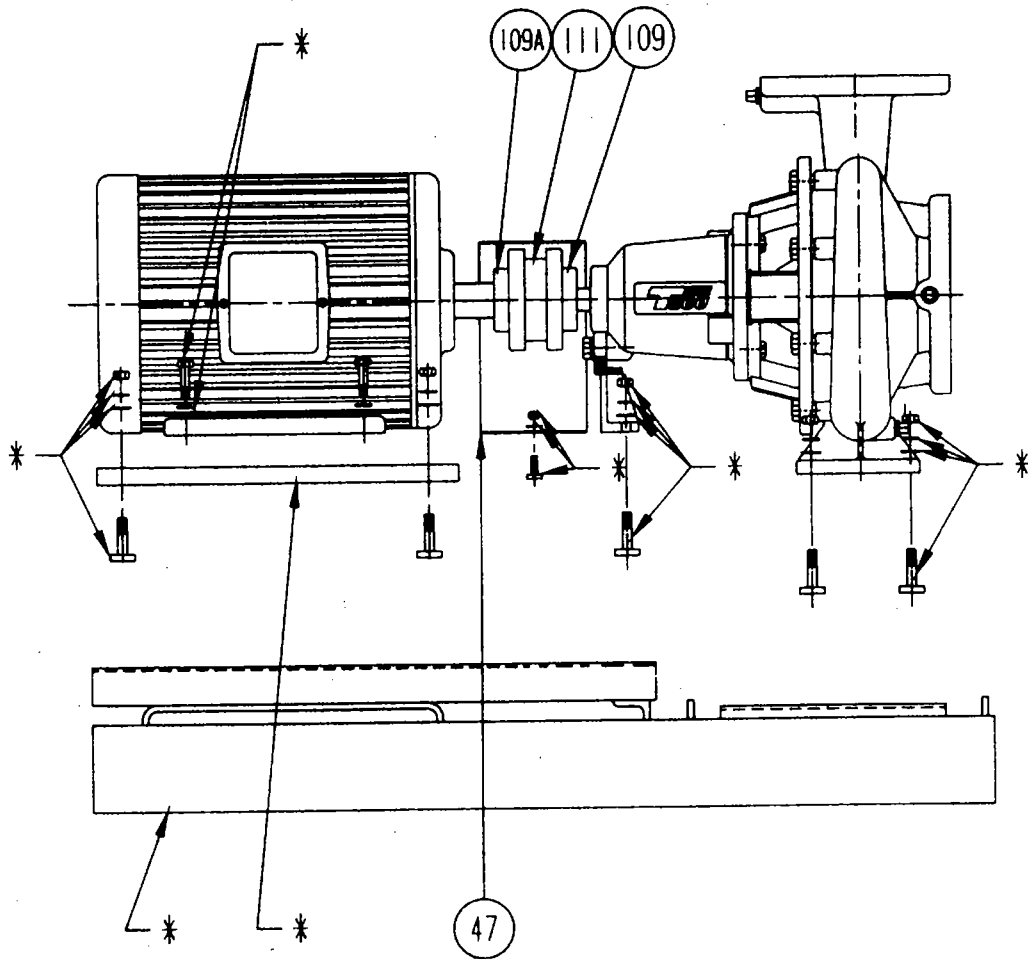

***SEE FE BASE HARDWARE SPREAD SHEET FOR ALL PUMPS**

FOR FE PUMPS NO. 1210			MOTOR FRAME SIZE (NEMA STD.) "T"								
ITEM NO.	NO. REQ.	DESCRIPTION	56	143T	145T	182T	184T	213T	215T	254T	256T
47	1	COUPL. GUARD				951-3076RP					
109	1	PUMP COUPL. HALF				900-328RP					
109A	1	MTR. COUPL. HALF				900-327RP					
111	1	COUPL. INSERT				900-513RP					

FOR FE PUMPS NO. 1510			MOTOR FRAME SIZE (NEMA STD.) "T"								
ITEM NO.	NO. REQ.	DESCRIPTION	56	143T	145T	182T	184T	213T	215T	254T	256T
47	1	COUPL. GUARD				951-3076RP					
109	1	PUMP COUPL. HALF				900-328RP					
109A	1	MTR. COUPL. HALF			900-325RP	900-327RP		900-328RP			
111	1	COUPL. INSERT				900-513RP					

FOR FE PUMPS NO. 2010			MOTOR FRAME SIZE (NEMA STD.) "T"								
ITEM NO.	NO. REQ.	DESCRIPTION	56	143T	145T	182T	184T	213T	215T	254T	256T
47	1	COUPL. GUARD				951-3076RP					
109	1	PUMP COUPL. HALF				900-328RP					
109A	1	MTR. COUPL. HALF			900-325RP	900-327RP		900-328RP			
111	1	COUPL. INSERT				900-513RP					



Replacement Parts List

304-302

FE 2007, 1208 & 1508

SUPERSEDES: NEW

EFFECTIVE: NOVEMBER 1, 1993

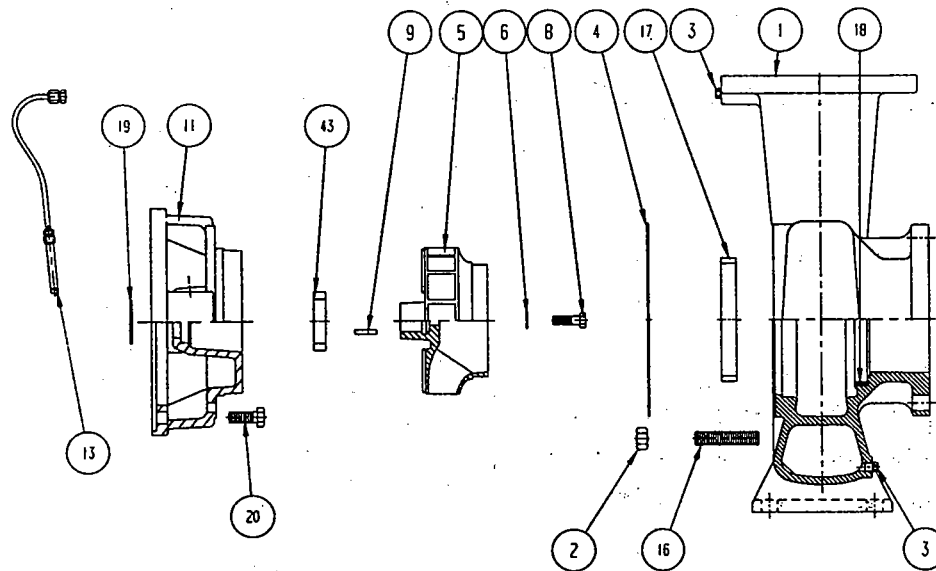
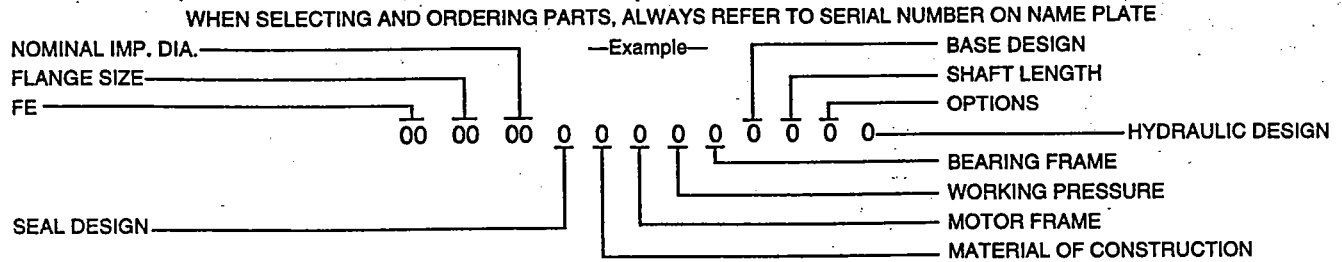

ITEM NO.	NO. REQ.	DESCRIPTION	2007	1208	1508
1	1	CASING	950-1006RP	950-1007RP	950-1008RP
2	8	NUT	HARDWARE	HARDWARE	HARDWARE
3	2	SQ. HEAD PLUG	HARDWARE	HARDWARE	HARDWARE
4	1	GASKET	950-022RP	950-023RP	950-023RP
5	1	IMPELLER (CI)	950-1067RP	950-1068RP	950-1069RP
5	1	IMPELLER (BRZ)	950-1067BRP	950-1068BRP	950-1069BRP
6	1	IMPELLER WASHER	951-2578RP	951-2578RP	951-2578RP
8	1	IMPELLER BOLT (SS)	HARDWARE	HARDWARE	HARDWARE
9	1	IMPELLER KEY (SS)	HARDWARE	HARDWARE	HARDWARE
11	1	COVER	951-2278RP	951-2285RP	951-2285RP
13	1	TUBE FITTING KIT	951-247RP	951-247RP	951-247RP
16	8	STUD	950-1158RP	950-1159RP	950-1159RP
17	1	WEAR RING (CI)	950-1165RP	950-1164RP	950-1164RP
17	1	WEAR RING (BRZ)	950-1165BRP	950-1164BRP	950-1164BRP
18	1	DOWEL PIN	N/A	N/A	N/A
20	1	BOLT		HARDWARE	
43	1	COVER WEAR RING (CI)	N/A	N/A	N/A
43	1	COVER WEAR RING (BRZ)	N/A	N/A	N/A

COMPARE. YOU'LL TAKE TACO.

TACO, INC., 1160 Cranston Street, Cranston, RI 02920 (401) 942-8000 FAX: (401) 942-2360.
 TACO (CANADA) LTD., 6180 Ordan Drive, Mississauga, Ontario L5T 2B3 (905) 564-9422 FAX: (905) 564-9436

Printed in USA

FRAME PARTS

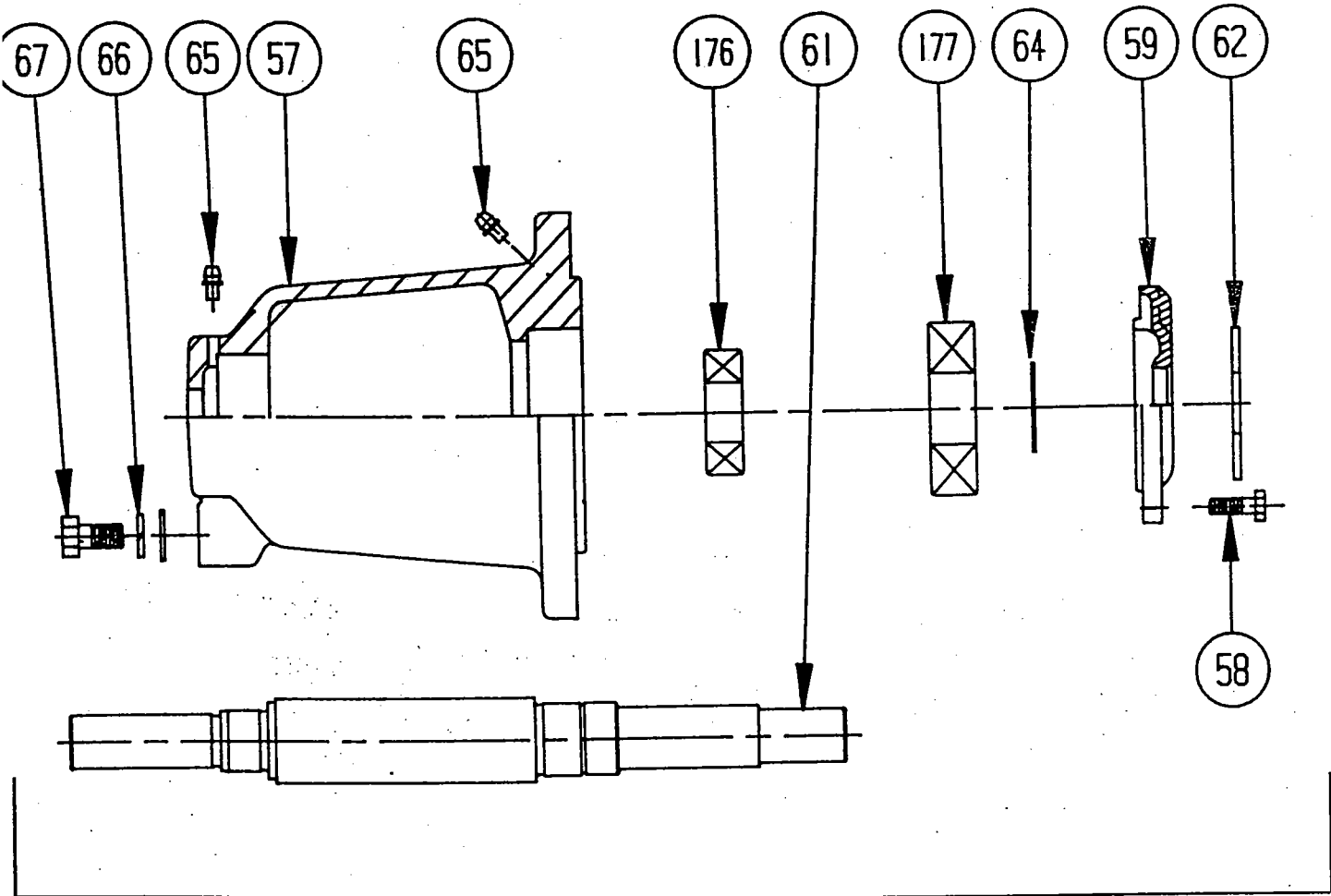

72

FRAME PARTS FOR "E" SIZE PUMP

ITEM NO.	NO. REQ.	DESCRIPTION	PART NO.	REMARKS
72	1	FRAME ASSEMBLY (CS)	951-2481RP	CARBON STEEL SHAFT
72	1	FRAME ASSEMBLY (SS)	951-2952RP	STAINLESS STEEL SHAFT
57	1	FRAME	N/A	
58	4	HEX HD. SCREWS	HARDWARE	
59	1	BEARING COVER	951-2402RP	
176	1	BALL BEARING	951-2482RP	
177	1	BALL BEARING	820-067RP	
61	1	SHAFT (CS)	951-2396RP	CARBON STEEL
61	1	SHAFT (SS)	951-2949RP	STAINLESS STEEL
62	1	DEFLECTOR	N/A	
64	1	RETAINING RING	15-125RP	
65	2	GREASE FITTING	15-203RP	
66	1	WASHER	HARDWARE	
67	1	BOLT	HARDWARE	

MECHANICAL SEAL DESIGN

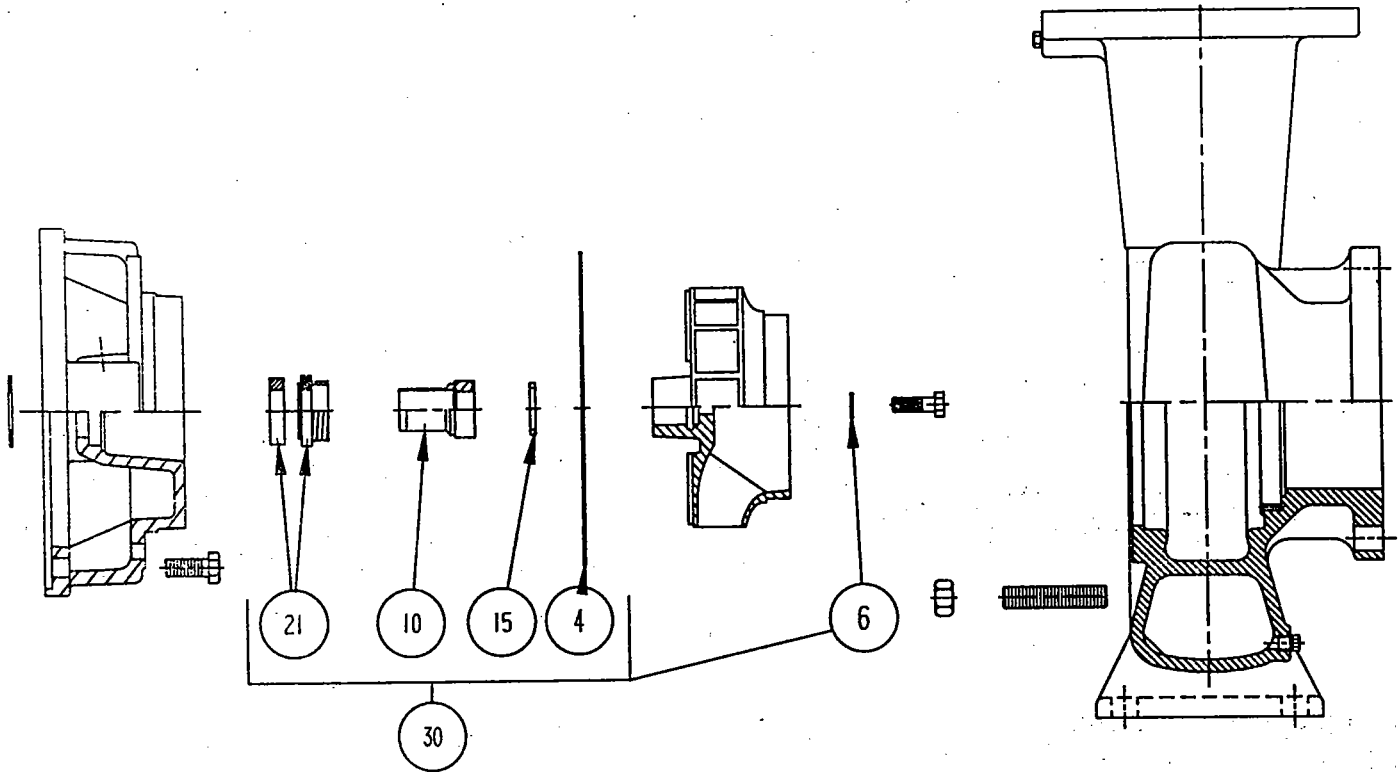

TYPE "E" STANDARD, TYPE "D" HI TEMP

ITEM NO.	NO. REQ.	DESCRIPTION	SEAL DESIGN	
			TYPE "E"	TYPE "D"
4	1	GASKET	SEE PAGE 1.	
6	1	IMPELLER WASHER	951-2578RP	
10	1	SLEEVE (SS)	951-3034RP	
10	1	SLEEVE (BRZ)	951-3034BRP	
15	1	SLEEVE GASKET	951-3041RP	
30	1	SEAL KIT	951-3161SRP	951-3159SRP
30	1	SEAL KIT	951-3161BRP	951-3159BRP
21	1	WATER SEAL	951-3161RP	951-3159RP

SEAL KIT INCLUDES ITEMS NUMBER 4, 6, 10, 15 & 21.

MOTOR PARTS

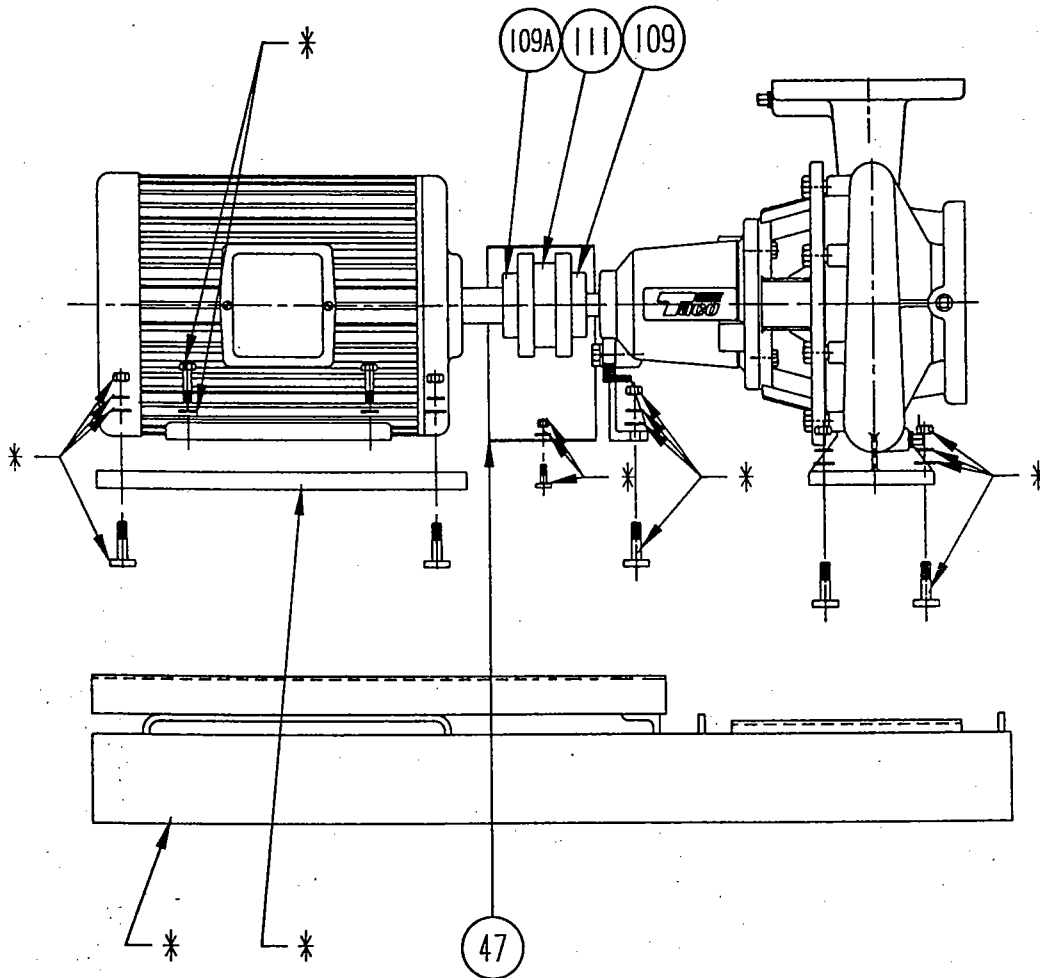

SEE FE BASE HARDWARE SPREAD SHEET FOR ALL PUMPS

FOR FE PUMPS NO. 2007

ITEM NO.	NO. REQ.	DESCRIPTION	MOTOR FRAME SIZE (NEMA STD.) "T"							
			56	143T	145T	182T	184T	213T	215T	254T
47	1	COUPL. GUARD	951-3075RP				951-3077RP			
109	1	PUMP COUPL. HALF	900-322RP				900-325RP			
109A	1	MTR. COUPL. HALF	900-322RP		900-324RP	900-327RP	900-328RP		951-367RP	
111	1	COUPL. INSERT	900-512RP				951-513RP			

FOR FE PUMPS NO. 1208

ITEM NO.	NO. REQ.	DESCRIPTION	MOTOR FRAME SIZE (NEMA STD.) "T"							
			56	143T	145T	182T	184T	213T	215T	254T
47	1	COUPL. GUARD	951-3074P				951-3076RP			
109	1	PUMP COUPL. HALF	900-322RP				900-325RP			
109A	1	MTR. COUPL. HALF	900-321RP	900-322RP		900-324RP	900-328RP			
111	1	COUPL. INSERT	900-512RP				900-513RP			

FOR FE PUMPS NO. 1508

ITEM NO.	NO. REQ.	DESCRIPTION	MOTOR FRAME SIZE (NEMA STD.) "T"							
			56	143T	145T	182T	184T	213T	215T	254T
47	1	COUPL. GUARD	951-3075RP				951-3077RP			
109	1	PUMP COUPL. HALF	900-322RP				900-325RP			
109A	1	MTR. COUPL. HALF	900-322RP		900-324RP	900-327RP	900-328RP		951-367RP	
111	1	COUPL. INSERT	900-512P				900-513RP			

FRAME PARTS

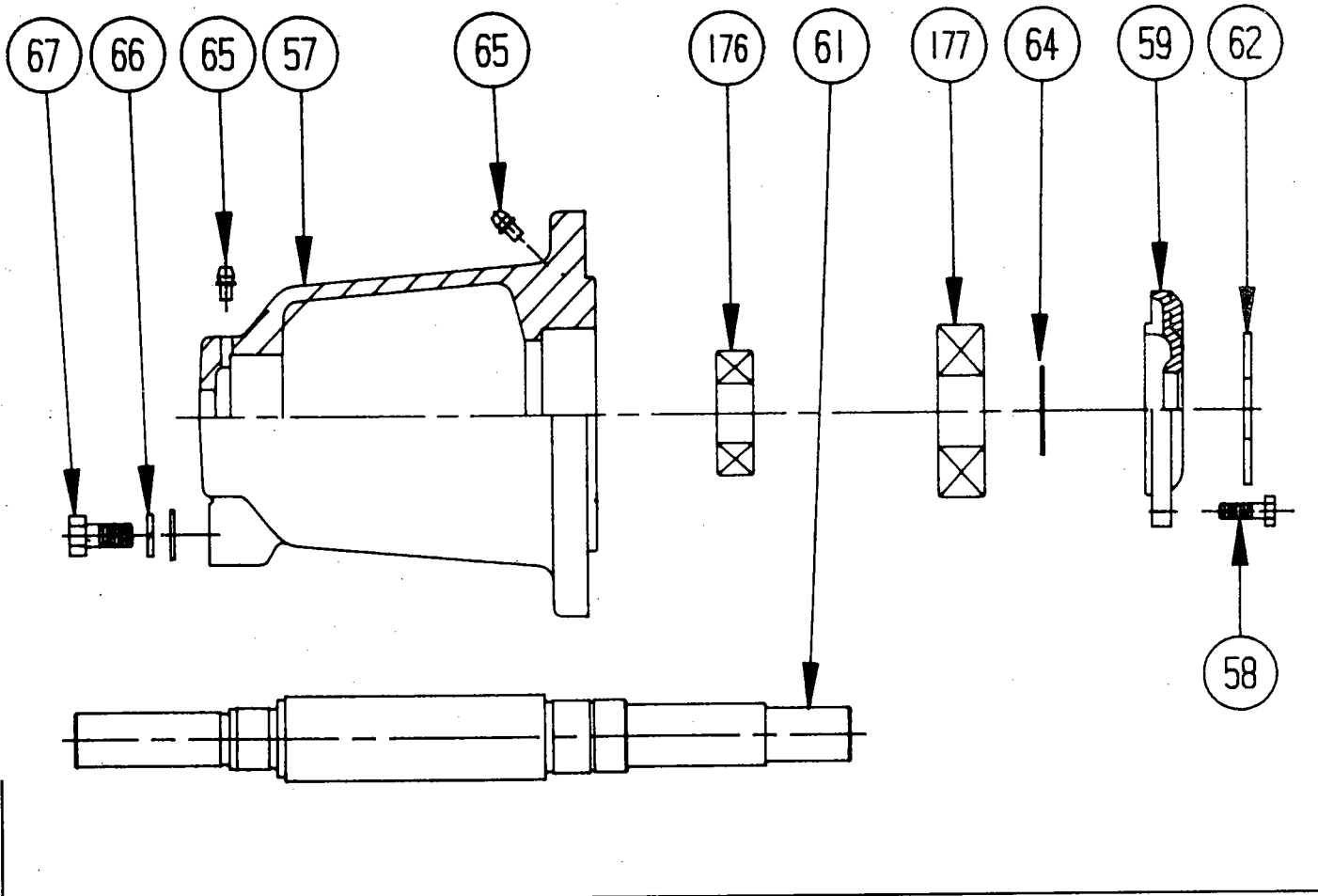

72

FRAME PARTS FOR "E" SIZE PUMP

ITEM NO.	NO. REQ.	DESCRIPTION	PART NO.	REMARKS
72	1	FRAME ASSEMBLY (CS)	951-2481RP	CARBON STEEL SHAFT
72	1	FRAME ASSEMBLY (SS)	951-2952RP	STAINLESS STEEL SHAFT
57	1	FRAME	N/A	
58	4	HEX HD. SCREWS	HARDWARE	
59	1	BEARING COVER	951-2402RP	
176	1	BALL BEARING	951-2482RP	
177	1	BALL BEARING	820-067RP	
61	1	SHAFT (CS)	951-2396RP	CARBON STEEL
61	1	SHAFT (SS)	951-2949RP	STAINLESS STEEL
62	1	DEFLECTOR	N/A	
64	1	RETAINING RING	15-125RP	
65	2	GREASE FITTING	15-203RP	
66	1	WASHER	HARDWARE	
67	1	BOLT	HARDWARE	

MECHANICAL SEAL DESIGN

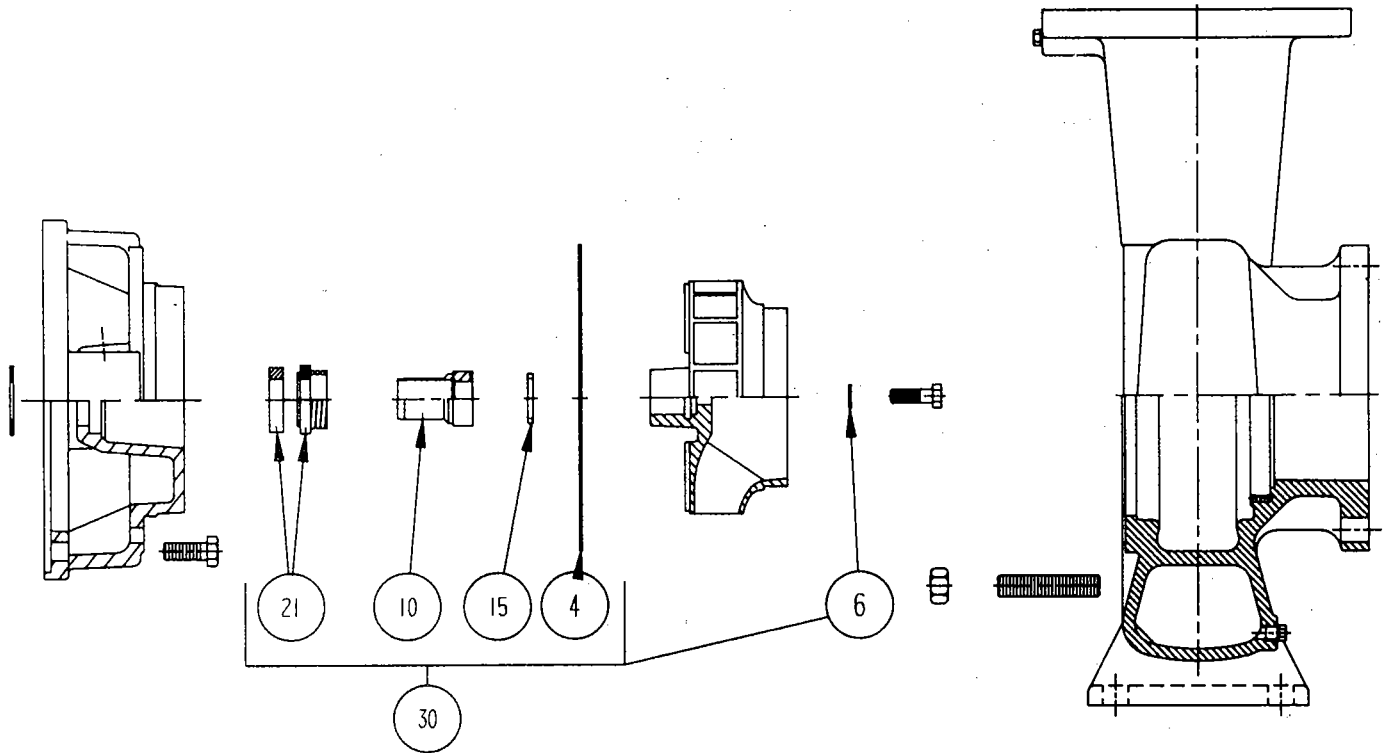

TYPE "E" STANDARD, TYPE "D" HI TEMP

ITEM NO.	NO. REQ.	DESCRIPTION	SEAL DESIGN	
			TYPE "E"	TYPE "D"
4	1	GASKET	SEE PAGE 1	
6	1	IMPELLER WASHER	951-2578RP	
10	1	SLEEVE (SS)	951-3034RP	
10	1	SLEEVE (BRZ)	951-3034BRP	
15	1	SLEEVE GASKET	951-3041RP	
30	1	SEAL KIT	951-3161SRP	951-3159SRP
30	1	SEAL KIT	951-3161BRP	951-3159BRP
21	1	WATER SEAL	951-3161RP	951-3159RP

SEAL KIT INCLUDES ITEMS NUMBER 4, 6, 10, 15 & 21.

MOTOR PARTS

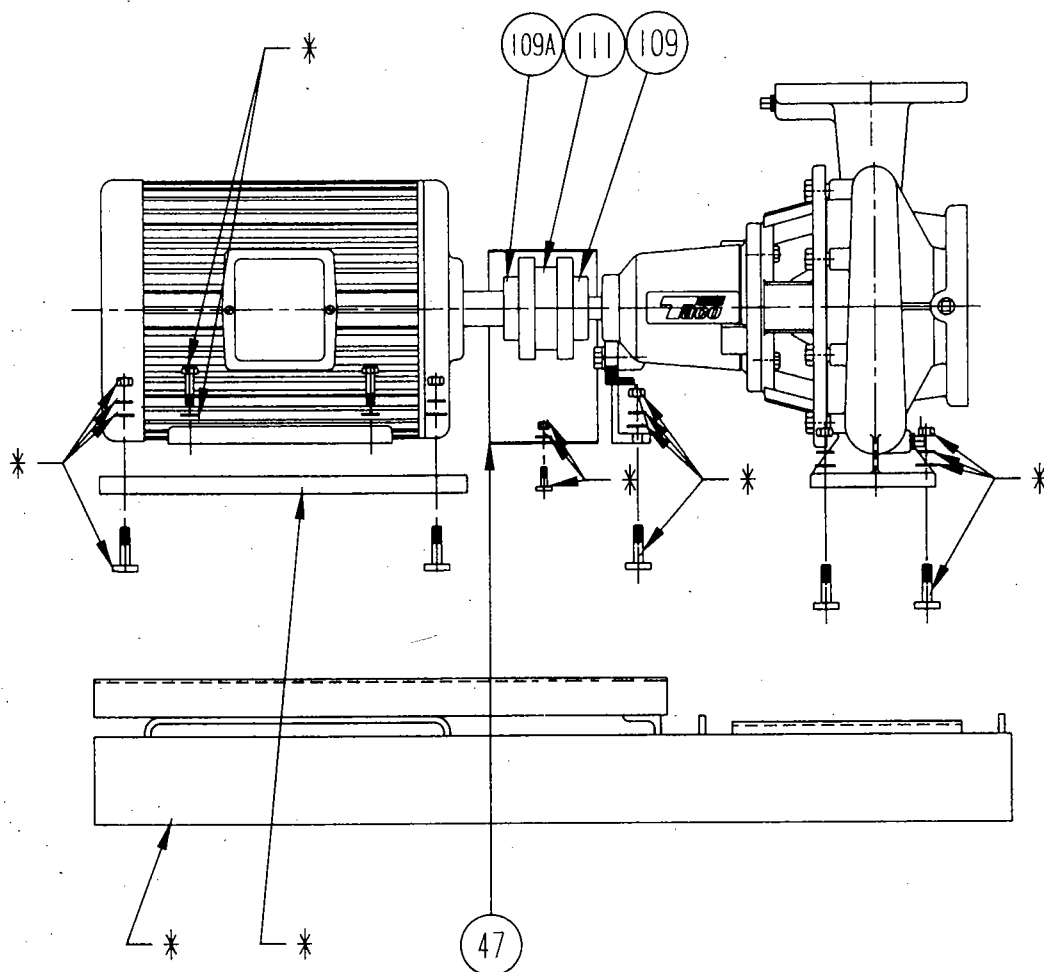

*SEE FE BASE HARDWARE SPREAD SHEET FOR ALL PUMPS

FOR FE PUMPS NO. 2506												
ITEM NO.	NO. REQ.	DESCRIPTION	MOTOR FRAME SIZE (NEMA STD.) "T"									
			56	143T	145T	182T	184T	213T	215T	254T	256T	
47	1	COUPL. GUARD	951-3075RP					951-3077RP				
109	1	PUMP COUPL. HALF	900-322RP				900-325RP					
109A	1	MTR. COUPL. HALF	900-322RP		900-324RP	900-327RP	900-328RP		900-367RP			
111	1	COUPL. INSERT	900-512RP				900-513RP					

FOR FE PUMPS NO. 1207											
ITEM NO.	NO. REQ.	DESCRIPTION	MOTOR FRAME SIZE (NEMA STD.) "T"								
			56	143T	145T	182T	184T	213T	215T	254T	256T
47	1	COUPL. GUARD	951-3074P				951-3076RP				
109	1	PUMP COUPL. HALF	900-322RP				900-325RP				
109A	1	MTR. COUPL. HALF	900-321RP	900-322RP		900-324RP	900-328RP				
111	1	COUPL. INSERT	900-512RP				900-513RP				

FOR FE PUMPS NO. 1507											
ITEM NO.	NO. REQ.	DESCRIPTION	MOTOR FRAME SIZE (NEMA STD.) "T"								
			56	143T	145T	182T	184T	213T	215T	254T	256T
47	1	COUPL. GUARD	951-3074RP				951-3076RP				
109	1	PUMP COUPL. HALF	900-322RP				900-325RP				
109A	1	MTR. COUPL. HALF	900-321RP	900-322RP		900-324RP	900-328RP				
111	1	COUPL. INSERT	900-512RP				900-513RP				

FRAME PARTS

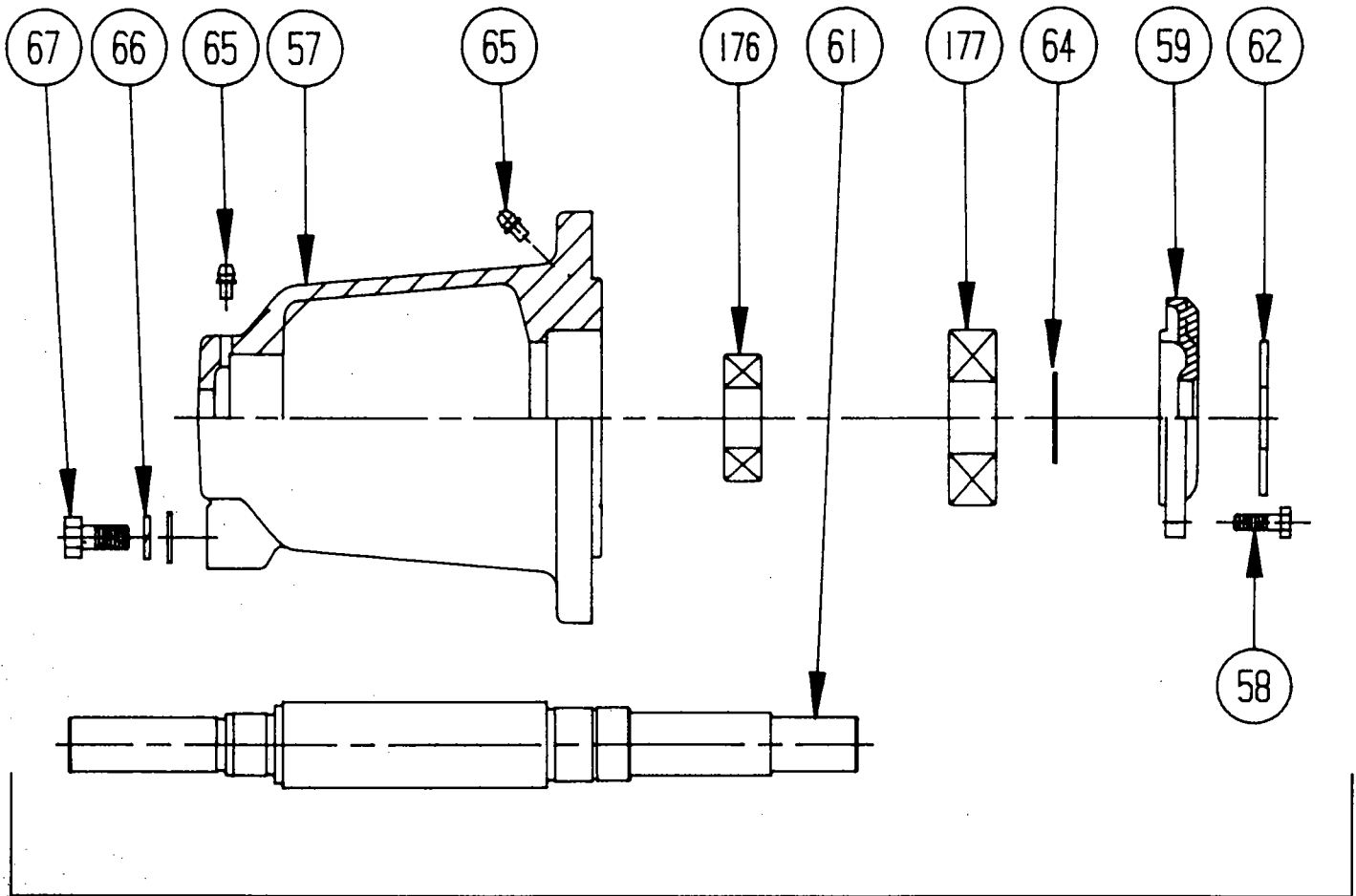

72

FRAME PARTS FOR "F" SIZE PUMP

ITEM NO.	NO. REQ.	DESCRIPTION	PART NO.	REMARKS
72	1	FRAME ASSEMBLY (CS)	951-2493RP	CARBON STEEL SHAFT
72	1	FRAME ASSEMBLY (SS)	951-2953RP	STAINLESS STEEL SHAFT
57	1	FRAME	N/A	
58	4	HEX HD. SCREWS	HARDWARE	
59	1	BEARING COVER	951-2405RP	
176	1	BALL BEARING	951-2491RP	
177	1	BALL BEARING	950-963RP	
61	1	SHAFT (CS)	951-2407RP	CARBON STEEL
61	1	SHAFT (SS)	951-2950RP	STAINLESS STEEL
62	1	DEFLECTOR	N/A	
64	1	RETAINING RING	15-140RP	
65	2	GREASE FITTING	15-203RP	
66	1	WASHER	HARDWARE	
67	1	BOLT	HARDWARE	

MECHANICAL SEAL DESIGN

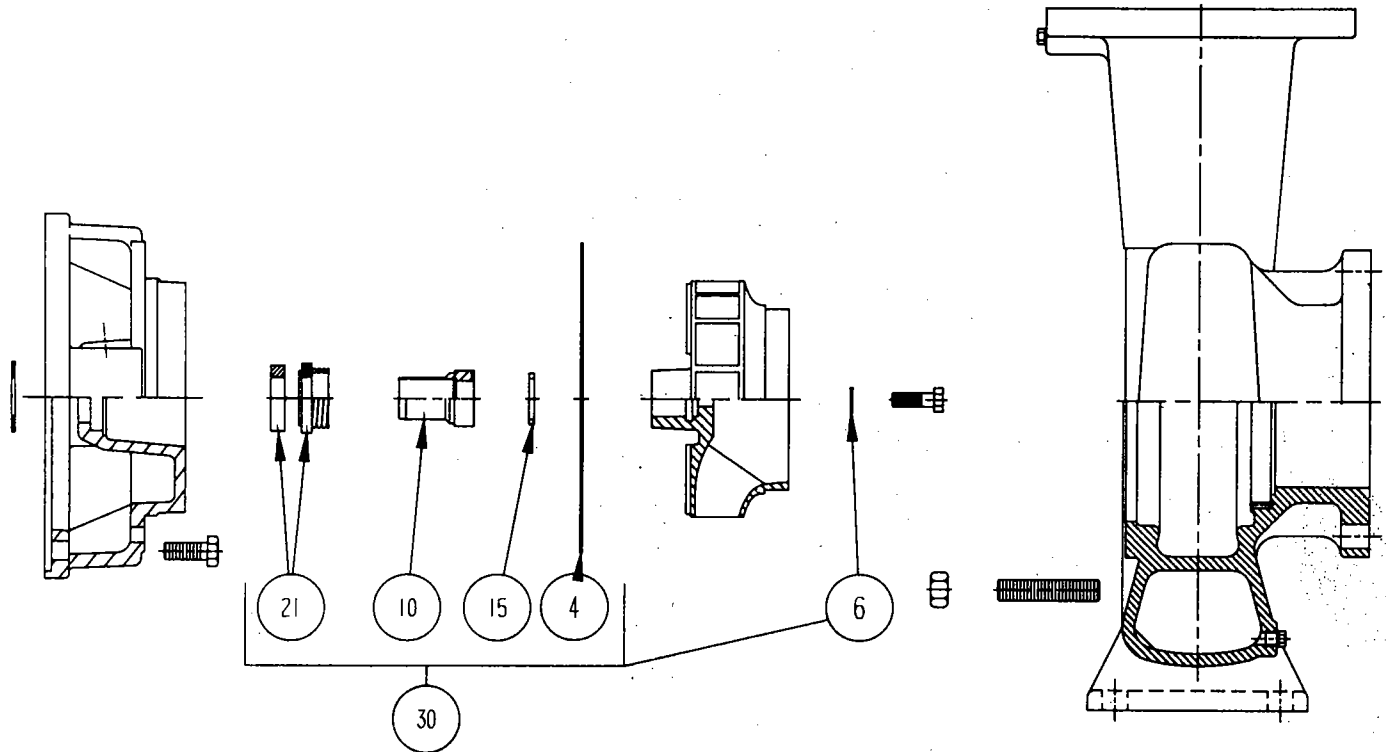

TYPE "E" STANDARD, TYPE "D" HI TEMP

ITEM NO.	NO. REQ.	DESCRIPTION	SEAL DESIGN	
			TYPE "E"	TYPE "D"
4	1	GASKET	SEE PAGE 1	
6	1	IMPELLER WASHER	951-2579RP	
10	1	SLEEVE (SS)	951-3035RP	
10	1	SLEEVE (BRZ)	951-3035BRP	
15	1	SLEEVE GASKET	951-3042RP	
30	1	SEAL KIT	951-3162SRP	951-3160SRP
30	1	SEAL KIT	951-3162BRP	951-3160BRP
21	1	WATER SEAL	951-3162RP	951-3160RP

SEAL KIT INCLUDES ITEMS NUMBER 4, 6, 10, 15 & 21.

MOTOR PARTS

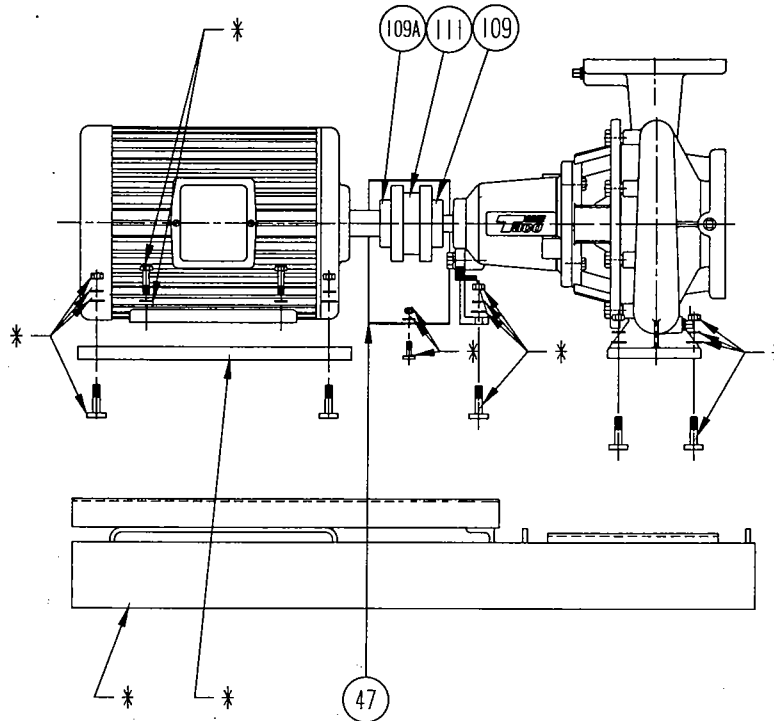

*SEE FE BASE HARDWARE SPREAD SHEET FOR ALL PUMPS

FOR FE PUMPS NO. 2507			MOTOR FRAME SIZE (NEMA STD.) "T"									
ITEM NO.	NO. REQ.	DESCRIPTION	143T	145T	182T	184T	213T	215T	254T	256T	284TS	286TS
47	1	COUPL. GUARD	951-3075RP				951-3078RP					
109	1	PUMP COUPL. HALF	900-328RP						900-364RP		900-427RP	
109A	1	MTR. COUPL. HALF	900-325RP	900-327RP	900-328RP			900-365RP		900-428RP		
111	1	COUPL. INSERT	900-513RP						900-514RP		900-515RP	

FOR FE PUMPS NO. 3007			MOTOR FRAME SIZE (NEMA STD.) "T"										
ITEM NO.	NO. REQ.	DESCRIPTION	145T	182T	184T	213T	215T	254T	256T	284TS	286TS	324TS	326TS
47	1	COUPL. GUARD	951-3076RP				951-3079RP						
109	1	PUMP COUPL. HALF	900-328RP						900-364RP		900-427RP		
109A	1	MTR. COUPL. HALF	900-325RP	900-327RP	900-328RP		951-367RP	900-365RP		900-428RP	900-437RP		
111	1	COUPL. INSERT	900-513RP						900-514RP		900-515RP		

FOR FE PUMPS NO. 2008			MOTOR FRAME SIZE (NEMA STD.) "T"									
ITEM NO.	NO. REQ.	DESCRIPTION	143T	145T	182T	184T	213T	215T	254T	256T	284TS	286TS
47	1	COUPL. GUARD	951-3075RP				951-3078RP					
109	1	PUMP COUPL. HALF	900-328RP						900-364RP		900-427RP	
109A	1	MTR. COUPL. HALF	900-325RP	900-327RP	900-328RP			900-365RP		900-428RP		
111	1	COUPL. INSERT	900-513RP						900-514RP		900-515RP	

FOR FE PUMPS NO. 2508			MOTOR FRAME SIZE (NEMA STD.) "T"										
ITEM NO.	NO. REQ.	DESCRIPTION	145T	182T	184T	213T	215T	254T	256T	284TS	286TS	324TS	326TS
47	1	COUPL. GUARD	951-3076RP				951-3079RP						
109	1	PUMP COUPL. HALF	900-328RP						900-364RP		900-427RP		
109A	1	MTR. COUPL. HALF	900-325RP	900-327RP	900-328RP		951-367RP	900-365RP		900-428RP	900-437RP		
111	1	COUPL. INSERT	900-513RP						900-514RP		900-515RP		



Replacement Parts List

304-305

FE 3008, 4008, 2510 & 3010

SUPERSEDES: 304-305 November 1, 1993

EFFECTIVE: April 15, 1995

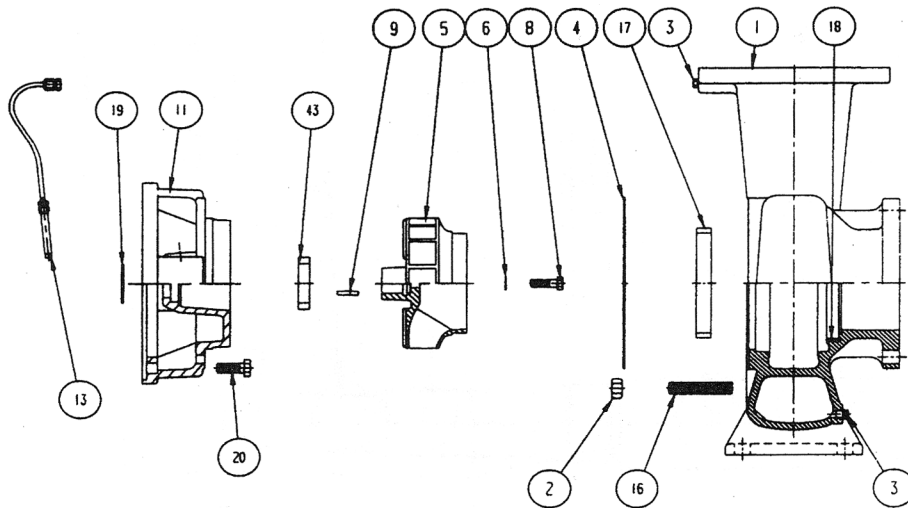
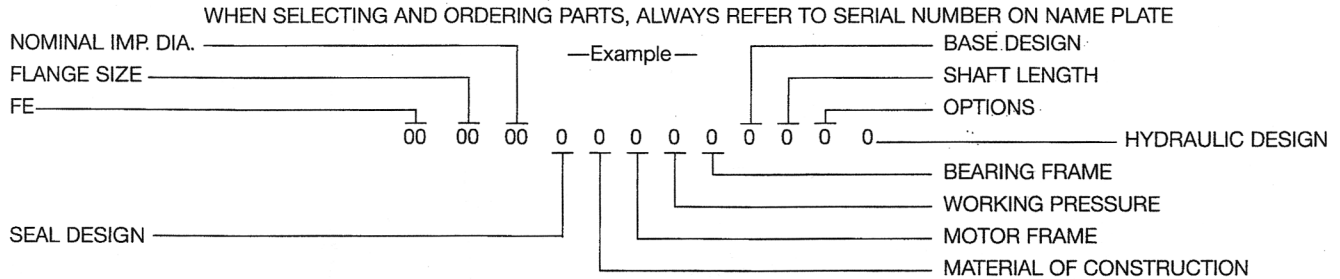

ITEM NO.	NO. REQ.	DESCRIPTION	3008	4008	2510	3010
1	1	CASING	950-1016RP	950-1017RP	950-1018RP	950-1019RP
2	.8	NUT	HARDWARE	HARDWARE	HARDWARE	HARDWARE
3	2	SQ. HEAD PLUG	HARDWARE	HARDWARE	HARDWARE	HARDWARE
4	1	GASKET	950-023RP	950-023RP	950-119RP	950-119RP
5	1	IMPELLER (CI)	950-1077RP	950-1078RP	950-1079RP	950-1080RP
5	1	IMPELLER (BRZ)	950-1077BRP	950-1078BRP	950-1079BRP	950-1080BRP
6	1	IMPELLER WASHER	951-2579RP	951-2579RP	951-2579RP	951-2579RP
8	1	IMPELLER BOLT (SS)	HARDWARE	HARDWARE	HARDWARE	HARDWARE
9	1	IMPELLER KEY (SS)	HARDWARE	HARDWARE	HARDWARE	HARDWARE
11	1	COVER	951-2290RP	951-2290RP	951-2304RP	951-2304RP
13	1	TUBE FITTING KIT	951-247RP	951-247RP	951-247RP	951-247RP
16	8	STUD	950-1159RP	950-1159RP	950-1159RP	950-1159RP
17	1	WEAR RING (CI)	950-1167RP	950-1168RP	950-1166RP	950-1167RP
17	1	WEAR RING (BRZ)	950-1167BRP	950-1168BRP	950-1166BRP	950-1167BRP
18	1	DOWEL PIN	N/A	N/A	N/A	N/A
20	1	BOLT	HARDWARE			
43	1	COVER WEAR RING (CI)	N/A	N/A	N/A	N/A
43	1	COVER WEAR RING (BRZ)	N/A	N/A	N/A	N/A

COMPARE. YOU'LL TAKE TACO.

TACO, INC., 1160 Cranston Street, Cranston, RI 02920 Telephone: (401) 942-8000 FAX: (401) 942-2360.

TACO (Canada), Ltd., 6180 Ordan Drive, Mississauga, Ontario L5T 2B3. Telephone: 905/564-9422. FAX: 905/564-9436.

Printed in USA
Copyright © 2005
TACO, INC.

FRAME PARTS

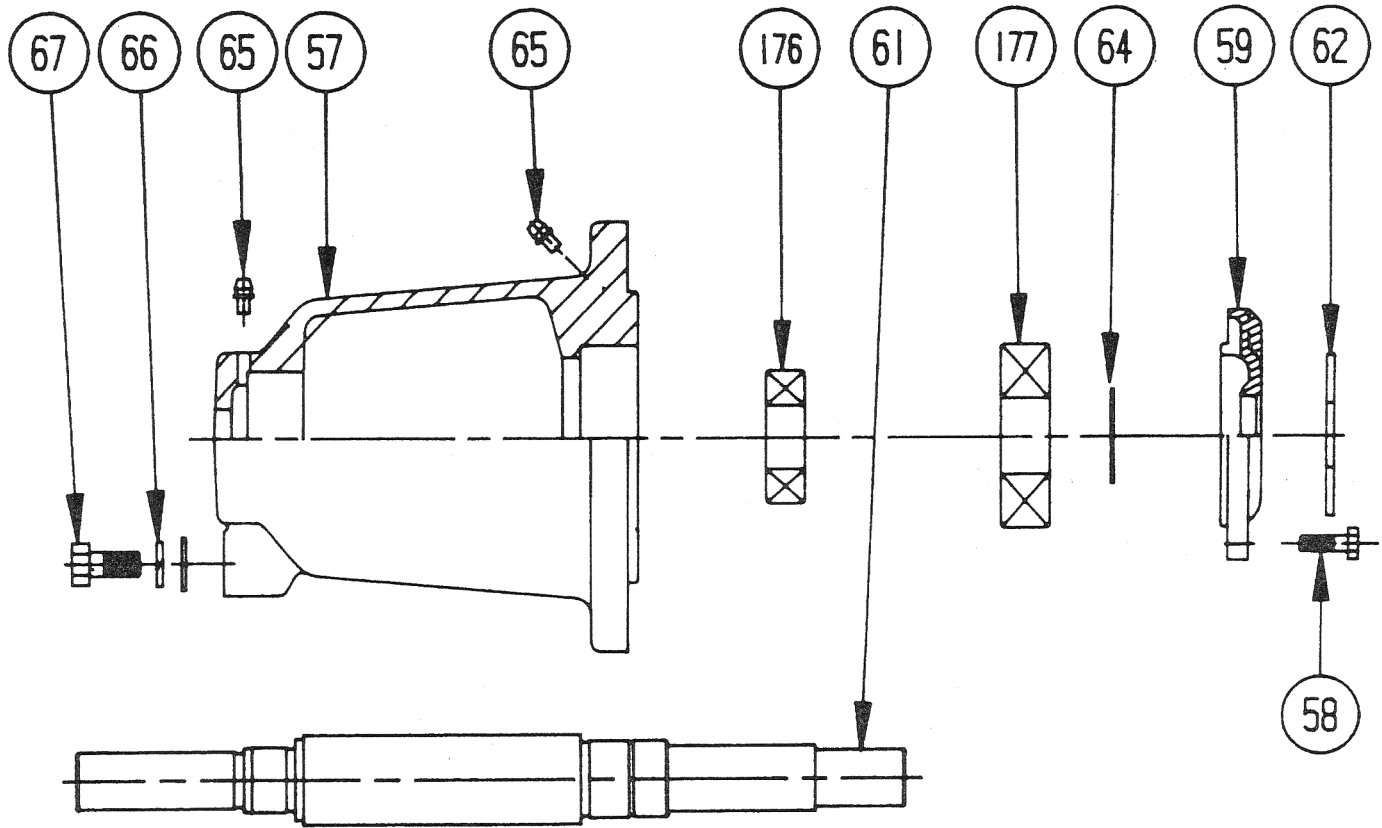

72

FRAME PARTS FOR "F" SIZE PUMP

ITEM NO.	NO. REQ.	DESCRIPTION	PART NO.	REMARKS
72	1	FRAME ASSEMBLY (CS)	951-2493RP	CARBON STEEL SHAFT
72	1	FRAME ASSEMBLY (SS)	951-2953RP	STAINLESS STEEL SHAFT
57	1	FRAME	N/A	
58	4	HEX HD. SCREWS	HARDWARE	
59	1	BEARING COVER	951-2405RP	
176	1	BALL BEARING	951-2491RP	
177	1	BALL BEARING	950-963RP	
61	1	SHAFT (CS)	951-2407RP	CARBON STEEL
61	1	SHAFT (SS)	951-2950RP	STAINLESS STEEL
62	1	DEFLECTOR	N/A	
64	1	RETAINING RING	15-140RP	
65	2	GREASE FITTING	15-203RP	
66	1	WASHER	HARDWARE	
67	1	BOLT	HARDWARE	

MECHANICAL SEAL DESIGN

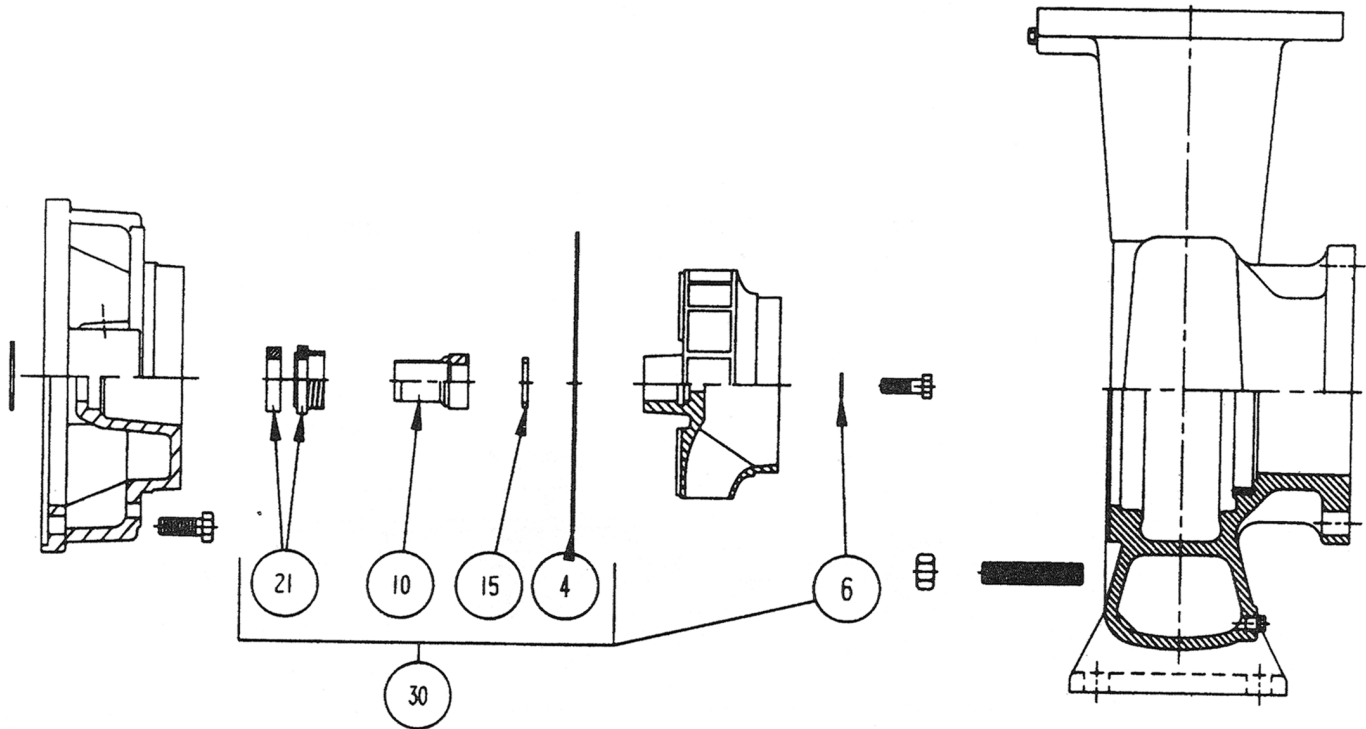

TYPE "E" STANDARD, TYPE "D" HI TEMP

ITEM NO.	NO. REQ.	DESCRIPTION	SEAL DESIGN	
			TYPE "E"	TYPE "D"
4	1	GASKET	SEE PAGE 1	
6	1	IMPELLER WASHER	951-2579RP	
10	1	SLEEVE (SS)	951-3035RP	
10	1	SLEEVE (BRZ)	951-3035BRP	
15	1	SLEEVE GASKET	951-3042RP	
30	1	SEAL KIT	951-3162SRP	951-3160SRP
30	1	SEAL KIT	951-3162BRP	951-3160BRP
21	1	WATER SEAL	951-3162RP	951-3160RP

SEAL KIT INCLUDES ITEMS NUMBER 4, 6, 10, 15 & 21.

MOTOR PARTS

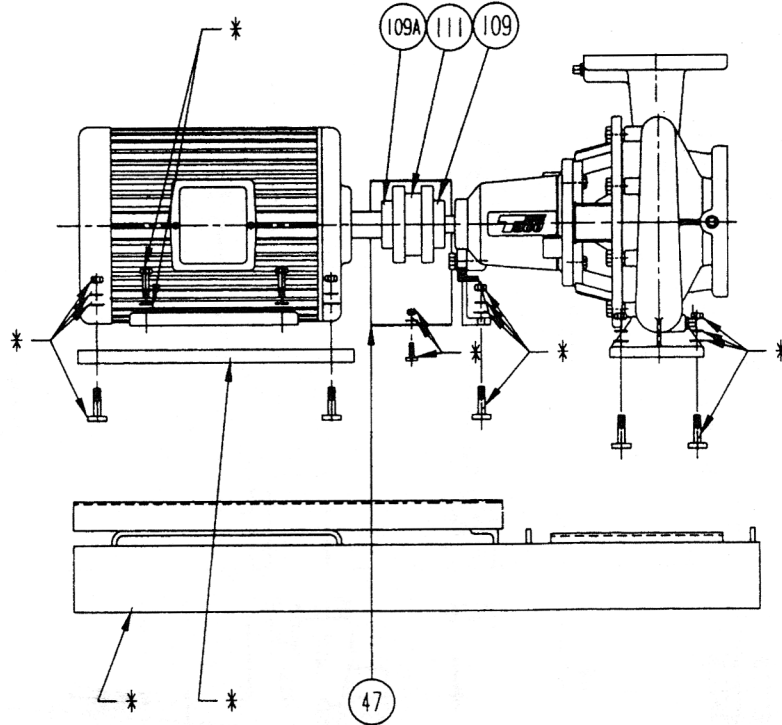

***SEE FE BASE HARDWARE SPREAD SHEET FOR ALL PUMPS**

FOR FE PUMPS NO. 3008							
ITEM NO.	NO. REQ.	DESCRIPTION	MOTOR FRAME SIZE (NEMA STD.) "T"				
			184T	213T	215T	254T	256T
47	1	COUPL. GUARD	951-3077RP				
109	1	PUMP COUPL. HALF	900-328RP		900-364RP		
109A	1	MTR. COUPL. HALF	900-327RP	900-328RP		900-365RP	
111	1	COUPL. INSERT	900-513RP		900-514RP		

FOR FE PUMPS NO. 4008							
ITEM NO.	NO. REQ.	DESCRIPTION	MOTOR FRAME SIZE (NEMA STD.) "T"				
			184T	213T	215T	254T	256T
47	1	COUPL. GUARD	951-3077RP				
109	1	PUMP COUPL. HALF	900-328RP		900-364RP	900-427RP	
109A	1	MTR. COUPL. HALF	900-327RP	900-328RP		900-365RP	900-428RP
111	1	COUPL. INSERT	900-513RP		900-514RP	900-515RP	

FOR FE PUMPS NO. 2510							
ITEM NO.	NO. REQ.	DESCRIPTION	MOTOR FRAME SIZE (NEMA STD.) "T"				
			184T	213T	215T	254T	256T
47	1	COUPL. GUARD	951-3077RP				
109	1	PUMP COUPL. HALF	900-328RP		900-364RP	900-427RP	
109A	1	MTR. COUPL. HALF	900-327RP	900-328RP		900-365RP	900-428RP
111	1	COUPL. INSERT	900-513RP		900-514RP	900-515RP	

FOR FE PUMPS NO. 3010								
ITEM NO.	NO. REQ.	DESCRIPTION	MOTOR FRAME SIZE (NEMA STD.) "T"					
			184T	213T	215T	254T	256T	284T
47	1	COUPL. GUARD	951-3078RP					
109	1	PUMP COUPL. HALF	900-364RP	900-328RP		900-364RP	900-427RP	
109A	1	MTR. COUPL. HALF	951-368RP	900-328RP		900-365RP	900-428RP	900-437RP
111	1	COUPL. INSERT	900-513RP		900-514RP	900-515RP		



Replacement Parts List

304-306

FE 4010, 5010, 2513 & 3013

SUPERSEDES: November 1, 1993

EFFECTIVE: November 1, 1996

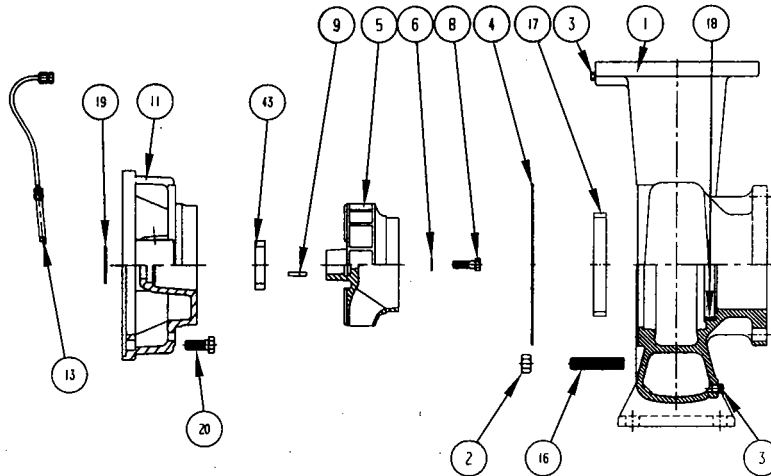
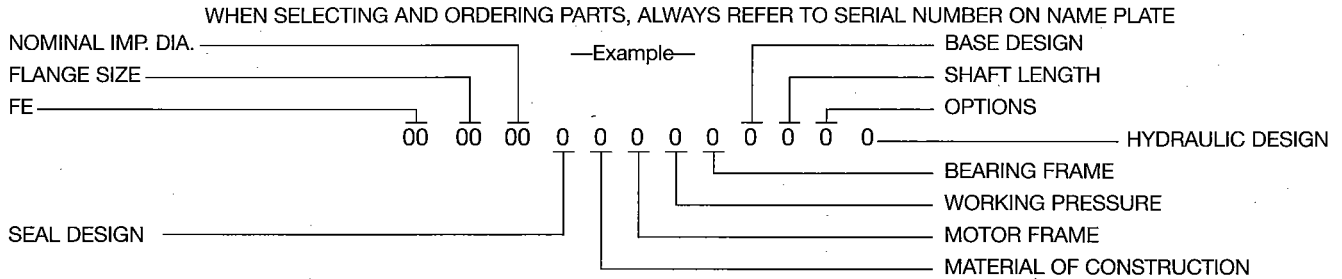

ITEM NO.	NO. REQ.	DESCRIPTION	4010	5010	2513	3013
1	1	CASING	950-1020RP	950-1021RP	950-1022RP	950-1023RP
2	8	NUT	HARDWARE	HARDWARE	HARDWARE	HARDWARE
3	2	SQ. HEAD PLUG	HARDWARE	HARDWARE	HARDWARE	HARDWARE
4	1	GASKET	950-119RP	950-119RP	950-077RP	950-077RP
5	1	IMPELLER (CI)	950-1081RP	950-1082RP	950-1083RP	950-1084RP
5	1	IMPELLER (BRZ)	950-1081BRP	950-1082BRP	950-1083BRP	950-1084BRP
6	1	IMPELLER WASHER	951-2579RP	951-2579RP	951-2579RP	951-2579RP
8	1	IMPELLER BOLT (SS)	HARDWARE	HARDWARE	HARDWARE	HARDWARE
9	1	IMPELLER KEY (SS)	HARDWARE	HARDWARE	HARDWARE	HARDWARE
11	1	COVER	951-2425RP	951-2425RP	951-2427RP	951-4049RP
13	1	TUBE FITTING KIT	951-247RP	951-247RP	951-247RP	951-247RP
16	8	BOLT/STUD	HARDWARE	HARDWARE	950-1159RP	950-1159RP
17	1	WEAR RING (CI)	950-1168RP	950-1169RP	950-1167RP	950-1170RP
17	1	WEAR RING (BRZ)	950-1168BRP	950-1169BRP	950-1167BRP	950-1170BRP
18	1	DOWEL PIN	N/A	N/A	N/A	N/A
20	1	BOLT	HARDWARE			
43	1	COVER WEAR RING (CI)	N/A	N/A	950-1184RP	950-1185RP
43	1	COVER WEAR RING (BRZ)	N/A	N/A	950-1184BRP	950-1185BRP

COMPARE. YOU'LL TAKE TACO.

TACO, INC., 1160 Cranston Street, Cranston, RI 02920 Telephone: (401) 942-8000 FAX: (401) 942-2360.

TACO (Canada), Ltd., 6180 Ordan Drive, Mississauga, Ontario L5T 2B3. Telephone: 905/564-9422. FAX: 905/564-9436.

Printed in USA
Copyright 1996
TACO, Inc.

FRAME PARTS

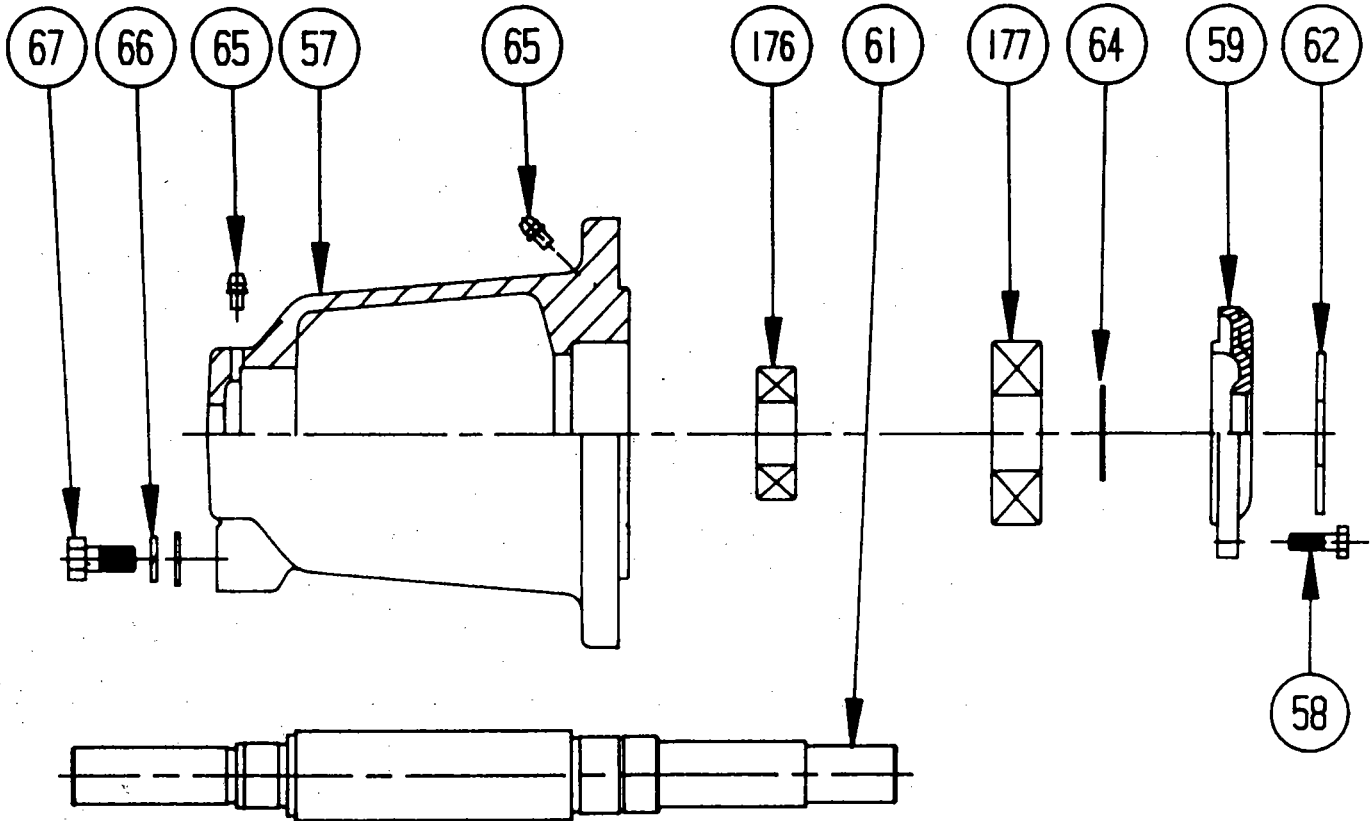

72

FRAME PARTS FOR "G" SIZE PUMP

ITEM NO.	NO. REQ.	DESCRIPTION	PART NO.	REMARKS
72	1	FRAME ASSEMBLY (CS)	951-2494RP	CARBON STEEL SHAFT
72	1	FRAME ASSEMBLY (SS)	951-2954RP	STAINLESS STEEL SHAFT
57	1	FRAME	N/A	
58	4	HEX HD. SCREWS	HARDWARE	
59	1	BEARING COVER	951-2406RP	
176	1	BALL BEARING	951-2491RP	
177	1	BALL BEARING	872-056RP	
61	1	SHAFT (CS)	951-2408RP	CARBON STEEL
61	1	SHAFT (SS)	951-2951RP	STAINLESS STEEL
62	1	DEFLECTOR	N/A	
64	1	RETAINING RING	15-141RP	
65	2	GREASE FITTING	15-203RP	
66	1	WASHER	HARDWARE	
67	1	BOLT	HARDWARE	

MECHANICAL SEAL DESIGN

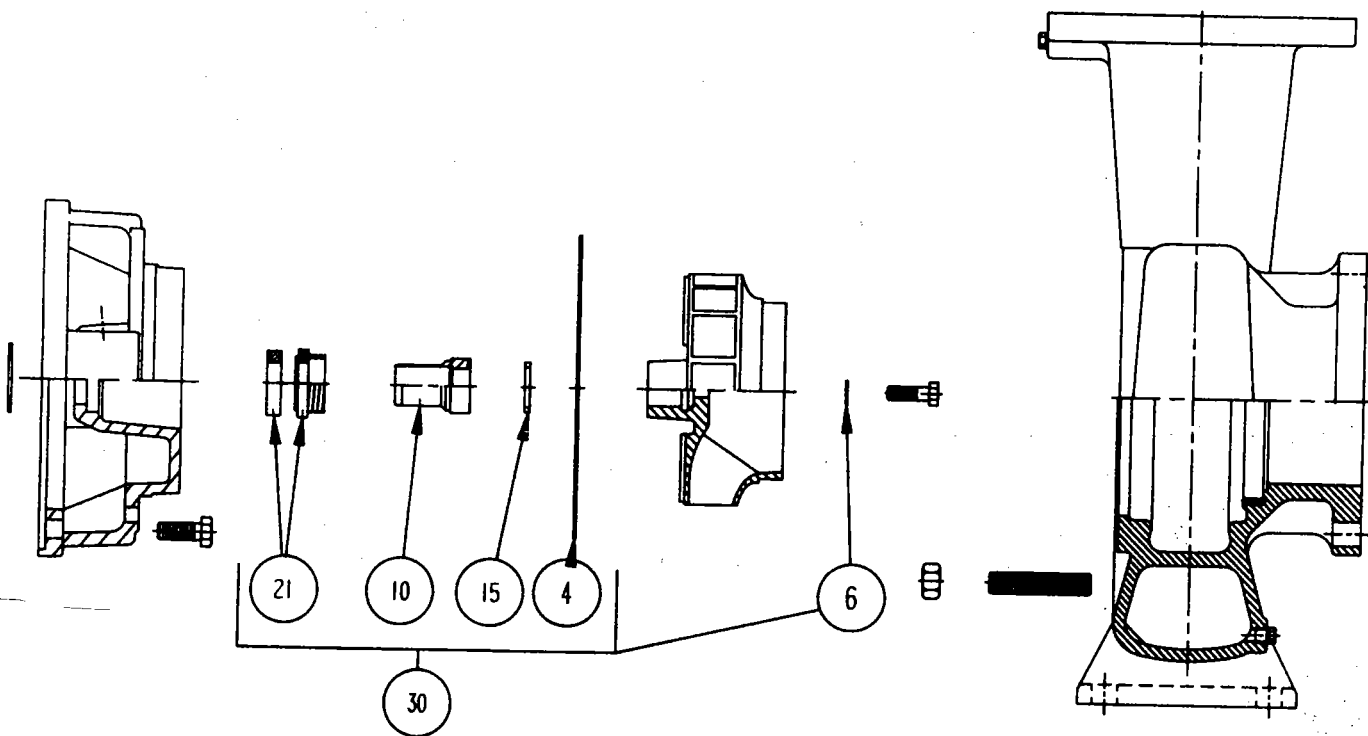

TYPE "E" STANDARD, TYPE "D" HI TEMP

4010 & 5010				2513 & 3013					
ITEM NO.	NO. REQ.	DESCRIPTION	SEAL DESIGN		ITEM NO.	NO. REQ.	DESCRIPTION	SEAL DESIGN	
			TYPE "E"	TYPE "D"				TYPE "E"	TYPE "D"
4	1	GASKET	SEE PAGE 1		4	1	GASKET	SEE PAGE 1	
6	1	IMPELLER WASHER	950-047RP		6	1	IMPELLER WASHER	950-047RP	
10	1	SLEEVE (SS)	951-3038RP		10	1	SLEEVE (SS)	951-3037RP	
10	1	SLEEVE (BRZ)	951-3038BRP		10	1	SLEEVE (BRZ)	951-3037BRP	
15	1	SLEEVE GASKET	951-3066RP		15	1	SLEEVE GASKET	951-3066RP	
30	1	SEAL KIT	950-1369SRP	950-1370SRP	30	1	SEAL KIT	951-2968SRP	951-2967SRP
30	1	SEAL KIT	950-1369BRP	950-1370BRP	30	1	SEAL KIT	951-2968BRP	951-2967BRP
21	1	WATER SEAL	951-2968RP 951-2967RP		21	1	WATER SEAL	951-2968RP 951-2967RP	

MOTOR PARTS

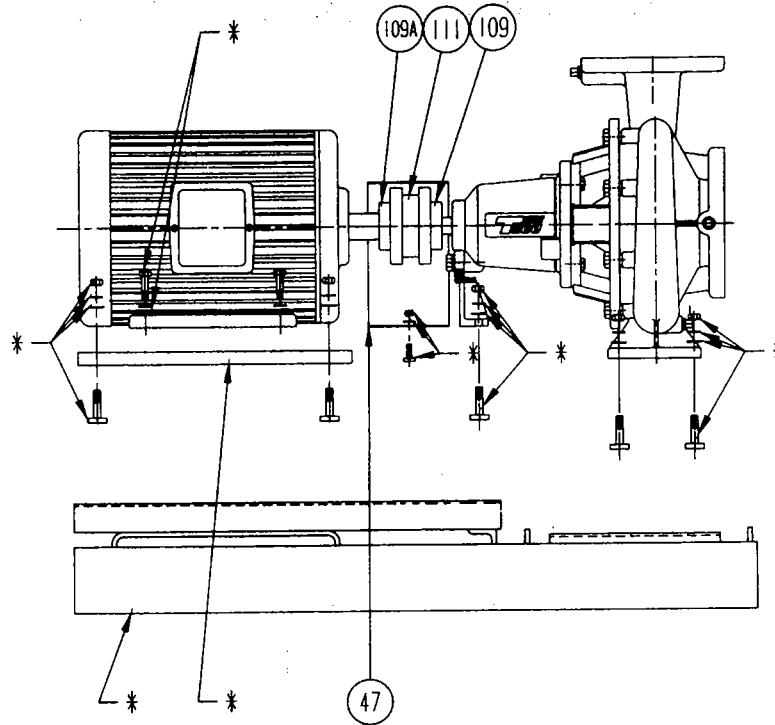

***SEE FE BASE HARDWARE SPREAD SHEET FOR ALL PUMPS**

FOR FE PUMPS NO. 4010			MOTOR FRAME SIZE (NEMA STD.) "T"						
ITEM NO.	NO. REQ.	DESCRIPTION	213T	215T	254T	256T	284T	286T	324T
47	1	COUPL. GUARD	951-3079RP						
109	1	PUMP COUPL. HALF	951-367RP	900-365RP	900-428RP	900-494RP			
109A	1	MTR. COUPL. HALF	951-364RP	900-365RP	900-428RP	900-437RP	900-495RP	900-497RP	
111	1	COUPL. INSERT	900-513RP	900-514RP	900-515RP	900-516RP			

FOR FE PUMPS NO. 5010			MOTOR FRAME SIZE (NEMA STD.) "T"							
ITEM NO.	NO. REQ.	DESCRIPTION	213T	215T	254T	256T	284T	286T	324T	326T
47	1	COUPL. GUARD	951-3079RP							
109	1	PUMP COUPL. HALF	951-367RP	900-365RP	900-428RP	900-494RP				
109A	1	MTR. COUPL. HALF	951-364RP	900-365RP	900-428RP	900-437RP	900-495RP	900-497RP		
111	1	COUPL. INSERT	900-513RP	900-514RP	900-515RP	900-516RP				

FOR FE PUMPS NO. 2513			MOTOR FRAME SIZE (NEMA STD.) "T"						
ITEM NO.	NO. REQ.	DESCRIPTION	184T	213T	215T	254T	256T	284T	286T
47	1	COUPL. GUARD	951-3078RP						
109	1	PUMP COUPL. HALF	951-367RP	900-365RP		900-428RP	900-494RP		
109A	1	MTR. COUPL. HALF	951-368RP	900-364RP	900-365RP	900-428RP	900-437RP	900-495RP	
111	1	COUPL. INSERT	900-513RP	900-514RP		900-515RP	900-516RP		

FOR FE PUMPS NO. 3013			MOTOR FRAME SIZE (NEMA STD.) "T"							
ITEM NO.	NO. REQ.	DESCRIPTION	213T	215T	254T	256T	284T	286T	324T	326T
47	1	COUPL. GUARD	951-3079RP							
109	1	PUMP COUPL. HALF	951-367RP	900-365RP	900-428RP	900-494RP				
109A	1	MTR. COUPL. HALF	951-364RP	900-365RP	900-428RP	900-437RP	900-495RP	900-497RP		
111	1	COUPL. INSERT	900-513RP	900-514RP	900-515RP	900-516RP				



Replacement Parts List

304-307

FE 4013, 5013 & 6013

SUPERSEDES: NOVEMBER 1, 1993

EFFECTIVE: November 1, 1996

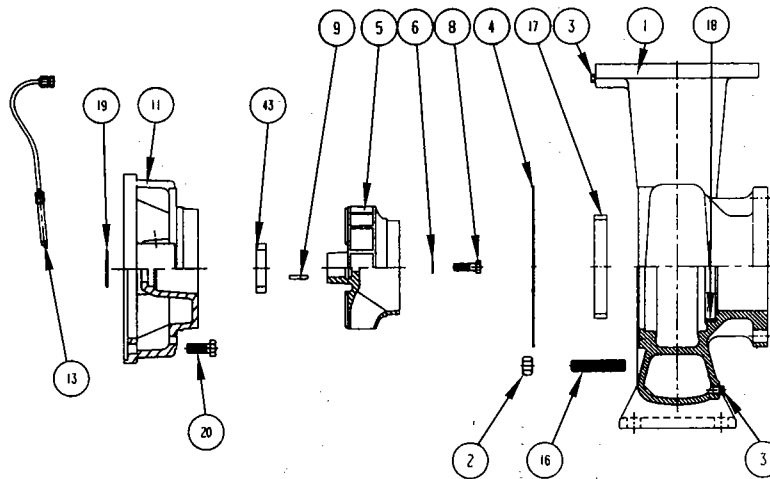
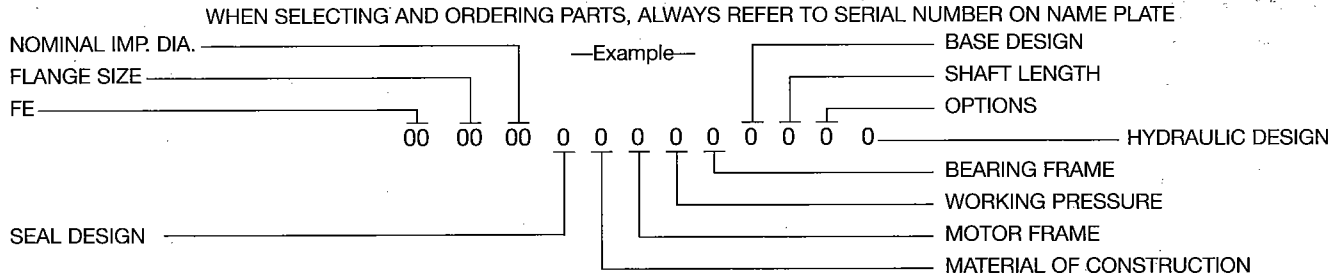

ITEM NO.	NO. REQ.	DESCRIPTION	4013	5013	6013
1	1	CASING	950-1024RP	950-1025RP	950-1026RP
2	8	NUT	HARDWARE	HARDWARE	HARDWARE
3	2	SQ. HEAD PLUG	HARDWARE	HARDWARE	HARDWARE
4	1	GASKET	950-077RP	950-077RP	950-077RP
5	1	IMPELLER (CI)	950-1085RP	950-1086RP	950-1087RP
5	1	IMPELLER (BRZ)	950-1085BRP	950-1086BRP	950-1087BRP
6	1	IMPELLER WASHER	951-2579RP	951-2579RP	951-2579RP
8	1	IMPELLER BOLT (SS)	HARDWARE	HARDWARE	HARDWARE
9	1	IMPELLER KEY (SS)	HARDWARE	HARDWARE	HARDWARE
11	1	COVER	951-4050RP	951-2428RP	951-4051RP
13	1	TUBE FITTING KIT	951-247RP	951-247RP	951-247RP
16	8	STUD	950-1159RP	950-1159RP	950-1159RP
17	1	WEAR RING (CI)	950-1168RP	950-1169RP	950-1171RP
17	1	WEAR RING (BRZ)	950-1168BRP	950-1169BRP	950-1171BRP
18	1	DOWEL PIN	N/A	N/A	N/A
20	1	BOLT		HARDWARE	
43	1	COVER WEAR RING (CI)	950-1186RP	950-1182RP	950-1171RP
43	1	COVER WEAR RING (BRZ)	950-1186BRP	950-1182BRP	950-1171BRP

COMPARE. YOU'LL TAKE TACO.

TACO, INC., 1160 Cranston Street, Cranston, RI 02920 Telephone: (401) 942-8000 FAX: (401) 942-2360.

TACO (Canada), Ltd., 6180 Ordan Drive, Mississauga, Ontario L5T 2B3. Telephone: 905/564-9422. FAX: 905/564-9436.

Printed in USA
 Copyright 1996
 TACO, Inc.

FRAME PARTS

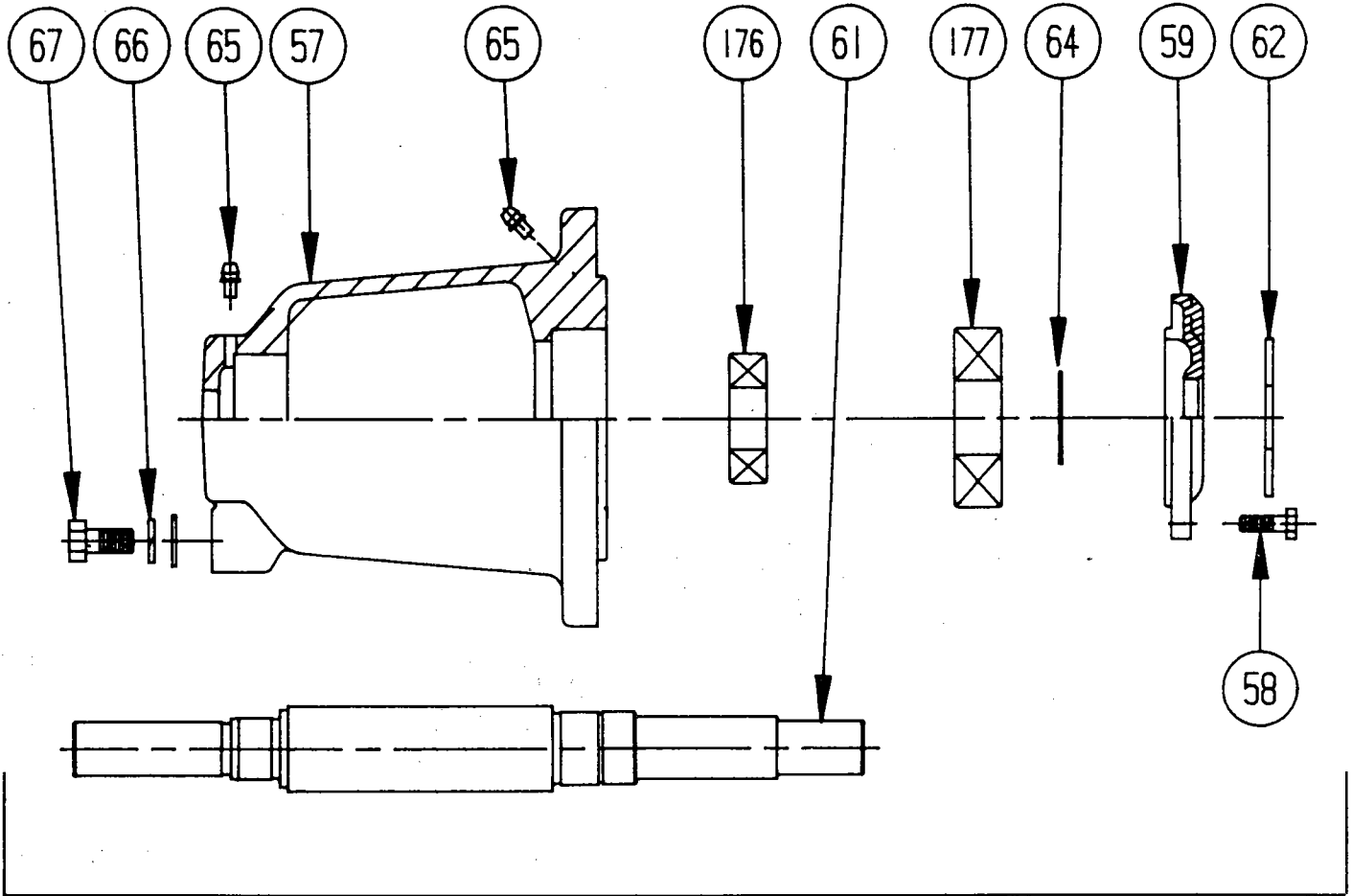

72

FRAME PARTS FOR "G" SIZE PUMP

ITEM NO.	NO. REQ.	DESCRIPTION	PART NO.	REMARKS
72	1	FRAME ASSEMBLY (CS)	951-2494RP	CARBON STEEL SHAFT
72	1	FRAME ASSEMBLY (SS)	951-2954RP	STAINLESS STEEL SHAFT
57	1	FRAME	N/A	
58	4	HEX HD. SCREWS	HARDWARE	
59	1	BEARING COVER	951-2406RP	
176	1	BALL BEARING	951-2491RP	
177	1	BALL BEARING	872-056RP	
61	1	SHAFT (CS)	951-2408RP	CARBON STEEL
61	1	SHAFT (SS)	951-2951RP	STAINLESS STEEL
62	1	DEFLECTOR	N/A	
64	1	RETAINING RING	15-141RP	
65	2	GREASE FITTING	15-203RP	
66	1	WASHER	HARDWARE	
67	1	BOLT	HARDWARE	

MECHANICAL SEAL DESIGN

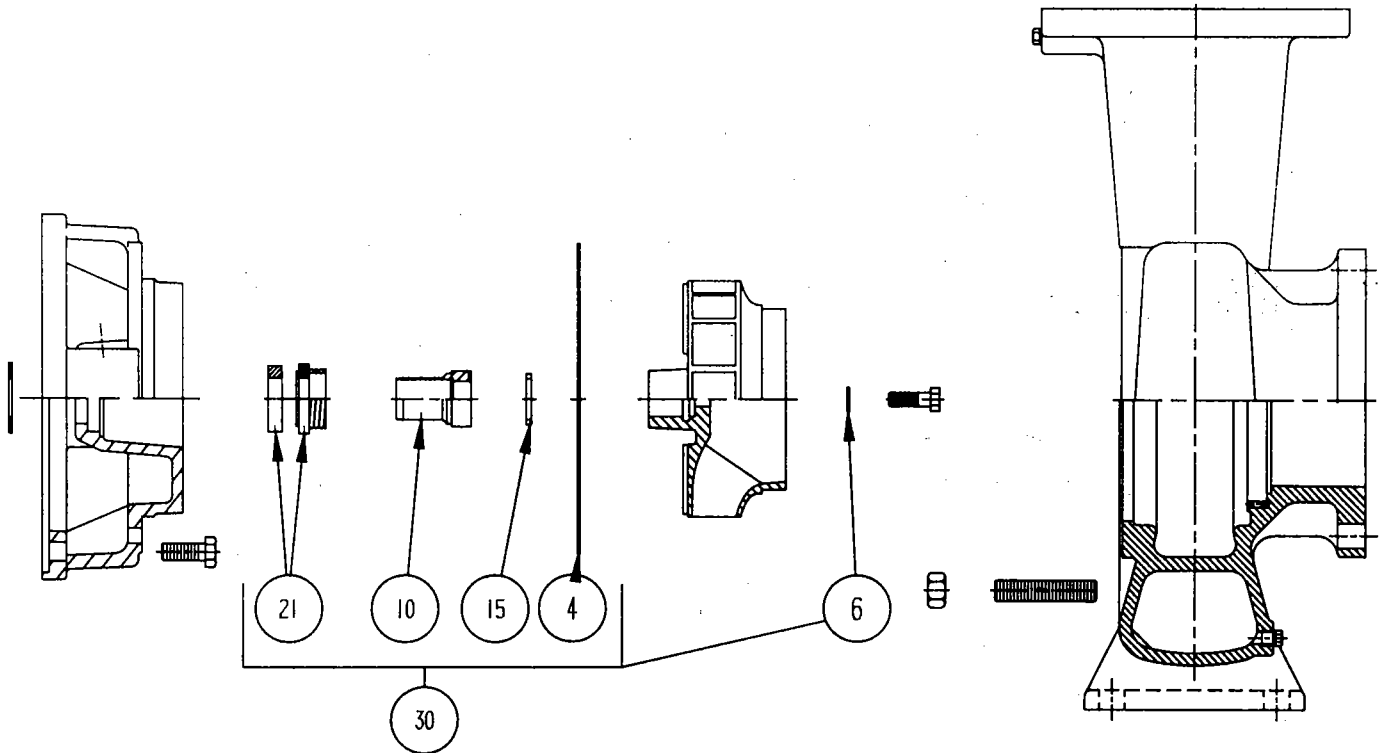

TYPE "E" STANDARD, TYPE "D" HI TEMP

ITEM NO.	NO. REQ.	DESCRIPTION	SEAL DESIGN	
			TYPE "E"	TYPE "D"
4	1	GASKET	SEE PAGE 1	
6	1	IMPELLER WASHER	951-2579RP	
10	1	SLEEVE (SS)	951-3037RP	
10	1	SLEEVE (BRZ)	951-3037BRP	
15	1	SLEEVE GASKET	951-3066RP	
30	1	SEAL KIT	951-2968SRP	951-2967SRP
30	1	SEAL KIT	951-2968BRP	951-2967BRP
21	1	WATER SEAL	951-2968RP	951-2967RP

SEAL KIT INCLUDES ITEMS NUMBER 4, 6, 10, 15 & 21.

MOTOR PARTS

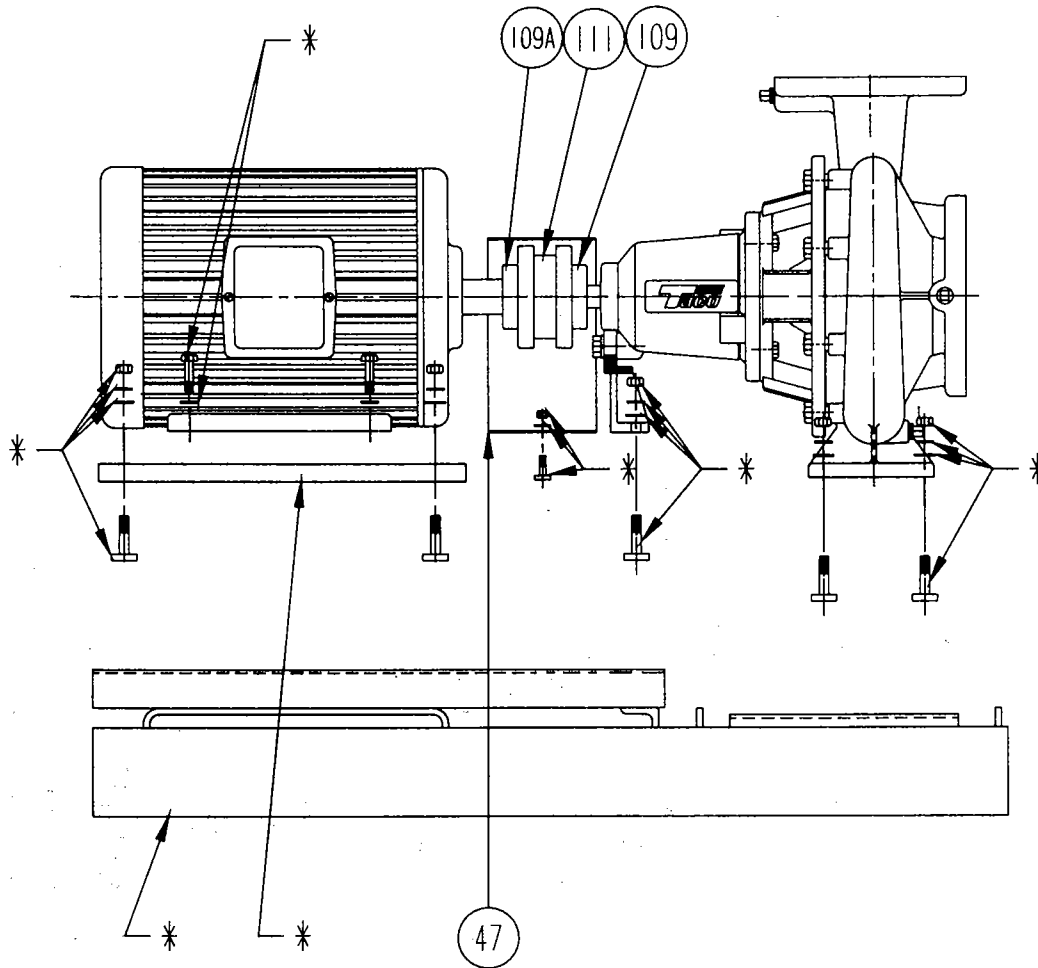

*SEE FE BASE HARDWARE SPREAD SHEET FOR ALL PUMPS

FOR FE PUMPS NO. 4013													
ITEM NO.	NO. REQ.	DESCRIPTION	MOTOR FRAME SIZE (NEMA STD.) "T"										
			213T	215T	254T	256T	284T	286T	324T	326T	364T	365T	404T
47	1	COUPL. GUARD	951-3079RP										
109	1	PUMP COUPL. HALF	951-367RP	900-365RP	900-428RP		900-494RP						
109A	1	MTR. COUPL. HALF	951-364RP	900-365RP	900-428RP	900-437RP	900-495RP	900-497RP					
111	1	COUPL. INSERT	900-513RP	900-514RP	900-515RP		900-516RP						

FOR FE PUMPS NO. 5013														
ITEM NO.	NO. REQ.	DESCRIPTION	MOTOR FRAME SIZE (NEMA STD.) "T"											
			213T	215T	254T	256T	284T	286T	324T	326T	364T	365T	404T	405T
47	1	COUPL. GUARD	951-3078RP						951-3140RP					
109	1	PUMP COUPL. HALF		951-367RP	900-365RP	900-428RP		900-494RP		950-242RP				
109A	1	MTR. COUPL. HALF		951-364RP	900-365RP	900-428RP	900-437RP	900-495RP	900-497RP	900-505RP	900-532RP			
111	1	COUPL. INSERT		900-513RP	900-514RP	900-515RP		900-516RP		900-517RP				

FOR FE PUMPS NO. 6013														
ITEM NO.	NO. REQ.	DESCRIPTION	MOTOR FRAME SIZE (NEMA STD.) "T"											
			213T	215T	254T	256T	284T	286T	324T	326T	364T	365T	404T	405T
47	1	COUPL. GUARD	951-3078RP						951-3141RP					
109	1	PUMP COUPL. HALF			900-365RP	900-428RP		900-494RP		950-242RP		950-238RP		
109A	1	MTR. COUPL. HALF			900-365RP	900-428RP	900-437RP	900-495RP	900-497RP	900-505RP	900-532RP	950-248RP	950-239RP	
111	1	COUPL. INSERT			900-514RP	900-515RP		900-516RP		900-517RP		950-241RP		

MECHANICAL SEAL DESIGN

304-308
p. 2

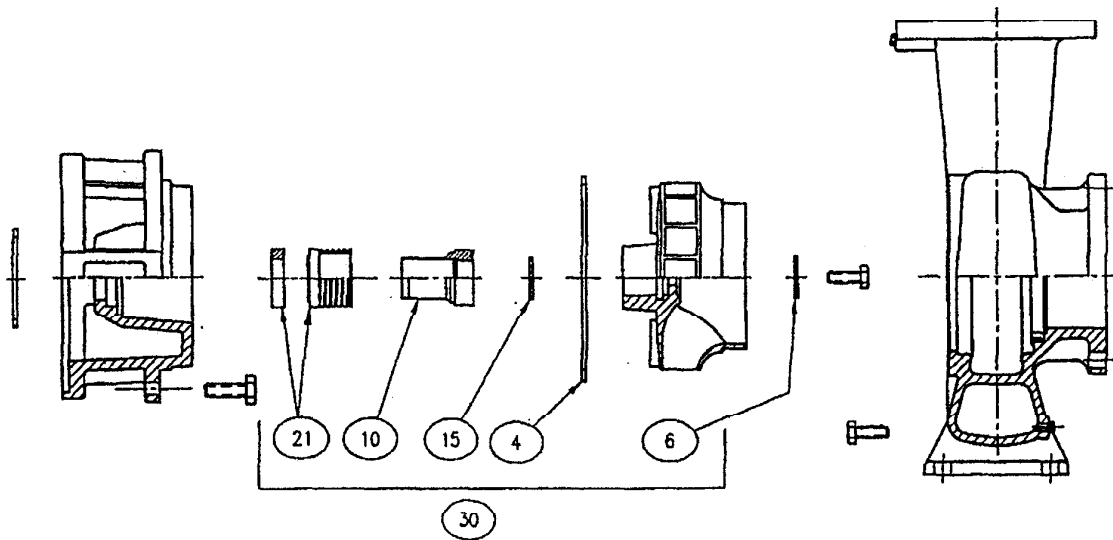

TYPE "E" STANDARD, TYPE "D" HI TEMP

ITEM NO.	NO. REQ.	DESCRIPTION	SEAL DESIGN	
			TYPE "E"	TYPE "D"
4	1	GASKET	SEE PAGE 1	
6	1	IMPELLER WASHER	951-2579RP	
10	1	SLEEVE (SS)	951-3035RP	
10	1	SLEEVE (BRZ)	951-3035BRP	
15	1	SLEEVE GASKET	951-3042RP	
30	1	SEAL KIT	951-3162SRP	951-3160SRP
30	1	SEAL KIT	951-3162BRP	951-3160BRP
21	1	WATER SEAL	951-3162RP	951-3160RP

SEAL KIT INCLUDES ITEMS NUMBER 4, 6, 10, 15 & 21.

FRAME PARTS

P.4
304-308
1.3

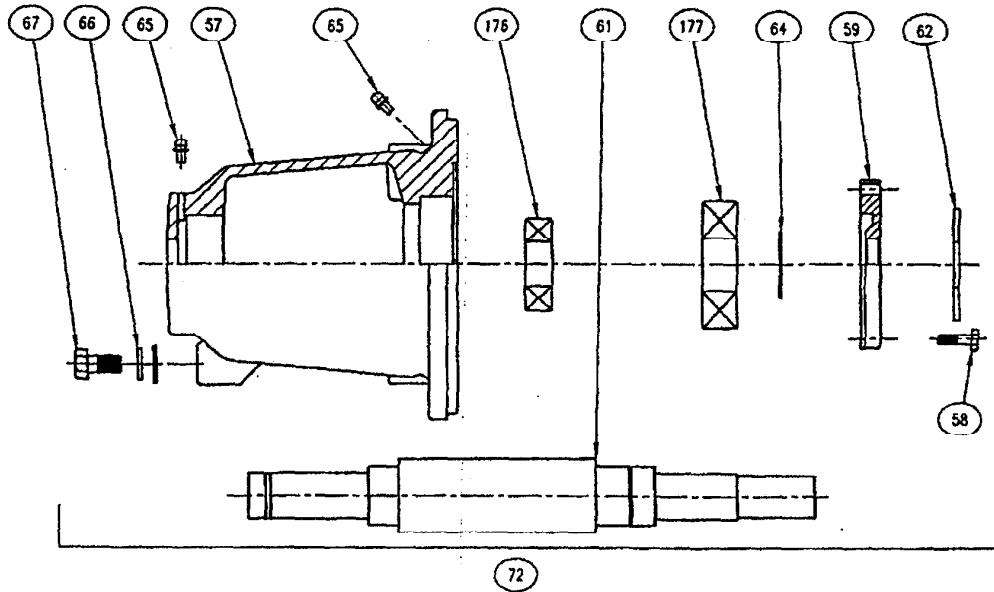

FRAME PARTS FOR "F" SIZE PUMP

ITEM NO.	NO. REQ.	DESCRIPTION	PART NO.	REMARKS
72	1	FRAME ASSEMBLY (CS)	951-2493RP	CARBON STEEL SHAFT
72	1	FRAME ASSEMBLY (SS)	951-2953RP	STAINLESS STEEL SHAFT
57	1	FRAME	N/A	
58	4	HEX HEAD SCREWS	HARDWARE	
59	1	BEARING COVER	951-2405RP	
176	1	BALL BEARING	951-2491RP	
177	1	BALL BEARING	950-963RP	
61	1	SHAFT (CS)	951-2407RP	CARBON STEEL
61	1	SHAFT (SS)	951-2950RP	CARBON STEEL
62	1	DEFLECTOR	N/A	
64	1	RETAINING RING	15-140RP	
65	2	GREASE FITTING	15-203RP	
66	1	WASHER	HARDWARE	
67	1	BOLT	HARDWARE	

P.5
304-308
P4

MOTOR PARTS

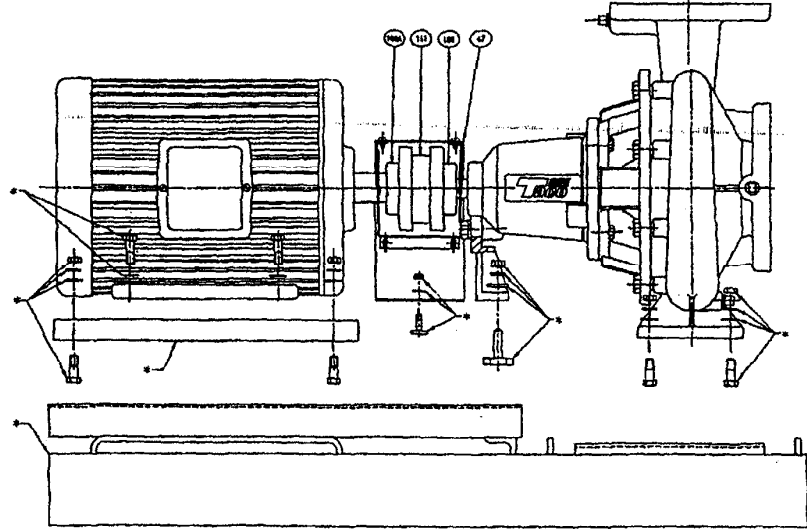

* SEE FE BASE HARDWARE SPREAD SHEET FOR ALL PUMPS

FOR FE PUMP NO. 5007

ITEM NO.	NO. REQ.	DESCRIPTION	MOTOR FRAME SIZE (NEMA STD.) "T"					
			143T	145T	182T	184T	213T	215T
47	1	COUPLER GUARD	951-3076RP					
109	1	PUMP COUPLER HALF	900-328RP					
109A	1	MOTOR COUPLER HALF	951-325RP	900-327RP		900-328RP		
111	1	COUPLER INSERT	900-513RP					

FOR FE PUMP NO. 6008

ITEM NO.	NO. REQ.	DESCRIPTION	MOTOR FRAME SIZE (NEMA STD.) "T"						
						213T	215T	254T	256T
47	1	COUPLER GUARD	951-3078RP						
109	1	PUMP COUPLER HALF			951-328RP	900-364RP	900-427RP		
109A	1	MOTOR COUPLER HALF			951-328RP	900-365RP	900-428RP	900-437RP	
111	1	COUPLER INSERT			900-513RP	900-514RP	900-515RP		

DO IT ONCE. DO IT RIGHT.

TACO, INC., 1180 Cranston Street, Cranston, RI 02920 Telephone: (401) 942-8000 FAX: (401) 942-2360.

TACO (Canada), Ltd., 6180 Ordan Drive, Mississauga, Ontario L5T 2B3. Telephone: 905/564-9422. FAX: 905/564-9436.

Printed in USA
Copyright 1988
TACO, Inc.



Replacement Parts List

304-

FE8010

SUPERSEDES: NEW

EFFECTIVE: AUG 1992

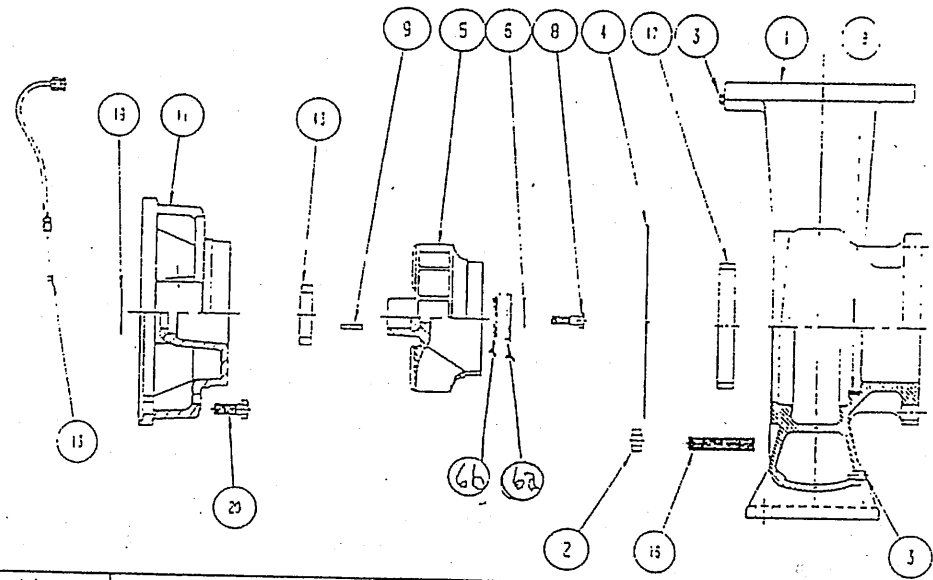
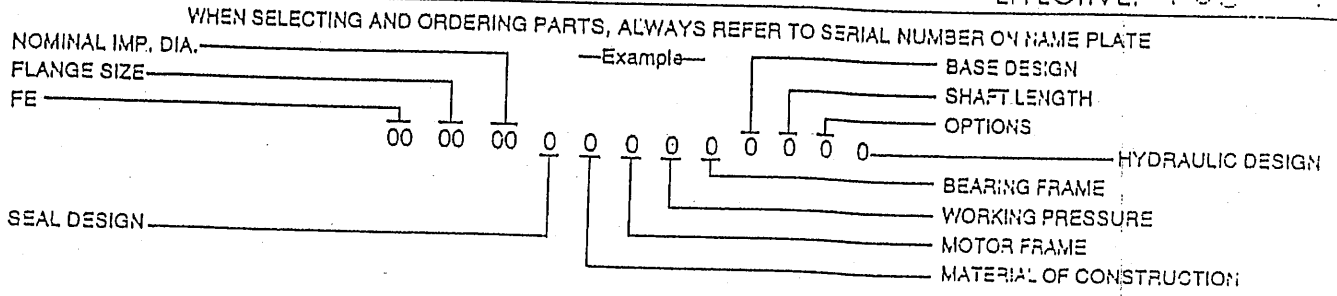

ITEM NO.	NO. REQ.	DESCRIPTION	HYDRAULIC DESIGN "A"	HYDRAULIC DESIGN "B"
1	1	CASING		
3	2	SQ. HEAD PLUG	951-3017RP	951-3807RP
4	1	GASKET	HARDWARE	HARDWARE
5	1	IMPELLER	950-119	950-119
6	1	DOWTY WASHER	951-3039RP	951-4143RP
6a	1	IMPELLER WASHER	951-2579RP	951-2579RP
6b	1	IMPELLER WASHER "O" RING	N/A	953-1099RP
8	1	IMPELLER BOLT (SS)	N/A	951-5277
9	1	IMPELLER KEY(SS)	HARDWARE	HARDWARE
11	1	COVER	HARDWARE	HARDWARE
13	1	COVER	951-2426RP	951-3812RP
13	1	TUBE FITTING KIT	951-247RP	951-247RP
16	8	BOLT	951-247RP	951-247RP
17	1	CASING WEAR RING	10-374 HARDWARE	HARDWARE
20	4	BOLT	N/A	951-3806RP
			HARDWARE	HARDWARE

COMPARE. YOU'LL TAKE TACO.

TACO, INC., 1150 Cranston Street, Cranston, RI 02923 (401) 942-8000 FAX: (401) 942-2360
 TACO (CANADA) LTD., 8150 Crean Drive, Mississauga, Ontario L5T 2B3 (905) 584-5422 FAX: (905) 584-5423

Part 304-1034

FRAME PARTS

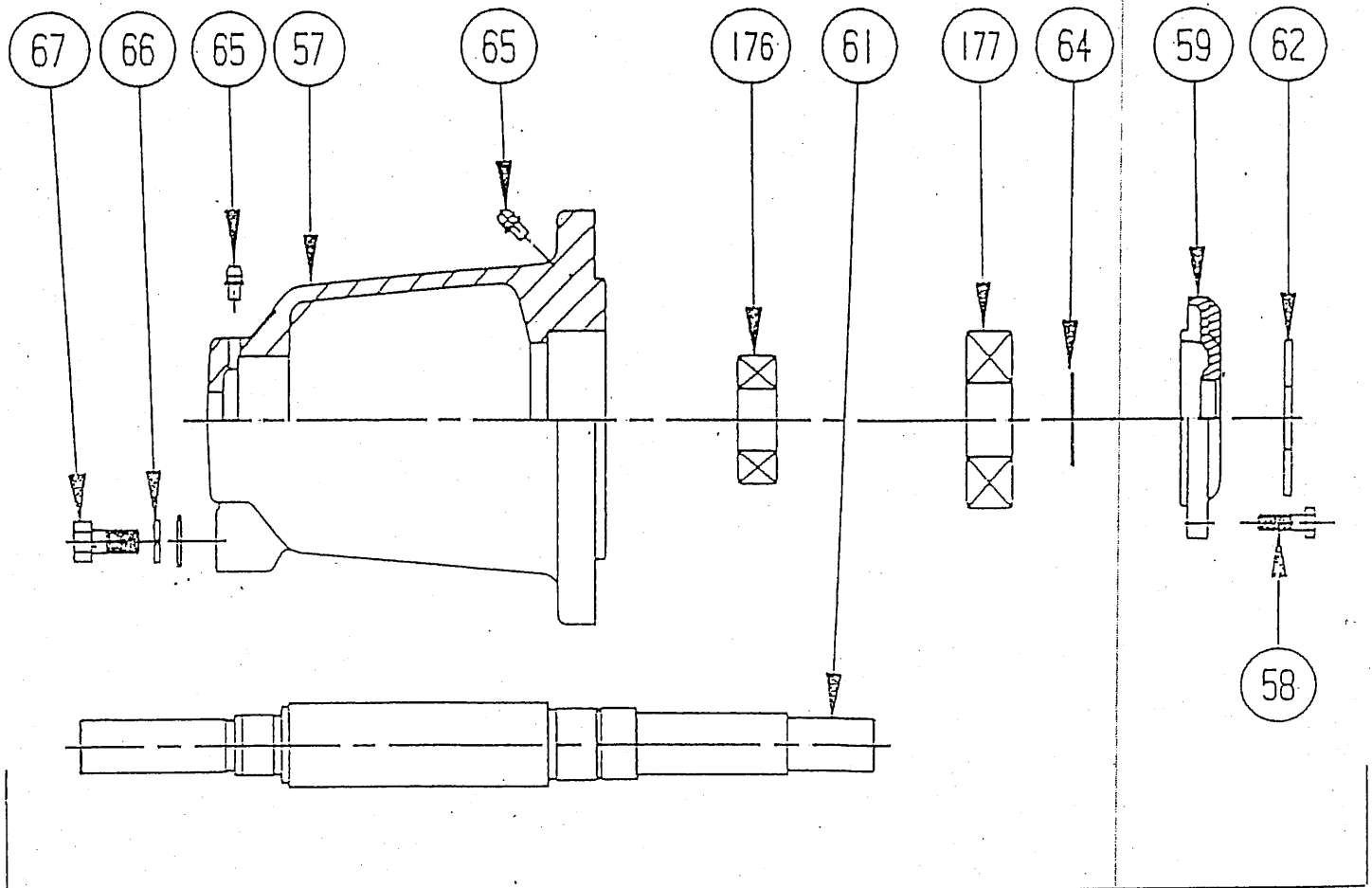

72

FRAME PARTS FOR "G" SIZE PUMP

ITEM NO.	NO. REQ.	DESCRIPTION	PART NO.	REMARKS
72	1	FRAME ASSEMBLY (CS)	951-2494RP	CARBON STEEL SHAFT
72	1	FRAME ASSEMBLY (SS)	951-2954RP	STAINLESS STEEL SHAFT
57	1	FRAME	N/A	
58	4	HEX HD. SCREWS	HARDWARE	
59	1	BEARING COVER	951-2406RP	
176	1	BALL BEARING	951-2491RP	
177	1	BALL BEARING	872-056RP	
61	1	SHAFT (CS)	951-2408RP	CARBON STEEL
51	1	SHAFT (SS)	951-2951RP	STAINLESS STEEL
62	1	DEFLECTOR	N/A	
64	1	RETAINING RING	15-141RP	
65	2	GREASE FITTING	15-203RP	
56	1	WASHER	HARDWARE	
67	1	BOLT	HARDWARE	

MECHANICAL SEAL DESIGN

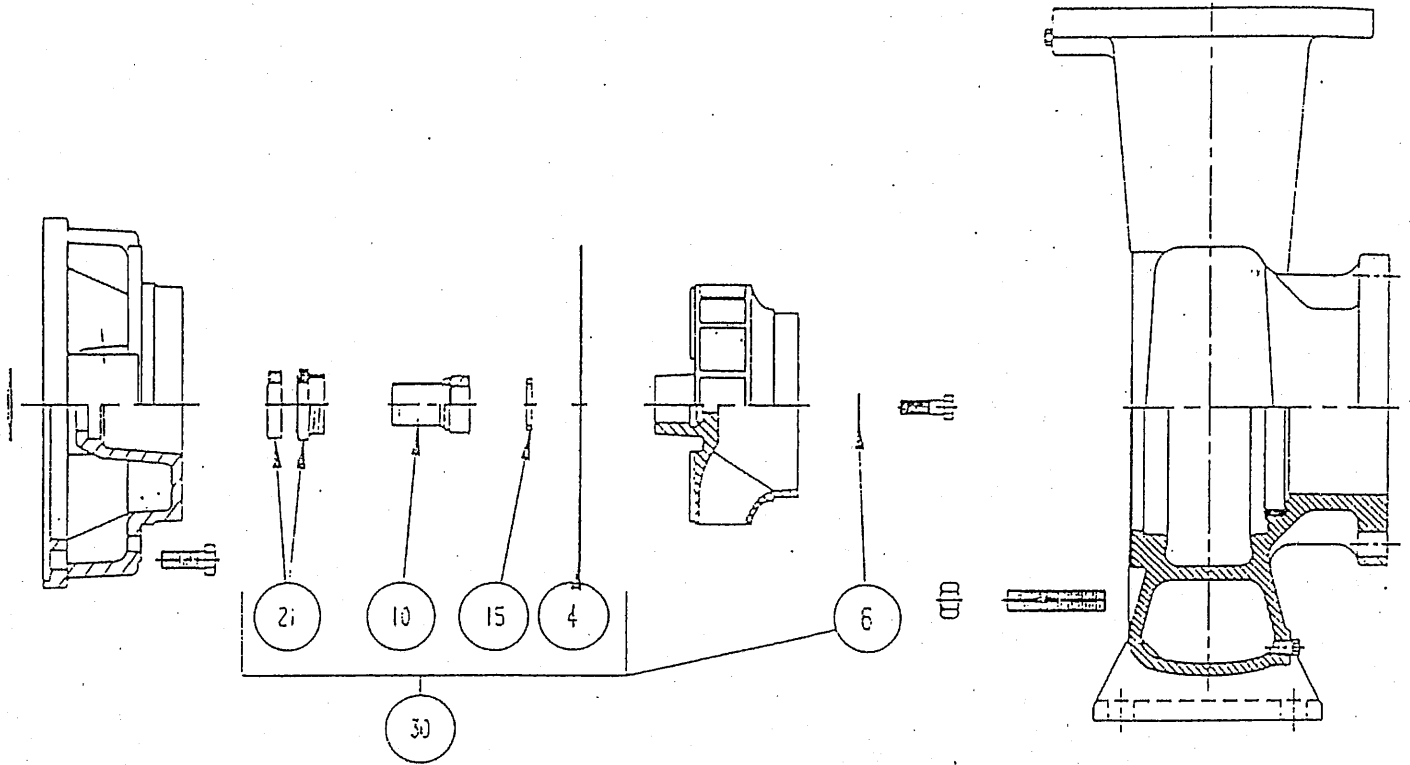

TYPE "E" STANDARD, TYPE "D" HI TEMP

ITEM NO.	NO. REQ.	DESCRIPTION	SEAL DESIGN	
			TYPE "E"	TYPE "D"
4	1	GASKET	SEE PAGE 1	
6	1	IMPELLER WASHER	951-2579RP	
10	1	SLEEVE (SS)	951-3037RP	
10	1	SLEEVE (BRZ)	951-3037BRP	
15	1	SLEEVE GASKET	951-3066RP	
30	1	SEAL KIT	951-2968SRP	951-2967SRP
30	1	SEAL KIT	951-2968BRP	951-2967BRP
21	1	WATER SEAL	951-2968RP	951-2967RP

SEAL KIT INCLUDES ITEMS NUMBER 4, 6, 10, 15 & 21.