

BERKELEY® B4ZQKLS-30 AIR COOLED ENGINE DRIVE SELF PRIME

Cast Iron Impeller

Threaded Case (NPT), Mechanical Seal Construction

Section	AC/SP
Page	140.1
Date	March 4, 2013
Supersedes 04/01/96	

Table I

B/M No.	HP	Engine Mfr.	Engine Part No.	Mounting Type & Part No.
B56116	30	Wisconsin	S30774	Base - S37521

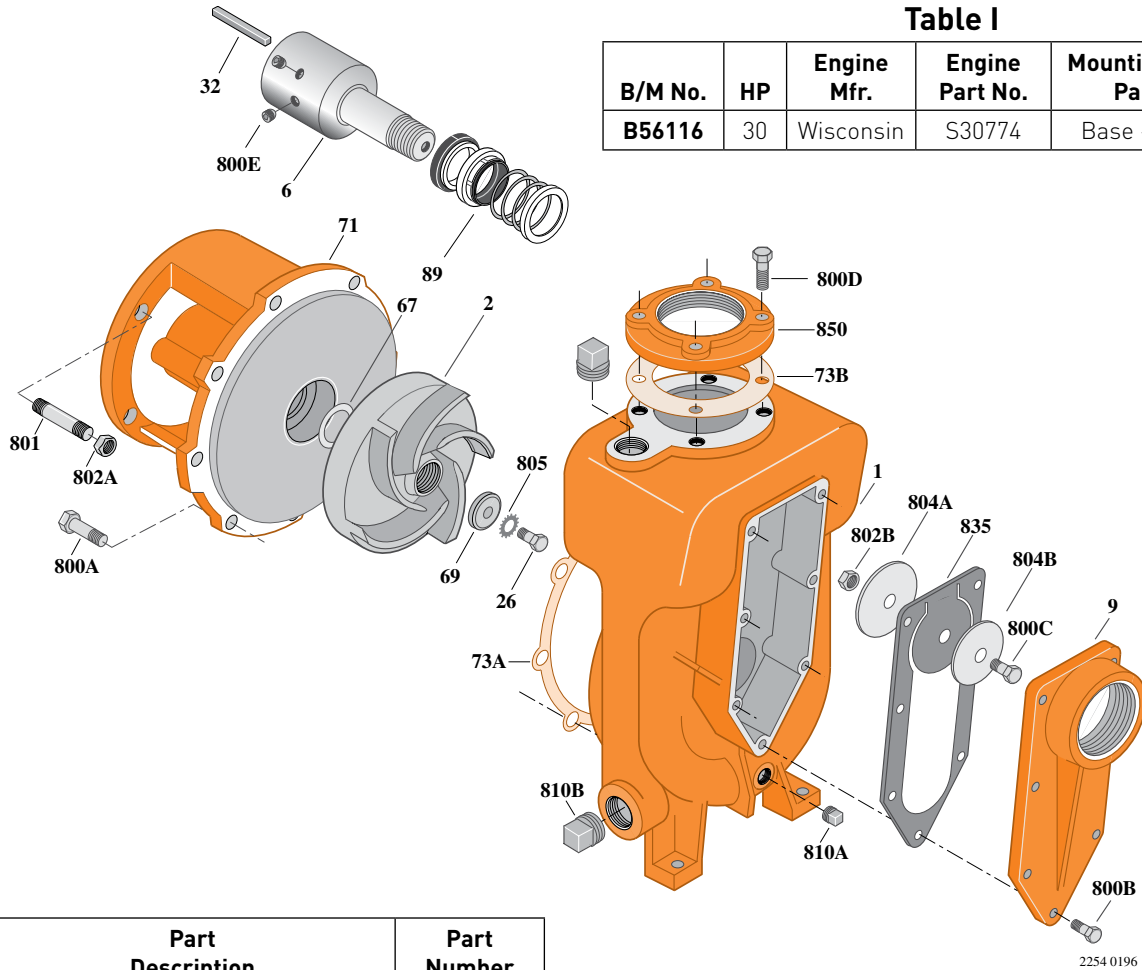

Item No.	Part Description	Part Number
1	Case, Volute	H02505
2	Impeller	M05636
6	Shaft, Telescope	M02875
9	Cover, Suction	L04108
26	Screw, Impeller 3/8-16x1"	S23566
32	Key, 3/8x3"	S24193
67	Shim [.015 Thick] (As Required)	S15335
69	Washer, Impeller	S06314
71	Bracket	H01079
73A	Gasket, Case	S05126
73B	Gasket, Companion Flange	S10364
89	Seal, Mechanical Shaft	S32014
800A	Capscrew, Hex 3/8-16x1" [8 Req.]	S26826
800B	Capscrew, Hex 3/8-16x1-1/4" [7 Req.]	S26828
800C	Capscrew, Hex 3/8-16x1"	S26824
800D	Capscrew, Hex 5/8-11x1-3/4" [4 Req.]	S27001

Item No.	Part Description	Part Number
800E	Screw, Set 1/2-13 [2 Req.]	S27793
801	Stud, 7/16-14x2" [4 Req.]	S24004
802A	Nut, Hex 7/16-14 [4 Req.]	S23015
802B	Nut, Hex 3/8-16	S23103
804A	Weight, Clack	S14842
804B	Washer, Clack	S15325
805	Washer, Lock	S23036
810A	Plug, Pipe 1/4" NPT	S23717
810B	Plug, Pipe 1-1/2" NPT [2 Req.]	S23695
835	Clack, Rubber	L04119
850	Flange, Companion	S15933

NOTE: Refer to **Supplement A** for base configuration and mounting hardware.

