

# BERKELEY® B1-1/2ZQLS-14 AIR COOLED ENGINE DRIVE Cast Iron Impeller

Threaded Case (NPT), Mechanical Seal Construction

Section	AC
Page	60.1
Date	March 4, 2013
Supersedes 07/01/11	

**Table I**

B/M No.	HP	Engine Mfr.	Engine Part No.	Engine Starter	Base Part No.
B71124	14	Robin	H05167	Electric	H05248

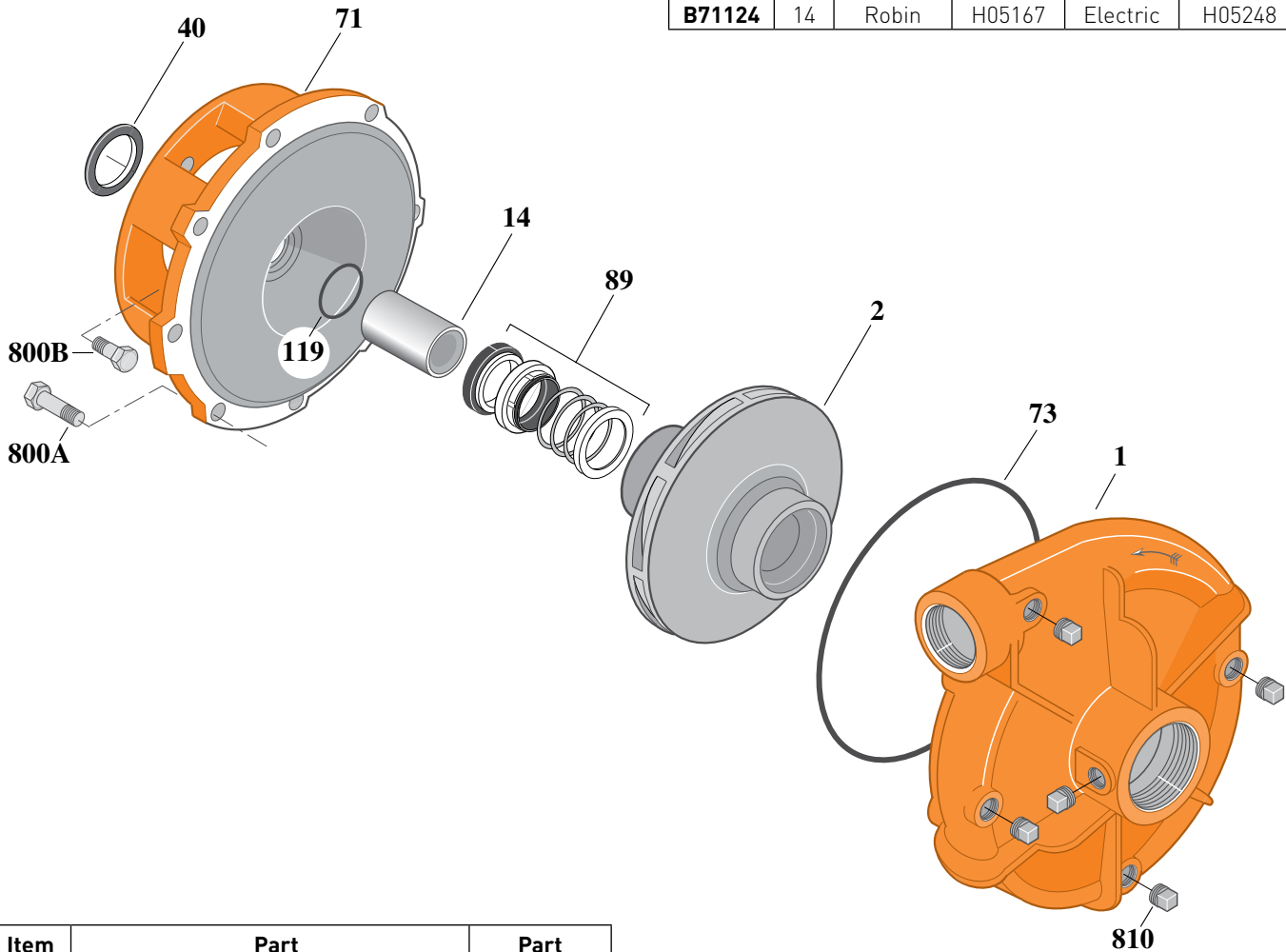

Item No.	Part Description	Part Number
1	Case, Volute	L01025
2	Impeller	M10447
14	Sleeve, Shaft	M10726
40	Slinger, Water	S03893
71	Bracket	H05262
73	O-Ring [See Note 2]	M14943
89	Seal, Mechanical Shaft	S32013
119	O-Ring	M10728
800A	Capscrew, Hex 3/8-16x1" (8 Req.)	S26826
800B	Capscrew, Hex 5/16-24x1-3/8" (4 Req.)	S23562
810	Plug, Pipe 1/4 NPT (5 Req.)	S23715

2225 1210

**NOTE 1:** Refer to **Supplement A** located at the beginning of this section for base configuration and mounting hardware.

**NOTE 2:** Also accepts gasket **S05126** as replacement for O-Ring. See **Supplement E** located at the beginning of this section.

