

BERKELEY® 8T-550

Submersible Turbine

Nominal RPM: 3450
Based on Fresh Water @ 68 F.
Maximum Working Pressure: 485 PSI

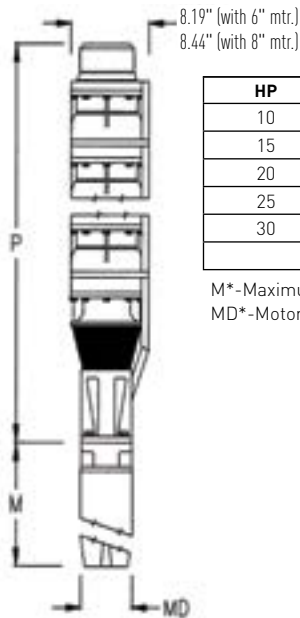
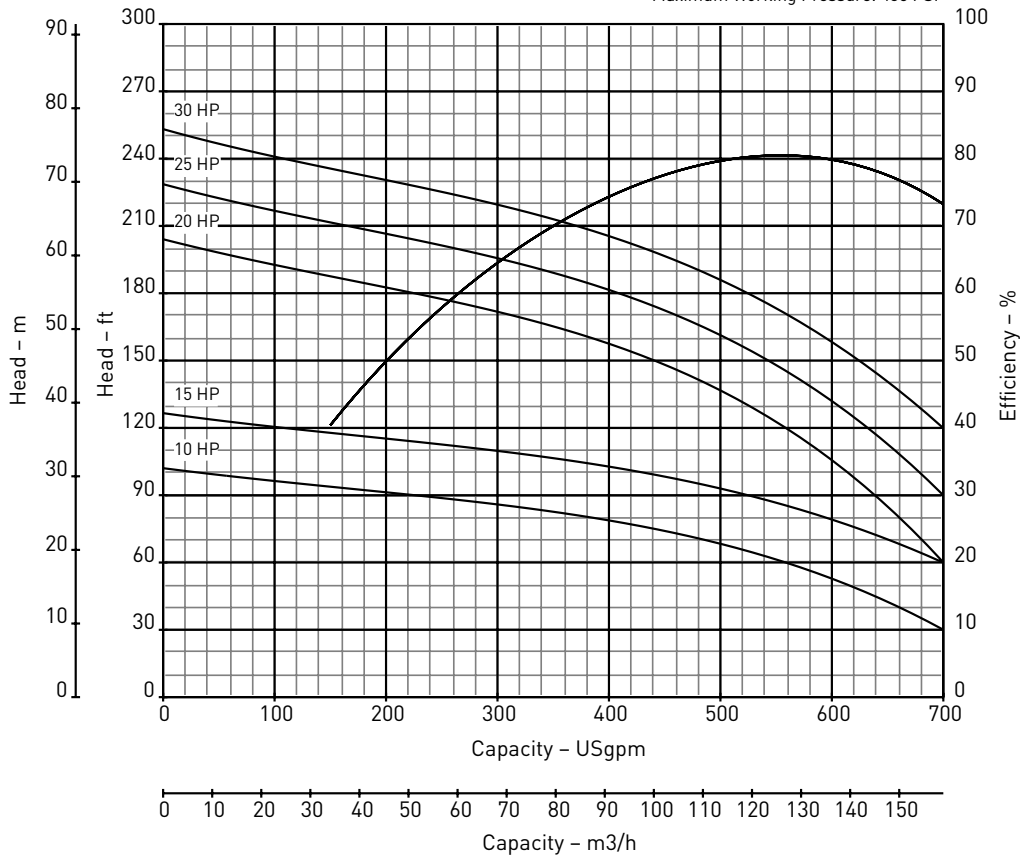

Outline Dimensions / Weights

HP	Stages	Motor Size	P Length	M* Length	MD* Diameter	Motor Weight	Pump Weight
10	1	6"	22.77	29.80	5.51	127	105
15	1	6"	22.77	30.40	5.51	130	105
20	2	6"	29.27	35.50	5.51	160	150
25	2	6"	29.27	47.20	5.51	224	150
30	2	6"	29.27	49.50	5.51	236	150

Note: Dimensions=Inches; Weight=U.S. Lbs.

M*-Maximum Length
MD*-Motor Diameter

Specifications

Minimum Well I.D.	10.0 Inches
Minimum Submergence @ BEP (above inlet)	10.0 Feet
Capacity Range	250 - 660 GPM
Discharge	6" F NPT
See manufacturer's data for motor cooling requirements	

BERKELEY® 8T-550

Submersible Turbine - Single Stage Performance

Nominal RPM: 3450
Based on Fresh Water @ 68 F.
Maximum Working Pressure: 400 PSI

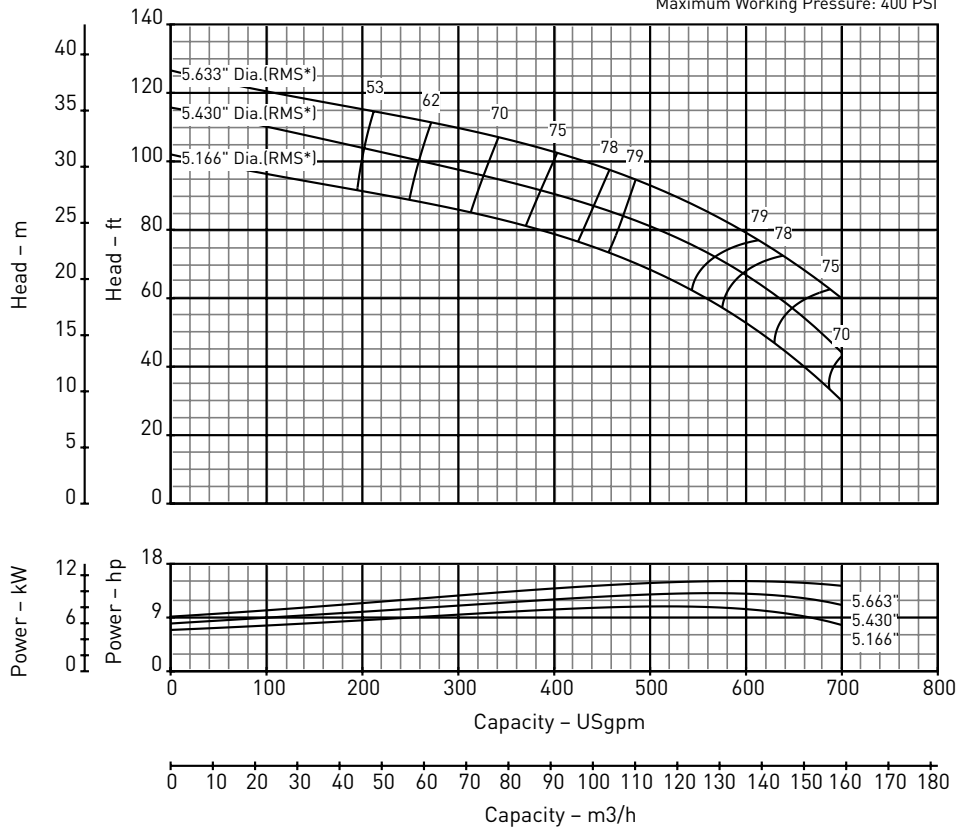

Impeller Dimensions

RMS* Diameter	A Diameter	B Diameter	C Angle
5.663	5.969	5.340	25
5.430	5.750	5.090	25
5.166	5.500	4.810	25

*Root-Mean-Square

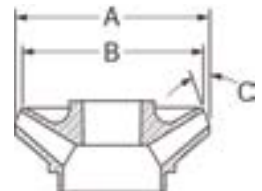

Materials of Construction

Part Name	Common Material Name	Material Spec Number
Discharge Adapter	Cast Iron	ASTM A48 Class 30
Top Bowl	Cast Iron, Ceramic Lined	ASTM A48 Class 30
Intermediate Bowl	Cast Iron, Ceramic Lined	ASTM A48 Class 30
Bearings, Top and Suction Case	Bronze	ASTM B144-3B (SAE 660)
Impeller	Stainless Steel	ASTM A743 CF8M
Pump Shaft	Stainless Steel	ASTM AISI 416
Impeller Collets	Steel	AISI 1226
Suction Bracket	Cast Iron	ASTM A48 Class 30
Bowl Bearing	Bronze	ASTM B505 C93200
Sand Cap	Bronze	ASTM B144-3B (SAE 660)
Strainer	Stainless Steel	AISI 302 UNS S30200
Cable Guard	Stainless Steel	AISI 302 UNS S30200
Shaft Coupling	Stainless Steel	AISI 416 UNS S41600

Note: Efficiency based on average staging

BERKELEY® 8T-550

Submersible Turbine

Nominal RPM: 3450
Based on Fresh Water @ 68 F.
Maximum Working Pressure: 485 PSI

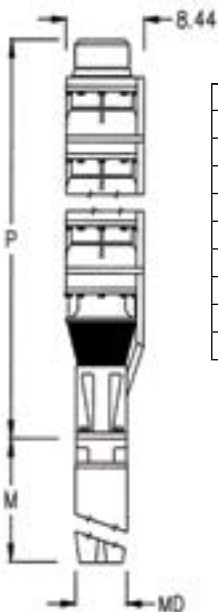
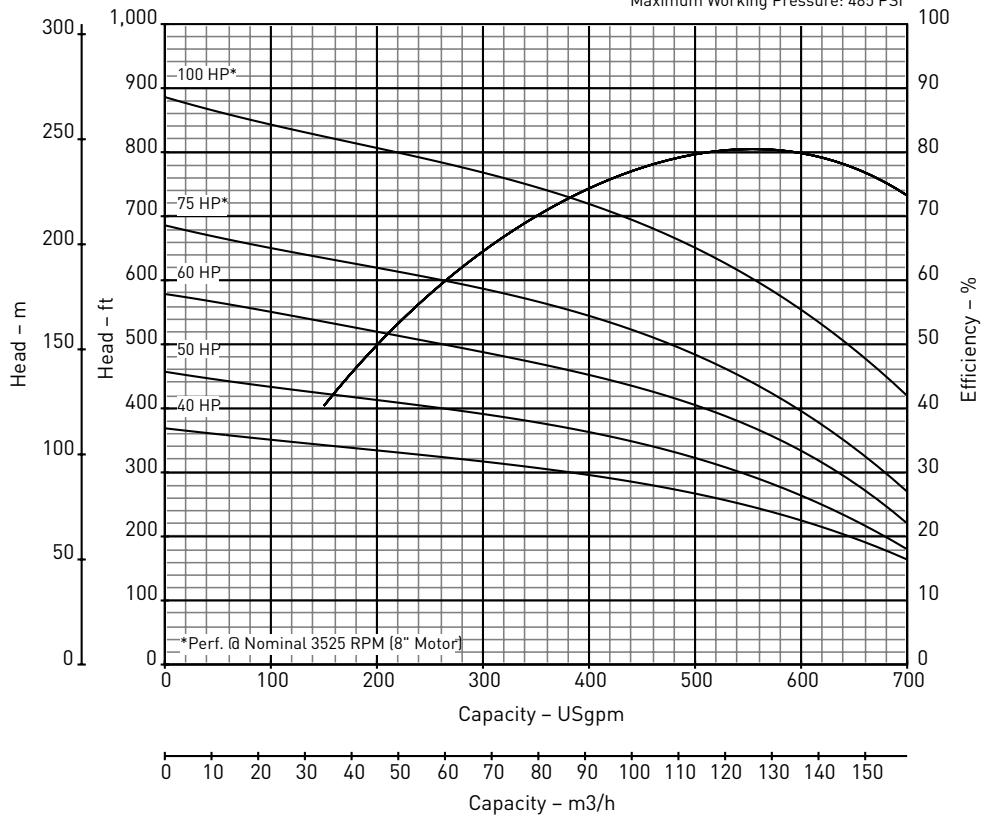

Outline Dimensions / Weights

HP	Stages	Motor Size	P Length	M* Length	MD* Diameter	Motor Weight	Pump Weight
40	3	6"	35.77	50.30	5.51	239	195
40	3	8"	36.37	35.80	7.69	310	200
50	4	6"	42.27	52.20	5.51	251	240
50	4	8"	42.87	38.80	7.69	350	245
60	5	6"	48.77	55.70	5.51	269	285
60	5	8"	49.37	41.80	7.69	385	290
75	6	8"	55.87	54.90	7.69	424	335
100	7	8"	62.37	58.90	7.69	469	380

Note: Dimensions=Inches; Weight=U.S. Lbs.

M*-Maximum Length
MD*-Motor Diameter

Specifications

Minimum Well I.D.	10.0 Inches
Minimum Submergence @ BEP (above inlet)	10.0 Feet
Capacity Range	250 - 660 GPM
Discharge	6" F NPT

See manufacturer's data for motor cooling requirements

BERKELEY® 8T-550

Submersible Turbine

Normalized RPM: 3525
Based on Fresh Water @ 68 F.
Maximum Working Pressure: 400 PSI

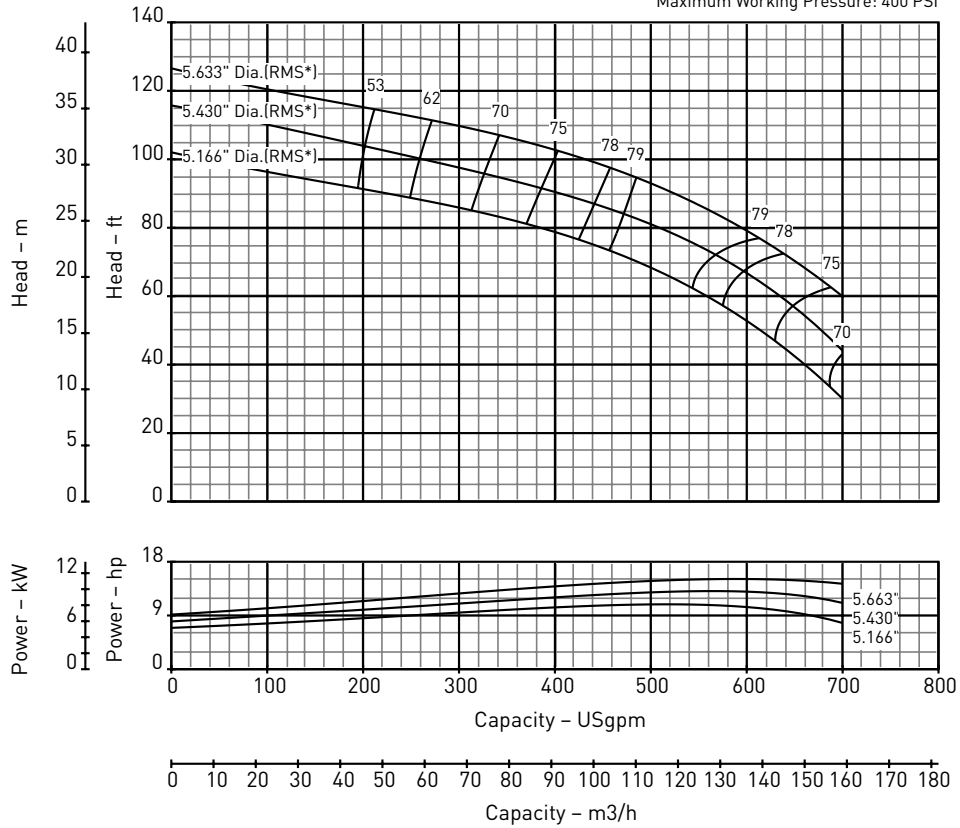

Impeller Dimensions

RMS* Diameter	A Diameter	B Diameter	C Angle
5.663	5.969	5.340	25
5.430	5.750	5.090	25
5.166	5.500	4.810	25

*Root-Mean-Square

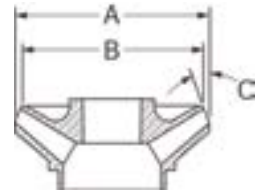

Materials of Construction

Part Name	Common Material Name	Material Spec Number
Discharge Adapter	Cast Iron	ASTM A48 Class 30
Top Bowl	Cast Iron, Ceramic Lined	ASTM A48 Class 30
Intermediate Bowl	Cast Iron, Ceramic Lined	ASTM A48 Class 30
Bearings, Top and Suction Case	Bronze	ASTM B144-3B (SAE 660)
Impeller	Stainless Steel	ASTM A743 CF8M
Pump Shaft	Stainless Steel	ASTM AISI 416
Impeller Collets	Steel	AISI 1226
Suction Bracket	Cast Iron	ASTM A48 Class 30
Bowl Bearing	Bronze	ASTM B505 C93200
Sand Cap	Bronze	ASTM B144-3B (SAE 660)
Strainer	Stainless Steel	AISI 302 UNS S30200
Cable Guard	Stainless Steel	AISI 302 UNS S30200
Shaft Coupling	Stainless Steel	AISI 416 UNS S41600

Note: Efficiency based on average staging

BERKELEY® 8T-650

Submersible Turbine

Nominal RPM: 3450
Based on Fresh Water @ 68 F.
Maximum Working Pressure: 485 PSI

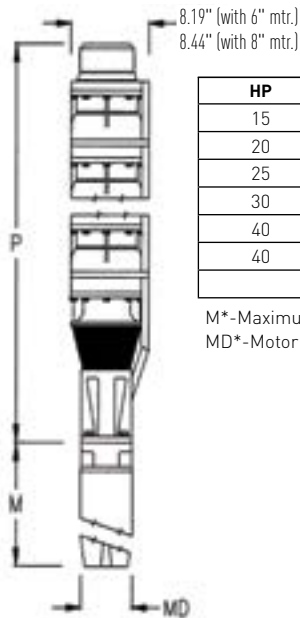
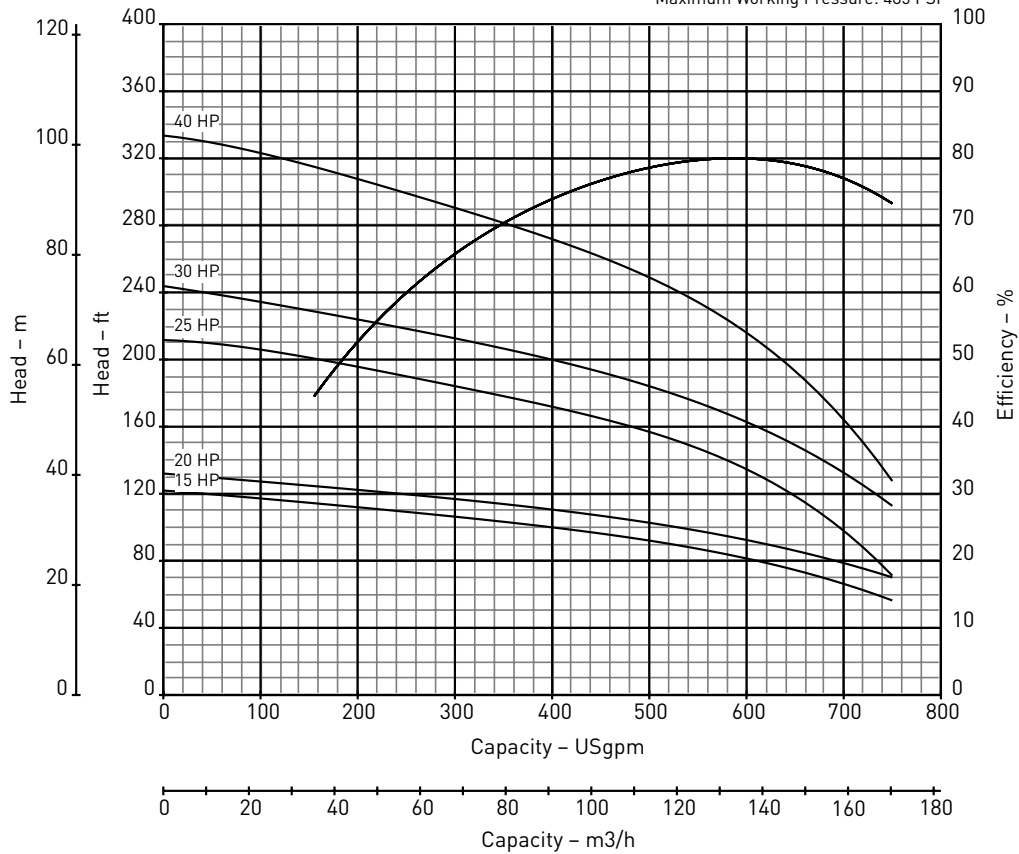

Outline Dimensions / Weights

HP	Stages	Motor Size	P Length	M* Length	MD* Diameter	Motor Weight	Pump Weight
15	1	6"	22.77	30.40	5.51	130	105
20	1	6"	22.77	35.50	5.51	160	105
25	2	6"	29.27	47.20	5.51	224	150
30	2	6"	29.27	49.50	5.51	236	150
40	3	6"	35.77	50.30	5.51	239	195
40	3	8"	36.37	35.80	7.69	310	200

Note: Dimensions=Inches; Weight=U.S. Lbs.

M*-Maximum Length
MD*-Motor Diameter

Specifications

Minimum Well I.D.	10.0 Inches
Minimum Submergence @ BEP (above inlet)	10.0 Feet
Capacity Range	300 - 750 GPM
Discharge	6" F NPT
See manufacturer's data for motor cooling requirements	

BERKELEY® 8T-650

Submersible Turbine - Single Stage Performance

Nominal RPM: 3450
Based on Fresh Water @ 68 F.
Maximum Working Pressure: 400 PSI

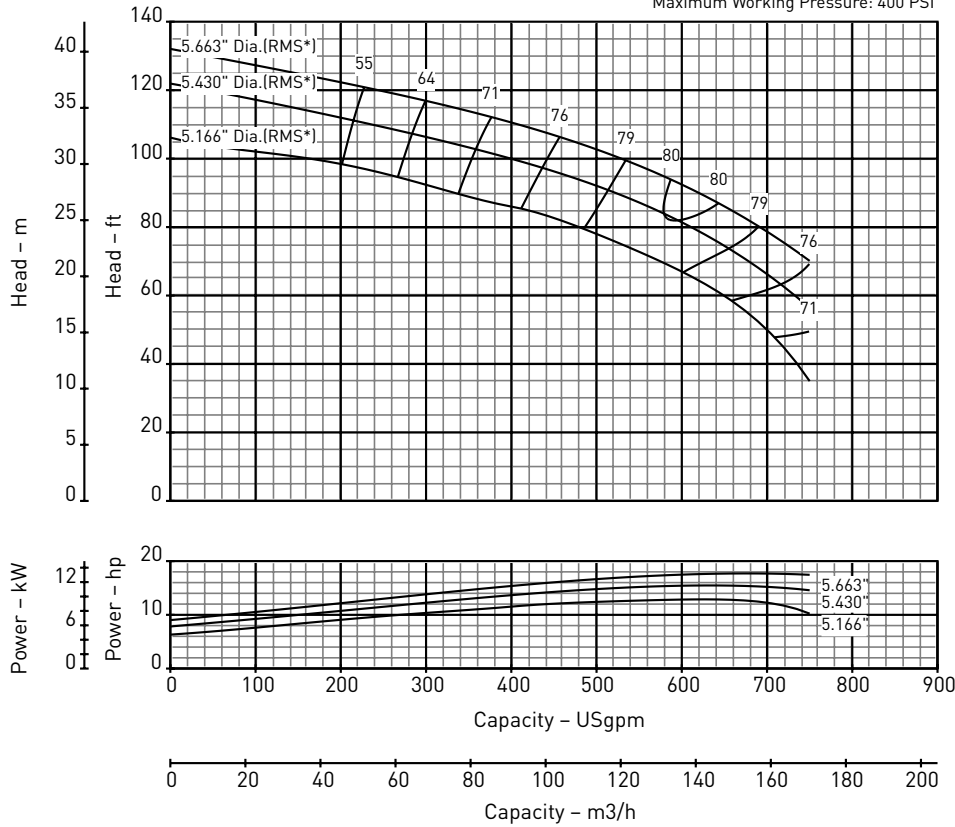

Impeller Dimensions

RMS* Diameter	A Diameter	B Diameter	C Angle
5.663	5.969	5.340	25
5.430	5.750	5.090	25
5.166	5.500	4.810	25

*Root-Mean-Square

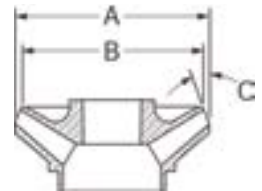

Materials of Construction

Part Name	Common Material Name	Material Spec Number
Discharge Adapter	Cast Iron	ASTM A48 Class 30
Top Bowl	Cast Iron, Ceramic Lined	ASTM A48 Class 30
Intermediate Bowl	Cast Iron, Ceramic Lined	ASTM A48 Class 30
Bearings, Top and Suction Case	Bronze	ASTM B144-3B (SAE 660)
Impeller	Stainless Steel	ASTM A743 CF8M
Pump Shaft	Stainless Steel	ASTM AISI 416
Impeller Collets	Steel	AISI 1226
Suction Bracket	Cast Iron	ASTM A48 Class 30
Bowl Bearing	Bronze	ASTM B505 C93200
Sand Cap	Bronze	ASTM B144-3B (SAE 660)
Strainer	Stainless Steel	AISI 302 UNS S30200
Cable Guard	Stainless Steel	AISI 302 UNS S30200
Shaft Coupling	Stainless Steel	AISI 416 UNS S41600

Note: Efficiency based on average staging

Section 8T | Page 2.02

Supersedes All Previous | Date-07/16/2014



BERKELEY® 8T-650

Submersible Turbine

Nominal RPM: 3450
Based on Fresh Water @ 68 F.
Maximum Working Pressure: 485 PSI

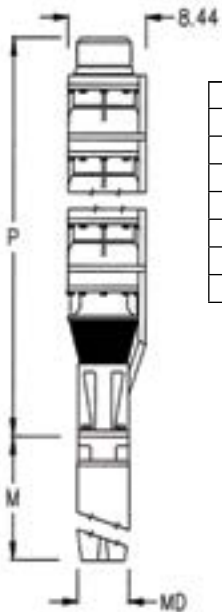
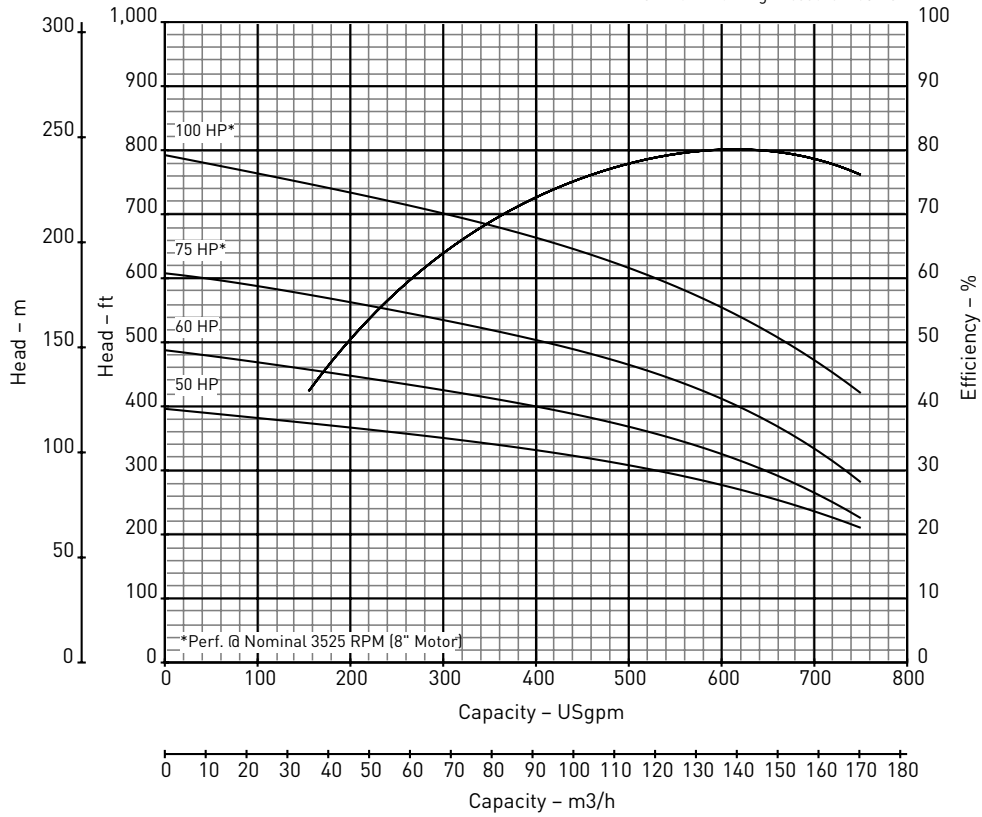

Outline Dimensions / Weights

HP	Stages	Motor Size	P Length	M* Length	MD* Diameter	Motor Weight	Pump Weight
50	3	6"	35.77	52.20	5.51	251	195
50	3	8"	36.37	38.80	7.69	350	200
60	4	6"	42.27	55.70	5.51	269	240
60	4	8"	42.87	41.80	7.69	385	245
75	5	8"	49.37	54.90	7.69	424	290
100	6	8"	55.87	58.90	7.69	469	335

Note: Dimensions=Inches; Weight=U.S. Lbs.

M*-Maximum Length
MD*-Motor Diameter

Specifications

Minimum Well I.D.	10.0 Inches
Minimum Submergence @ BEP (above inlet)	10.0 Feet
Capacity Range	300 - 750 GPM
Discharge	6" F NPT

See manufacturer's data for motor cooling requirements

BERKELEY® 8T-650

Submersible Turbine - Single Stage Performance

Normalized RPM: 3525
Based on Fresh Water @ 68 F.
Maximum Working Pressure: 400 PSI

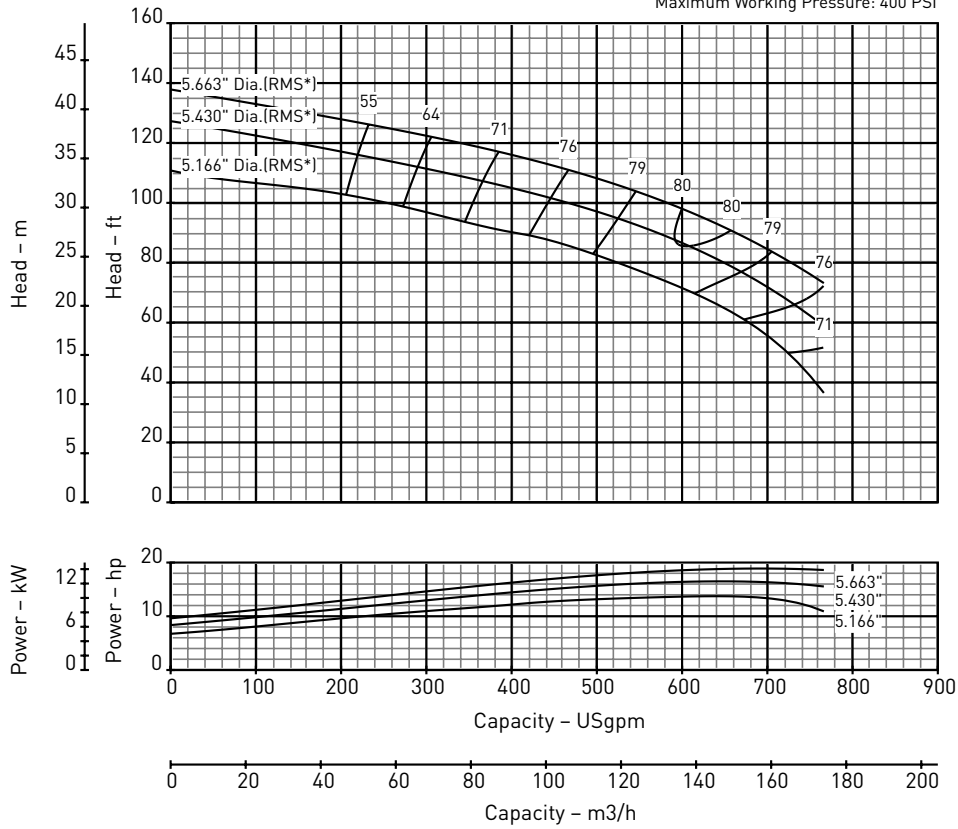

Impeller Dimensions

RMS* Diameter	A Diameter	B Diameter	C Angle
5.663	5.969	5.340	25
5.430	5.750	5.090	25
5.166	5.500	4.810	25

*Root-Mean-Square

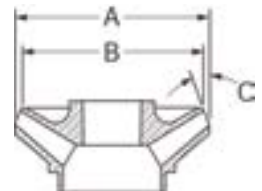

Materials of Construction

Part Name	Common Material Name	Material Spec Number
Discharge Adapter	Cast Iron	ASTM A48 Class 30
Top Bowl	Cast Iron, Ceramic Lined	ASTM A48 Class 30
Intermediate Bowl	Cast Iron, Ceramic Lined	ASTM A48 Class 30
Bearings, Top and Suction Case	Bronze	ASTM B144-3B (SAE 660)
Impeller	Stainless Steel	ASTM A743 CF8M
Pump Shaft	Stainless Steel	ASTM AISI 416
Impeller Collets	Steel	AISI 1226
Suction Bracket	Cast Iron	ASTM A48 Class 30
Bowl Bearing	Bronze	ASTM B505 C93200
Sand Cap	Bronze	ASTM B144-3B (SAE 660)
Strainer	Stainless Steel	AISI 302 UNS S30200
Cable Guard	Stainless Steel	AISI 302 UNS S30200
Shaft Coupling	Stainless Steel	AISI 416 UNS S41600

Note: Efficiency based on average staging



BERKELEY® 8T-750

Submersible Turbine

Nominal RPM: 3450
Based on Fresh Water @ 68 F.
Maximum Working Pressure: 510 PSI

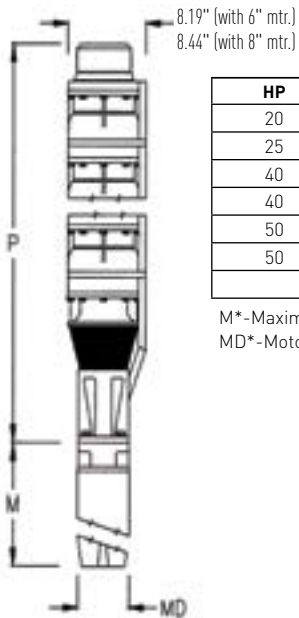
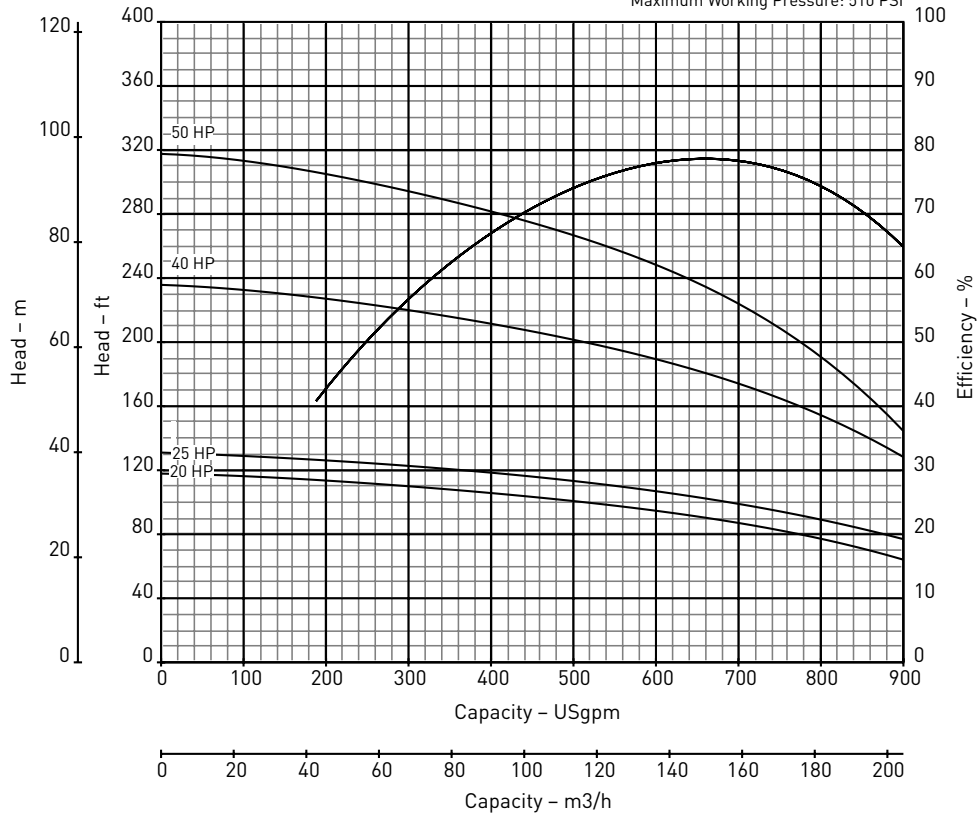

Outline Dimensions / Weights

HP	Stages	Motor Size	P Length	M* Length	MD* Diameter	Motor Weight	Pump Weight
20	1	6"	22.77	35.50	5.51	160	105
25	1	6"	22.77	47.20	5.51	224	105
40	2	6"	29.27	50.30	5.51	239	150
40	2	8"	29.87	35.80	7.69	310	155
50	3	6"	35.77	52.20	5.51	251	195
50	3	8"	36.37	38.80	7.69	350	200

Note: Dimensions=Inches; Weight=U.S. Lbs.

M*-Maximum Length
MD*-Motor Diameter

Specifications

Minimum Well I.D.	10.0 Inches
Minimum Submergence @ BEP (above inlet)	10.0 Feet
Capacity Range	350 - 800 GPM
Discharge	6" F NPT
See manufacturer's data for motor cooling requirements	

BERKELEY® 8T-750

Submersible Turbine - Single Stage Performance

Nominal RPM: 3450
Based on Fresh Water @ 68 F.
Maximum Working Pressure: 500 PSI

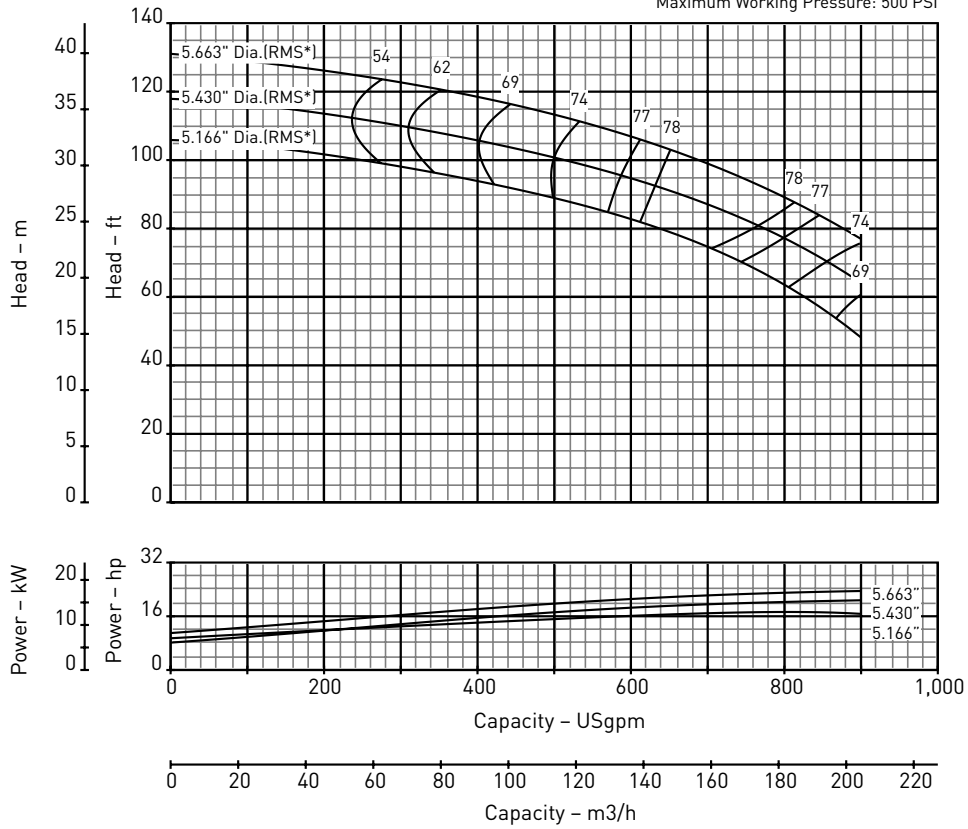

Impeller Dimensions

RMS* Diameter	A Diameter	B Diameter	C Angle
5.663	5.969	5.340	25
5.430	5.750	5.090	25
5.166	5.500	4.810	25

*Root-Mean-Square

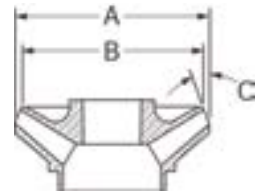

Materials of Construction

Part Name	Common Material Name	Material Spec Number
Discharge Adapter	Cast Iron	ASTM A48 Class 30
Top Bowl	Cast Iron, Ceramic Lined	ASTM A48 Class 30
Intermediate Bowl	Cast Iron, Ceramic Lined	ASTM A48 Class 30
Bearings, Top and Suction Case	Bronze	ASTM B144-3B (SAE 660)
Impeller	Stainless Steel	ASTM A743 CF8M
Pump Shaft	Stainless Steel	ASTM AISI 416
Impeller Collets	Steel	AISI 1226
Suction Bracket	Cast Iron	ASTM A48 Class 30
Bowl Bearing	Bronze	ASTM B505 C93200
Sand Cap	Bronze	ASTM B144-3B (SAE 660)
Strainer	Stainless Steel	AISI 302 UNS S30200
Cable Guard	Stainless Steel	AISI 302 UNS S30200
Shaft Coupling	Stainless Steel	AISI 416 UNS S41600

Note: Efficiency based on average staging



BERKELEY® 8T-750

Submersible Turbine

Nominal RPM: 3450
 Based on Fresh Water @ 68 F.
 Maximum Working Pressure: 510 PSI

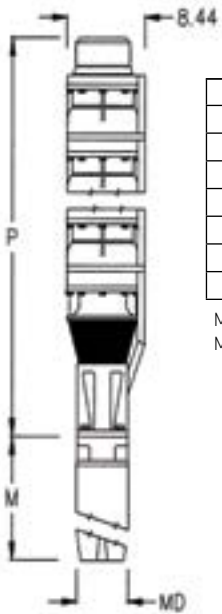
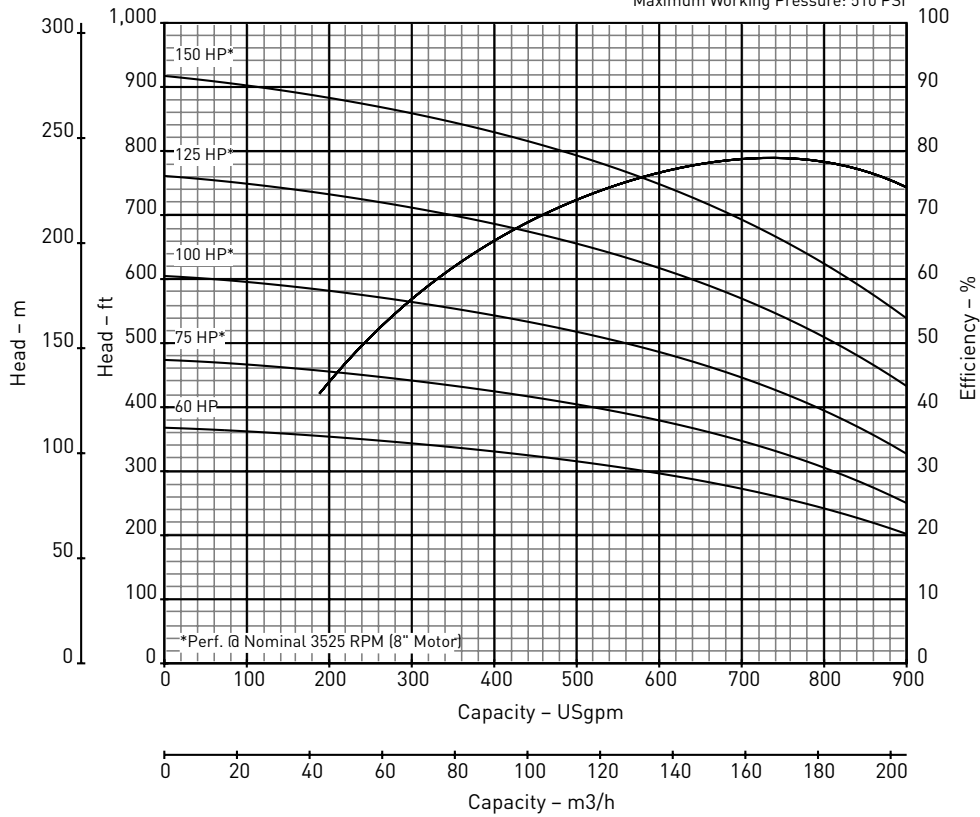

Outline Dimensions / Weights

HP	Stages	Motor Size	P Length	M* Length	MD* Diameter	Motor Weight	Pump Weight
60	3	6"	35.77	55.70	5.51	269	195
60	3	8"	36.37	41.80	7.69	385	200
75	4	8"	42.87	54.90	7.69	424	245
100	5	8"	49.37	58.90	7.69	469	290
125	6	8"	55.87	68.80	7.69	700	335
150	7	8"	62.37	77.80	7.69	850	380

Note: Dimensions=Inches; Weight=U.S. Lbs.

M*-Maximum Length
 MD*-Motor Diameter

Specifications

Minimum Well I.D.	10.0 Inches
Minimum Submergence @ BEP (above inlet)	10.0 Feet
Capacity Range	350 - 800 GPM
Discharge	6" F NPT
See manufacturer's data for motor cooling requirements	

BERKELEY® 8T-750

Submersible Turbine - Single Stage Performance

Normalized RPM: 3525
Based on Fresh Water @ 68 F.
Maximum Working Pressure: 500 PSI

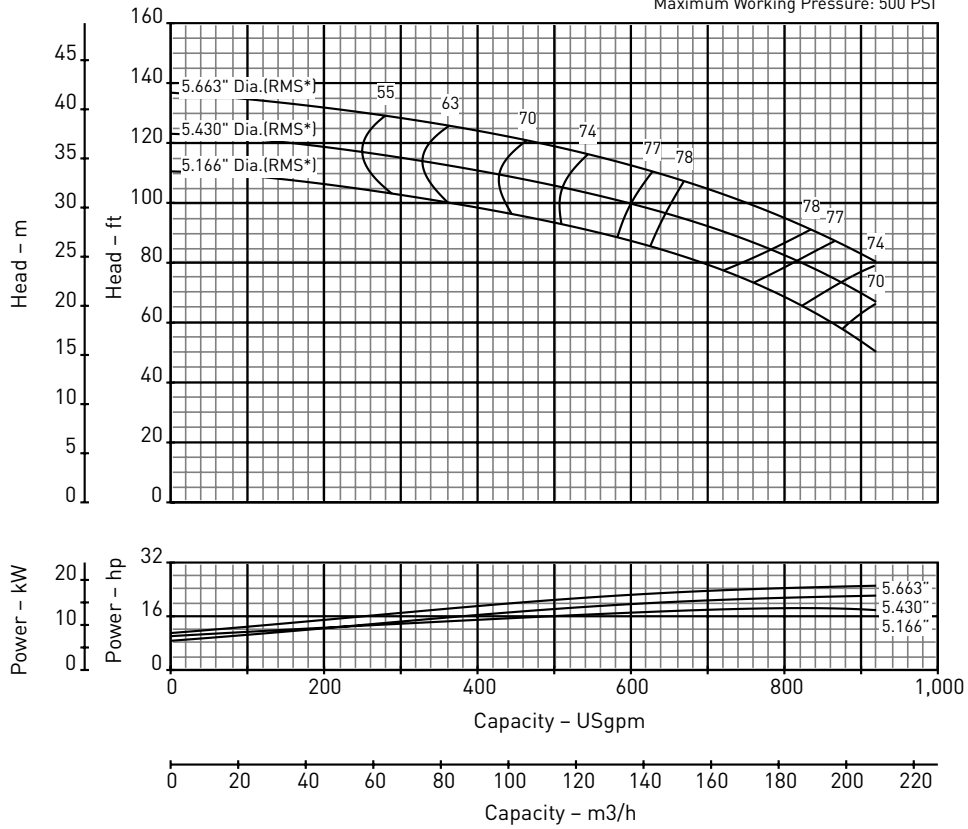

Impeller Dimensions

RMS* Diameter	A Diameter	B Diameter	C Angle
5.663	5.969	5.340	25
5.430	5.750	5.090	25
5.166	5.500	4.810	25

*Root-Mean-Square

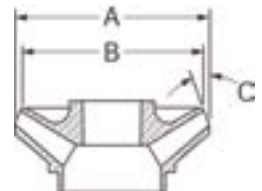

Materials of Construction

Part Name	Common Material Name	Material Spec Number
Discharge Adapter	Cast Iron	ASTM A48 Class 30
Top Bowl	Cast Iron, Ceramic Lined	ASTM A48 Class 30
Intermediate Bowl	Cast Iron, Ceramic Lined	ASTM A48 Class 30
Bearings, Top and Suction Case	Bronze	ASTM B144-3B (SAE 660)
Impeller	Stainless Steel	ASTM A743 CF8M
Pump Shaft	Stainless Steel	ASTM AISI 416
Impeller Collets	Steel	AISI 1226
Suction Bracket	Cast Iron	ASTM A48 Class 30
Bowl Bearing	Bronze	ASTM B505 C93200
Sand Cap	Bronze	ASTM B144-3B (SAE 660)
Strainer	Stainless Steel	AISI 302 UNS S30200
Cable Guard	Stainless Steel	AISI 302 UNS S30200
Shaft Coupling	Stainless Steel	AISI 416 UNS S41600

Note: Efficiency based on average staging



BERKELEY® 8T-950

Submersible Turbine

Nominal RPM: 3500
 Based on Fresh Water @ 68°F
 Maximum Working Pressure: 350 PSI (24.1 BAR)

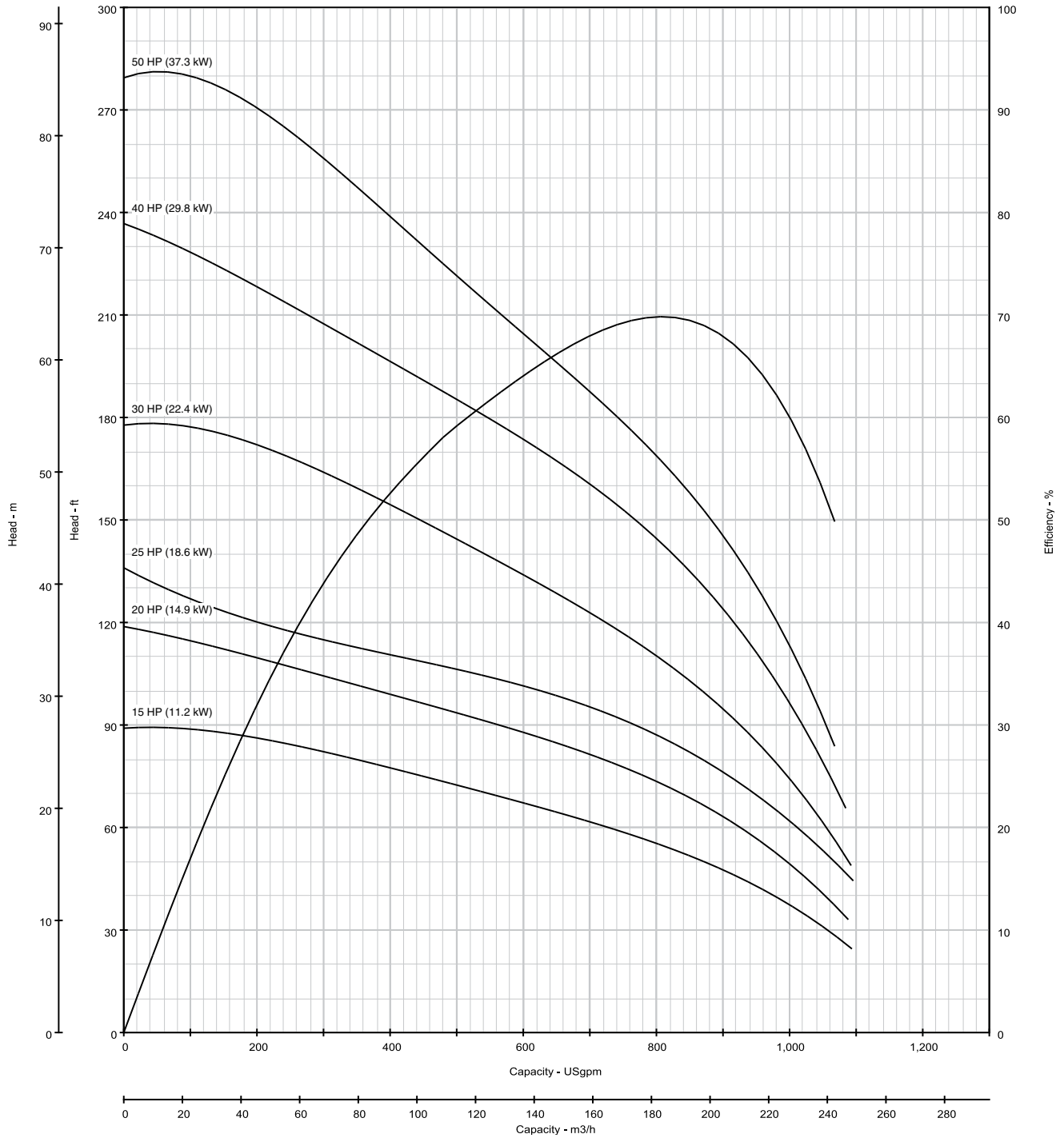

BERKELEY® 8T-950

Submersible Turbine

Nominal RPM: 3500
 Based on Fresh Water @ 68°F
 Maximum Working Pressure: 350 PSI (24.1 BAR)

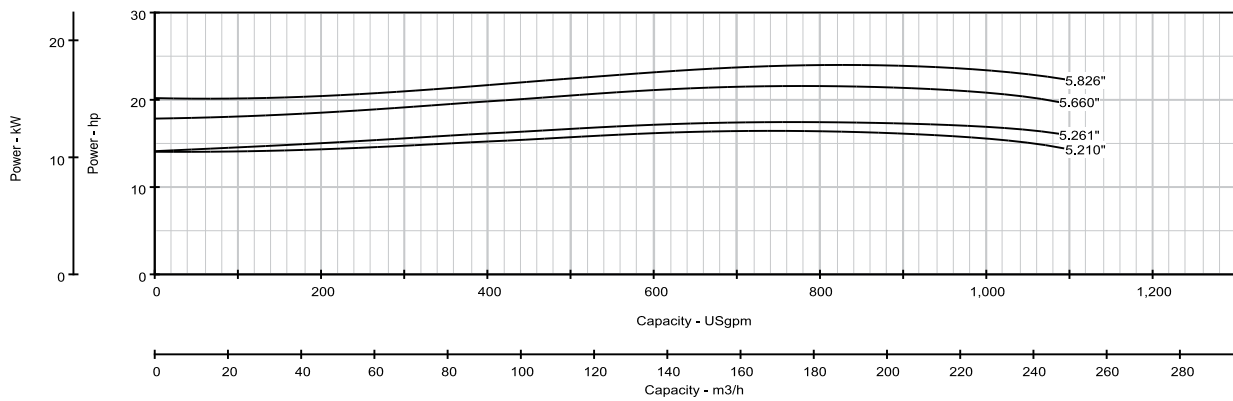
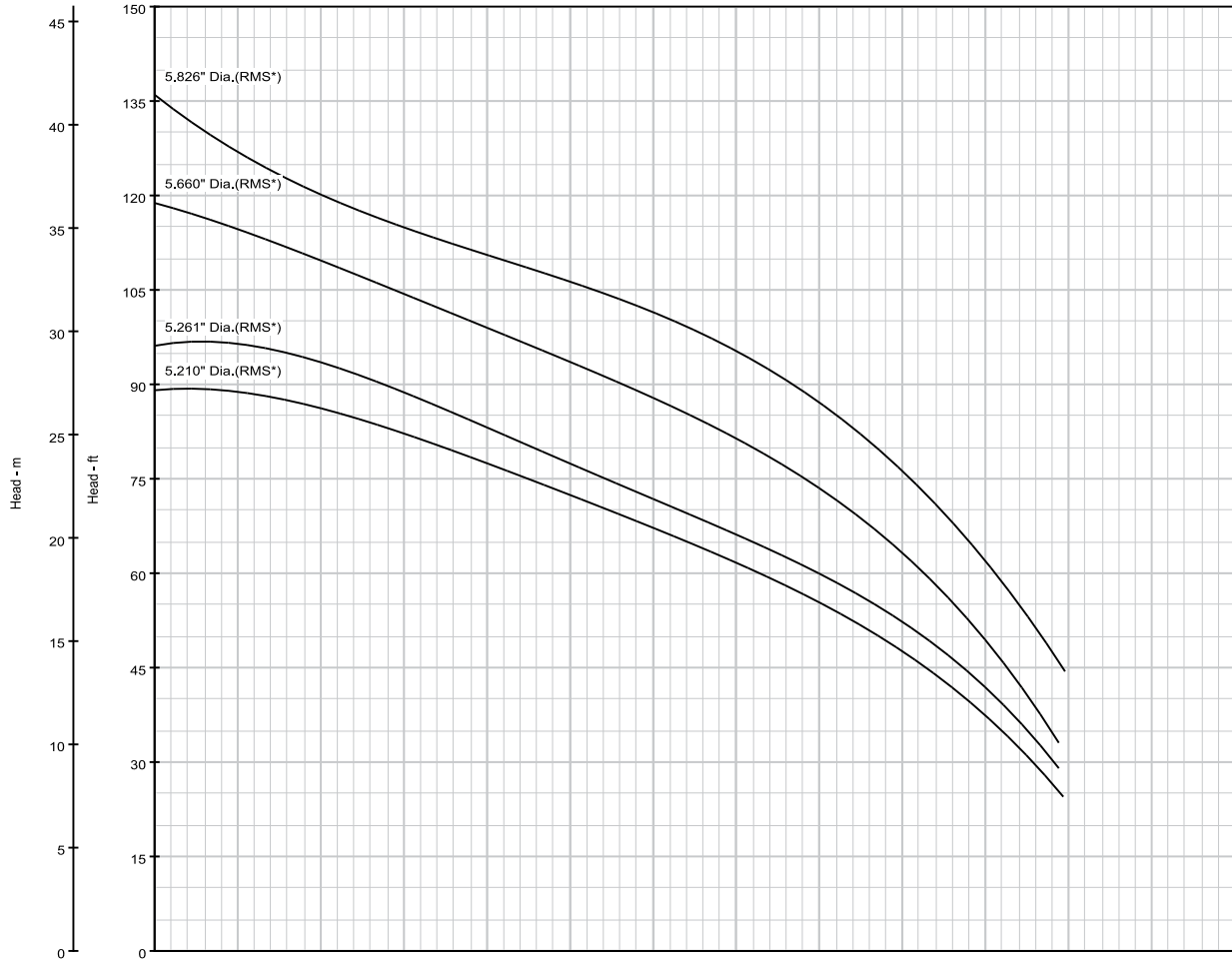

BERKELEY® 8T-950

Submersible Turbine - Single Stage Performance

Nominal RPM: 3500
Based on Fresh Water @ 68°F
Maximum Working Pressure: 350 PSI (24.1 BAR)

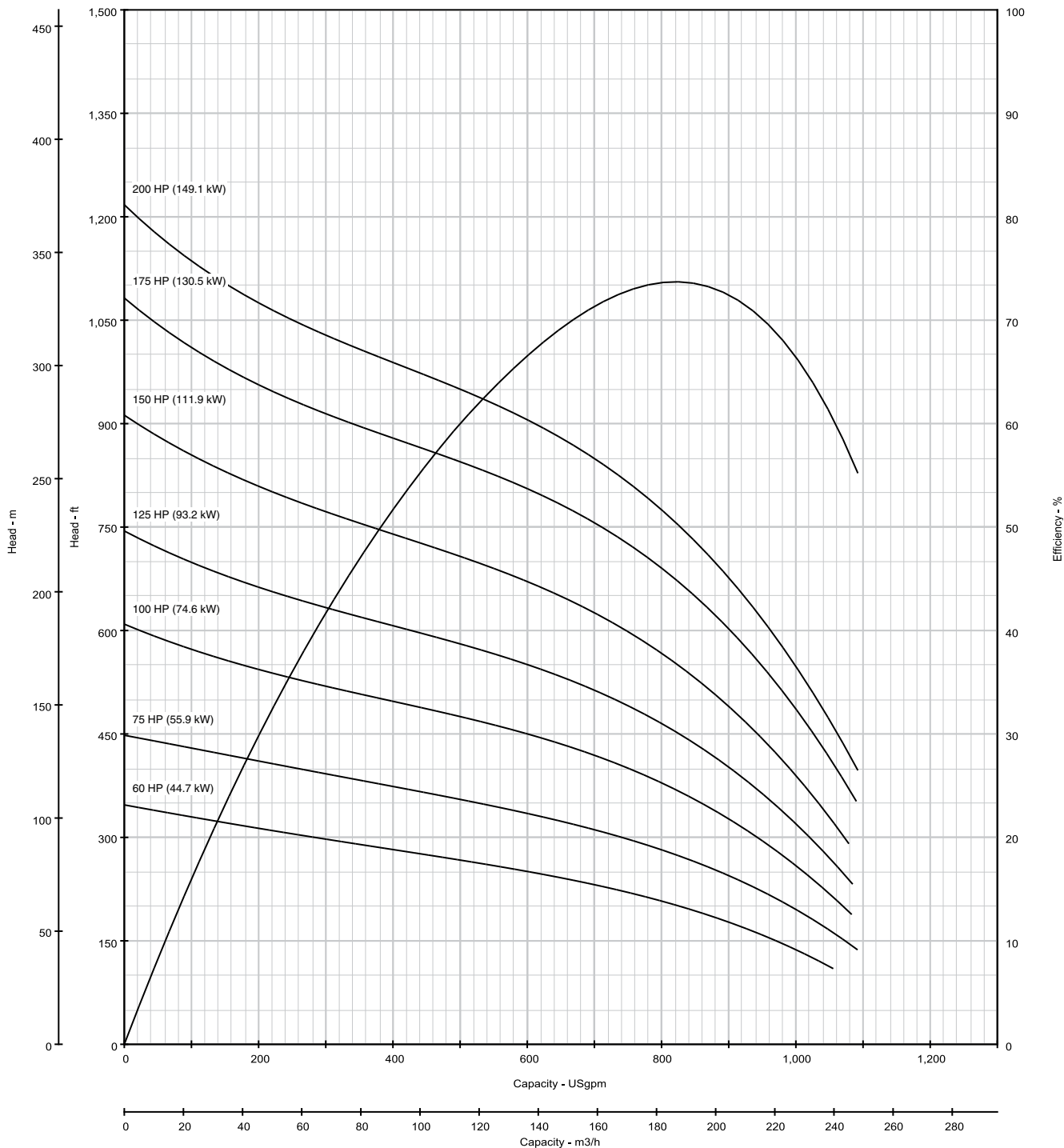

BERKELEY® 8T-950

Submersible Turbine - Single Stage Performance

Nominal RPM: 3500
 Based on Fresh Water @ 68°F
 Maximum Working Pressure: 350 PSI (24.1 BAR)

