

BERKELEY® 7T-350

Submersible Turbine

Nominal RPM: 3450
 Based on Fresh Water @ 68 F.
 Maximum Working Pressure: 550 PSI

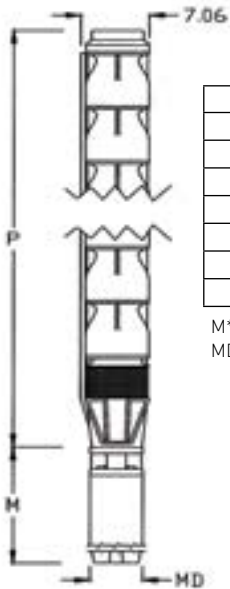
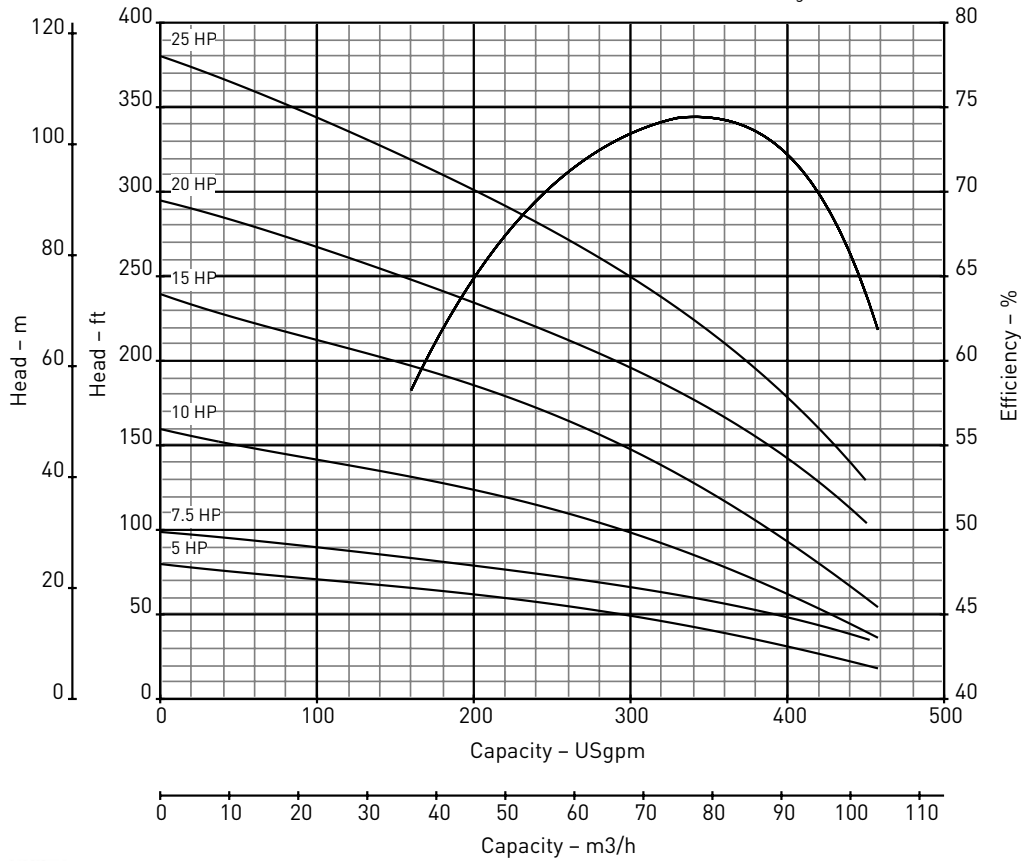

Outline Dimensions / Weights

HP	Stages	Motor Size	P Length	M* Length	MD* Diameter	Motor Weight	Pump Weight
5	1	6"	19.94	27.00	5.51	95	59
7.5	1	6"	19.94	27.60	5.51	114	59
10	2	6"	26.44	29.80	5.51	127	83
15	3	6"	32.94	30.40	5.51	130	108
20	3	6"	32.94	35.50	5.51	160	108
25	4	6"	39.44	47.20	5.51	224	133

Note: Dimensions=Inches; Weight=U.S. Lbs.

M*-Maximum Length (Pentair Motor)
 MD*-Motor Diameter (Pentair Motor)

Specifications

Minimum Well I.D.	8.0 Inches
Minimum Submergence @ BEP (above inlet)	10.0 Feet
Capacity Range	130 - 450 GPM
Discharge	5" F x 6" M NPT
See manufacturer's data for motor cooling requirements	

BERKELEY® 7T-350

Submersible Turbine

Nominal RPM: 3450
Based on Fresh Water @ 68 F.
Maximum Working Pressure: 550 PSI

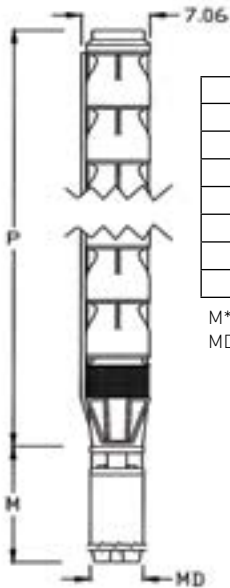
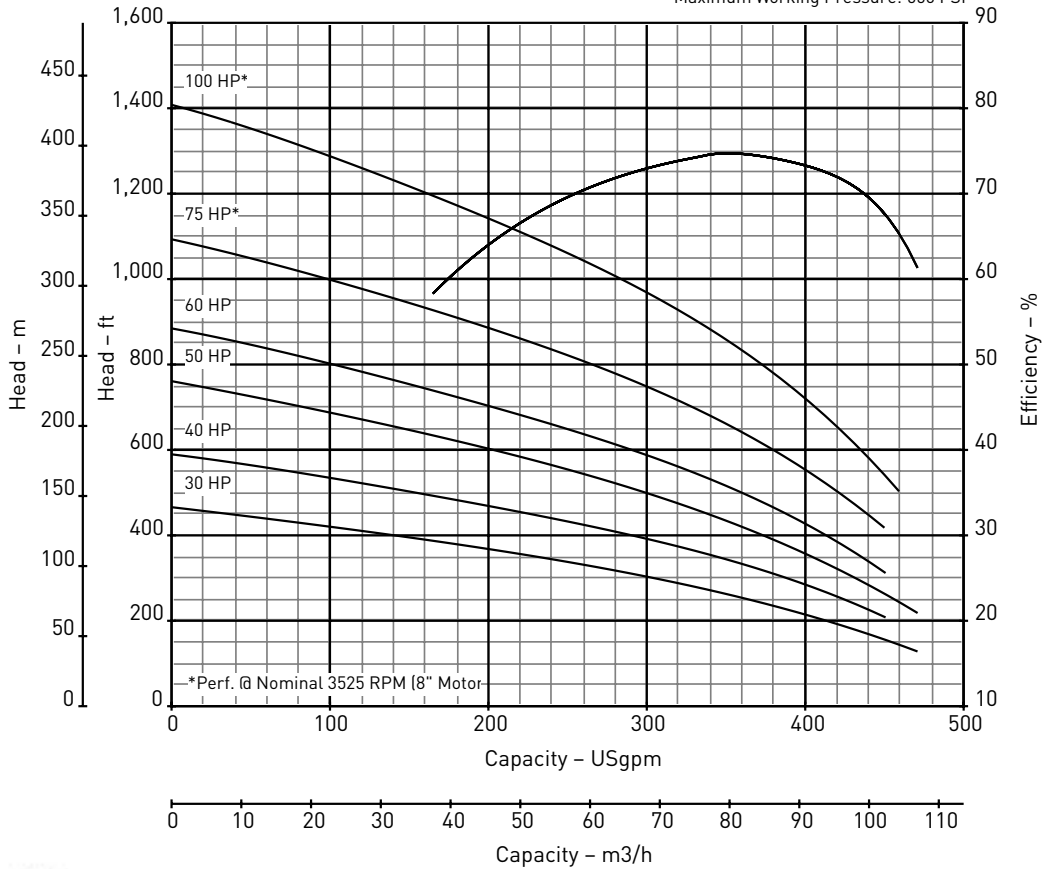

Outline Dimensions / Weights

HP	Stages	Motor Size	P Length	M* Length	MD* Diameter	Motor Weight	Pump Weight
30	5	6"	45.94	49.50	5.51	236	158
40	6	6"	52.44	50.30	5.51	239	183
50	8	6"	65.44	52.20	5.51	251	232
60	9	6"	71.94	55.70	5.51	269	257
75	11	8"	86.44	46.79	7.58	430	359
100	14	8"	105.94	54.29	7.58	530	434

Note: Dimensions=Inches; Weight=U.S. Lbs.

M*-Maximum Length (Pentair Motor)
MD*-Motor Diameter (Pentair Motor)

Specifications

Minimum Well I.D.	8.0 Inches
Minimum Submergence @ BEP (above inlet)	10.0 Feet
Capacity Range	147 - 450 GPM
Discharge	5" F x 6" M NPT

See manufacturer's data for motor cooling requirements

BERKELEY® 7T-350

Submersible Turbine - Single Stage Performance

Normalized RPM: 3450
Based on Fresh Water @ 68 F.
Maximum Working Pressure: 550 PSI

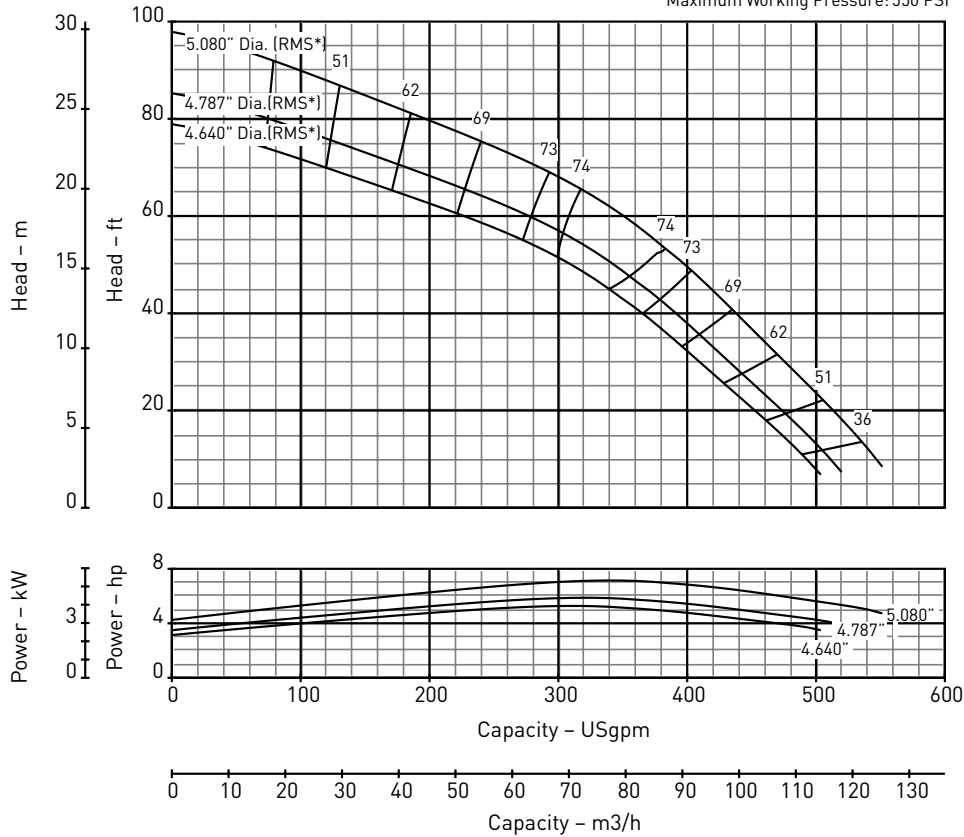

Impeller Dimensions

RMS* Diameter	A Diameter	B Diameter	C Angle
5.080	5.390	4.750	30
4.787	5.110	4.440	30
4.640	5.000	4.250	30

*Root-Mean-Square

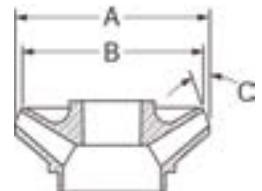

Materials of Construction

Part Name	Common Material Name	Material Spec Number
Discharge Adapter	Cast Iron	ASTM A48 Class 30
Top Bowl	Cast Iron	ASTM A48 Class 30
Intermediate Bowl	Cast Iron	ASTM A48 Class 30
Bearings, Top and Suction Case	Rubber	Neoprene
Impeller	Stainless Steel	ASTM A743 UNS C30400
Pump Shaft	Stainless Steel	ASTM AISI 416
Impeller Collets	Steel	AISI 1226
Suction Bracket	Cast Iron	ASTM A48 Class 30
Bowl Bearing	Rubber	Neoprene
Strainer	Stainless Steel	AISI 302 UNS S30200
Cable Guard	Stainless Steel	AISI 302 UNS S30200
Shaft Coupling	Stainless Steel	AISI 416 UNS S41600

Note: Efficiency based on average staging

BERKELEY® 7T-350

Submersible Turbine - Single Stage Performance

Normalized RPM: 3450
Based on Fresh Water @ 68 F.
Maximum Working Pressure: 550 PSI

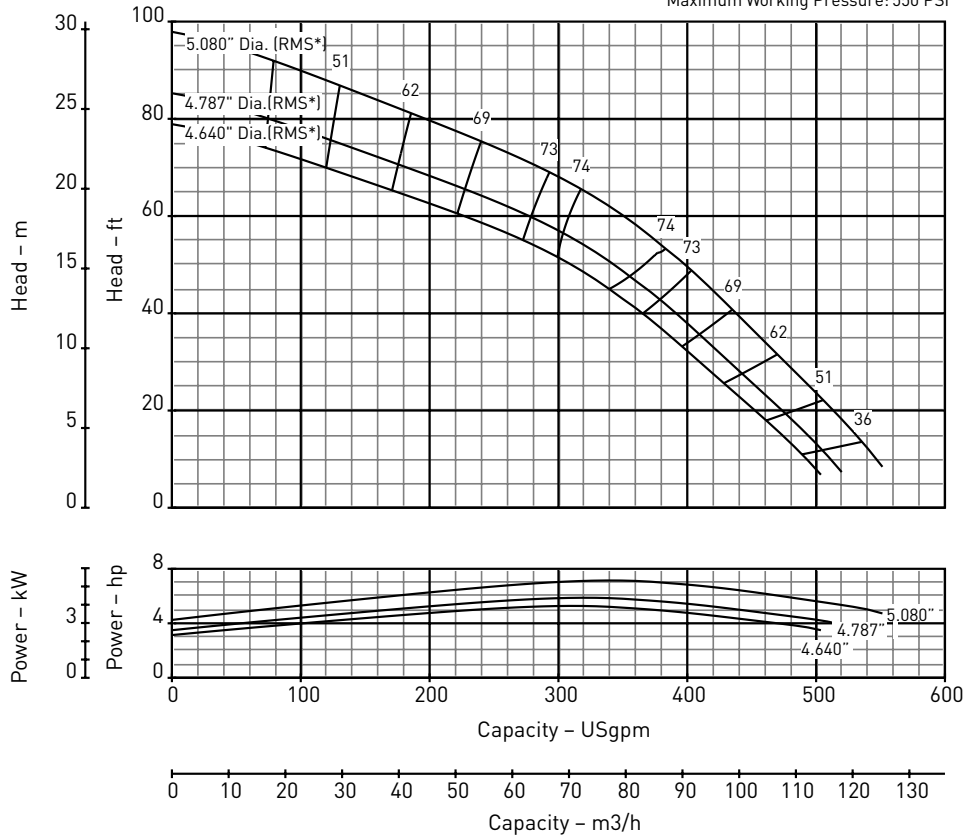

Impeller Dimensions

RMS* Diameter	A Diameter	B Diameter	C Angle
5.080	5.390	4.750	30
4.787	5.110	4.440	30
4.640	5.000	4.250	30

*Root-Mean-Square

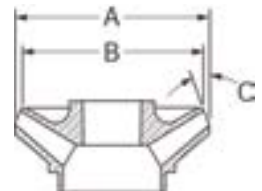

Materials of Construction

Part Name	Common Material Name	Material Spec Number
Discharge Adapter	Cast Iron	ASTM A48 Class 30
Top Bowl	Cast Iron	ASTM A48 Class 30
Intermediate Bowl	Cast Iron	ASTM A48 Class 30
Bearings, Top and Suction Case	Rubber	Neoprene
Impeller	Stainless Steel	ASTM A743 UNS C30400
Pump Shaft	Stainless Steel	ASTM AISI 416
Impeller Collets	Steel	AISI 1226
Suction Bracket	Cast Iron	ASTM A48 Class 30
Bowl Bearing	Rubber	Neoprene
Strainer	Stainless Steel	AISI 302 UNS S30200
Cable Guard	Stainless Steel	AISI 302 UNS S30200
Shaft Coupling	Stainless Steel	AISI 416 UNS S41600

Note: Efficiency based on average staging

BERKELEY® 7T-450

Submersible Turbine

Nominal RPM: 3450
Based on Fresh Water @ 68 F.
Maximum Working Pressure: 550 PSI

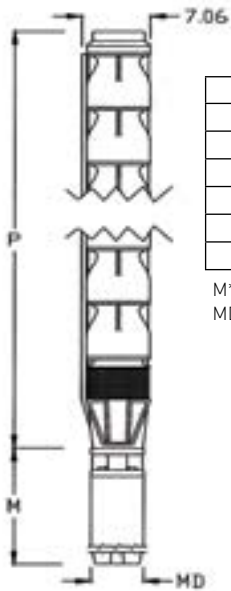
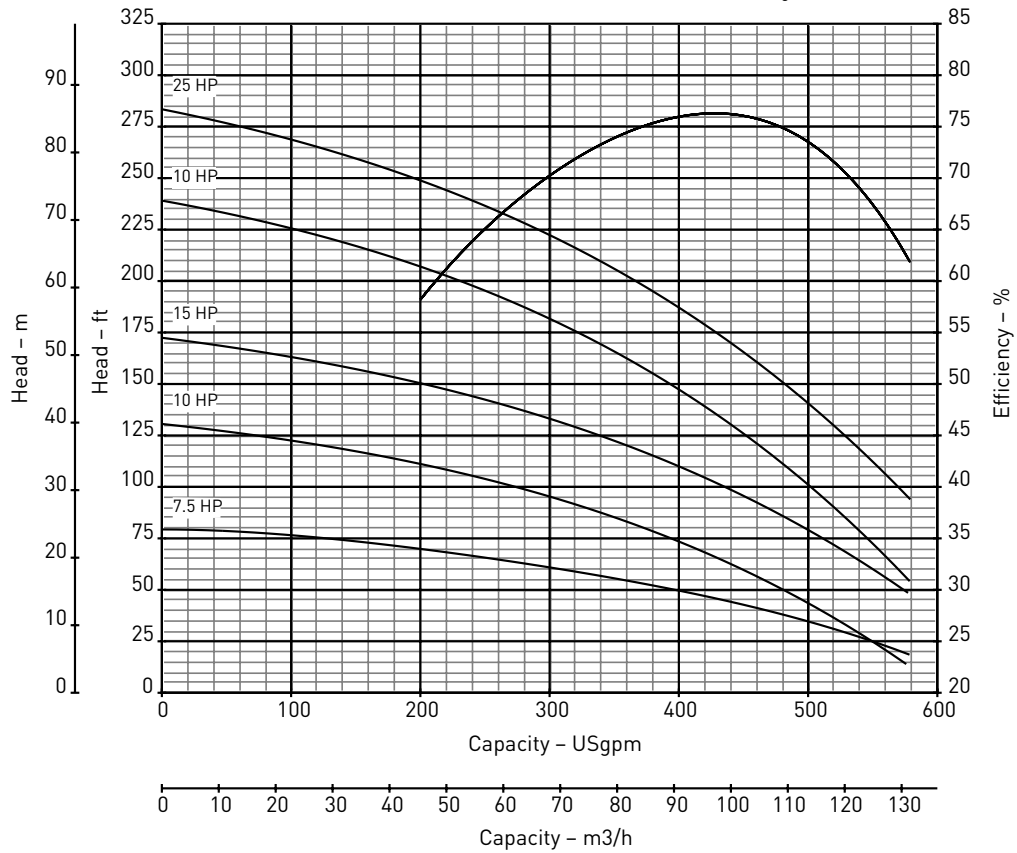

Outline Dimensions / Weights

HP	Stages	Motor Size	P Length	M* Length	MD* Diameter	Motor Weight	Pump Weight
7.5	1	6"	19.94	27.60	5.51	114	59
10	2	6"	26.44	29.80	5.51	127	85
15	2	6"	26.44	30.40	5.51	130	85
20	3	6"	32.94	35.50	5.51	160	110
25	3	6"	32.94	47.20	5.51	224	110

Note: Dimensions=Inches; Weight=U.S. Lbs.

M*-Maximum Length (Pentair Motor)
MD*-Motor Diameter (Pentair Motor)

Specifications

Minimum Well I.D.	8.0 Inches
Minimum Submergence @ BEP (above inlet)	10.0 Feet
Capacity Range	100 - 580 GPM
Discharge	5" F x 6" M NPT

See manufacturer's data for motor cooling requirements

BERKELEY® 7T-450

Submersible Turbine

Nominal RPM: 3450
Based on Fresh Water @ 68 F.
Maximum Working Pressure: 550 PSI

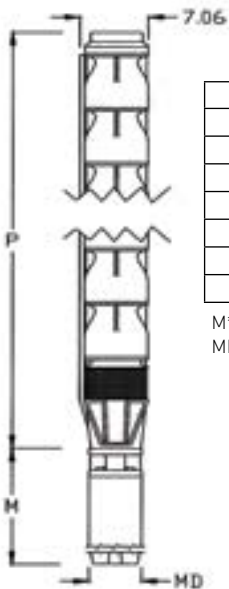
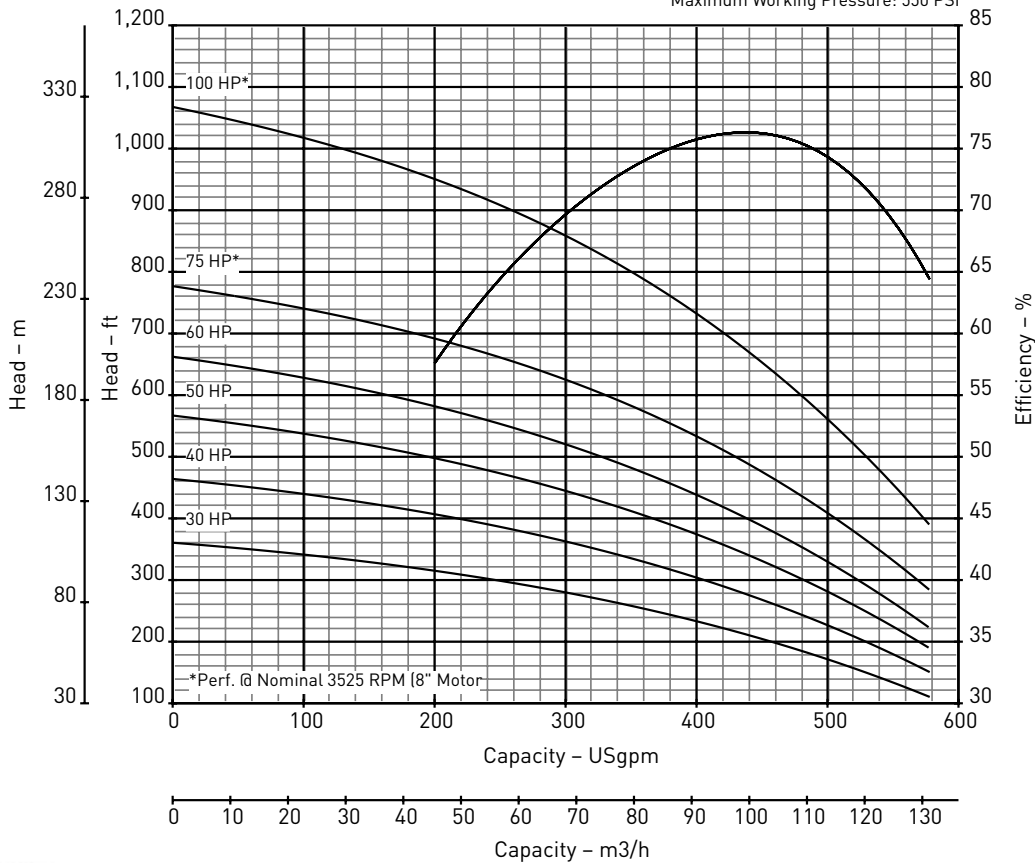

Outline Dimensions / Weights

HP	Stages	Motor Size	P Length	M* Length	MD* Diameter	Motor Weight	Pump Weight
30	4	6"	39.44	49.50	5.51	236	136
40	5	6"	45.94	50.30	5.51	239	161
50	6	6"	52.44	52.20	5.51	251	187
60	7	6"	58.94	55.70	5.51	269	212
75	8	8"	66.94	46.79	7.58	430	290
100	11	8"	86.44	54.29	7.58	530	366

Note: Dimensions=Inches; Weight=U.S. Lbs.

M*-Maximum Length (Pentair Motor)
MD*-Motor Diameter (Pentair Motor)

Specifications

Minimum Well I.D.	8.0 Inches
Minimum Submergence @ BEP (above inlet)	10.0 Feet
Capacity Range	100 - 580 GPM
Discharge	5" F x 6" M NPT

See manufacturer's data for motor cooling requirements

BERKELEY® 7T-450

Submersible Turbine - Single Stage Performance

Nominal RPM: 3450
Based on Fresh Water @ 68 F.
Maximum Working Pressure: 550 PSI

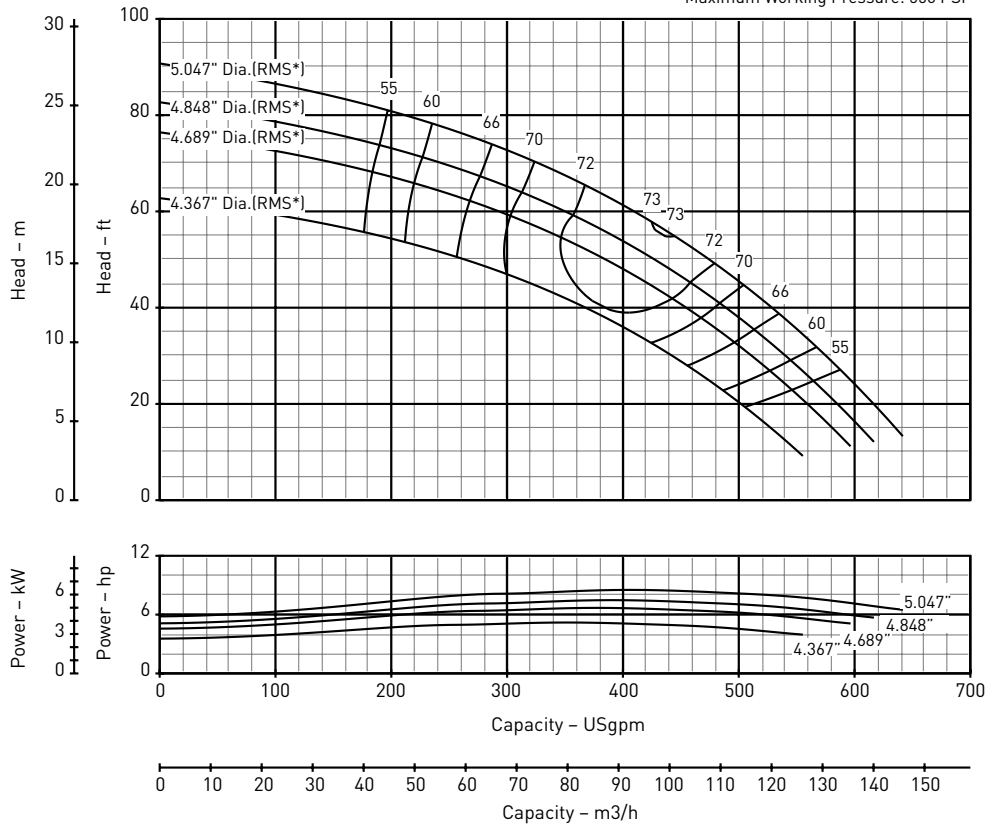

Impeller Dimensions

RMS* Diameter	A Diameter	B Diameter	C Angle
5.047	5.380	4.960	24
4.848	5.190	4.480	24
4.689	5.040	4.310	24
4.367	4.730	3.970	24

*Root-Mean-Square

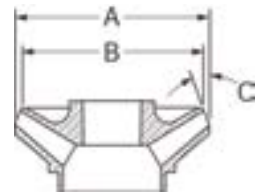

Materials of Construction

Part Name	Common Material Name	Material Spec Number
Discharge Adapter	Cast Iron	ASTM A48 Class 30
Top Bowl	Cast Iron	ASTM A48 Class 30
Intermediate Bowl	Cast Iron	ASTM A48 Class 30
Bearings, Top and Suction Case	Rubber	Neoprene
Impeller	Stainless Steel	ASTM A743 UNS C30400
Pump Shaft	Stainless Steel	ASTM AISI 416
Impeller Collets	Steel	AISI 1226
Suction Bracket	Cast Iron	ASTM A48 Class 30
Bowl Bearing	Rubber	Neoprene
Strainer	Stainless Steel	AISI 302 UNS S30200
Cable Guard	Stainless Steel	AISI 302 UNS S30200
Shaft Coupling	Stainless Steel	AISI 416 UNS S41600

Note: Efficiency based on average staging

BERKELEY® 7T-450

Submersible Turbine - Single Stage Performance

Nominal RPM: 3525
Based on Fresh Water @ 68 F.
Maximum Working Pressure: 550 PSI

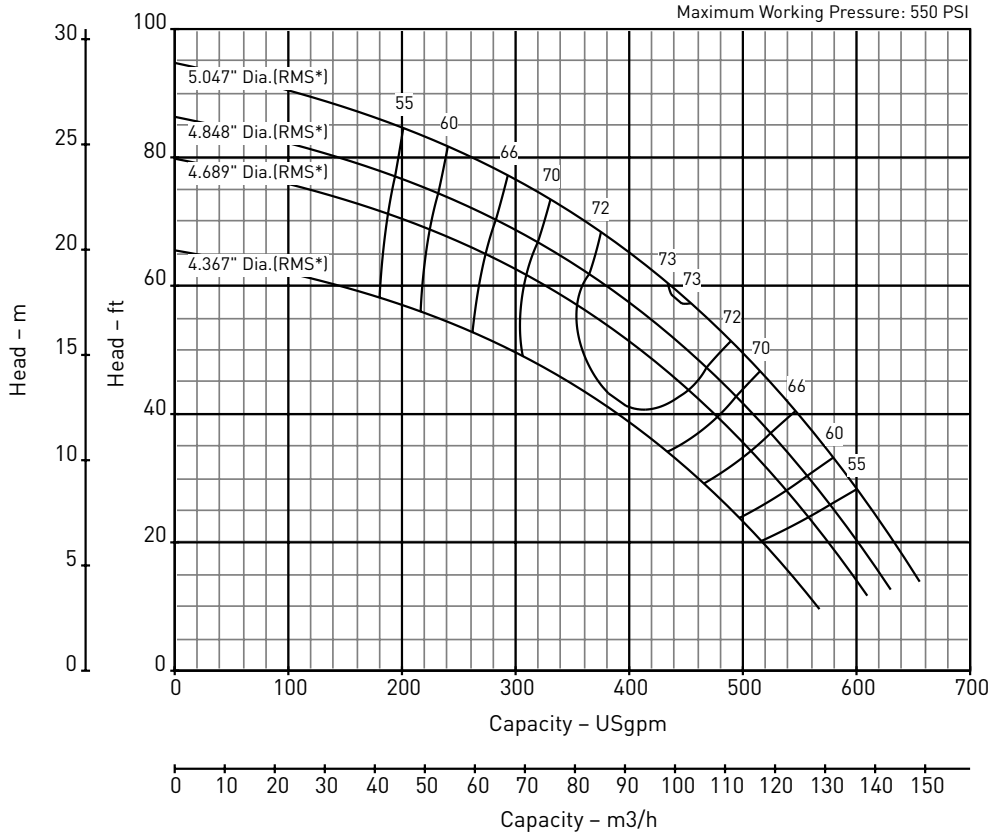

Impeller Dimensions

RMS* Diameter	A Diameter	B Diameter	C Angle
5.047	5.380	4.960	24
4.848	5.190	4.480	24
4.689	5.040	4.310	24
4.367	4.730	3.970	24

*Root-Mean-Square

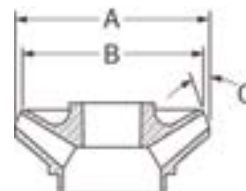

Materials of Construction

Part Name	Common Material Name	Material Spec Number
Discharge Adapter	Cast Iron	ASTM A48 Class 30
Top Bowl	Cast Iron	ASTM A48 Class 30
Intermediate Bowl	Cast Iron	ASTM A48 Class 30
Bearings, Top and Suction Case	Rubber	Neoprene
Impeller	Stainless Steel	ASTM A743 UNS C30400
Pump Shaft	Stainless Steel	ASTM AISI 416
Impeller Collets	Steel	AISI 1226
Suction Bracket	Cast Iron	ASTM A48 Class 30
Bowl Bearing	Rubber	Neoprene
Strainer	Stainless Steel	AISI 302 UNS S30200
Cable Guard	Stainless Steel	AISI 302 UNS S30200
Shaft Coupling	Stainless Steel	AISI 416 UNS S41600

Note: Efficiency based on average staging

BERKELEY® 7T-500

Submersible Turbine

Nominal RPM: 3450
Based on Fresh Water @ 68 F.
Maximum Working Pressure: 550 PSI

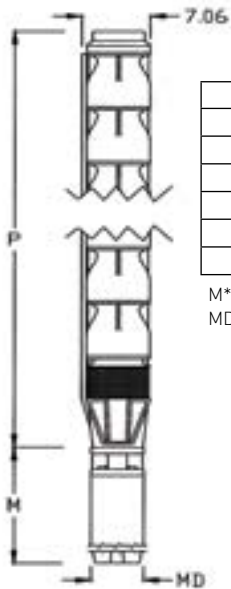
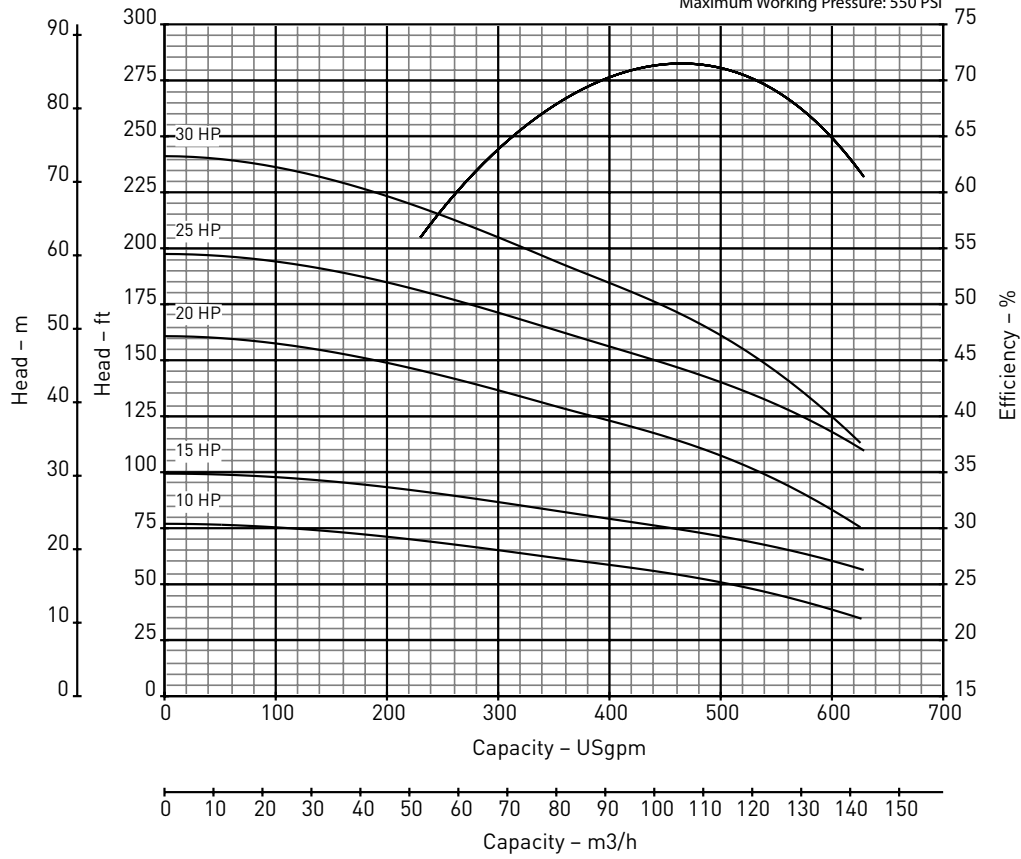

Outline Dimensions / Weights

HP	Stages	Motor Size	P Length	M* Length	MD* Diameter	Motor Weight	Pump Weight
10	1	6"	19.94	29.80	5.51	127	60
15	1	6"	19.94	30.40	5.51	130	60
20	2	6"	26.44	35.50	5.51	160	86
25	2	6"	26.44	47.20	5.51	224	86
30	3	6"	32.94	49.50	5.51	236	112

Note: Dimensions=Inches; Weight=U.S. Lbs.

M*-Maximum Length (Pentair Motor)
MD*-Motor Diameter (Pentair Motor)

Specifications

Minimum Well I.D.	8.0 Inches
Minimum Submergence @ BEP (above inlet)	10.0 Feet
Capacity Range	211 - 650 GPM
Discharge	5" F x 6" M NPT

See manufacturer's data for motor cooling requirements

BERKELEY® 7T-500

Submersible Turbine

Nominal RPM: 3450
Based on Fresh Water @ 68 F.
Maximum Working Pressure: 550 PSI

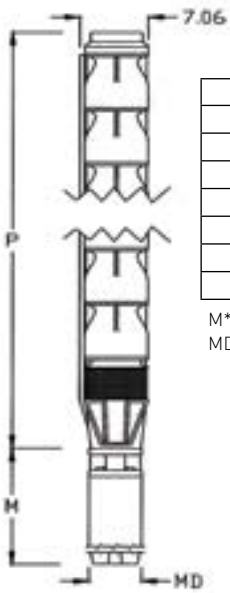
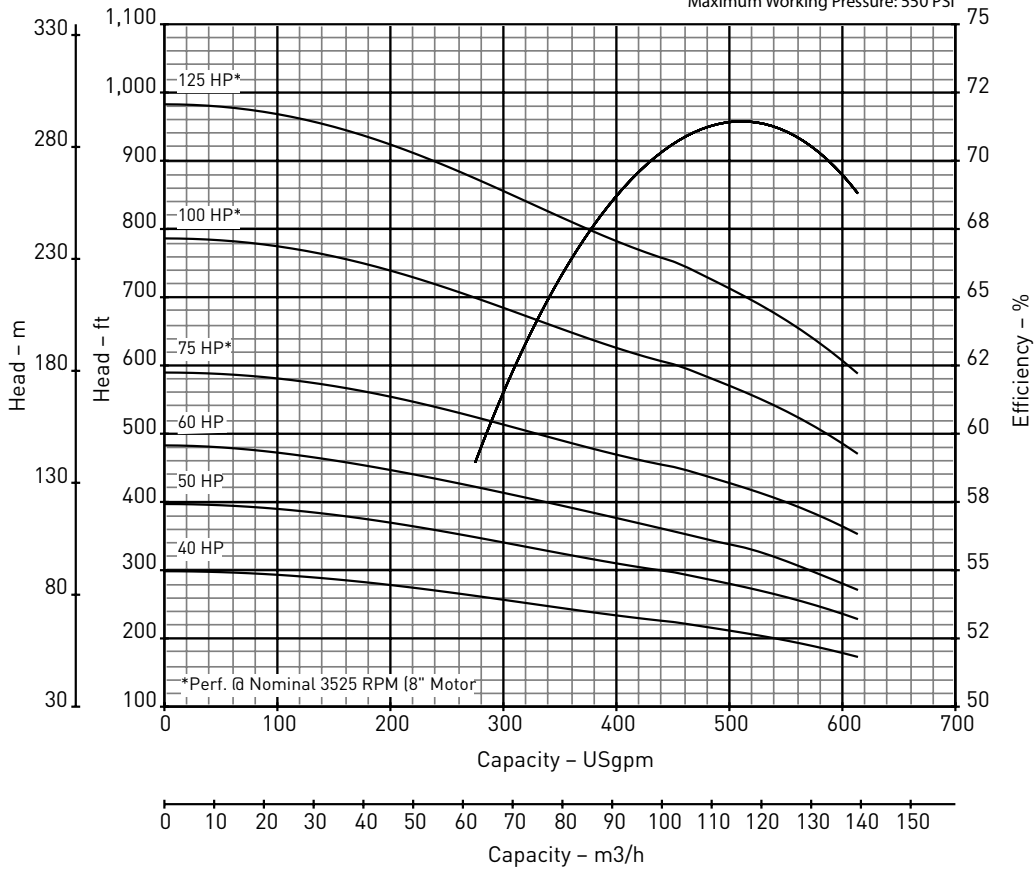

Outline Dimensions / Weights

HP	Stages	Motor Size	P Length	M* Length	MD* Diameter	Motor Weight	Pump Weight
40	3	6"	32.94	50.30	5.51	239	112
50	4	6"	39.44	52.20	5.51	251	138
60	5	6"	45.94	55.70	5.51	269	164
75	6	8"	53.94	46.79	7.58	430	242
100	8	8"	66.94	54.29	7.58	530	294
125	10	8"	79.94	68.78	7.58	700	346

Note: Dimensions=Inches; Weight=U.S. Lbs.

M*-Maximum Length (Pentair Motor)
MD*-Motor Diameter (Pentair Motor)

Specifications

Minimum Well I.D.	8.0 Inches
Minimum Submergence @ BEP (above inlet)	10.0 Feet
Capacity Range	211 - 650 GPM
Discharge	5" F x 6" M NPT

See manufacturer's data for motor cooling requirements

BERKELEY® 7T-500

Submersible Turbine - Single Stage Performance

Nominal RPM: 3450
Based on Fresh Water @ 68 F.
Maximum Working Pressure: 550 PSI

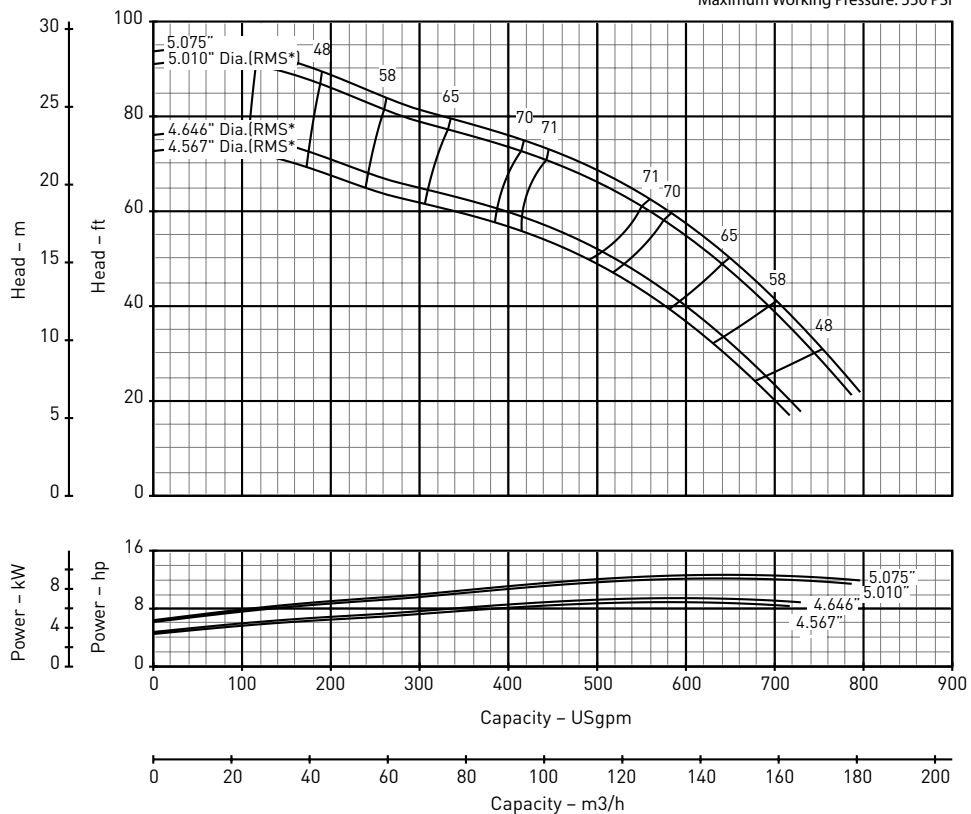

Impeller Dimensions

RMS* Diameter	A Diameter	B Diameter	C Angle
5.075	5.380	4.750	20
5.010	5.310	4.690	20
4.646	4.960	4.310	20
4.567	4.880	4.230	20

*Root-Mean-Square

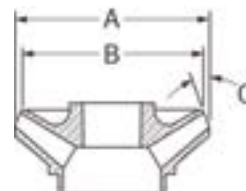

Materials of Construction

Part Name	Common Material Name	Material Spec Number
Discharge Adapter	Cast Iron	ASTM A48 Class 30
Top Bowl	Cast Iron	ASTM A48 Class 30
Intermediate Bowl	Cast Iron	ASTM A48 Class 30
Bearings, Top and Suction Case	Rubber	Neoprene
Impeller	Stainless Steel	ASTM A743 UNS C30400
Pump Shaft	Stainless Steel	ASTM AISI 416
Impeller Collets	Steel	AISI 1226
Suction Bracket	Cast Iron	ASTM A48 Class 30
Bowl Bearing	Rubber	Neoprene
Strainer	Stainless Steel	AISI 302 UNS S30200
Cable Guard	Stainless Steel	AISI 302 UNS S30200
Shaft Coupling	Stainless Steel	AISI 416 UNS S41600

Note: Efficiency based on average staging

BERKELEY® 7T-500

Submersible Turbine - Single Stage Performance

Nominal RPM: 3450
Based on Fresh Water @ 68 F.
Maximum Working Pressure: 550 PSI

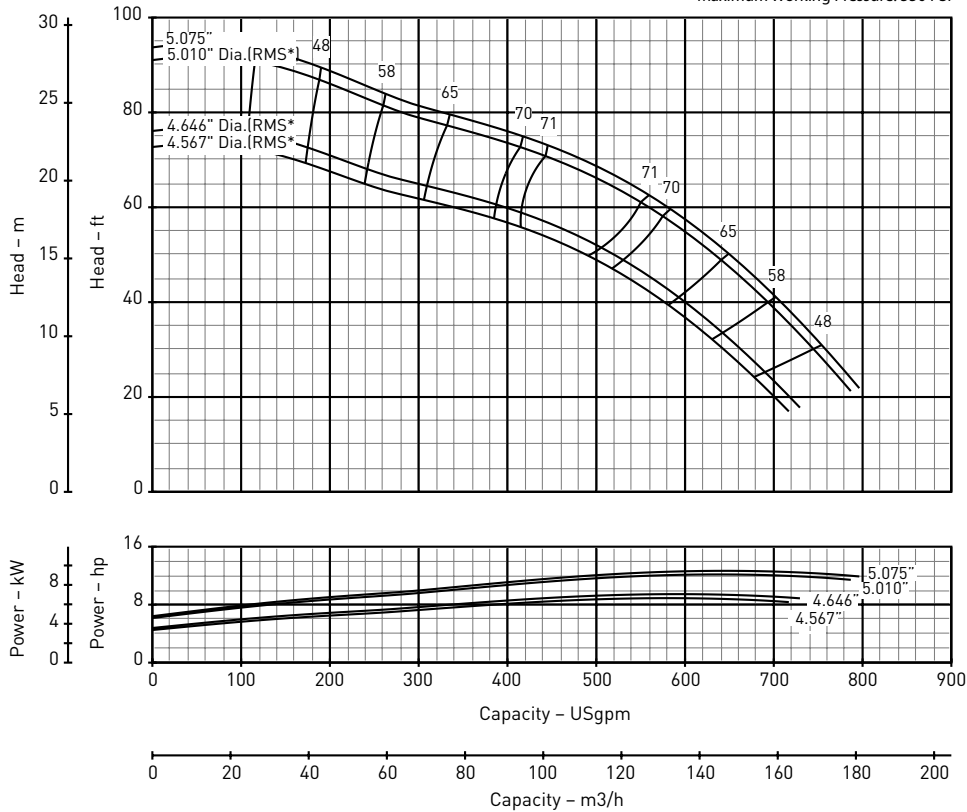

Impeller Dimensions

RMS* Diameter	A Diameter	B Diameter	C Angle
5.075	5.380	4.750	20
5.010	5.310	4.690	20
4.646	4.960	4.310	20
4.567	4.880	4.230	20

*Root-Mean-Square

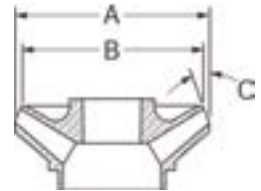

Materials of Construction

Part Name	Common Material Name	Material Spec Number
Discharge Adapter	Cast Iron	ASTM A48 Class 30
Top Bowl	Cast Iron	ASTM A48 Class 30
Intermediate Bowl	Cast Iron	ASTM A48 Class 30
Bearings, Top and Suction Case	Rubber	Neoprene
Impeller	Stainless Steel	ASTM A743 UNS C30400
Pump Shaft	Stainless Steel	ASTM AISI 416
Impeller Collets	Steel	AISI 1226
Suction Bracket	Cast Iron	ASTM A48 Class 30
Bowl Bearing	Rubber	Neoprene
Strainer	Stainless Steel	AISI 302 UNS S30200
Cable Guard	Stainless Steel	AISI 302 UNS S30200
Shaft Coupling	Stainless Steel	AISI 416 UNS S41600

Note: Efficiency based on average staging

