

BERKELEY® 6T-75

Submersible Turbine

Nominal RPM: 3450
Based on Fresh Water @ 68 F.
Maximum Working Pressure: 725 PSI

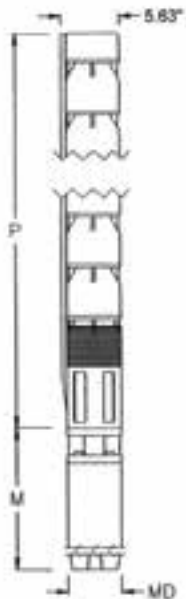
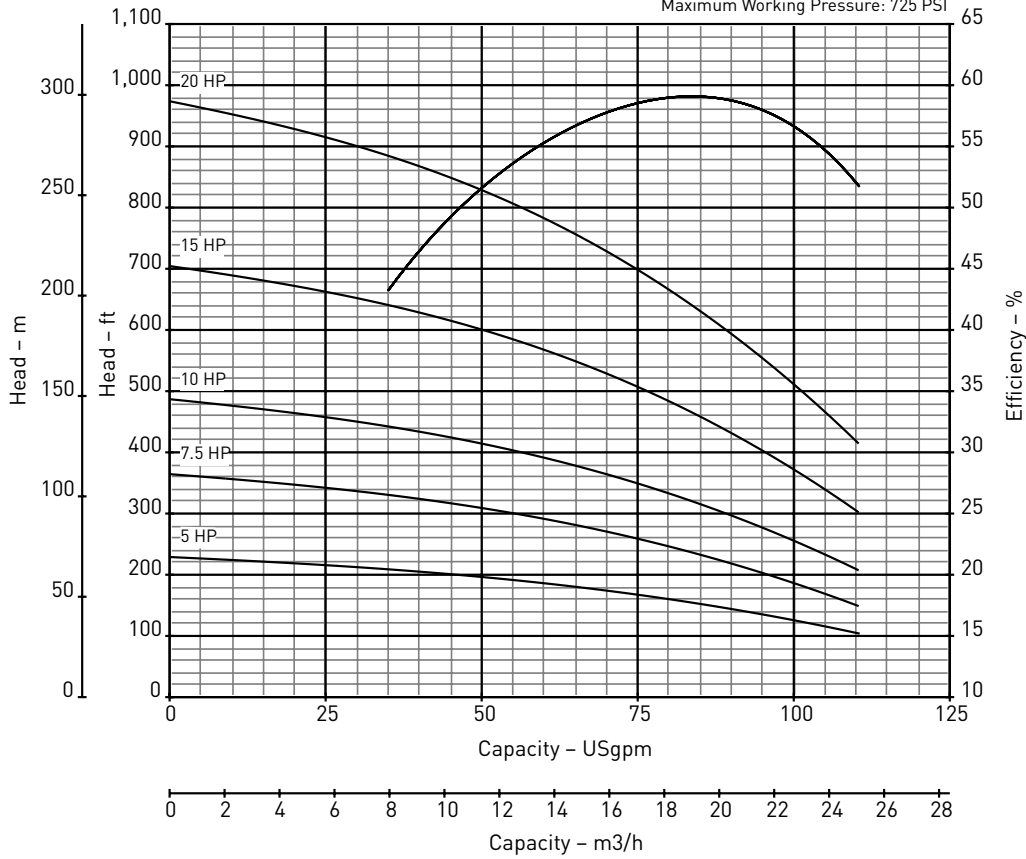

Outline Dimensions / Weights

HP	Stages	Motor Size	P Length	M* Length	MD* Diameter	Motor Weight	Pump Weight
5	4	6"	29.73	27.00	5.51	95	80
7.5	7	6"	41.54	27.60	5.51	114	116
10	9	6"	49.41	29.80	5.51	127	141
15	13	6"	65.16	30.40	5.51	130	189
20	18	6"	84.85	35.50	5.51	160	250

Note: Dimensions=Inches; Weight=U.S. Lbs.

M*-Maximum Length (Pentair Motor)
MD*-Motor Diameter (Pentair Motor)

Specifications

Minimum Well I.D.	6.0 Inches
Minimum Submergence @ BEP (above inlet)	10.0 Feet
Capacity Range	35 - 110 GPM
Discharge	3" F NPT

See manufacturer's data for motor cooling requirements

BERKELEY® 6T-75

Submersible Turbine - Single Stage Performance

Nominal RPM: 3450
Based on Fresh Water @ 68 F.
Maximum Working Pressure: 725 PSI

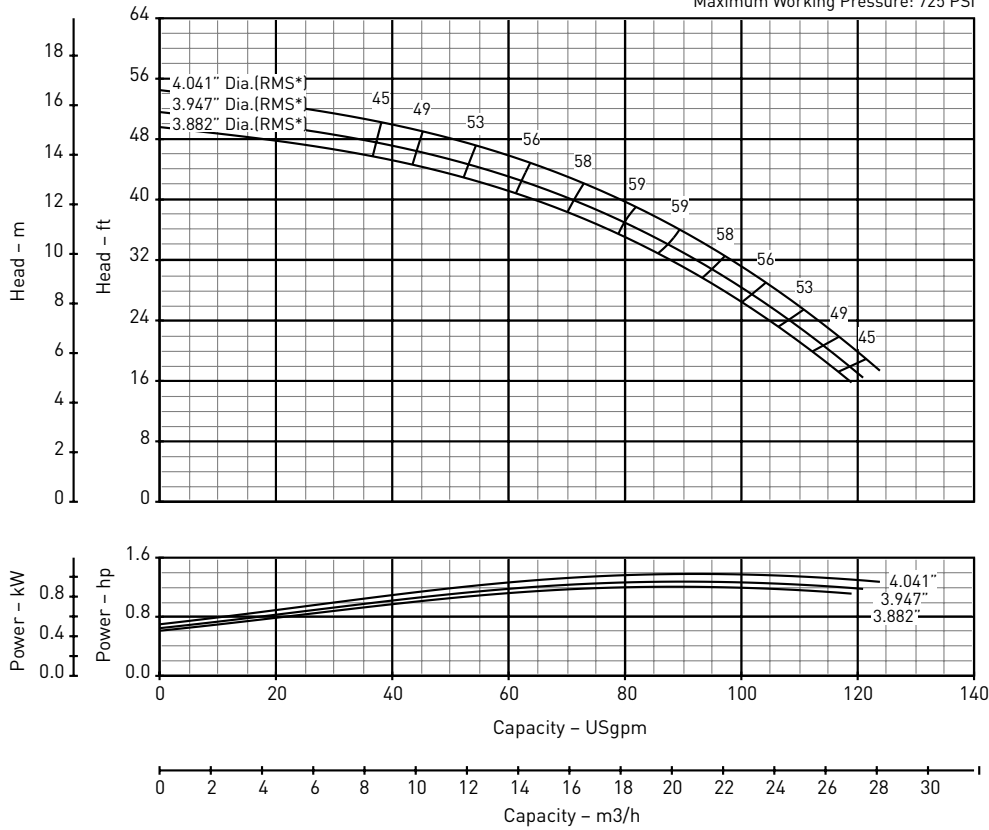

Impeller Dimensions

RMS* Diameter	A Diameter	B Diameter	C Angle
4.041	4.130	39.50	20
3.947	4.060	3.830	20
3.882	4.00	3.760	20

*Root-Mean-Square

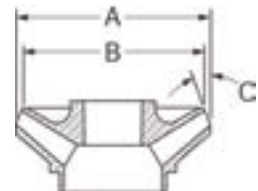

Materials of Construction

Part Name	Common Material Name	Material Spec Number
Discharge Adapter	Cast Iron	ASTM A48 Class 30
Top Bowl	Cast Iron	ASTM A48 Class 30
Intermediate Bowl	Cast Iron	ASTM A48 Class 30
Bearings, Top and Suction Case	Rubber	Neoprene
Impeller	Stainless Steel	ASTM A743 UNS C30400
Pump Shaft	Stainless Steel	ASTM AISI 416
Impeller Collets	Steel	AISI 1226
Suction Bracket	Cast Iron	ASTM A48 Class 30
Bowl Bearing	Rubber	Neoprene
Strainer	Stainless Steel	AISI 302 UNS S30200
Cable Guard	Stainless Steel	AISI 302 UNS S30200
Shaft Coupling	Stainless Steel	AISI 416 UNS S41600

Note: Efficiency based on average staging



BERKELEY® 6T-90

Submersible Turbine

Nominal RPM: 3450
Based on Fresh Water @ 68 F.
Maximum Working Pressure: 725 PSI

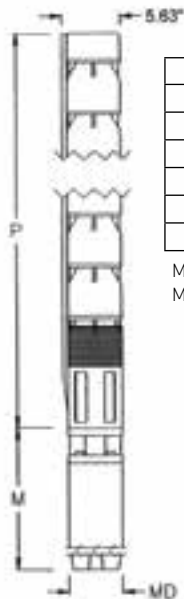
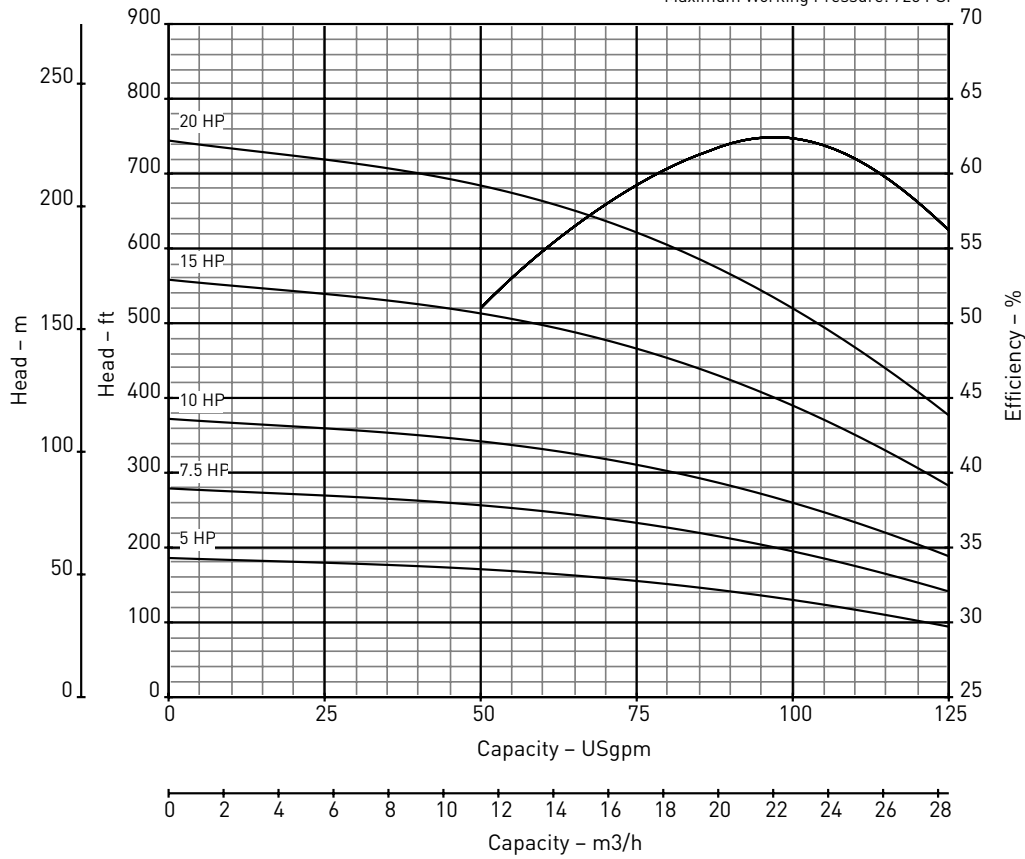

Outline Dimensions / Weights

HP	Stages	Motor Size	P Length	M* Length	MD* Diameter	Motor Weight	Pump Weight
5	4	6"	29.73	27.00	5.51	95	79
7.5	6	6"	37.60	27.60	5.51	114	103
10	8	6"	45.48	29.80	5.51	127	27
15	12	6"	61.22	30.40	5.51	130	175
20	16	6"	76.97	35.50	5.51	160	222

Note: Dimensions=Inches; Weight=U.S. Lbs.

M*-Maximum Length (Pentair Motor)
MD*-Motor Diameter (Pentair Motor)

Specifications

Minimum Well I.D.	6.0 Inches
Minimum Submergence @ BEP (above inlet)	10.0 Feet
Capacity Range	45 - 125 GPM
Discharge	3" F NPT

See manufacturer's data for motor cooling requirements

BERKELEY® 6T-90

Submersible Turbine - Single Stage Performance

Nominal RPM: 3450
Based on Fresh Water @ 68 F.
Maximum Working Pressure: 725 PSI

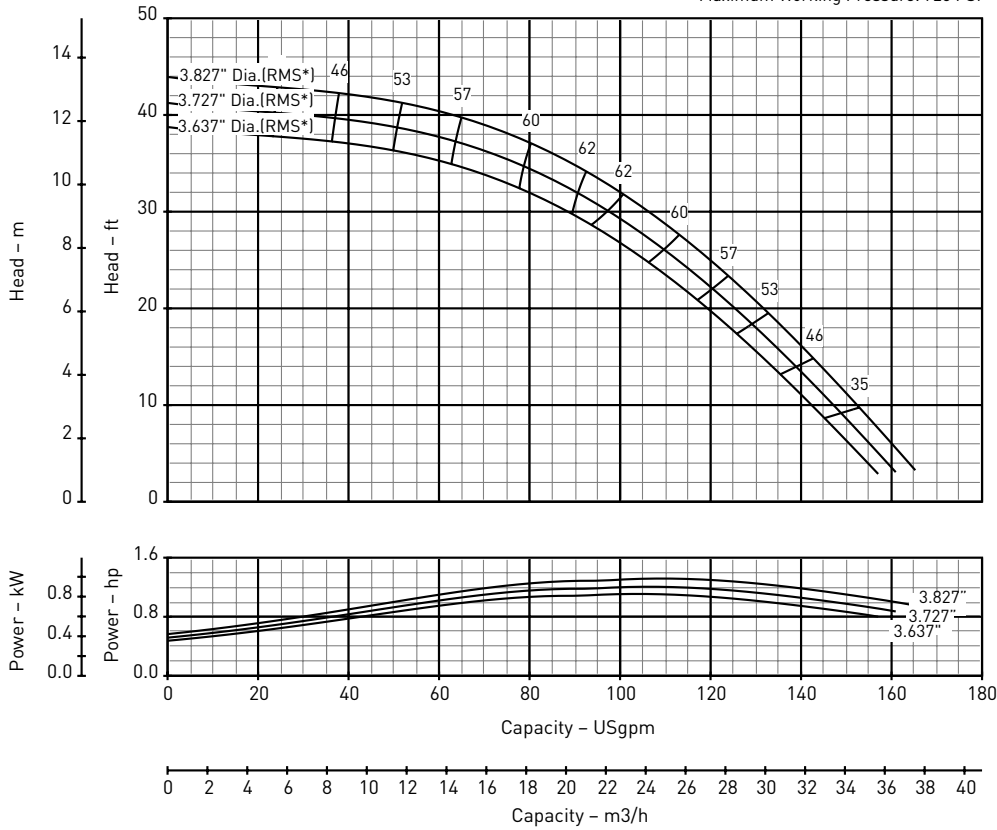

Impeller Dimensions

RMS* Diameter	A Diameter	B Diameter	C Angle
3.827	3.940	3.710	20
3.727	3.840	3.610	20
3.637	3.750	3.520	20

*Root-Mean-Square

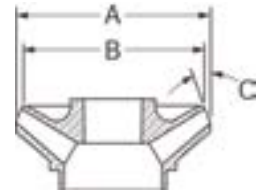

Materials of Construction

Part Name	Common Material Name	Material Spec Number
Discharge Adapter	Cast Iron	ASTM A48 Class 30
Top Bowl	Cast Iron	ASTM A48 Class 30
Intermediate Bowl	Cast Iron	ASTM A48 Class 30
Bearings, Top and Suction Case	Rubber	Neoprene
Impeller	Stainless Steel	ASTM A743 UNS C30400
Pump Shaft	Stainless Steel	ASTM AISI 416
Impeller Collets	Steel	AISI 1226
Suction Bracket	Cast Iron	ASTM A48 Class 30
Bowl Bearing	Rubber	Neoprene
Strainer	Stainless Steel	AISI 302 UNS S30200
Cable Guard	Stainless Steel	AISI 302 UNS S30200
Shaft Coupling	Stainless Steel	AISI 416 UNS S41600

Note: Efficiency based on average staging

BERKELEY® 6T-115

Submersible Turbine

Nominal RPM: 3450
Based on Fresh Water @ 68 F.
Maximum Working Pressure: 606 PSI

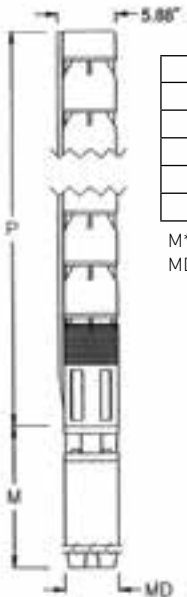
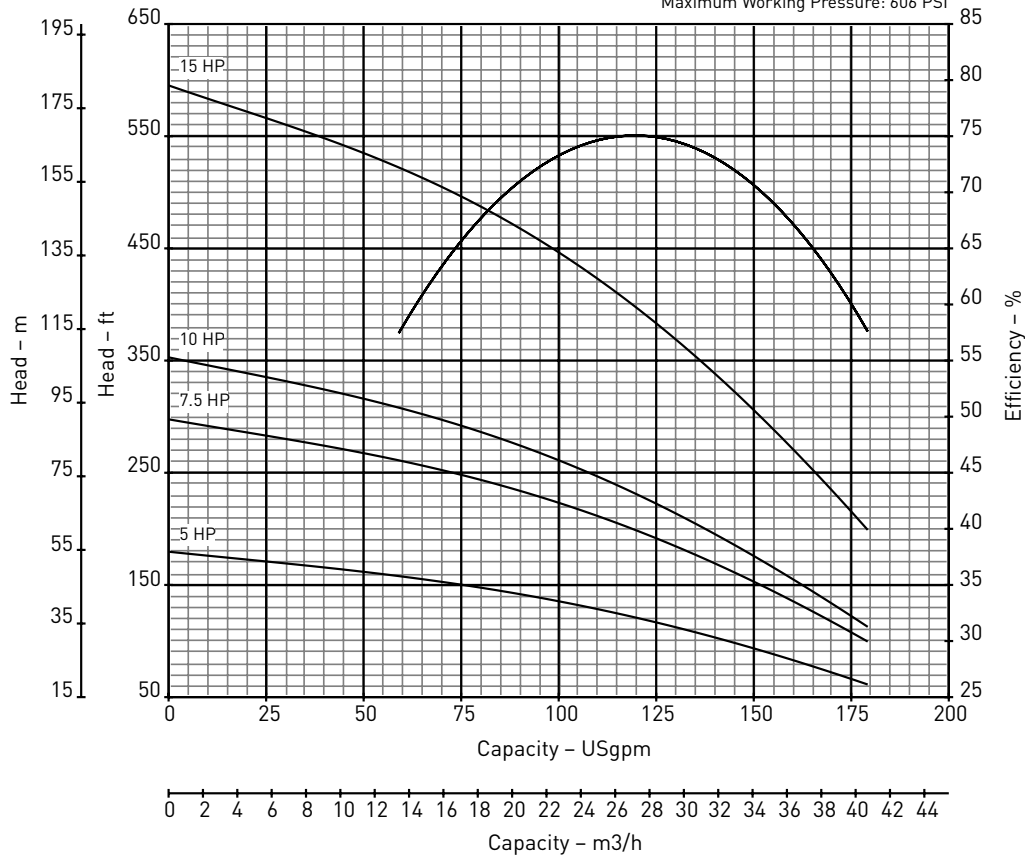

Outline Dimensions / Weights

HP	Stages	Motor Size	P Length	M* Length	MD* Diameter	Motor Weight	Pump Weight
5	3	6"	27.88	27.00	5.51	95	91
7.5	5	6"	37.13	27.60	5.51	114	127
10	6	6"	41.75	29.80	5.51	127	145
15	10	6"	60.25	30.40	5.51	130	217

Note: Dimensions=Inches; Weight=U.S. Lbs.

M*-Maximum Length (Pentair Motor)
MD*-Motor Diameter (Pentair Motor)

Specifications

Minimum Well I.D.	6.0 Inches
Minimum Submergence @ BEP (above inlet)	10.0 Feet
Capacity Range	59 - 179 GPM
Discharge	3" F NPT

See manufacturer's data for motor cooling requirements

BERKELEY® 6T-115

Submersible Turbine

Nominal RPM: 3450
 Based on Fresh Water @ 68 F.
 Maximum Working Pressure: 606 PSI

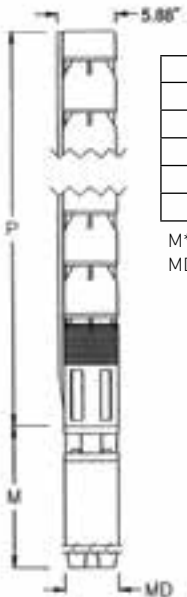
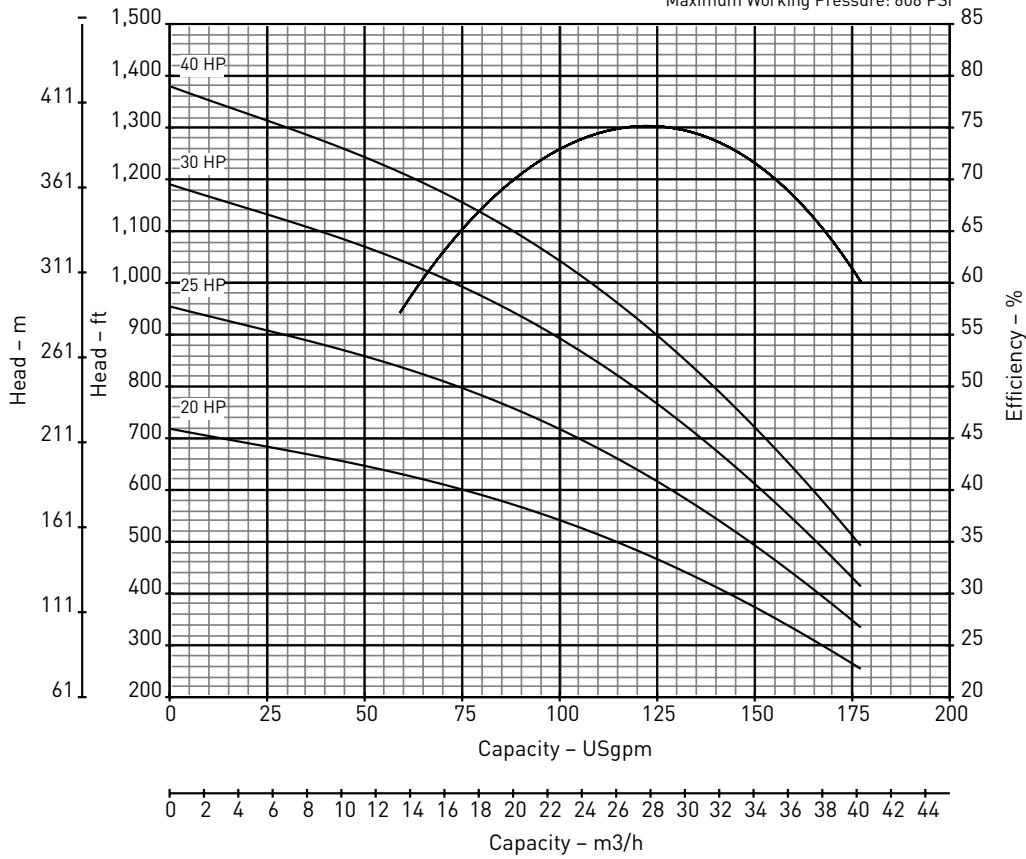

Outline Dimensions / Weights

HP	Stages	Motor Size	P Length	M* Length	MD* Diameter	Motor Weight	Pump Weight
20	12	6"	69.50	35.50	5.51	160	252
25	16	6"	88.00	47.20	5.51	224	324
30	20	6"	106.49	49.50	5.51	236	396
40	23	6"	120.37	50.30	5.51	239	450

Note: Dimensions=Inches; Weight=U.S. Lbs.

M*-Maximum Length (Pentair Motor)
 MD*-Motor Diameter (Pentair Motor)

Specifications

Minimum Well I.D.	6.0 Inches
Minimum Submergence @ BEP (above inlet)	10.0 Feet
Capacity Range	59 - 179 GPM
Discharge	3" F NPT

See manufacturer's data for motor cooling requirements

BERKELEY® 6T-115

Submersible Turbine - Single Stage Performance

Nominal RPM: 3450
Based on Fresh Water @ 68 F.
Maximum Working Pressure: 606 PSI

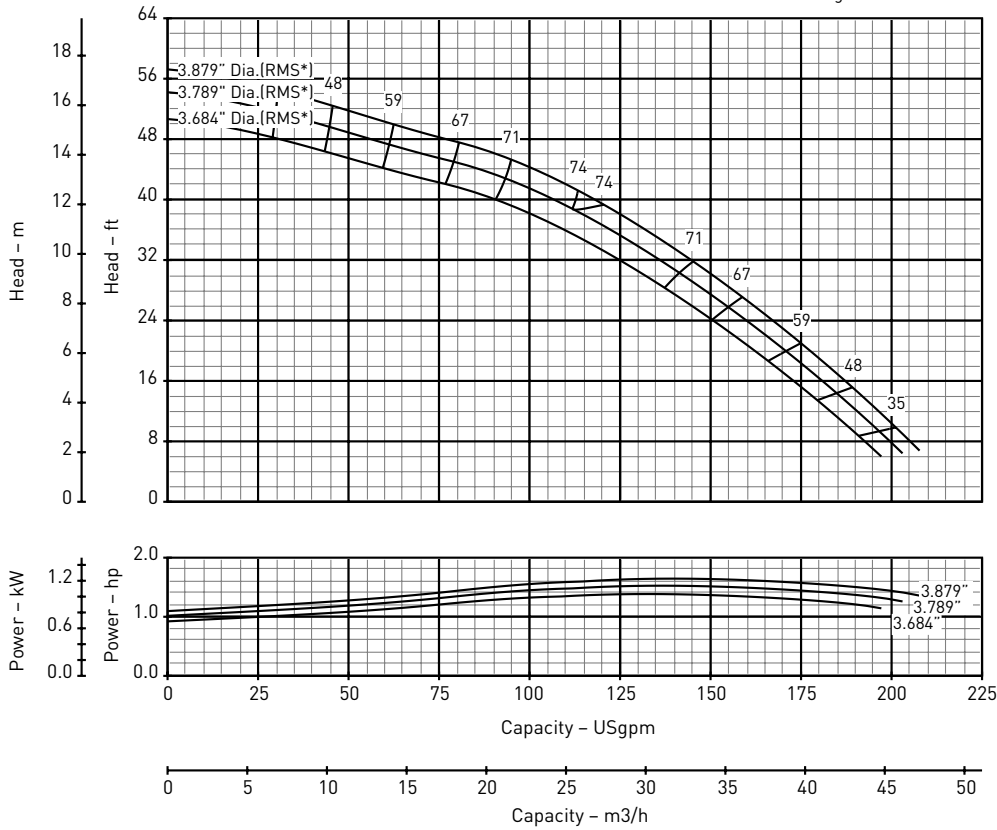

Impeller Dimensions

RMS* Diameter	A Diameter	B Diameter	C Angle
3.879	4.040	3.710	21
3.789	3.950	3.620	21
3.684	3.850	3.510	21

*Root-Mean-Square

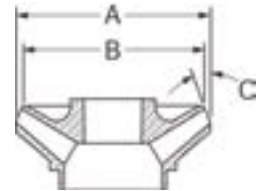

Materials of Construction

Part Name	Common Material Name	Material Spec Number
Discharge Adapter	Cast Iron	ASTM A48 Class 30
Top Bowl	Cast Iron	ASTM A48 Class 30
Intermediate Bowl	Cast Iron	ASTM A48 Class 30
Bearings, Top and Suction Case	Rubber	Neoprene
Impeller	Stainless Steel	ASTM A743 UNS C30400
Pump Shaft	Stainless Steel	ASTM AISI 416
Impeller Collets	Steel	AISI 1226
Suction Bracket	Cast Iron	ASTM A48 Class 30
Bowl Bearing	Rubber	Neoprene
Strainer	Stainless Steel	AISI 302 UNS S30200
Cable Guard	Stainless Steel	AISI 302 UNS S30200
Shaft Coupling	Stainless Steel	AISI 416 UNS S41600

Note: Efficiency based on average staging



BERKELEY® 6T-155

Submersible Turbine

Nominal RPM: 3450
Based on Fresh Water @ 68 F.
Maximum Working Pressure: 606 PSI

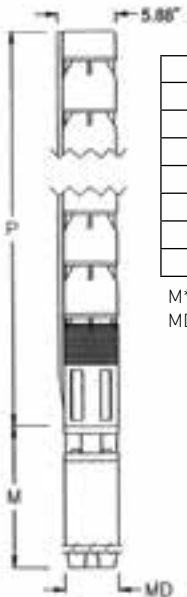
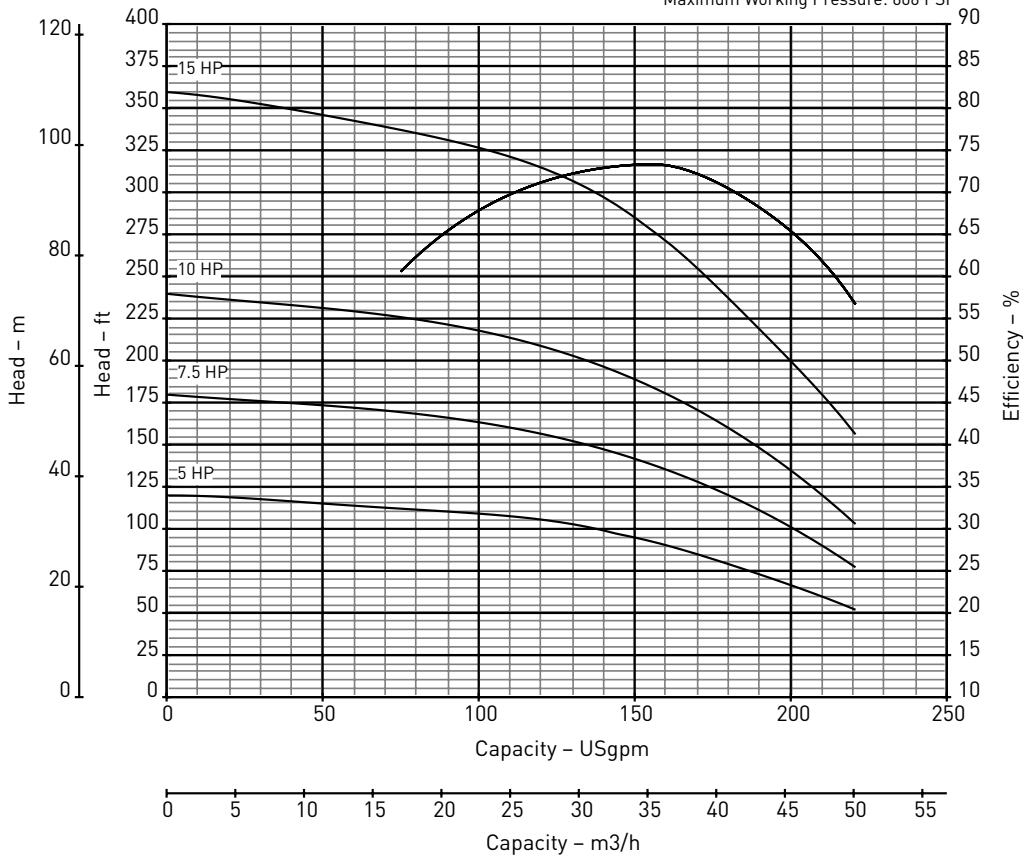

Outline Dimensions / Weights

HP	Stages	Motor Size	P Length	M* Length	MD* Diameter	Motor Weight	Pump Weight
5	2	4"	23.25	27.00	3.75	95	73
5	2	6"	23.25	27.00	5.51	95	73
7.5	3	4"	27.88	27.60	3.75	114	91
7.5	3	6"	27.88	27.60	5.51	114	91
10	4	6"	32.50	29.80	5.51	127	109
15	6	6"	41.75	30.40	5.51	130	145

Note: Dimensions=Inches; Weight=U.S. Lbs.

M*-Maximum Length (Pentair Motor)
MD*-Motor Diameter (Pentair Motor)

Specifications

Minimum Well I.D.	6.0 Inches
Minimum Submergence @ BEP (above inlet)	10.0 Feet
Capacity Range	48 - 210 GPM
Discharge	3" F NPT

See manufacturer's data for motor cooling requirements

BERKELEY® 6T-155

Submersible Turbine

Nominal RPM: 3450
Based on Fresh Water @ 68 F.
Maximum Working Pressure: 606 PSI

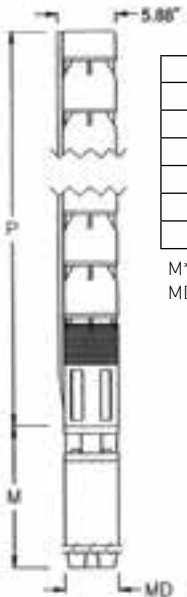
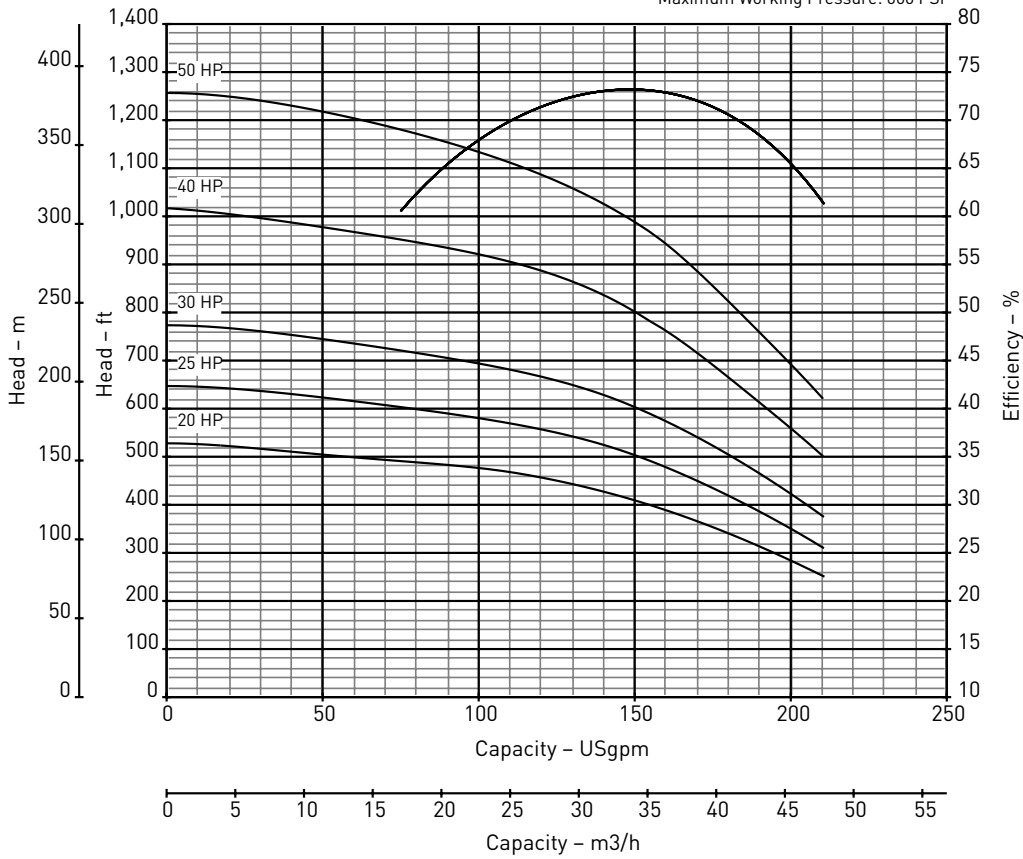

Outline Dimensions / Weights

HP	Stages	Motor Size	P Length	M* Length	MD* Diameter	Motor Weight	Pump Weight
20	9	6"	55.63	35.50	5.51	160	199
25	11	6"	64.88	47.20	5.51	224	235
30	13	6"	74.13	49.50	5.51	236	270
40	17	6"	92.63	50.30	5.51	239	342
50	21	6"	111.13	52.20	5.51	251	414

Note: Dimensions=Inches; Weight=U.S. Lbs.

M*-Maximum Length (Pentair Motor)
MD*-Motor Diameter (Pentair Motor)

Specifications

Minimum Well I.D.	6.0 Inches
Minimum Submergence @ BEP (above inlet)	10.0 Feet
Capacity Range	48 - 210 GPM
Discharge	3" F NPT

See manufacturer's data for motor cooling requirements

BERKELEY® 6T-155

Submersible Turbine - Single Stage Performance

Nominal RPM: 3450
Based on Fresh Water @ 68 F.
Maximum Working Pressure: 606 PSI

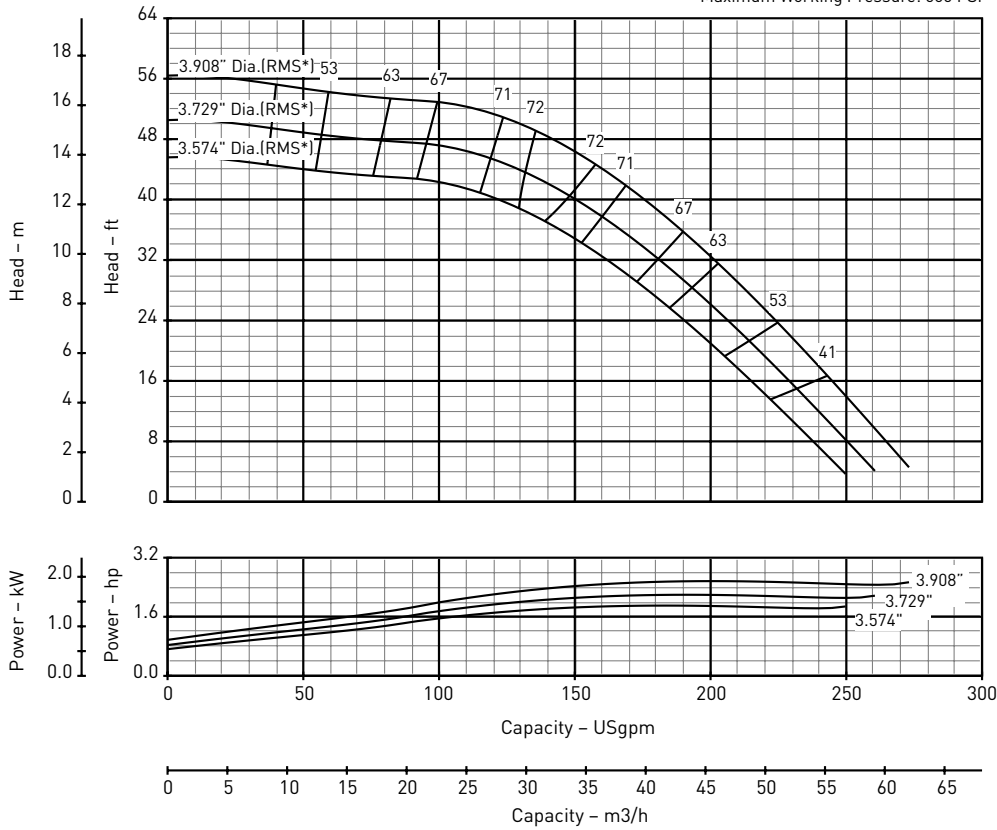

Impeller Dimensions

RMS* Diameter	A Diameter	B Diameter	C Angle
3.908	4.070	3.740	21
3.729	3.890	3.560	21
3.574	3.740	3.400	21

*Root-Mean-Square

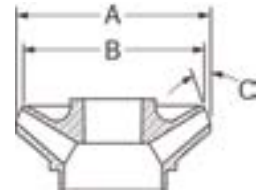

Materials of Construction

Part Name	Common Material Name	Material Spec Number
Discharge Adapter	Cast Iron	ASTM A48 Class 30
Top Bowl	Cast Iron	ASTM A48 Class 30
Intermediate Bowl	Cast Iron	ASTM A48 Class 30
Bearings, Top and Suction Case	Rubber	Neoprene
Impeller	Stainless Steel	ASTM A743 UNS C30400
Pump Shaft	Stainless Steel	ASTM AISI 416
Impeller Collets	Steel	AISI 1226
Suction Bracket	Cast Iron	ASTM A48 Class 30
Bowl Bearing	Rubber	Neoprene
Strainer	Stainless Steel	AISI 302 UNS S30200
Cable Guard	Stainless Steel	AISI 302 UNS S30200
Shaft Coupling	Stainless Steel	AISI 416 UNS S41600

Note: Efficiency based on average staging



BERKELEY® 6T-200

Submersible Turbine

Nominal RPM: 3450
Based on Fresh Water @ 68 F.
Maximum Working Pressure: 580 PSI

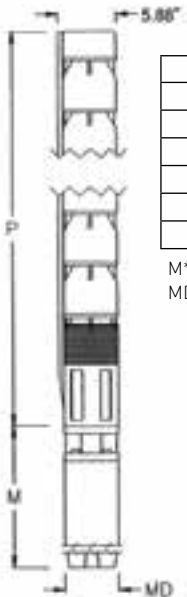
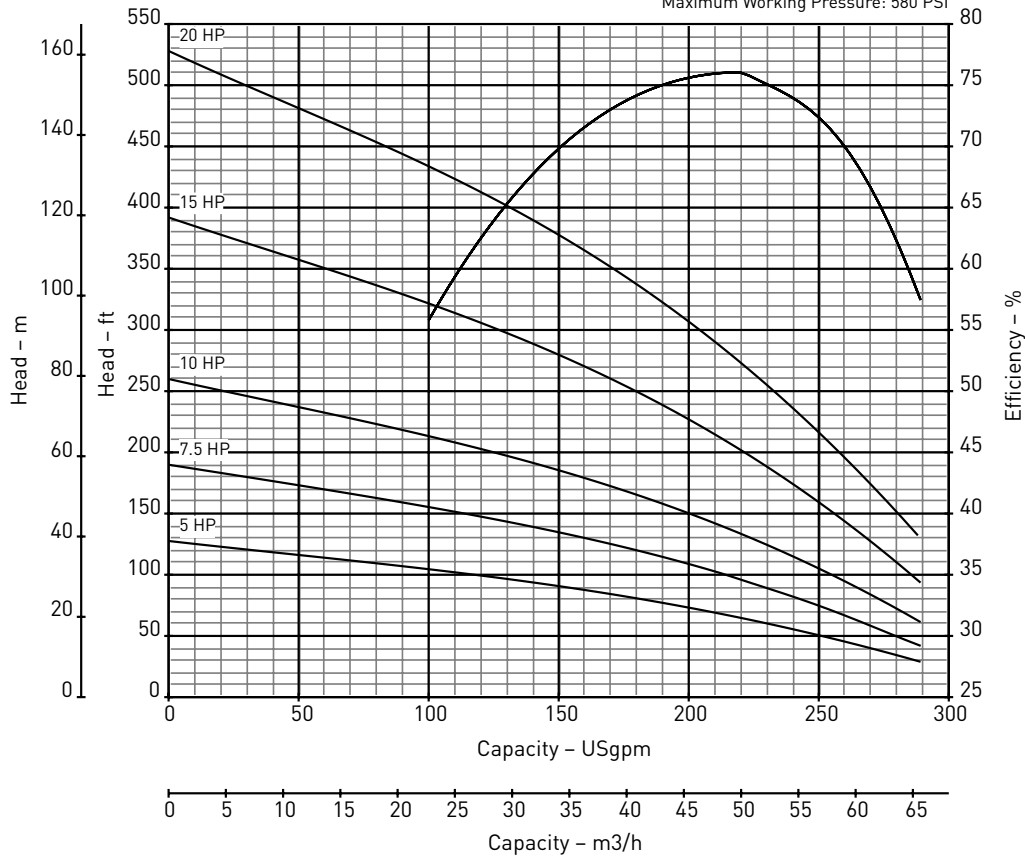

Outline Dimensions / Weights

HP	Stages	Motor Size	P Length	M* Length	MD* Diameter	Motor Weight	Pump Weight
5	2	6"	23.98	27.00	5.51	95	76
7.5	3	6"	28.98	27.60	5.51	114	95
10	4	6"	33.98	29.80	5.51	127	115
15	6	6"	43.98	30.40	5.51	130	154
20	8	6"	53.98	35.50	5.51	160	193

Note: Dimensions=Inches; Weight=U.S. Lbs.

M*-Maximum Length (Pentair Motor)
MD*-Motor Diameter (Pentair Motor)

Specifications

Minimum Well I.D.	6.0 Inches
Minimum Submergence @ BEP (above inlet)	10.0 Feet
Capacity Range	95 - 290 GPM
Discharge	3" F NPT

See manufacturer's data for motor cooling requirements

BERKELEY® 6T-200

Submersible Turbine

Nominal RPM: 3450
Based on Fresh Water @ 68 F.
Maximum Working Pressure: 580 PSI

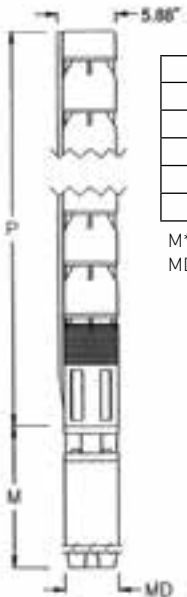
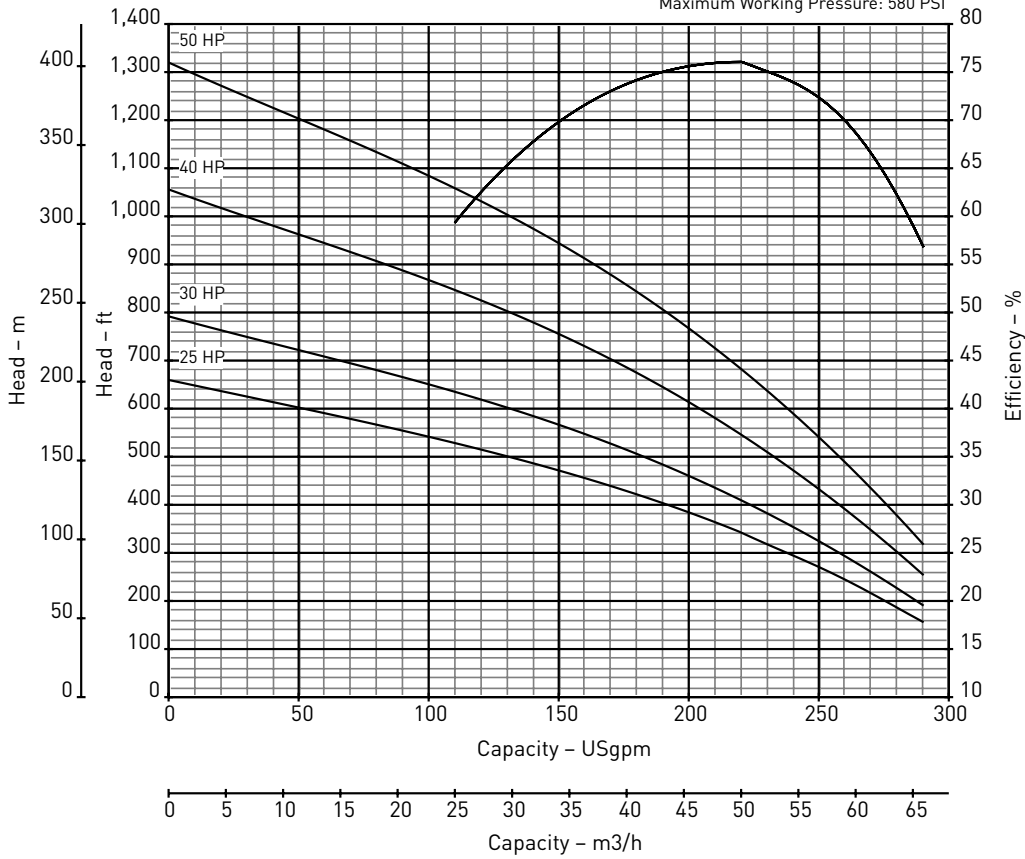

Outline Dimensions / Weights

HP	Stages	Motor Size	P Length	M* Length	MD* Diameter	Motor Weight	Pump Weight
25	10	6"	63.98	47.20	5.51	224	233
30	12	6"	73.98	49.50	5.51	236	272
40	16	6"	93.98	50.30	5.51	239	350
50	20	6"	113.98	52.20	5.51	251	429

Note: Dimensions=Inches; Weight=U.S. Lbs.

M*-Maximum Length (Pentair Motor)
MD*-Motor Diameter (Pentair Motor)

Specifications

Minimum Well I.D.	6.0 Inches
Minimum Submergence @ BEP (above inlet)	10.0 Feet
Capacity Range	95 - 290 GPM
Discharge	3" F NPT

See manufacturer's data for motor cooling requirements

BERKELEY® 6T-200

Submersible Turbine - Single Stage Performance

Nominal RPM: 3450
Based on Fresh Water @ 68 F.
Maximum Working Pressure: 580 PSI

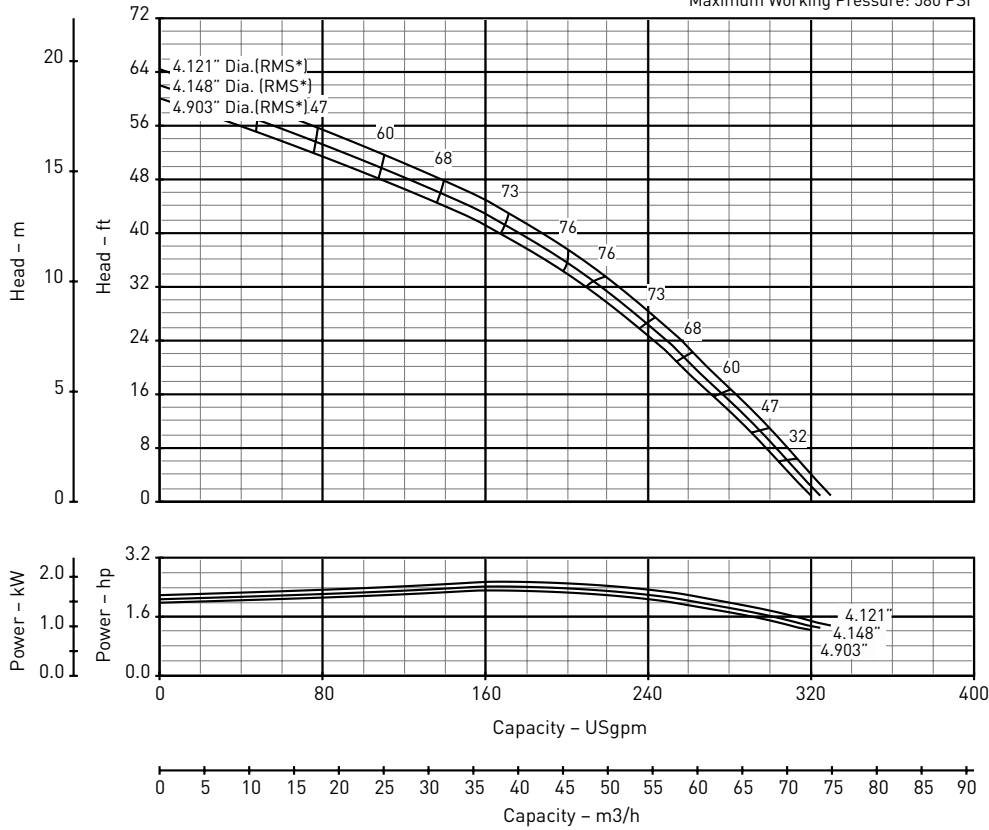

Impeller Dimensions

RMS* Diameter	A Diameter	B Diameter	C Angle
4.212	4.520	3.880	32
4.148	4.460	3.810	32
4.093	4.410	3.750	32

*Root-Mean-Square

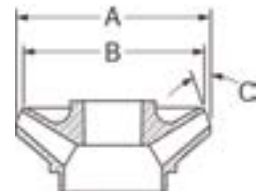

Materials of Construction

Part Name	Common Material Name	Material Spec Number
Discharge Adapter	Cast Iron	ASTM A48 Class 30
Top Bowl	Cast Iron	ASTM A48 Class 30
Intermediate Bowl	Cast Iron	ASTM A48 Class 30
Bearings, Top and Suction Case	Rubber	Neoprene
Impeller	Stainless Steel	ASTM A743 UNS C30400
Pump Shaft	Stainless Steel	ASTM AISI 416
Impeller Collets	Steel	AISI 1226
Suction Bracket	Cast Iron	ASTM A48 Class 30
Bowl Bearing	Rubber	Neoprene
Strainer	Stainless Steel	AISI 302 UNS S30200
Cable Guard	Stainless Steel	AISI 302 UNS S30200
Shaft Coupling	Stainless Steel	AISI 416 UNS S41600

Note: Efficiency based on average staging



BERKELEY® 6T-225

Submersible Turbine

Nominal RPM: 3450
Based on Fresh Water @ 68 F.
Maximum Working Pressure: 580 PSI

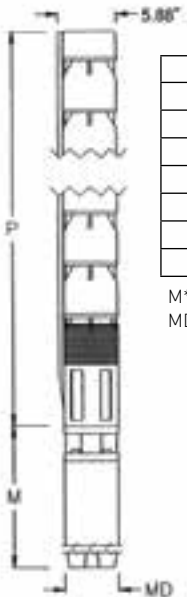
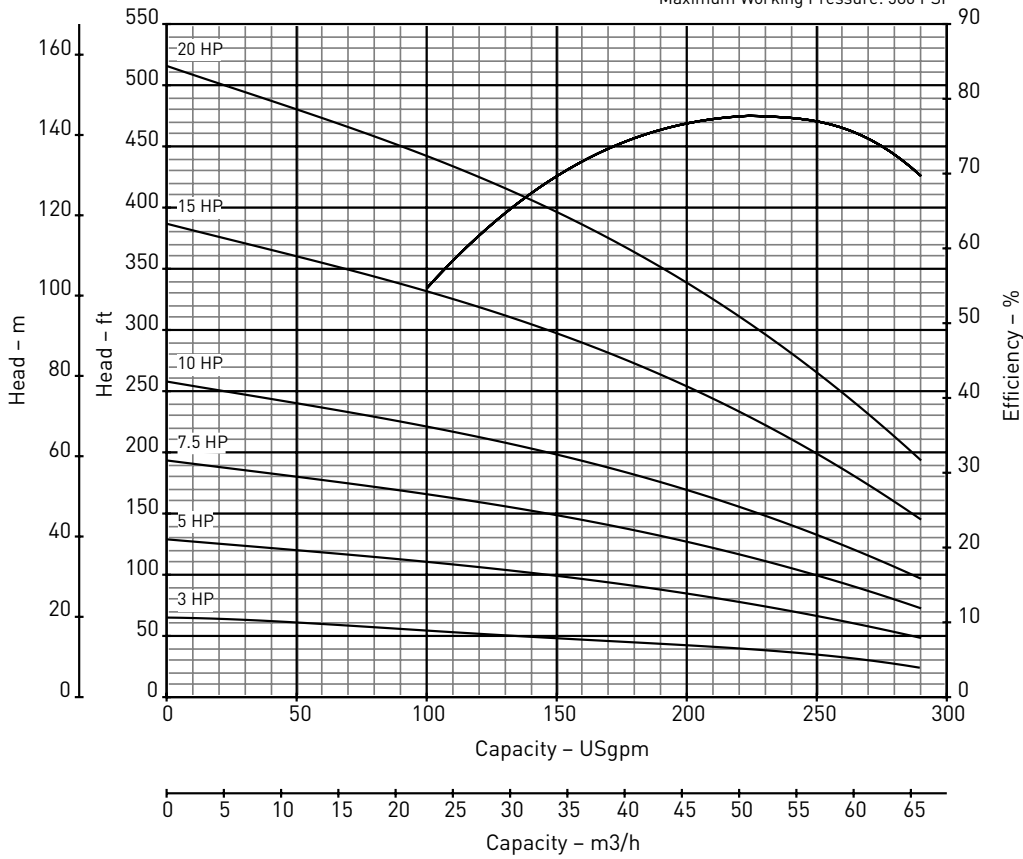

Outline Dimensions / Weights

HP	Stages	Motor Size	P Length	M* Length	MD* Diameter	Motor Weight	Pump Weight
3	1	4"	15.61	23.62	3.75	53	54
5	2	6"	23.98	27.00	5.51	95	75
7.5	3	6"	28.98	27.60	5.51	114	94
10	4	6"	33.98	29.80	5.51	127	114
15	6	6"	43.98	30.40	5.51	130	152
20	8	6"	53.98	35.50	5.51	160	191

Note: Dimensions=Inches; Weight=U.S. Lbs.

M*-Maximum Length (Pentair Motor)
MD*-Motor Diameter (Pentair Motor)

Specifications

Minimum Well I.D.	6.0 Inches
Minimum Submergence @ BEP (above inlet)	10.0 Feet
Capacity Range	100 - 300 GPM
Discharge	4" F NPT

See manufacturer's data for motor cooling requirements

BERKELEY® 6T-225

Submersible Turbine

Nominal RPM: 3450
Based on Fresh Water @ 68 F.
Maximum Working Pressure: 580 PSI

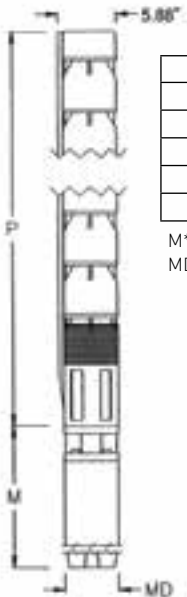
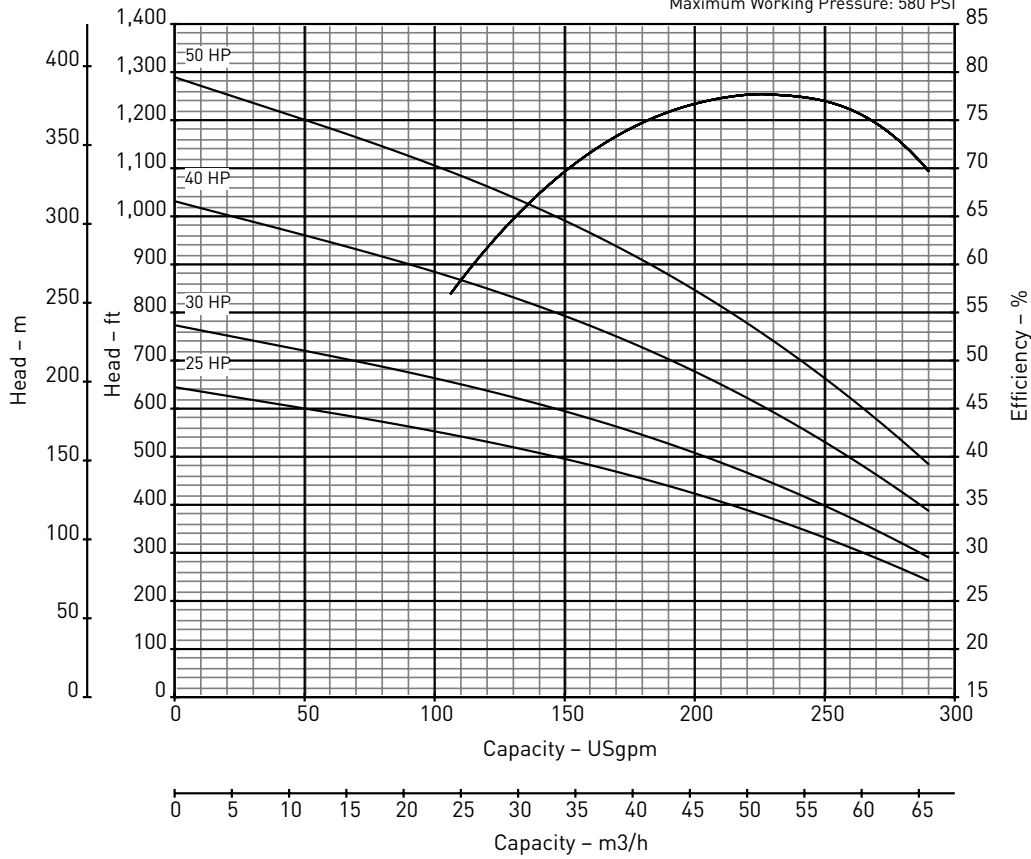

Outline Dimensions / Weights

HP	Stages	Motor Size	P Length	M* Length	MD* Diameter	Motor Weight	Pump Weight
25	10	6"	63.98	47.20	5.51	224	230
30	12	6"	73.98	49.50	5.51	236	269
40	16	6"	93.98	50.30	5.51	239	346
50	20	6"	113.98	52.20	5.51	251	424

Note: Dimensions=Inches; Weight=U.S. Lbs.

M*-Maximum Length (Pentair Motor)
MD*-Motor Diameter (Pentair Motor)

Specifications

Minimum Well I.D.	6.0 Inches
Minimum Submergence @ BEP (above inlet)	10.0 Feet
Capacity Range	100 - 300 GPM
Discharge	4" F NPT

See manufacturer's data for motor cooling requirements

BERKELEY® 6T-225

Submersible Turbine - Single Stage Performance

Nominal RPM: 3450
Based on Fresh Water @ 68 F.
Maximum Working Pressure: 580 PSI

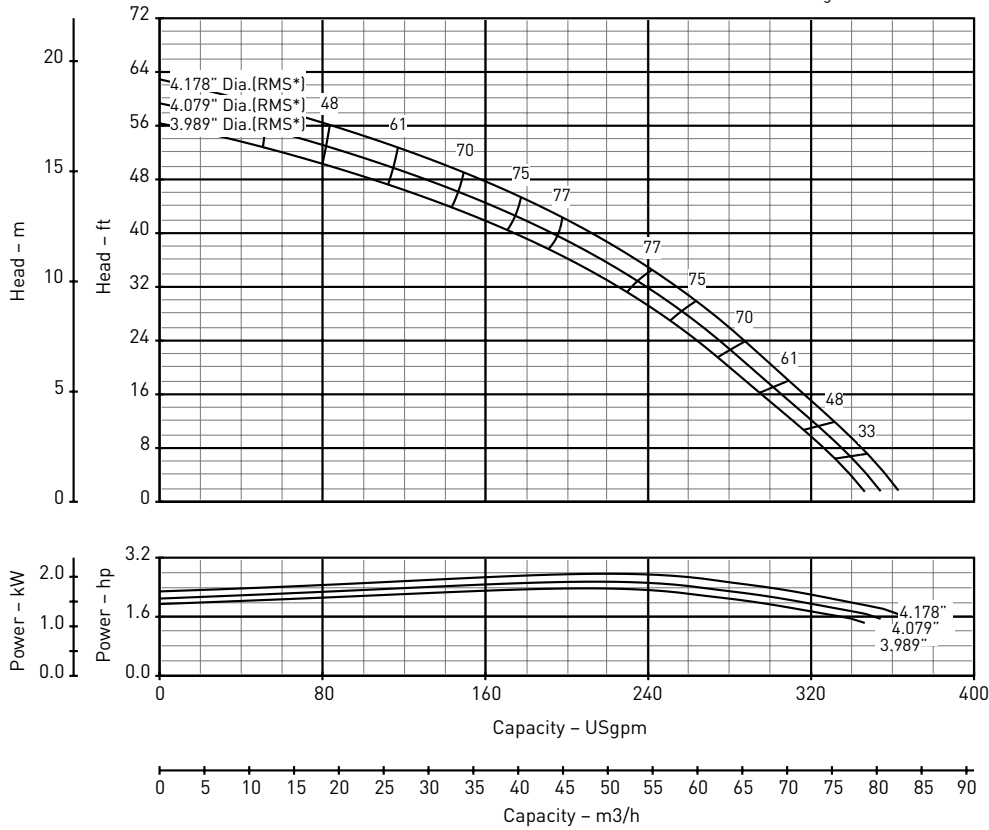

Impeller Dimensions

RMS* Diameter	A Diameter	B Diameter	C Angle
4.178	4.500	3.830	32
4.079	4.400	3.730	32
3.989	4.310	3.640	32

*Root-Mean-Square

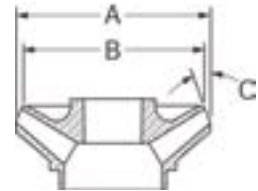

Materials of Construction

Part Name	Common Material Name	Material Spec Number
Discharge Adapter	Cast Iron	ASTM A48 Class 30
Top Bowl	Cast Iron	ASTM A48 Class 30
Intermediate Bowl	Cast Iron	ASTM A48 Class 30
Bearings, Top and Suction Case	Rubber	Neoprene
Impeller	Stainless Steel	ASTM A743 UNS C30400
Pump Shaft	Stainless Steel	ASTM AISI 416
Impeller Collets	Steel	AISI 1226
Suction Bracket	Cast Iron	ASTM A48 Class 30
Bowl Bearing	Rubber	Neoprene
Strainer	Stainless Steel	AISI 302 UNS S30200
Cable Guard	Stainless Steel	AISI 302 UNS S30200
Shaft Coupling	Stainless Steel	AISI 416 UNS S41600

Note: Efficiency based on average staging



BERKELEY® 6T-275

Submersible Turbine

Nominal RPM: 3450
Based on Fresh Water @ 68 F.
Maximum Working Pressure: 580 PSI

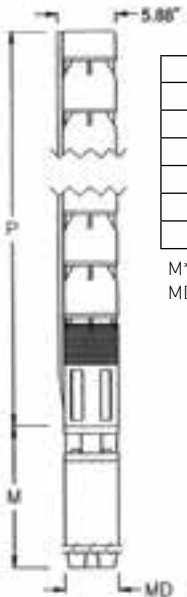
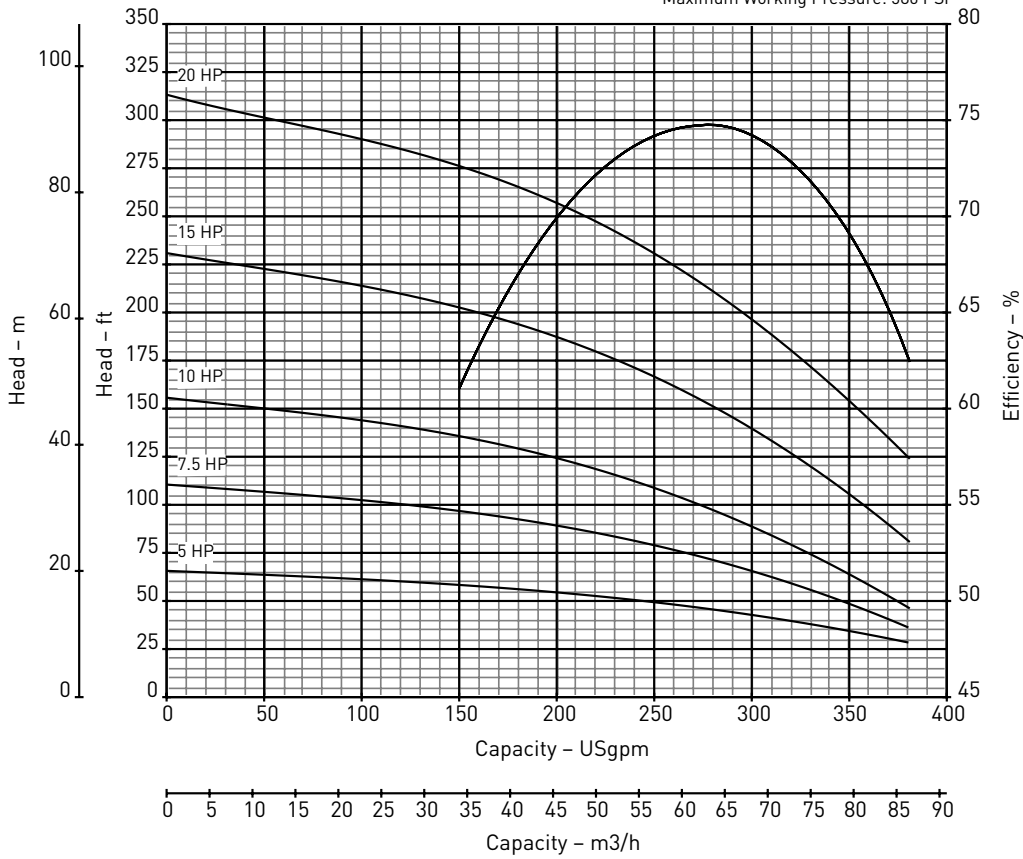

Outline Dimensions / Weights

HP	Stages	Motor Size	P Length	M* Length	MD* Diameter	Motor Weight	Pump Weight
5	1	6"	18.98	27.00	5.51	95	56
7.5	2	6"	23.98	27.60	5.51	114	75
10	3	6"	28.98	29.80	5.51	127	95
15	4	6"	33.98	30.40	5.51	130	114
20	5	6"	38.98	35.50	5.51	160	133

Note: Dimensions=Inches; Weight=U.S. Lbs.

M*-Maximum Length (Pentair Motor)
MD*-Motor Diameter (Pentair Motor)

Specifications

Minimum Well I.D.	6.0 Inches
Minimum Submergence @ BEP (above inlet)	10.0 Feet
Capacity Range	125 - 380 GPM
Discharge	4" F NPT

See manufacturer's data for motor cooling requirements

BERKELEY® 6T-275

Submersible Turbine

Nominal RPM: 3450
Based on Fresh Water @ 68 F.
Maximum Working Pressure: 580 PSI

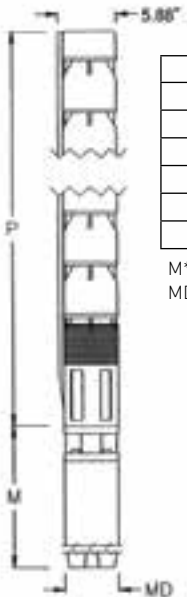
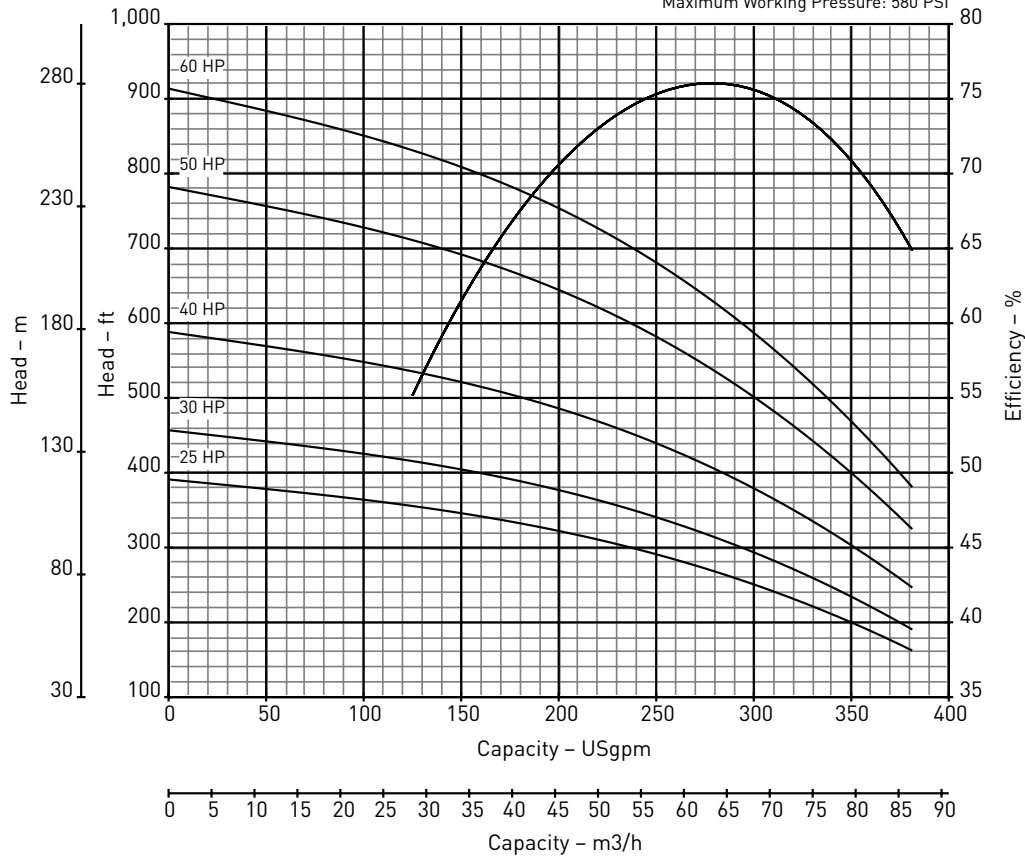

Outline Dimensions / Weights

HP	Stages	Motor Size	P Length	M* Length	MD* Diameter	Motor Weight	Pump Weight
25	6	6"	43.98	47.20	5.51	224	153
30	7	6"	48.98	49.50	5.51	236	172
40	9	6"	58.98	50.30	5.51	239	211
50	12	6"	73.98	52.20	5.51	251	269
60	14	6"	83.98	55.70	5.51	269	308

Note: Dimensions=Inches; Weight=U.S. Lbs.

M*-Maximum Length (Pentair Motor)
MD*-Motor Diameter (Pentair Motor)

Specifications

Minimum Well I.D.	6.0 Inches
Minimum Submergence @ BEP (above inlet)	10.0 Feet
Capacity Range	125 - 380 GPM
Discharge	4" F NPT

See manufacturer's data for motor cooling requirements

BERKELEY® 6T-275

Submersible Turbine - Single Stage Performance

Nominal RPM: 3450
Based on Fresh Water @ 68 F.
Maximum Working Pressure: 580 PSI

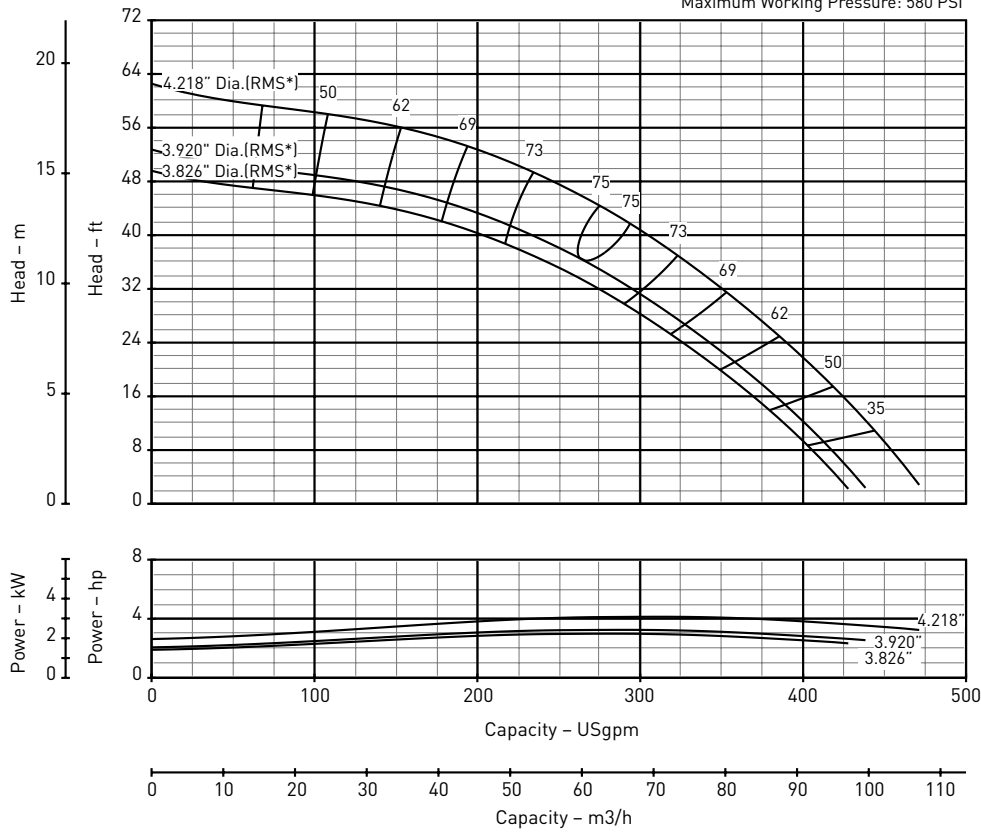

Impeller Dimensions

RMS* Diameter	A Diameter	B Diameter	C Angle
4.218	4.530	3.880	32
3.920	4.250	3.560	32
3.826	4.160	3.460	32

*Root-Mean-Square

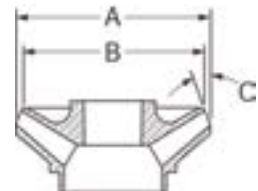

Materials of Construction

Part Name	Common Material Name	Material Spec Number
Discharge Adapter	Cast Iron	ASTM A48 Class 30
Top Bowl	Cast Iron	ASTM A48 Class 30
Intermediate Bowl	Cast Iron	ASTM A48 Class 30
Bearings, Top and Suction Case	Rubber	Neoprene
Impeller	Stainless Steel	ASTM A743 UNS C30400
Pump Shaft	Stainless Steel	ASTM AISI 416
Impeller Collets	Steel	AISI 1226
Suction Bracket	Cast Iron	ASTM A48 Class 30
Bowl Bearing	Rubber	Neoprene
Strainer	Stainless Steel	AISI 302 UNS S30200
Cable Guard	Stainless Steel	AISI 302 UNS S30200
Shaft Coupling	Stainless Steel	AISI 416 UNS S41600

Note: Efficiency based on average staging



BERKELEY® 6T-325

Submersible Turbine

Nominal RPM: 3450
 Based on Fresh Water @ 68 F.
 Maximum Working Pressure: 420 PSI

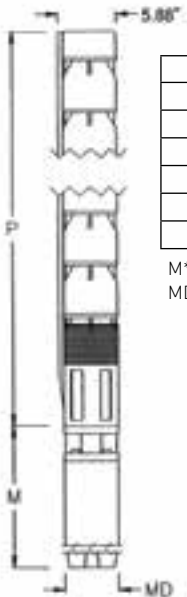
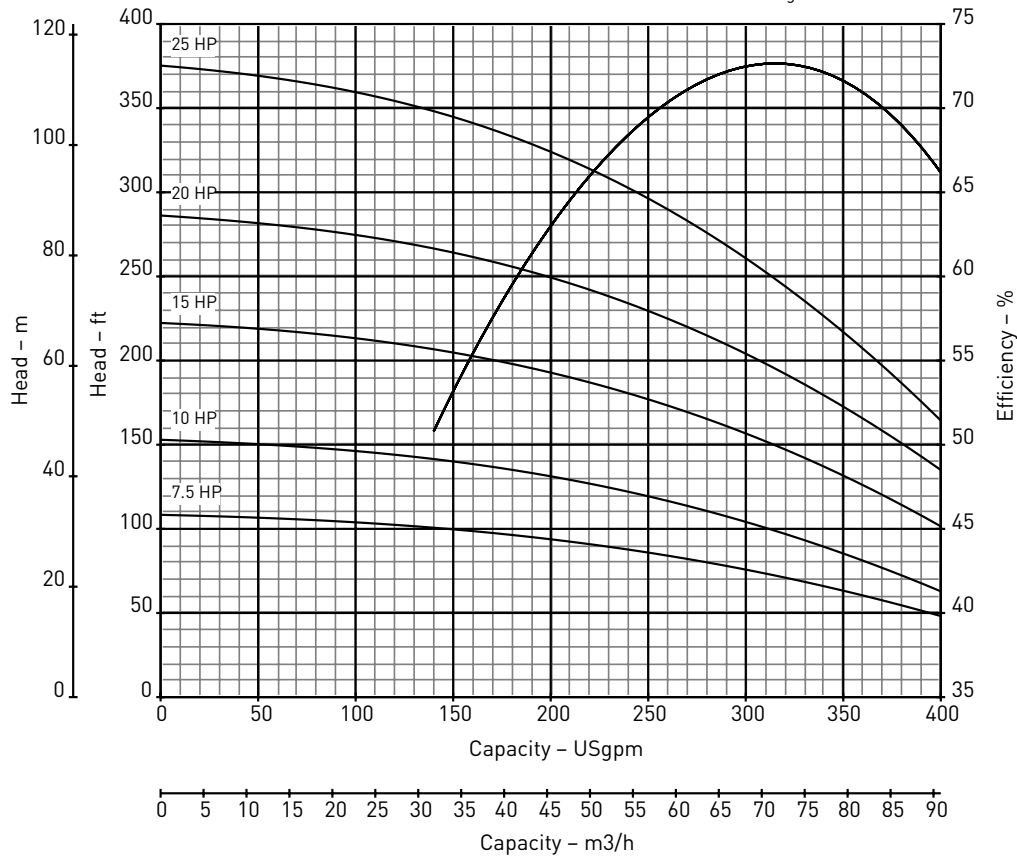

Outline Dimensions / Weights

HP	Stages	Motor Size	P Length	M* Length	MD* Diameter	Motor Weight	Pump Weight
7.5	2	6"	23.73	27.60	5.51	114	63
10	3	6"	28.61	29.80	5.51	127	75
15	4	6"	33.48	30.40	5.51	130	88
20	5	6"	38.25	35.50	5.51	160	100
25	7	6"	48.11	47.20	5.51	224	125

Note: Dimensions=Inches; Weight=U.S. Lbs.

M*-Maximum Length (Pentair Motor)
 MD*-Motor Diameter (Pentair Motor)

Specifications

Minimum Well I.D.	6.0 Inches
Minimum Submergence @ BEP (above inlet)	10.0 Feet
Capacity Range	140 - 400 GPM
Discharge	4" F NPT

See manufacturer's data for motor cooling requirements

BERKELEY® 6T-325

Submersible Turbine

Nominal RPM: 3450
Based on Fresh Water @ 68 F.
Maximum Working Pressure: 420 PSI

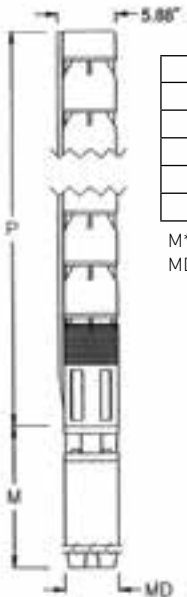
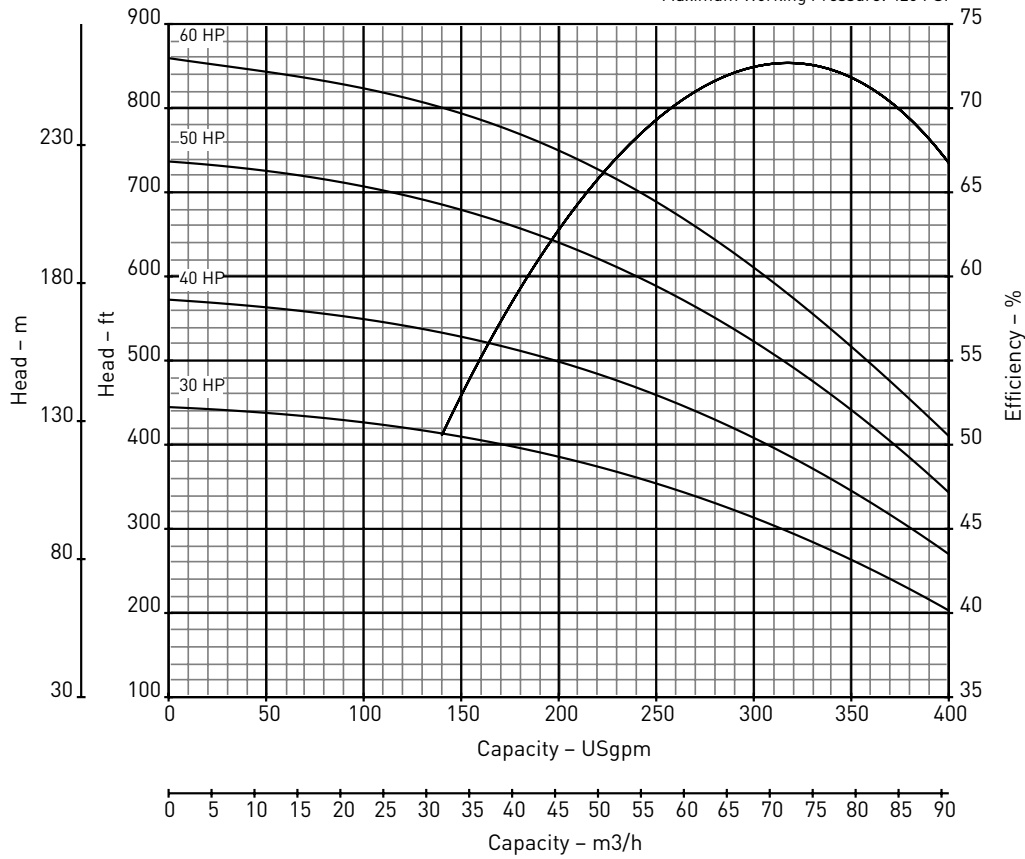

Outline Dimensions / Weights

HP	Stages	Motor Size	P Length	M* Length	MD* Diameter	Motor Weight	Pump Weight
30	8	6"	52.98	49.50	5.51	236	138
40	10	6"	62.73	50.30	5.51	239	163
50	13	6"	77.36	52.20	5.51	251	200
60	15	6"	87.11	55.70	5.51	269	225

Note: Dimensions=Inches; Weight=U.S. Lbs.

M*-Maximum Length (Pentair Motor)
MD*-Motor Diameter (Pentair Motor)

Specifications

Minimum Well I.D.	6.0 Inches
Minimum Submergence @ BEP (above inlet)	10.0 Feet
Capacity Range	140 - 400 GPM
Discharge	4" F NPT

See manufacturer's data for motor cooling requirements

BERKELEY® 6T-325

Submersible Turbine - Single Stage Performance

Nominal RPM: 3450
Based on Fresh Water @ 68 F.
Maximum Working Pressure: 420 PSI

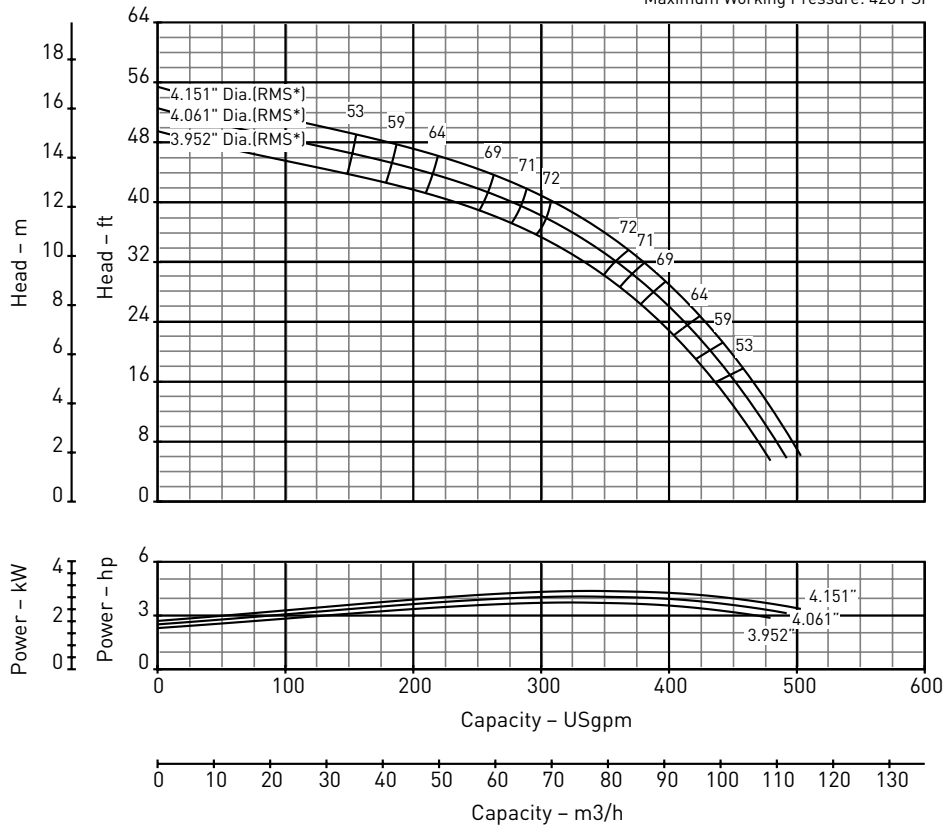

Impeller Dimensions

RMS* Diameter	A Diameter	B Diameter	C Angle
4.151	4.440	3.840	26
4.061	4.350	3.750	26
3.952	4.250	3.630	26

*Root-Mean-Square

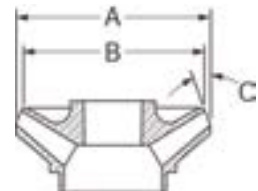

Materials of Construction

Part Name	Common Material Name	Material Spec Number
Discharge Adapter	Cast Iron	ASTM A48 Class 30
Top Bowl	Cast Iron	ASTM A48 Class 30
Intermediate Bowl	Cast Iron	ASTM A48 Class 30
Bearings, Top and Suction Case	Rubber	Neoprene
Impeller	Stainless Steel	ASTM A743 UNS C30400
Pump Shaft	Stainless Steel	ASTM AISI 416
Impeller Collets	Steel	AISI 1226
Suction Bracket	Cast Iron	ASTM A48 Class 30
Bowl Bearing	Rubber	Neoprene
Strainer	Stainless Steel	AISI 302 UNS S30200
Cable Guard	Stainless Steel	AISI 302 UNS S30200
Shaft Coupling	Stainless Steel	AISI 416 UNS S41600

Note: Efficiency based on average staging



BERKELEY® 6T-450

Submersible Turbine

Nominal RPM: 3450
Based on Fresh Water @ 68 F.
Maximum Working Pressure: 420 PSI

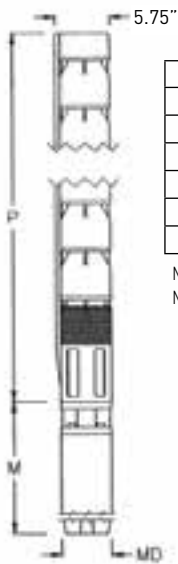
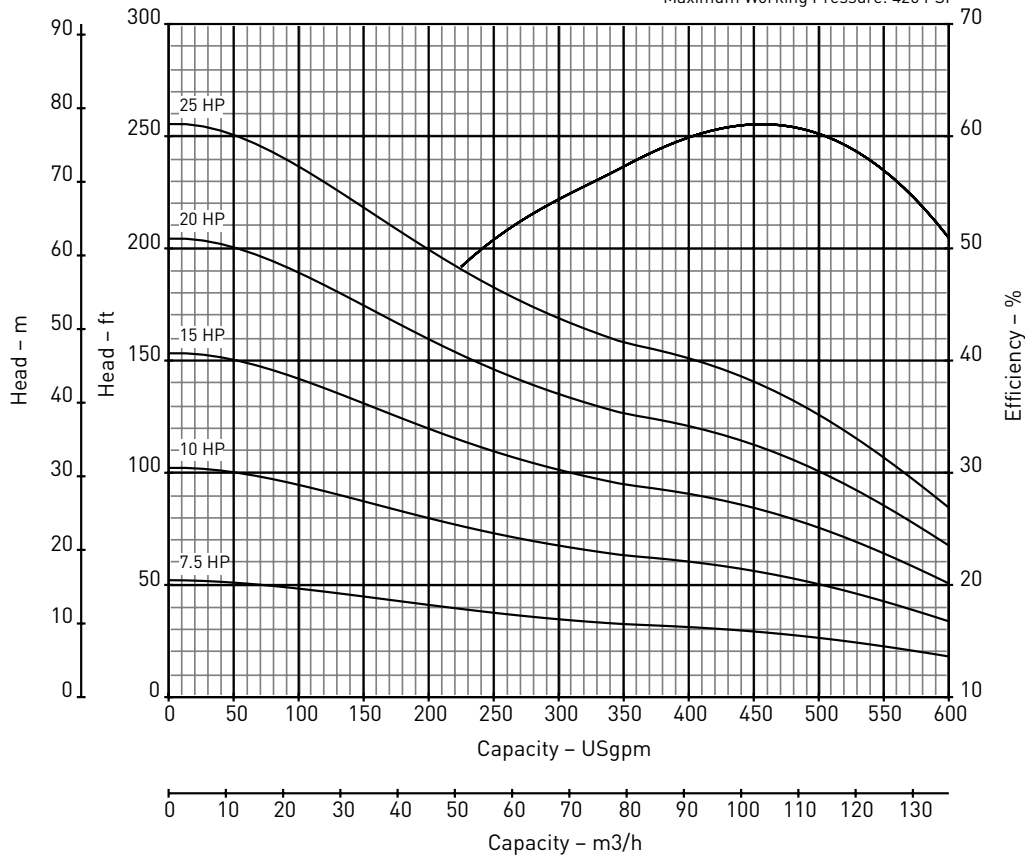

Outline Dimensions / Weights

HP	Stages	Motor Size	P Length	M* Length	MD* Diameter	Motor Weight	Pump Weight
7.5	1	6"	20.11	27.60	5.51	114	63
10	2	6"	26.24	29.80	5.51	127	75
15	3	6"	32.37	30.40	5.51	130	87
20	4	6"	38.50	35.50	5.51	160	99
25	5	6"	44.63	47.20	5.51	224	111

Note: Dimensions=Inches; Weight=U.S. Lbs.

M*-Maximum Length (Pentair Motor)
MD*-Motor Diameter (Pentair Motor)

Specifications

Minimum Well I.D.	6.0 Inches
Minimum Submergence @ BEP (above inlet)	10.0 Feet
Capacity Range	100 - 500 GPM
Discharge	4" F NPT

See manufacturer's data for motor cooling requirements

BERKELEY® 6T-450

Submersible Turbine

Nominal RPM: 3450
Based on Fresh Water @ 68 F.
Maximum Working Pressure: 420 PSI

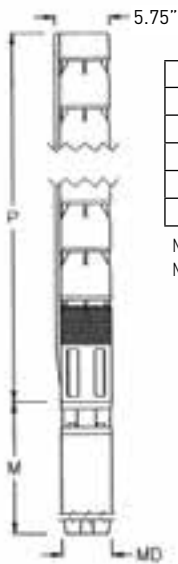
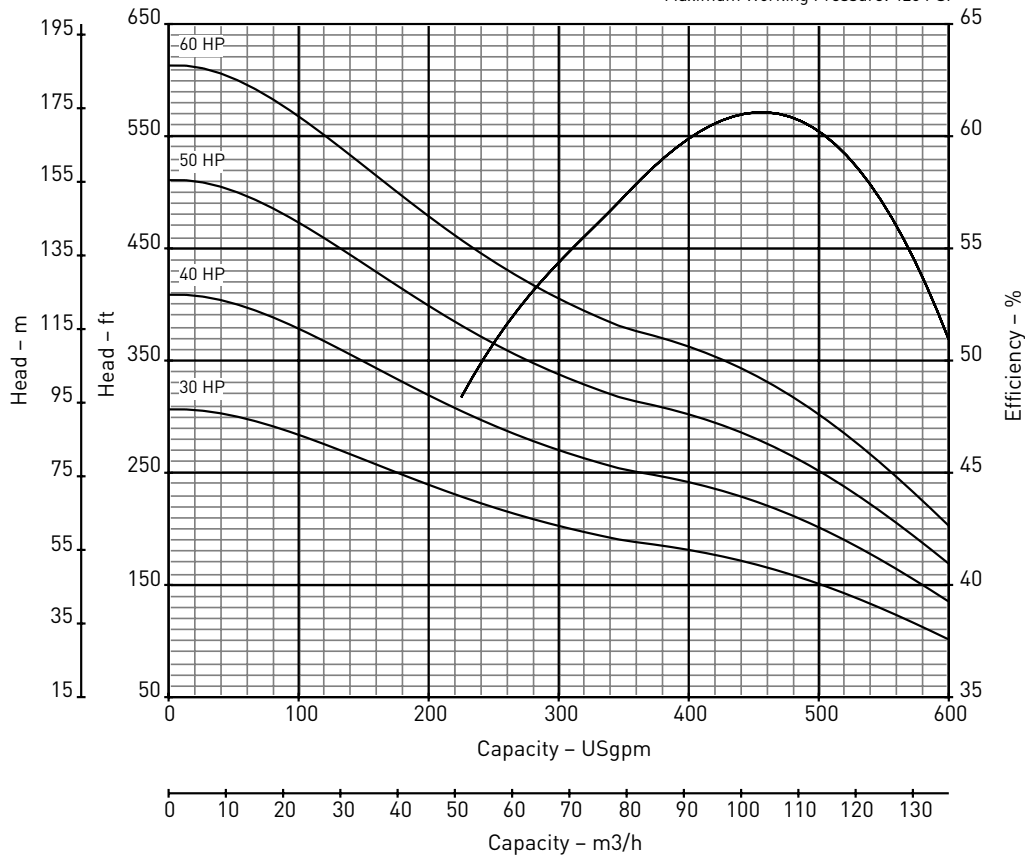

Outline Dimensions / Weights

HP	Stages	Motor Size	P Length	M* Length	MD* Diameter	Motor Weight	Pump Weight
30	6	6"	50.76	49.50	5.51	236	123
40	8	6"	63.02	50.30	5.51	239	147
50	10	6"	75.28	52.20	5.51	251	171
60	12	6"	87.54	55.70	5.51	269	195

Note: Dimensions=Inches; Weight=U.S. Lbs.

M*-Maximum Length (Pentair Motor)
MD*-Motor Diameter (Pentair Motor)

Specifications

Minimum Well I.D.	6.0 Inches
Minimum Submergence @ BEP (above inlet)	10.0 Feet
Capacity Range	100 - 500 GPM
Discharge	4" F NPT

See manufacturer's data for motor cooling requirements

BERKELEY® 6T-450

Submersible Turbine - Single Stage Performance

Nominal RPM: 3450
Based on Fresh Water @ 68 F.
Maximum Working Pressure: 420 PSI

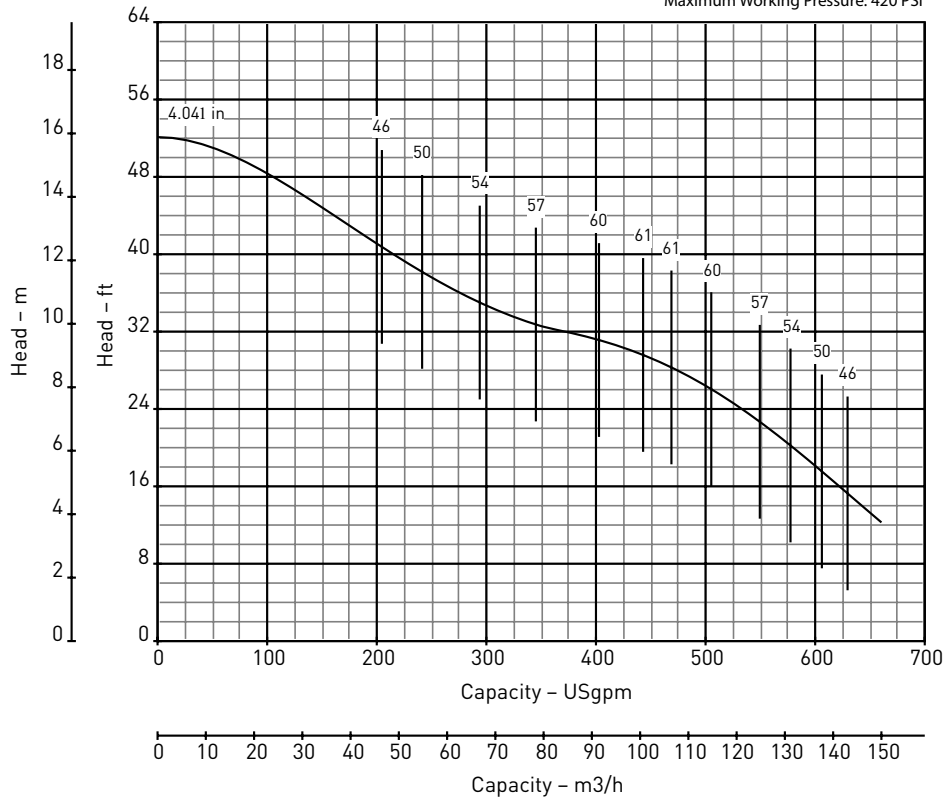

Impeller Dimensions

RMS* Diameter	A Diameter	B Diameter	C Angle
4.041	4.130	3.950	20

*Root-Mean-Square

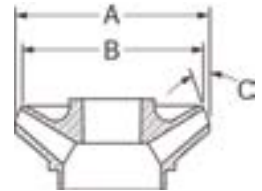

Materials of Construction

Part Name	Common Material Name	Material Spec Number
Discharge Adapter	Cast Iron	ASTM A48 Class 30
Top Bowl	Cast Iron	ASTM A48 Class 30
Intermediate Bowl	Cast Iron	ASTM A48 Class 30
Bearings, Top and Suction Case	Rubber	Neoprene
Impeller	Stainless Steel	ASTM A743 UNS C30400
Pump Shaft	Stainless Steel	ASTM AISI 416
Impeller Collets	Steel	AISI 1226
Suction Bracket	Cast Iron	ASTM A48 Class 30
Bowl Bearing	Rubber	Neoprene
Strainer	Stainless Steel	AISI 302 UNS S30200
Cable Guard	Stainless Steel	AISI 302 UNS S30200
Shaft Coupling	Stainless Steel	AISI 416 UNS S41600

Note: Efficiency based on average staging

