



DMX09



DOMEX

Model: DX
Centrifugal Roof Exhausters
Direct Drive and Belt Drive

MOVING YOUR WAY

› **Domex Direct Drive Series**

Model: DX (V/S/R/Q/Q1/Q2)

- Static pressure up to 1.25 in. wg.
- Flow capacity up to 4,561 CFM
- High wind construction (-HW) option available.



› **Domex Standard Duty Belt Drive Series**

Model: DX (B)

- Static pressure up to 1.5 in. wg.
- Flow capacity up to 19,442 CFM
- High wind construction (-HW) option available.

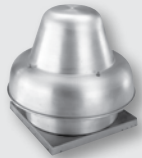

› **Domex High Capacity Belt Drive Series**

Model: KB, JB, MB

- Static pressure up to 1.5 in. wg.
- Flow capacity up to 46,640 CFM

Introduction.....2

Features & Benefits.....3

Options and Accessories.....4

 - High Wind Construction.....5

Motor Availability.....6

Direct Drive Dimensional & Performance Data8

Belt Drive Dimensional & Performance Data.....11

Engineering Specifications26

Limited Warranty28

› **Domex Direct & Belt Drive Fans**

PennBarry certifies that the Domex direct drive and belt drive models shown herein are licensed to bear the AMCA seal. The ratings shown are based on tests and procedures performed in accordance with AMCA publication 211 and AMCA publication 311 and comply with the requirements of the AMCA Certified Ratings Program.



› **Domex High Capacity Belt Drive Fans**

PennBarry certifies that the Domex high capacity models shown on pages 23 - 25 are licensed to bear the AMCA seal. The ratings shown are based on tests and procedures performed in accordance with AMCA publication 211 and comply with the requirements of the AMCA Certified Ratings Program.



› **UL and CSA Certification**

Domex fans carry the UL label, UL 705, (ZACT), File #E28413.



Domex exhausters are also certified by the Canadian Standard Association (File #LR13309).



PennBarry reserves the right to make changes at any time, without notice, to models, construction, specifications, options, availability, etc. This bulletin illustrates the appearance of PennBarry products at the time of publication. To view the latest updates, visit PennBarry at www.pennbarry.com.

Introduction

Domex Centrifugal Fans



Introduction

Centrifugal Fans



Belt Drive Domex



Direct Drive Domex

› Domex Series of Centrifugal Fans

Domex fans are ideal for general purpose exhaust applications including: bathrooms, garages, general kitchen areas, offices, churches, dormitories, factories, large warehouses and other relatively clean air applications.

They feature a weather-resistant, seamless spun aluminum housing which works in conjunction with a patented wheel design and deeply spun inlets to provide smooth quiet air flow through the ventilator. The centrifugal wheels are aluminum, nonoverloading, backward inclined, robotically welded, and dynamically balanced. The optional high wind construction makes Domex fans particularly suited for high wind hurricane zones.

› Domex Direct Drive Series

Model: DX (V/S/R/Q/Q1/Q2)

- Static pressure up to 1.25 in. wg.
- Flow capacity up to 4,561 CFM
- High wind construction (-HW) option available.

› Domex Standard Duty Belt Drive Series

Model: DX (B)

- Static pressure up to 1.5 in. wg.
- Flow capacity up to 19,442 CFM
- High wind construction (-HW) option available.

› Domex High Capacity Belt Drive Series

Model: KB, JB, MB

- Static pressure up to 1.5 in. wg.
- Flow capacity up to 46,640 CFM

D
o
m
e
x

› Motor Selection

Both direct drive and belt drive models are available with a wide range of voltages and enclosures (see Motor Selection for a complete listing). Standard belt drive Open Drip Proof (ODP) ball bearing motors are selected using a conservative portion of the NEMA service factor. Standard direct drive ODP motors have Class B insulation and internal thermal overload protection. Each size is carefully engineered to match the motor to the wheel capacity.

› Internal Wiring

All direct drive models with ODP motors feature a polarized disconnect plug between the motor and junction box. This provides a positive method of electric shut-off. Belt drive units with ODP motors are factory-wired between the motor and junction box. For either direct drive or belt drive models, an electric disconnect is available.

› Sound Performance

Units deliver outstanding air performance with minimal noise.

› Curb Caps (Base)

Curb caps for direct drive and standard duty belt drive models are available in galvanized steel (standard) or aluminum (optional). Curb caps for high capacity belt drive models are available only in aluminum. All curb caps have fully welded corners and are pre-punched to ensure both a leak-tight and easy installation.

› Forced Motor Cooling

Breather slots between the motor dome and discharge apron enable fresh air to be drawn into the motor housing during fan operation. This positive cooling promotes longer life for motor and drive components.

› Easy Maintenance Access

By removing the fasteners, the motor dome lifts off for complete access to all the drive train components.

› Structural Integrity

Durable housings of spun aluminum have a high strength-to-weight ratio and incorporate a rolled bead for additional strength. There are no welds to break or seams to leak. The heavy-gauge motor mounting platform provides positive rigidity between all components of the power train assembly.

› Solid Steel Shafts

Sized so the first critical speed is a minimum of 130% of maximum cataloged operating speed, shafts are precision ground and polished.

› Internal Bracing

Tri-Strut™ supports transfer the weight of the motor mounting platform directly to the curb mounting surface. The aluminum spun housing, therefore, is not used to support any weight.

› Self-Aligning Bearings

Heavy-duty bearings are sized for a minimum L50 life in excess of 200,000 hours of operation. 100% factory tested, they are designed for air handling applications.

› Drives and Belts

Pulleys are pre-set to the specified RPM. Cast iron variable pitch pulleys are adjustable, allowing for field balancing based on actual field conditions. All pulleys are sized for at least 150% of the driven horsepower.

› Vibration Isolators

Multidirectional, rubber-in-shear vibration isolators mitigate residual vibration transmission from the unit to the building.

› Conduit

Both direct and belt drive units include a large 1" nominal conduit chase for easy installation of wiring from the motor dome to below the curb cap.

› Reverse Venturi

Reverse venturi reduces turbulence and improves distribution of the air as it enters the wheel inlet and is "captured" by the blades.



› Aluminum Wheels

Domex fans offer patented wheel designs. Carefully matched highly-tooled venturis enhance the performance of these backward inclined and non-overloading centrifugal wheels. Made of advanced alloys, the various wheel components provide superior strength and durability.

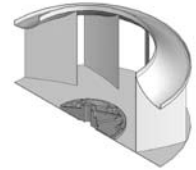

› Silent Wheel (Direct Drive)

- Blades' highly curved leading edge provide unsurpassed low sound numbers with excellent air performance.
- Backplate and inlet are stamped for consistency, plus dynamic balancing assure smooth, vibration-free operation.
- Riveted and/or welded construction ensure superior dependability over other wheel designs.

› Standard Duty, All Welded Wheel

(Standard Duty and High Pressure Belt Drive)

- Blades are curved for improved air performance while increasing their strength and rigidity.
- Backplate and inlet are stamped for consistency. They include a perimeter rim which enhances strength and improves balancing.
- Wheel assembly is robotically welded to provide extremely durable and consistent performance.
- Wheel is dynamically balanced. Balancing weights are mechanically attached to the inside of the rims of both the backplate and wheel inlet. This allows a precise placement of the weights anywhere within a full 360° range on two separate planes, without the possibility of detachment.

Introduction

Domex Centrifugal Fans



Centrifugal Fans

Options & Accessories

› Finishes

Coatings such as Polyester Powder Coat, Epoxy Powder Coat, Phenolic Epoxy Powder Coat, and others are available. See the coatings brochure for details.

› Mounting Pedestal

The 12" high mounting pedestal, available in aluminum or galvanized steel, incorporates a removable access panel for easy inspection and service of motor operated backdraft dampers. It provides solid ventilator support and a weather resistant seal that does not injure or disturb flashing. This item should not be used with Fatrap units.

› Hinged Sub-Base

Hinged sub-bases provide access to the curb well for damper service or clean out for grease applications. Constructed with a rust proof hinge arrangement and low height (3 1/2") the assembly is easily manipulated and reduces the impact on overall installation height. This accessory is available for use with most all models for either factory built or existing roof curbs.

› Floating Hinge Kit

A floating hinge kit is also available for field installation. This assembly connects the exhauster directly to the roof curb and provides the same level of access as the hinged sub-base.

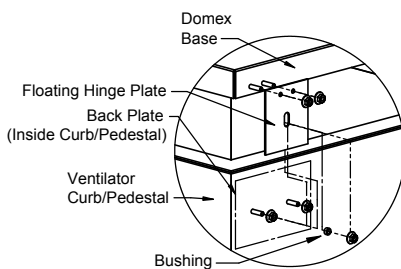

› Aluminum Bird and Insect Screen

Bird screens are available for all direct and belt drive models. An aluminum insect screen with a smaller mesh than the standard bird screen is also available. However, please note that NFPA 96 installations do not allow the use of bird or insect screens. The requirements of local codes must be reviewed to determine if there are any conflicts.

› Backdraft Dampers

Backdraft dampers are available for either gravity or motorized operation (motor kit optional). Dampers feature square galvanized steel frame, multi-leaf, roll formed aluminum blades with nylon bearings. Backdraft dampers should not be used when venting kitchen hoods. NFPA 96 installations do not allow the use of dampers. The requirements of local codes must be reviewed to determine if there are any conflicts.

› Safety Disconnect Switch

Safety disconnect switches are available to allow positive electrical shut-off and safety. NEMA 1 switches are factory mounted when factory wiring is requested, others will be shipped loose. Wiring is only run from the motor to the junction box. (Factory wiring of explosion proof applications is not available.) A wide range of NEMA rated enclosures with disconnect switches are available for indoor, outdoor, and explosion proof installations. Disconnects are to be field wired by a licensed electrician.



› Firestat Switch

Firestat switch automatically disconnects the unit when the temperature of the air being exhausted exceeds a preset rating.



› Time-Delay Switch

(Selected direct drive models only) The Air minder Model AM12 switch is a UL recognized and CSA certified time-delay relay that operates both the fan and room light to ventilate an area even after the occupants depart. In the "On" position, the Air minder turns the light and fan on immediately. In the "Off" position, the light goes off immediately and the fan is in operation for a period of time as preset from 1 to 60 minutes. Suitable only for 1/3 HP maximum at 120/1/60.



› Speed Controllers

The Lektrol™ controller allows adjustment in speed to a maximum of 50% reduction, which results in a very cost effective means for system balancing. The device can be located under the fan dome to prevent unauthorized tampering or on the wall for ease of operation by the building occupants. (Available on direct drive units with ODP motors and some select TE motors. See reference table under Motor Availability)



› Automatic Belt Tensioner

The factory mounted Automatic Belt Tensioner accessory eliminates the need for re-tensioning the belt after start-up. It is constructed from 10 gage galvanized steel and incorporates five torsion springs to automatically position the motor and maintain proper belt tension. Additional benefits include reduced belt and pulley wear and simplified belt replacement without tools. The Automatic Belt Tensioner is available for Domex models DX11B, DX12B, and DX14B with 1/4, 1/2, 3/4 and 1 HP ODP motors. It can also be used with 1.5 HP, 3-phase ODP motors.



› Internal Wiring

NEMA 3R wiring is available for both direct and belt drive models.

› Spark Resistant Construction

AMCA 'B' construction is available as standard construction on direct drive units and as an option on belt drive units. If required, an explosion proof motor and disconnect may be selected as options.

› Prefabricated Curb

A variety of sizes of prefabricated roof curbs are available. Galvanized steel unibeam curbs are the most popular. For a complete listing of all curb types and sizes available, please consult the latest PennBarry Curb brochure.

Domex

› High Wind Construction

High wind construction Domex fans are specifically designed for high wind hurricane zones (HWHZ). The Domex models are designed to withstand 150 MPH winds in accordance with Miami-Dade and Florida Building Code standards. The units are 3rd party tested and certified through a 3rd party Professional Engineer (P.E.) to meet these strict standards. Installation details are provided and since there are no tie downs or external braces required for attaching the unit to the roof or curb this makes installation simple and easy. A wide range is offered to meet all of your ventilation needs which includes all belt and direct drive sizes 36 and under.

Product Certifications:

- Miami-Dade NOA # 08-1202.13
- Florida Product Approval #12339
- Texas Department of Insurance # pending

› Domex Exploded View

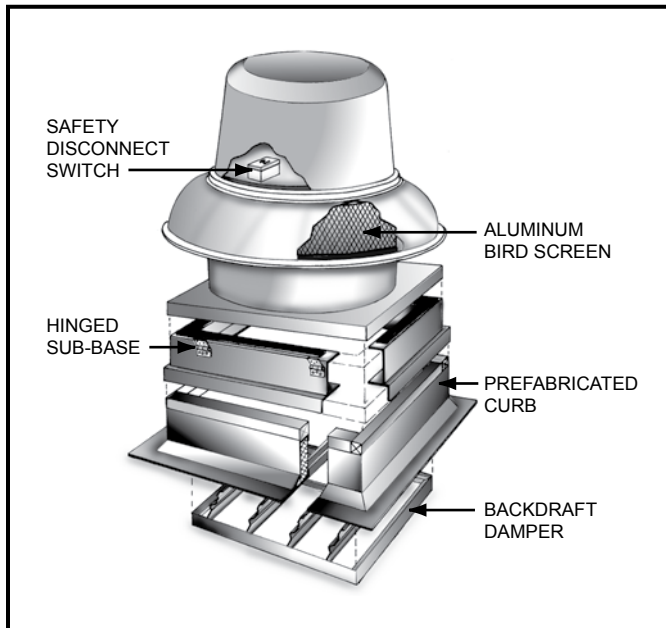

› Domex Curb Dimensional Drawings

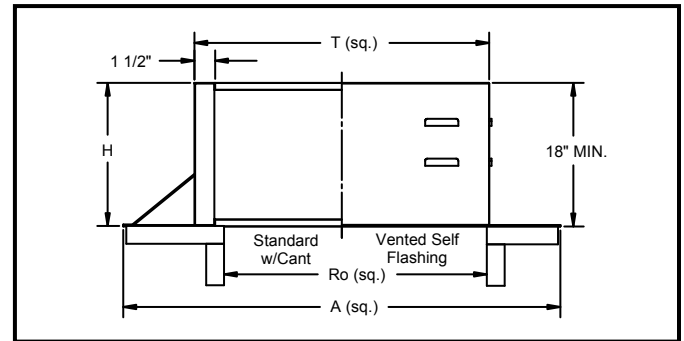

› Domex Dimensional References

Model	E ⁽⁴⁾ SQ	T ⁽²⁾ SQ	A SQ	Ro ⁽³⁾ SQ	Damper Size SQ	Galv. Steel Gauge
DX06R	18.5	17	25	9	8.75	18
DX08S/R	18.5	17	25	9	8.75	18
DX10S/R	18.5	17	25	11.5	11.25	18
DX11V/S/R/Q	18.5	17	25	11.5	11.25	18
DX13V/S/R/Q	18.5	17	25	11.5	11.25	18
DX16V/S/R/Q1/Q2	20.5	19	27	16	15.75	18
DX18V	28.5	27	35	20	19.75	18
DX06B/DX08B	18.5	17	25	11.5	11.25	18
DX11B	20.5	19	27	16	15.75	18
DX12B/DX14B	24.75	23.25	31.25	16	15.75	18
DX16B/DX18B	28.5	27	35	20	19.75	18
DX24B	33.5	32	40	25	24.75	18
DX27B/DX30B	36.5	35	43	28	27.75	18
DX36B	44.5	43	51	36	35.5	18
KB420	52.5	51	59	44	43.5	18
JB48	59	57.5	65.5	50	49.5	18
MB542	63.5	62	70	55	54.5	18

(1) Standard heights "H" are 8", 12", and 18" including wood nailer. (2) "T" dimension of curb is 1 1/2" less than the dimension of inside base of fan ("E"). (3) "Ro" refers to Roof Opening. (4) "E" dimension is inside base of fan.

Introduction

Domex Centrifugal Fans



Centrifugal Fans

Motor Availability

› NEMA Motor

This chart summarizes the largest allowable NEMA frame sizes for motors used on belt drive models.

› Largest Available NEMA Frame Size per Model

Model	Max. Frame Size
DX06B	42*
DX08B	42*
DX11B	56
DX12B	56
DX14B	56
DX16B	145T
DX18B	145T
DX24B	184T
DX27B/DX30B	184T
DX36B	213T
KB420	213T
JB48	215T
MB542	254T

! *Only available as 1/4 ODP, 115V. At PennBarry's option, large frame motors may be removed after testing and shipped separately. Contact the factory for special application motor availability.

› Fixed Speed Motor Control

Two-speed motors, used in conjunction with external switches or sensors (gas concentration, odor, temperature), are used to quickly adjust the airflow through the ventilator by changing from one fixed speed to another. Normally, 2-speed motors operate at 1800 and 1200 RPM (2-speed, 2-windings). However, 1800/900 RPM (2-speed, 1 winding) motors are available for 3-phase power only. A single operating voltage must be specified because dual-voltage versions are not available in a 2-speed motor.

› Variable Speed Motor Control

PennBarry offers Lek-Trol™ solid state controllers to reduce the high speed of most direct drive motors by as much as 50%. If variable speed is required, check the Lek-Trol™ availability table below to verify that controllers exist for the fan model selected. Remember, Lek-Trol™ controllers are currently only available for direct drive motors including all standard Open Drip Proof (ODP) 60 Hz motors. Not all totally enclosed motors are currently available with variable speed control. Inverter rated motors suitable for use with variable frequency drives can be supplied for belt drive models. Contact your local PennBarry representative for availability.

› Available Lek-Trol™ Speed Controls

Model	60 Hz					50 Hz		
	ODP 115V	Totally Enclosed			Totally Enclosed			
	115V	200V	208V	230V	110V	220V	240V	
DX06R	LT25	-	-	-	-	-	-	
DX08S	-	-	-	-	-	-	-	
DX08R	LT25	-	-	-	-	-	-	
DX10S	-	-	-	-	-	-	-	
DX10R	LT30	LT30	LT35	LT35	LT30	LT35	LT35	
DX11V	-	-	-	-	-	-	-	
DX11S	-	-	-	-	-	-	-	
DX11R	LT30	-	-	-	-	-	-	
DX11Q	LT50	-	-	-	-	-	-	
DX13V	LT55	-	-	-	-	-	-	
DX13S	LT30	-	-	-	-	-	-	
DX13R	LT30	LT30	LT35	LT35	LT50	LT35	LT35	
DX13Q	LT45	LT50	LT35	LT35	LT50	LT35	LT35	
DX16V	LT55	-	-	-	-	-	-	
DX16S	LT50	-	-	-	-	-	-	
DX16R	LT50	-	-	-	-	-	-	
DX16Q1	LT40	-	-	-	-	-	-	
DX16Q2	LT75	-	-	-	-	-	-	
DX18V	LT60	-	-	-	-	-	-	

Lek-Trols™ indicated for multi-speed models (eg., FX16V/S/R) are applicable only for the high speed. Do not use on low or medium speed for multi-speed models. Items noted with (-) are not applicable.

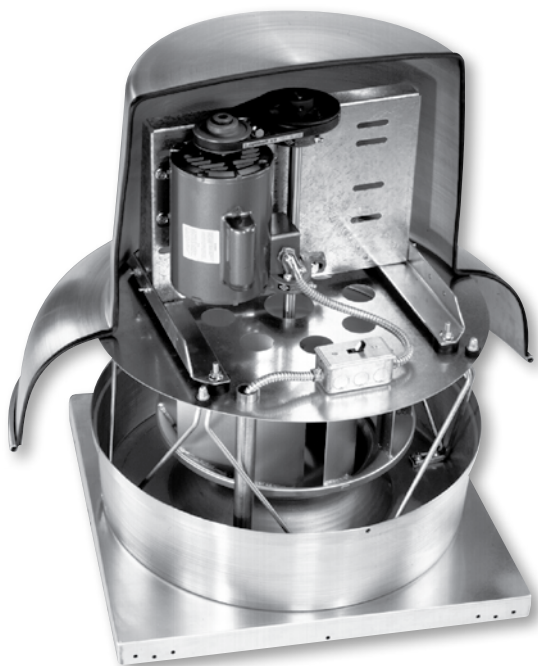

Belt Drive
Domex Cutaway



Direct Drive
Domex Cutaway

D
o
m
e
x

©PENNBARRY 2009

› Belt Drive Motor Availability

The chart below lists horsepower, voltages, and enclosure types. After selecting a model and horsepower that meets performance requirements, an engineer should verify that the desired voltage and enclosure are the same (or smaller) as the maximum NEMA motor frame shown for each model (see NEMA Motor Frame Size chart).

Model	1 Phase					200V, 230V, 460V OR 575V 3 Phase				
	ODP		Totally Enclosed	Explosion Proof	2 Speed 2 Winding	ODP	Totally Enclosed	Explosion Proof	2 Speed 2 Winding	2 Speed 2 Winding
	115V	230V	115V/230V							
1/4	48	48	48	48/56	48	48	48	48	56	-
1/3	48/56	48/56	56	56	56	56	56	56	56	-
1/2	48/56	48/56	56	56	56	56	56	56	143T	56
3/4	56	56	56	56	56	56	56	56	143T	56
1	56	56	56	56	56	56	56	56	143T	145T
1 1/2	56	56	145T	184T	-	56	56	56	145T	182T
2	145T	145T	182T	182T	-	56/145T	145T	145T	145T	182T
3	184T	184T	184T	215T	-	145T	182T	182T	184T	184T
5	-	-	-	-	-	184T	184T	184T	184T	215T
7 1/2	-	-	-	-	-	213T	213T	213T	-	215T
10	-	-	-	-	-	215T	215T	215T	-	256T
15	-	-	-	-	-	254T	254T	254T	-	284T

On horsepower less than 1 1/2, motor frame sizes may change due to variations in voltage, special features and motor manufacturer. Motors shown are ball bearing, continuous duty and 1750 RPM or 1750/1140 RPM for two speed - two winding motors.

› Direct Drive Motor Availability

The following chart lists the various motor options available for each of the direct drive fan models. Once a fan model is selected, this chart can be used to determine if a suitable motor is available. (If not, another selection may have to be made from the fan performance charts). Look under the nominal RPM heading to determine which fans have 2-speed and 3-speed motors.

Model	Nominal RPM				1 Phase							
	1050 V	1300 S	1550 R	1725 Q	115 Volts			200 - 240 Volts				
					Open Drip Proof	Totally Enclosed	Explosion Proof	Open Drip Proof	Totally Enclosed	50 hz	50 C Ambient	Explosion Proof (4)
DX06R	-	-	x	-	yes	-	-	Use TE Motors	-	-	-	-
DX08S/R	-	x	x	-	yes	yes (1)	-		yes (1)	yes (1)	yes (1)	-
DX10S/R	-	x	x	-	yes	yes (1)	-		yes (1)	yes (1)	yes (1)	-
DX11V/S/R	x	x	x	-	yes	yes (1)	-		yes (1)	yes (1)	yes (1)	-
DX11Q	-	-	-	x	yes	yes	yes		yes	yes	yes	yes (5)
DX13V/S/R	x	x	x	-	yes	yes (1)	-		yes (1)	yes (1)	yes (1)	-
DX13Q	-	-	-	x	yes	yes	yes		yes	yes	yes	yes (5)
DX16V/S/R	x	x	x	-	yes	yes (1)	-		yes (1)	yes (1)	yes (1)	-
DX16Q1	-	-	-	x (3)	yes	-	-		-	-	-	-
DX16Q2	-	-	-	x	yes	yes	yes		yes	yes	yes	yes (5)
DX18V	x	-	-	-	yes	-	-	-	-	-	-	

Model	Nominal RPM				3 Phase				
	1050 V	1300 S	1550 R	1725 Q	200 - 460 Volts (2)				
					Open Drip Proof	Totally Enclosed	50 hz	50 C Ambient	Explosion Proof (4)
DX06R	-	-	x	-	Use TE Motors	-	-	-	-
DX08S/R	-	x	x	-		-	-	-	-
DX10S/R	-	x	x	-		-	-	-	-
DX11V/S/R	x	x	x	-		-	-	-	-
DX11Q	-	-	-	x		-	-	-	yes (6)
DX13V/S/R	x	x	x	-		-	-	-	-
DX13Q	-	-	-	x		yes	yes	yes	yes (6)
DX16V/S/R	x	x	x	-		-	-	-	-
DX16Q1	-	-	-	x (3)		-	-	-	-
DX16Q2	-	-	-	x		yes	yes	yes	yes (6)
DX18V	x	-	-	-	-	-	-	-	

(1) High speed only.; (2) 200 - 240, 380, 415, 460 V; (3) Nominal 1650 RPM; (4) Cls.I, Grp.D, Div. I / Cls. II, Grp.F & G, Div.I., Not available with 50 Hz.; (5) 230 V only. Not available in 200 or 208 V; (6) 230 V and 460 V only.

Dimensional Information & Performance Data

Domex Centrifugal Fans | Direct Drive



Centrifugal Fans

DX06, DX08, DX10, & DX11

> Performance Data Overview

Domex direct drive models (except size 06) are available with single and multi-speed motors. Multi-speed motors are designated V (1050 RPM), S (1300 RPM), and R (1550 RPM). DX06R and DX18V are exceptions being single speed motors. Q, Q1, Q2 (1725/1760 RPM) are single speed motors. A single Domex fan may be suitable for several requirements by a simple wiring change. This feature provides flexibility for a variety of reasons, including energy savings, off-hours requirements, future expansion, or unexpected field variations. Domex direct drive models are available in seven sizes (6, 8, 10, 11, 13, 16 and 18). Capacities range from below 150 CFM to above 4500 CFM, with static pressures beyond 1 1/4".

By using Lek-Trol™ variable speed controllers, the high speed flow rate of most models can be reduced by as much as 50%. Do not use Lek-Trol™ on medium or low speed for multispeed models, unless a specific Lek-trol™ is shown to be available (see Lek-Trol™ Speed Controller Availability). When compared to belt drive models, Domex direct drive fans require less maintenance, have a simpler construction, cost less, and are lighter in weight. Performances in 50 Hz applications will be less than shown below; consult with local PennBarry representative.

> DX06 - DX11 Direct Drive Fan Dimensional Data

Model	Material Gages			Dimensions				Est. Ship Wt.
	Alum. Base	Galv. Base	Apron	L (Dia.)	H	E*	Ro	
DX06R	0.050"	16 ga.	0.050"	18 7/8"	12 3/4"	18 1/2" x 18 1/2"	9 x 9	22 lbs
DX08S/R	0.050"	16 ga.	0.050"	20 3/8"	13 3/8"	18 1/2" x 18 1/2"	9 x 9	26 lbs
DX10S/R	0.050"	16 ga.	0.050"	20 3/8"	13 3/8"	18 1/2" x 18 1/2"	11 1/2" x 11 1/2"	29 lbs
DX11V/S/R & Q	0.050"	16 ga.	0.050"	20 3/8"	13 3/8"	18 1/2" x 18 1/2"	11 1/2" x 11 1/2"	38 lbs
DX11Q	0.050"	16 ga.	0.050"	20 3/8"	13 3/8"	18 1/2" x 18 1/2"	11 1/2" x 11 1/2"	40 lbs

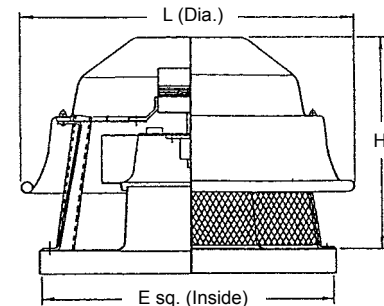

All dimensions are in inches.

*Outside dimension of curb should be 1 1/2" less than "E" dimension.

> DX06 - DX11 Direct Drive Fan Performance Data

Model	Nominal			Tip Speed FPM	0.000" SP		0.125" SP		0.250" SP		0.375" SP		0.500" SP		0.625" SP		0.750" SP		0.875" SP		1.250" SP		1.250" SP		
	HP	Max Watts	RPM		CFM	Sones	CFM	Sones	CFM	Sones	CFM	Sones	CFM	Sones	CFM	Sones	CFM	Sones	CFM	Sones	CFM	Sones	CFM	Sones	CFM
DX06R	1/100	52	1550	2841	146	4.3	100	3.6	69	3.4	-	-	-	-	-	-	-	-	-	-	-	-	-	-	-
DX08S	1/50	44	1300	3361	237	1.5	161	2.2	114	3	69	3.8	-	-	-	-	-	-	-	-	-	-	-	-	-
DX08R	1/30	55	1550	4007	290	2.4	223	2.8	171	3.5	129	4.1	84	4.9	-	-	-	-	-	-	-	-	-	-	-
DX10S	1/25	82	1300	3361	385	3.9	316	3.5	257	4.8	207	5.1	168	5.2	129	5.6	82	6.1	-	-	-	-	-	-	-
DX10R	1/12	121	1550	4007	559	6.1	501	5.9	446	6.1	394	6.5	338	6.8	267	7	187	7.2	100	7.4	-	-	-	-	-
DX11V	1/25	111	1050	3058	388	1.8	223	2.2	148	3.1	112	3.7	80	4.5	49	5.3	-	-	-	-	-	-	-	-	-
DX11S	1/11	142	1300	3786	503	3.4	397	3.6	320	4.3	262	5	201	5.5	149	6	104	6.5	-	-	-	-	-	-	-
DX11R	1/7	201	1550	4514	736	6.7	659	6.4	577	6.6	502	6.9	432	7.6	356	7.9	274	7.9	188	7.9	100	7.9	100	7.9	7.9
DX11Q	1/5	268	1725	5024	997	10.2	921	9.7	850	9.5	768	9.5	685	9.4	598	9.2	511	9	409	8.7	294	8.6	294	8.6	8.6

Performance shown is for installation Type A: Free Inlet, Free Outlet. Speed (RPM) shown is nominal. Performance is based on actual speed of test. The sound ratings shown are for loudness values in fan sonas at 5'0" (1.5m) in a hemispherical free field per AMCA Standard 301. Values shown are for Installation Type A: Free Inlet Fan Sone Levels. Performance ratings do not include the effects of appurtenances in the air stream.

Domex fans are only one component of a total system. As such, fan performance is directly affected by the system. It is critical that system designers determine the actual system loss to ensure that the actual flow is specified in the system design.

D
o
m
e
x

©PENNBARRY 2009

DX13 Direct Drive Fan Dimensional Data

Model	Material Gages			Dimensions				Est. Ship Wt.
	Alum. Base	Galv. Base	Apron	L (Dia.)	H	E*	Ro	
DX13V/S/R & Q	0.050"	16 ga.	0.050"	21 7/16	14 3/4	18 1/2 x 18 1/2	11 1/2 x 11 1/2	36 lbs
DX13Q	0.064"	16 ga.	0.050"	21 7/16	14 3/4	18 1/2 x 18 1/2	11 1/2 x 11 1/2	43 lbs

All dimensions are in inches.

*Outside dimension of curb should be 1 1/2" less than "E" dimension.

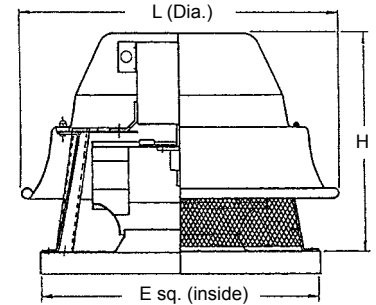

Centrifugal Fans

DX13 Direct Drive Fan Performance Data

Model	Nominal			Tip Speed FPM	0.000" SP		0.125" SP		0.250" SP		0.375" SP		0.500" SP		0.625" SP		0.750" SP		0.875" SP		1.250" SP		1.250" SP			
	HP	Max Watts	RPM		CFM	Sones	CFM	Sones	CFM	Sones	CFM	Sones	CFM	Sones	CFM	Sones	CFM	Sones	CFM	Sones	CFM	Sones	CFM	Sones	CFM	Sones
DX13V	1/20	92	1050	3221	661	4.4	479	3.1	341	2.8	262	3.6	207	4.3	161	5.1	115	5.9	79	6.6	44	7.4	-	-	-	-
DX13S	1/12	120	1300	3988	869	8	749	6.4	632	5.3	510	5.4	418	6	349	6.4	290	6.7	226	7	158	7.4	-	-	-	-
DX13R	1/6	201	1550	4755	1054	10.5	988	9.9	917	9.2	839	8.9	736	8.5	651	8.2	579	7.9	510	7.9	428	8	191	8.5	-	-
DX13Q	1/4	314	1725	5292	1280	16	1226	15.3	1170	14.6	1112	14	1053	13.4	995	13	936	12.5	868	12	796	11.5	630	11	-	-

Performance shown is for installation Type A: Free Inlet, Free Outlet. Speed (RPM) shown is nominal. Performance is based on actual speed of test. The sound ratings shown are for loudness values in fan sones at 5'0" (1.5m) in a hemispherical free field per AMCA Standard 301. Values shown are for Installation Type A: Free Inlet Fan Sone Levels. Performance ratings do not include the effects of appurtenances in the air stream.

Domex fans are only one component of a total system. As such, fan performance is directly affected by the system. It is critical that system designers determine the actual system loss to ensure that the actual flow is specified in the system design.

DX16 - DX18 Direct Drive Fan Dimensional Data

Model	Material Gages			Dimensions				Est. Ship Wt.
	Alum. Base	Galv. Base	Apron	L (Dia.)	H	E*	Ro	
DX16V/S/R, Q1 & Q2	0.064"	16 ga.	0.064"	28 1/2	22 1/2	20 1/2 x 20 1/2	16 x 16	56 lbs
DX18V	0.080"	14 ga.	0.064"	39	31	28 1/2	20	78 lbs

All dimensions are in inches.

*Outside dimension of curb should be 1 1/2" less than "E" dimension.

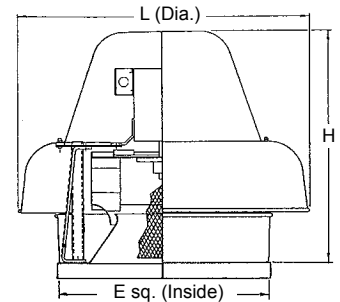

DX16 - DX18 Direct Drive Fan Performance Data

Model	Nominal			Tip Speed FPM	0.000" SP		0.125" SP		0.250" SP		0.375" SP		0.500" SP		0.625" SP		0.750" SP		0.875" SP		1.250" SP		1.250" SP			
	HP	Max Watts	RPM		CFM	Sones	CFM	Sones	CFM	Sones	CFM	Sones	CFM	Sones	CFM	Sones	CFM	Sones	CFM	Sones	CFM	Sones	CFM	Sones	CFM	Sones
DX16V	1/6	453	1050	3788	1738	9.9	1489	8	1256	6.6	1032	6.1	884	6.6	772	7.1	682	7.9	598	9.9	529	10.1	392	10.2	-	-
DX16S	1/3	510	1300	4690	2021	12	1822	10.6	1637	9.5	1428	8.7	1256	8.4	1094	8.5	943	9.3	850	10.2	775	11	606	12.3	-	-
DX16R	1/2	574	1550	5592	2346	13.8	2176	12.8	2014	12	1853	11.3	1685	10.7	1532	10.4	1384	10.1	1247	10	1115	10.4	881	12.4	-	-
DX16Q1	1/2	688	1650	5953	2701	16.9	2576	16.4	2465	15.9	2352	15.5	2228	15	2096	14.4	1966	14	1839	13.6	1700	13.5	1401	13.5	-	-
DX16Q2	3/4	866	1725	6223	3016	17.7	2921	17.1	2829	16.7	2747	16.3	2665	15.9	2575	15.5	2484	15	2371	14.6	2256	14.2	2005	13.3	-	-
DX18V	3/4	964	1075	6029	4561	21	4395	19.8	4230	19.1	4053	18.5	3865	17.9	3671	16.9	3454	16.4	3237	16.4	2995	16.4	2405	16.4	-	-

Performance shown is for installation Type A: Free Inlet, Free Outlet. Speed (RPM) shown is nominal. Performance is based on actual speed of test. The sound ratings shown are for loudness values in fan sones at 5'0" (1.5m) in a hemispherical free field per AMCA Standard 301. Values shown are for Installation Type A: Free Inlet Fan Sone Levels. Performance ratings do not include the effects of appurtenances in the air stream.

Domex fans are only one component of a total system. As such, fan performance is directly affected by the system. It is critical that system designers determine the actual system loss to ensure that the actual flow is specified in the system design.

Performance Data

Domex Centrifugal Fans | Direct Drive



Centrifugal Fans

Direct Drive Performance Data

> Fan Curves

The fan curves illustrated here show the range of capacities available for direct drive units. Each graph shows the performance of several models at one particular nominal speed. Fan curves provide a quick method for selecting a fan unit based on design point requirements.

The direct drive performance chart on the previous page provides the tabular data (CFM and static pressure) used to plot the fan curves. In addition, the horsepower, tip speed and sones are tabulated. Since sound is normally an important factor in the selection of a fan, an engineer will usually want to select the "slowest" unit which meets CFM and SP requirements.

Please refer to the Motor Selection section to make sure the motor you select meets your electrical requirements.

> Nominal 1075 RPM

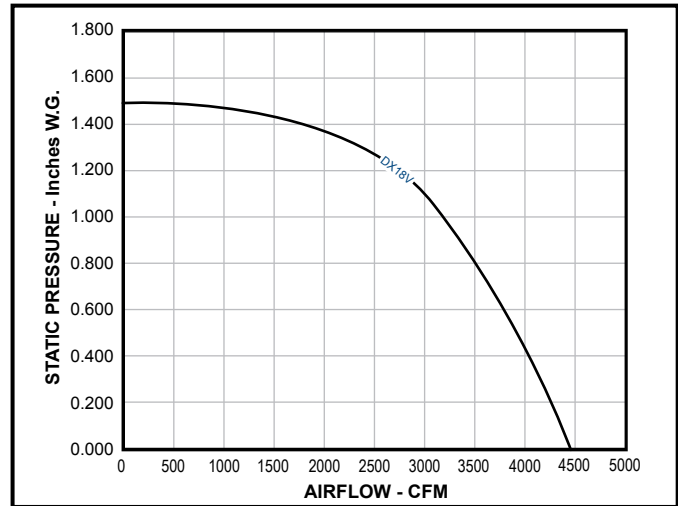

> Nominal 1050 RPM

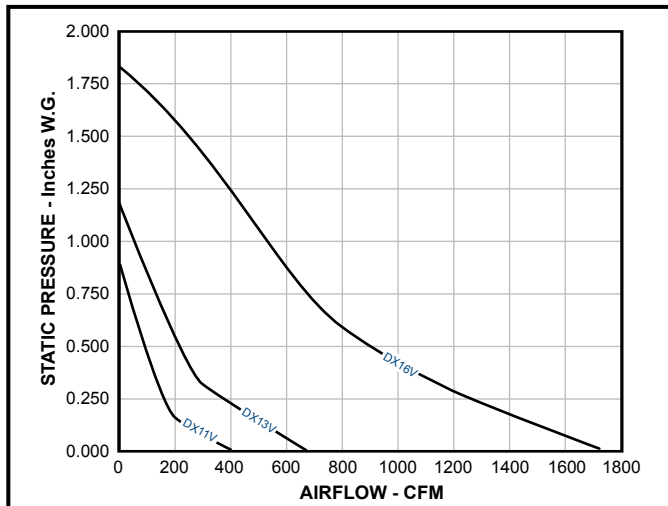

> Nominal 1550 RPM

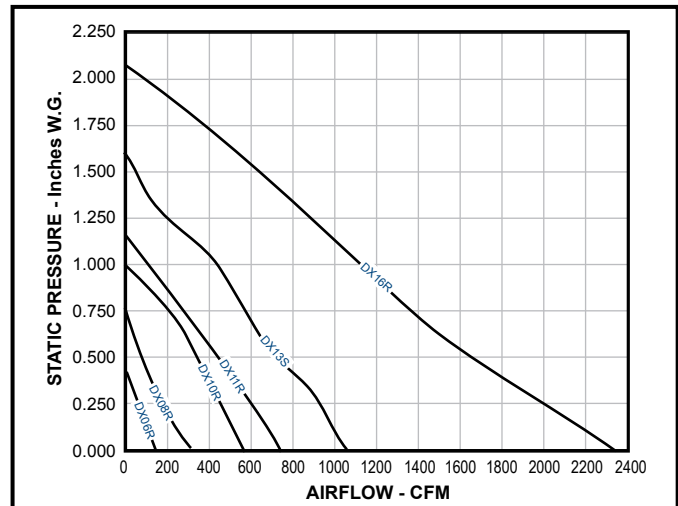

> Nominal 1300 RPM

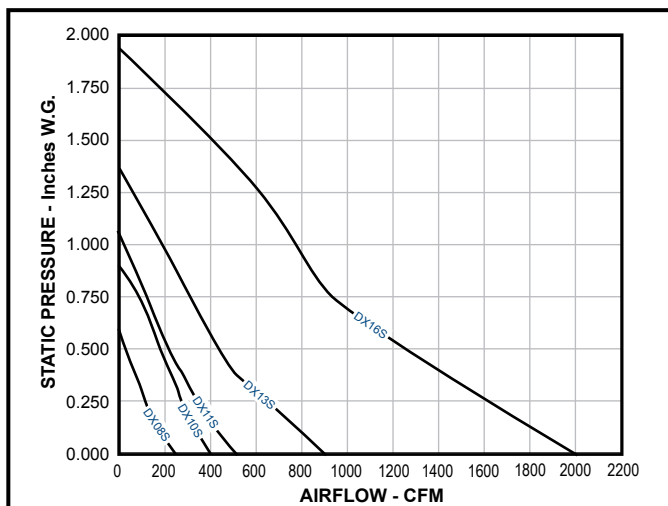

> Nominal 1725 RPM

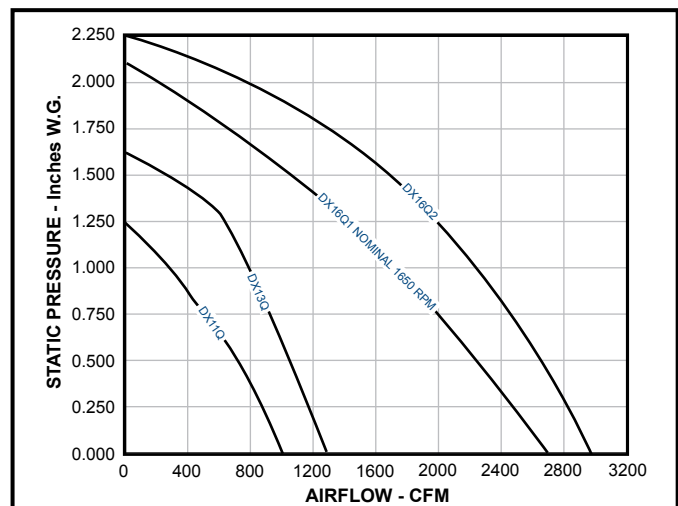

Domex fans are only one component of a total system. As such, fan performance is directly affected by the system. It is critical that system designers determine the actual system loss to ensure that the actual flow is specified in the system design.

©PENN BARRY 2009

› Performance Data

The belt drive models shown on the following pages have sizes and capacities ranging from below 300 CFM to above 46,000 CFM, with static pressures from 0" to above 1 ½". All models are available with a wide range of horsepower sizes and RPM's. Two-speed motors are commonly used to enhance this flexibility.

The data provided for each belt drive model includes:

- Elevation Drawing Showing Overall Dimensions
- Fan Curve Graph
- Performance Chart

Each curve graphically displays the range of capacities available for each model, in most cases beyond the specifics shown in the tabular data. The maximum performance afforded by each horsepower is indicated by dashed lines and the RPM is indicated by solid lines.

Some models have graphs that show both shaded and unshaded areas. Selection should be made from the unshaded area only. Shaded areas reflect unstable performance ("surge"), a characteristic typical of backward inclined wheels, and should be avoided. These unstable regions are not shown in the tabular data.

The highest RPM shown for a specific horsepower in the tabular data is the maximum speed that for any point along the performance curve, the BHP will not exceed the available horsepower.

It is important to note that while it is common industry-wide practice to exceed a "nominal" horsepower by using a motor's service factor, PennBarry uses a conservative portion of the service factor, allowing half to remain a true "safety" factor.

Use the Motor Availability chart (see Motor Selection) to select motor enclosures and voltages which can be installed in the fans.

Note: Domex fans are only one component of a total system. As such, performance is directly affected by the system. It is critical that system designers determine actual system losses to ensure that the actual flow is specified in the system range.

› Belt Drive Losses

The AMCA Review Committee has developed the chart shown below for the purpose of estimating belt drive losses. To calculate total BHP (including drive losses): Find the BHP of your operating point on the x-axis on the graph below. Follow the vertical line to the curves indicating the range of drive losses. Look at the y-axis on the left and find the drive loss percentage. Calculate the total BHP by adding the drive loss to the operating point BHP. For BHP's below 0.3, use 30%.

› Drive Loss Reference Chart

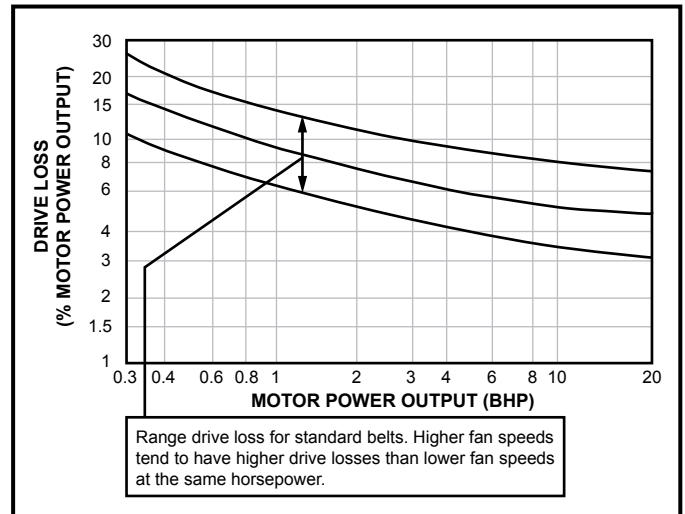

! For totally enclosed, explosion proof, multi-speed and all 1.0 Service Factor motors, fan BHP plus drive losses should not exceed motor rated HP.

Graph reprinted from AMCA publication 203, with the express written permission from the Air Movement and Control Association, Inc., 30 West University Drive, Arlington Heights, IL 60004-1983.

Dimensional Information & Performance Data

Domex Centrifugal Fans | Belt Drive



DX06B

DX06B Belt Drive Fan Curves

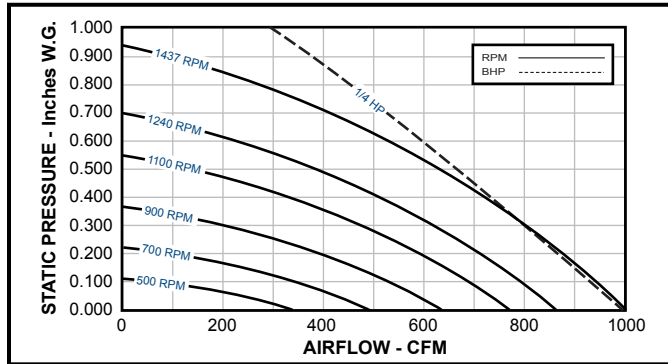

DX06B Belt Drive Fan Dimensional Data

Galv. Steel Base = 16 Gage
Aluminum Base = 0.064"
Discharge Apron = 0.050"
Roof/Wall Opening = 11 1/2" SQ.
Damper Size = 11 1/2" SQ.
Max. Motor Frame Size = 42
Peak BHP = (RPM/2232) ³
Max. RPM = 1437 (1/4 HP)
Est. Ship Weight = 35 lbs.

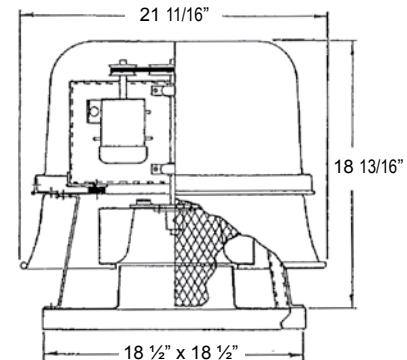

DX06B Belt Drive Fan Performance Data

HP	RPM	Tip Speed FPM	0.000" SP		0.125" SP		0.250" SP		0.375" SP		0.500" SP		0.625" SP	
			Sones	BHP	Sones	BHP	Sones	BHP	Sones	BHP	Sones	BHP	Sones	BHP
1/4	375	1092	264	-	-	-	-	-	-	-	-	-	-	-
			1.6	0.01	-	-	-	-	-	-	-	-	-	-
	430	1252	302	-	-	-	-	-	-	-	-	-	-	-
			1.8	0.01	-	-	-	-	-	-	-	-	-	-
	475	1383	334	-	-	-	-	-	-	-	-	-	-	-
			2.1	0.01	-	-	-	-	-	-	-	-	-	-
	520	1515	366	-	-	-	-	-	-	-	-	-	-	-
			2.2	0.01	-	-	-	-	-	-	-	-	-	-
	565	1646	397	-	-	-	-	-	-	-	-	-	-	-
			2.4	0.02	-	-	-	-	-	-	-	-	-	-
	610	1777	429	-	179	-	-	-	-	-	-	-	-	-
			2.9	0.02	2.5	0.02	-	-	-	-	-	-	-	-
	655	1908	461	-	244	-	-	-	-	-	-	-	-	-
			3.1	0.02	2.6	0.02	-	-	-	-	-	-	-	-
	700	2039	492	-	298	-	-	-	-	-	-	-	-	-
			3.4	0.03	2.9	0.03	-	-	-	-	-	-	-	-
	745	2170	524	-	347	-	-	-	-	-	-	-	-	-
			3.7	0.04	3.2	0.03	-	-	-	-	-	-	-	-
	790	2301	556	-	394	-	114	-	-	-	-	-	-	-
			4.0	0.04	3.5	0.04	3.1	0.04	-	-	-	-	-	-
835	2432	587	-	438	-	209	-	-	-	-	-	-	-	
		4.4	0.05	3.8	0.05	3.5	0.04	-	-	-	-	-	-	
880	2563	619	-	480	-	279	-	-	-	-	-	-	-	
		4.8	0.06	4.3	0.06	3.7	0.05	-	-	-	-	-	-	
925	2694	651	-	519	-	344	-	-	-	-	-	-	-	
		5.2	0.07	4.7	0.07	4.1	0.06	-	-	-	-	-	-	
970	2825	683	-	558	-	398	-	146	-	-	-	-	-	
		5.9	0.08	5.3	0.08	4.6	0.07	4.4	0.05	-	-	-	-	
1015	2956	714	-	597	-	450	-	243	-	-	-	-	-	
		6.4	0.09	5.8	0.09	5.2	0.08	4.8	0.07	-	-	-	-	
1060	3087	746	-	635	-	498	-	315	-	-	-	-	-	
		6.5	0.11	6.0	0.10	5.3	0.10	4.9	0.08	-	-	-	-	
1105	3218	778	-	674	-	544	-	382	-	131	-	-	-	
		6.8	0.12	6.3	0.12	5.7	0.11	5.1	0.10	4.9	0.07	-	-	
1150	3349	809	-	712	-	590	-	442	-	241	-	-	-	
		7.2	0.13	6.7	0.13	6.1	0.13	5.5	0.12	5.1	0.10	-	-	
1195	3480	841	-	749	-	634	-	496	-	318	-	-	-	
		7.7	0.15	7.2	0.15	6.5	0.14	5.9	0.13	5.4	0.12	-	-	
1240	3612	873	-	783	-	675	-	547	-	389	-	158	-	
		8.2	0.17	7.6	0.17	6.9	0.16	6.4	0.15	5.8	0.14	5.3	0.11	
1280	3728	901	-	814	-	710	-	590	-	447	-	256	-	
		8.4	0.19	7.9	0.18	7.3	0.18	6.7	0.17	6.3	0.16	5.9	0.13	
1320	3845	929	-	845	-	745	-	633	-	501	-	330	-	
		8.8	0.20	8.2	0.20	7.6	0.20	7.1	0.19	6.7	0.18	6.4	0.15	
1350	3932	950	-	868	-	771	-	664	-	537	-	378	-	
		9.1	0.22	8.5	0.22	8.0	0.21	7.4	0.20	7.0	0.19	6.8	0.17	
1390	4048	978	-	898	-	805	-	704	-	585	-	440	-	
		9.5	0.24	9.1	0.24	8.4	0.23	7.9	0.22	7.5	0.21	7.3	0.19	
1420	4136	999	-	921	-	830	-	734	-	619	-	484	-	
		9.9	0.25	9.4	0.25	8.8	0.25	8.3	0.24	7.8	0.23	7.8	0.21	
1437	4185	1011	-	933	-	845	-	750	-	638	-	509	-	
		10.1	0.26	9.5	0.26	9.1	0.25	8.5	0.25	8.0	0.24	7.9	0.22	

Performance shown is for installation type A: Free Inlet, Free Outlet. Power rating (BHP) does not include drive losses. For further information on estimating belt drive losses and motor service factors see page 11. The sound ratings shown are for loudness values in fan sones at 5'0" (1.5m) in a hemispherical free field per AMCA Standard 301. Values shown are for installation Type A: free inlet sone levels. Performance ratings do not include the effects of appurtenances in the airstream.

©PENN BARRY 2009

› DX08B Belt Drive Fan Curves

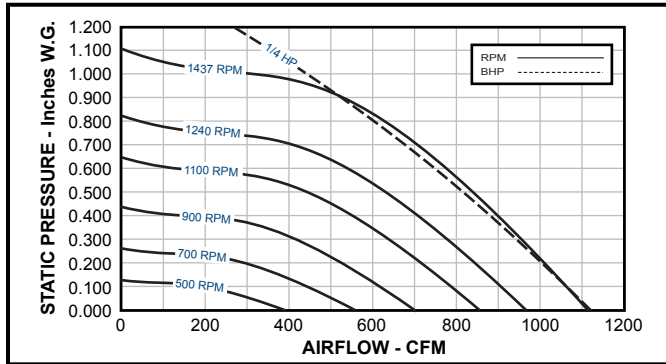

› DX08B Belt Drive Fan Dimensional Data

Galv. Steel Base = 16 Gage
Aluminum Base = 0.064"
Discharge Apron = 0.050"
Roof/Wall Opening = 11 1/2" SQ.
Damper Size = 11 1/2" SQ.
Max. Motor Frame Size = 42
Peak BHP = (RPM/2232) ³
Max. RPM = 1437 (1/4 HP)
Est. Ship Weight = 35 lbs.

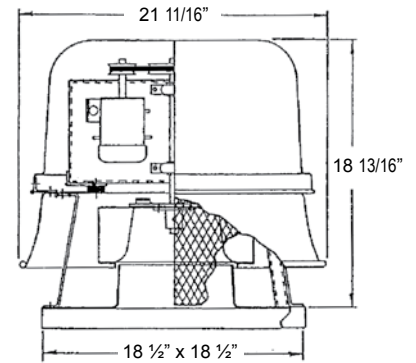

Centrifugal Fans

› DX08B Belt Drive Fan Performance Data

HP	RPM	Tip Speed FPM	0.000" SP		0.125" SP		0.250" SP		1.375" SP		0.500" SP		0.625" SP		0.750" SP	
			Sones	BHP	Sones	BHP	Sones	BHP	Sones	BHP	Sones	BHP	Sones	BHP	Sones	BHP
1/4	375	1150	289	-	-	-	-	-	-	-	-	-	-	-	-	-
			1.4	0.01	-	-	-	-	-	-	-	-	-	-	-	-
	430	1319	331	-	-	-	-	-	-	-	-	-	-	-	-	-
			1.7	0.01	-	-	-	-	-	-	-	-	-	-	-	-
	475	1457	366	-	-	-	-	-	-	-	-	-	-	-	-	-
			2.0	0.01	-	-	-	-	-	-	-	-	-	-	-	-
	520	1595	401	155	-	-	-	-	-	-	-	-	-	-	-	-
			2.2	0.01	1.7	0.01	-	-	-	-	-	-	-	-	-	-
	565	1733	435	242	-	-	-	-	-	-	-	-	-	-	-	-
			2.5	0.02	1.9	0.02	-	-	-	-	-	-	-	-	-	-
	610	1871	470	301	-	-	-	-	-	-	-	-	-	-	-	-
			3.1	0.02	2.4	0.02	-	-	-	-	-	-	-	-	-	-
	655	2009	505	351	-	-	-	-	-	-	-	-	-	-	-	-
			3.4	0.02	2.7	0.02	-	-	-	-	-	-	-	-	-	-
	700	2147	540	399	-	-	-	-	-	-	-	-	-	-	-	-
			3.8	0.03	3.1	0.03	-	-	-	-	-	-	-	-	-	-
	745	2285	574	444	247	-	-	-	-	-	-	-	-	-	-	-
			4.3	0.03	3.5	0.04	3.0	0.03	-	-	-	-	-	-	-	-
	790	2424	609	487	330	-	-	-	-	-	-	-	-	-	-	-
			4.6	0.04	3.9	0.04	3.3	0.04	-	-	-	-	-	-	-	-
	835	2562	644	530	393	-	-	-	-	-	-	-	-	-	-	-
			5.0	0.05	4.2	0.05	3.6	0.05	-	-	-	-	-	-	-	-
	880	2700	678	571	446	207	-	-	-	-	-	-	-	-	-	-
			5.5	0.06	4.7	0.06	4.0	0.06	3.6	0.05	-	-	-	-	-	-
	925	2838	713	611	496	329	-	-	-	-	-	-	-	-	-	-
			6.0	0.07	5.2	0.07	4.5	0.07	4.0	0.07	-	-	-	-	-	-
	970	2976	748	651	543	408	-	-	-	-	-	-	-	-	-	-
			6.7	0.08	5.9	0.08	5.2	0.08	4.5	0.08	-	-	-	-	-	-
1015	3114	783	691	590	471	236	-	-	-	-	-	-	-	-	-	
		7.2	0.09	6.5	0.09	5.8	0.09	5.1	0.09	4.8	0.08	-	-	-	-	-
1060	3252	817	730	635	526	364	-	-	-	-	-	-	-	-	-	
		7.5	0.10	6.8	0.10	6.2	0.11	5.6	0.11	5.2	0.10	-	-	-	-	-
1105	3390	852	769	678	577	449	-	-	-	-	-	-	-	-	-	
		8.0	0.11	7.2	0.12	6.6	0.12	6.0	0.12	5.5	0.12	-	-	-	-	-
1150	3258	887	808	720	626	514	309	-	-	-	-	-	-	-	-	
		8.8	0.13	7.9	0.13	7.3	0.13	6.7	0.13	6.2	0.13	5.8	0.12	-	-	-
1195	3666	921	846	762	673	426	-	-	-	-	-	-	-	-	-	
		9.8	0.14	8.8	0.15	8.1	0.15	7.6	0.15	7.1	0.15	6.7	0.14	-	-	-
1240	3804	956	885	803	719	509	279	-	-	-	-	-	-	-	-	
		10.4	0.16	9.4	0.16	8.6	0.17	8.1	0.17	7.7	0.17	7.4	0.16	6.8	0.14	-
1280	3927	687	918	840	760	670	398	-	-	-	-	-	-	-	-	
		10.5	0.17	9.6	0.18	8.9	0.18	8.3	0.19	7.9	0.19	7.6	0.18	7.3	0.17	-
1320	4049	1018	952	875	798	714	488	-	-	-	-	-	-	-	-	
		10.8	0.19	10.0	0.20	9.3	0.20	8.7	0.20	8.3	0.20	8.0	0.20	7.9	0.19	-
1350	4141	1041	977	902	827	746	544	-	-	-	-	-	-	-	-	
		11.1	0.21	10.4	0.21	9.7	0.21	9.0	0.22	8.7	0.22	8.5	0.22	8.3	0.21	-
1390	4264	1072	1010	937	865	787	603	-	-	-	-	-	-	-	-	
		11.7	0.22	11.1	0.23	10.3	0.23	9.7	0.23	9.1	0.24	9.1	0.24	9.0	0.23	-
1420	4356	1095	1035	964	893	818	645	-	-	-	-	-	-	-	-	
		12.3	0.24	11.6	0.24	10.9	0.25	10.3	0.25	9.6	0.25	9.6	0.25	9.6	0.25	-
1437	4408	1108	1049	979	909	836	669	-	-	-	-	-	-	-	-	
		12.5	0.25	11.8	0.25	11.1	0.26	10.5	0.26	9.9	0.26	9.8	0.26	9.8	0.26	-

Performance shown is for installation type A: Free Inlet, Free Outlet. Power rating (BHP) does not include drive losses. For further information on estimating belt drive losses and motor service factors see page 11. The sound ratings shown are for loudness values in fan sones at 50' (1.5m) in a hemispherical free field per AMCA Standard 301. Values shown are for installation Type A: free inlet sone levels. Performance ratings do not include the effects of appurtenances in the airstream.

Domex

Dimensional Information & Performance Data

Domex Centrifugal Fans | Belt Drive



DX11B

Centrifugal Fans

DX11B Belt Drive Fan Curves

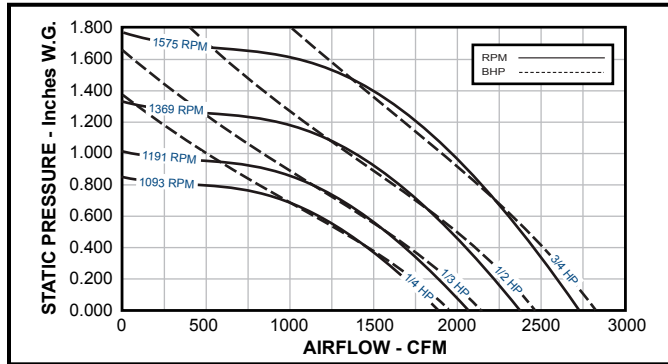

DX11B Belt Drive Fan Dimensional Data

Galv. Steel Base = 16 Gage
Aluminum Base = 0.064"
Discharge Apron = 0.050"
Roof/Wall Opening = 16" SQ.
Damper Size = 15 1/4" SQ.
Max. Motor Frame Size = 56
Peak BHP = (RPM/1700) ³
Max. RPM = 1810 (3/4 HP)
Est. Ship Weight = 55 lbs.

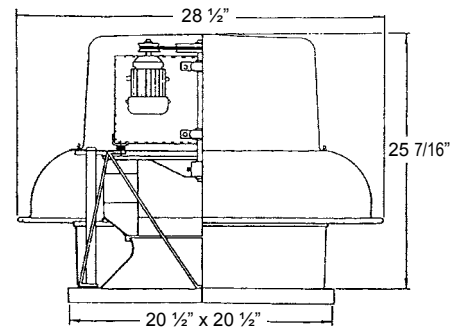

DX11B Belt Drive Fan Performance Data

HP	RPM	Tip Speed FPM	0.000" SP		0.125" SP		0.250" SP		0.375" SP		0.500" SP		0.625" SP		0.750" SP		0.875" SP		1.000" SP		1.125" SP	
			Sones	BHP	Sones	BHP	Sones	BHP	Sones	BHP	Sones	BHP	Sones	BHP	Sones	BHP	Sones	BHP	Sones	BHP	Sones	BHP
1/4	650	2345	1120	905	535	-	-	-	-	-	-	-	-	-	-	-	-	-	-	-	-	-
			4.7	0.05	4.1	0.05	3.4	0.05	-	-	-	-	-	-	-	-	-	-	-	-	-	-
	675	2435	1164	959	638	-	-	-	-	-	-	-	-	-	-	-	-	-	-	-	-	-
			4.9	0.05	4.3	0.06	3.6	0.06	-	-	-	-	-	-	-	-	-	-	-	-	-	-
	700	2526	1207	1011	737	-	-	-	-	-	-	-	-	-	-	-	-	-	-	-	-	-
			5.1	0.06	4.6	0.07	3.9	0.07	-	-	-	-	-	-	-	-	-	-	-	-	-	-
	725	2616	1250	1062	813	-	-	-	-	-	-	-	-	-	-	-	-	-	-	-	-	-
			5.5	0.07	4.9	0.07	4.3	0.08	-	-	-	-	-	-	-	-	-	-	-	-	-	-
	750	2706	1293	1113	880	252	-	-	-	-	-	-	-	-	-	-	-	-	-	-	-	-
			5.8	0.07	5.3	0.08	4.7	0.09	4.1	0.05	-	-	-	-	-	-	-	-	-	-	-	-
	800	2886	1379	1213	1007	672	-	-	-	-	-	-	-	-	-	-	-	-	-	-	-	-
			6.6	0.09	6.1	0.10	5.5	0.10	5.0	0.10	-	-	-	-	-	-	-	-	-	-	-	-
	825	2976	1422	1263	1067	775	-	-	-	-	-	-	-	-	-	-	-	-	-	-	-	-
			6.8	0.10	6.3	0.10	5.7	0.11	5.2	0.11	-	-	-	-	-	-	-	-	-	-	-	-
850	3067	1465	1312	1126	874	-	-	-	-	-	-	-	-	-	-	-	-	-	-	-	-	
		7.0	0.11	6.5	0.11	5.9	0.12	5.4	0.12	-	-	-	-	-	-	-	-	-	-	-	-	-
900	3247	1552	1407	1238	1028	665	-	-	-	-	-	-	-	-	-	-	-	-	-	-	-	
		7.8	0.13	7.2	0.13	6.5	0.14	6.0	0.15	5.7	0.13	-	-	-	-	-	-	-	-	-	-	-
950	3427	1638	1502	1347	1159	884	-	-	-	-	-	-	-	-	-	-	-	-	-	-	-	
		8.5	0.15	7.9	0.16	7.3	0.16	6.7	0.17	6.3	0.17	-	-	-	-	-	-	-	-	-	-	-
1000	3608	1724	1596	1451	1282	1080	706	-	-	-	-	-	-	-	-	-	-	-	-	-	-	
		9.2	0.17	8.7	0.18	8.0	0.19	7.3	0.20	7.0	0.20	6.8	0.18	-	-	-	-	-	-	-	-	-
1050	3788	1810	1689	1553	1400	1217	939	-	-	-	-	-	-	-	-	-	-	-	-	-	-	
		9.7	0.20	9.2	0.21	8.5	0.22	7.8	0.23	7.4	0.23	7.1	0.22	-	-	-	-	-	-	-	-	-
1075	3878	1853	1735	1603	1456	1284	1040	647	-	-	-	-	-	-	-	-	-	-	-	-	-	
		10.0	0.21	9.4	0.23	8.8	0.23	8.1	0.24	7.7	0.25	7.4	0.25	7.5	0.21	-	-	-	-	-	-	-
1093	3943	1884	1768	1639	1496	1329	1111	758	-	-	-	-	-	-	-	-	-	-	-	-	-	
		10.2	0.23	9.6	0.24	9.1	0.24	8.3	0.26	7.9	0.26	7.7	0.26	7.7	0.23	-	-	-	-	-	-	-
1/3	1125	4059	1940	1827	1703	1566	1408	1227	924	-	-	-	-	-	-	-	-	-	-	-	-	
			10.6	0.25	10.0	0.26	9.5	0.27	8.8	0.27	8.2	0.29	8.0	0.29	8.1	0.27	-	-	-	-	-	-
	1150	4149	1983	1873	1753	1621	1469	1296	1028	489	-	-	-	-	-	-	-	-	-	-	-	-
11.0			0.26	10.4	0.27	9.8	0.28	9.1	0.29	8.5	0.31	8.3	0.31	8.3	0.29	8.4	0.21	-	-	-	-	-
1191	4297	2053	1948	1834	1708	1568	1406	1193	883	-	-	-	-	-	-	-	-	-	-	-	-	
		11.5	0.29	11.0	0.30	10.5	0.31	9.8	0.32	9.0	0.34	8.8	0.34	8.6	0.34	8.6	0.31	-	-	-	-	-
1/2	1220	4402	2103	2001	1889	1767	1634	1481	1306	1019	-	-	-	-	-	-	-	-	-	-	-	
			11.9	0.31	11.4	0.33	10.9	0.34	10.2	0.34	9.6	0.36	9.2	0.37	9.0	0.37	8.9	0.34	-	-	-	-
	1250	4510	2155	2056	1947	1829	1700	1555	1393	1142	801	-	-	-	-	-	-	-	-	-	-	
			12.4	0.34	11.9	0.35	11.4	0.36	10.8	0.37	10.0	0.38	9.6	0.39	9.4	0.39	9.3	0.38	9.3	0.33	-	-
1300	4690	2241	2147	2042	1930	1811	1677	1528	1342	1071	-	-	-	-	-	-	-	-	-	-	-	
		13.0	0.38	12.6	0.39	12.2	0.40	11.6	0.41	10.9	0.42	10.2	0.44	10.1	0.44	9.9	0.44	9.9	0.42	-	-	-
1369	4939	2360	2271	2172	2069	1959	1838	1703	1556	1352	1095	-	-	-	-	-	-	-	-	-	-	
		14.0	0.44	13.6	0.46	13.2	0.47	12.8	0.48	12.1	0.49	11.4	0.51	11.0	0.52	10.8	0.52	10.9	0.51	10.9	0.48	-
3/4	1380	4979	2379	2290	2193	2091	1982	1862	1730	1585	1396	1141	-	-	-	-	-	-	-	-	-	
			14.1	0.45	13.8	0.47	13.4	0.48	13.0	0.49	12.3	0.50	11.6	0.52	11.1	0.53	10.9	0.53	11.0	0.52	11.1	0.50
	1410	5087	2431	2344	2249	2150	2044	1929	1803	1666	1513	1265	-	-	-	-	-	-	-	-	-	-
			14.6	0.48	14.2	0.50	13.8	0.51	13.5	0.52	12.8	0.53	12.1	0.55	11.5	0.56	11.4	0.56	11.4	0.57	11.5	0.54
	1470	5304	2535	2451	2361	2268	2166	2061	1946	1818	1681	1505	-	-	-	-	-	-	-	-	-	-
15.6			0.55	15.2	0.56	14.8	0.58	14.5	0.58	13.9	0.60	13.2	0.61	12.6	0.64	12.3	0.64	12.2	0.64	12.3	0.63	-
1500	5412	2586	2504	2416	2325	2227	2126	2014	1892	1761	1620	-	-	-	-	-	-	-	-	-	-	
		16.1	0.58	15.8	0.60	15.4	0.61	15.1	0.62	14.5	0.63	13.9	0.64	13.2	0.67	12.8	0.68	12.7	0.68	12.8	0.68	-
		2716	2638	2555	2468	2377	2282	2180	2073	1952	1825	-	-	-	-	-	-	-	-	-	-	-
1575	5682	17.4	0.67	17.2	0.69	16.9	0.71	16.6	0.72	16.3	0.73	15.6	0.74	15.0	0.76	14.4	0.78	14.3	0.79	14.3	0.79	-

Performance shown is for installation type A: Free Inlet, Free Outlet. Power rating (BHP) does not include drive losses. For further information on estimating belt drive losses and motor service factors see page 11. The sound ratings shown are for loudness values in fan sones at 5'0" (1.5m) in a hemispherical free field per AMCA Standard 301. Values shown are for installation Type A: free inlet sone levels. Performance ratings do not include the effects of appurtenances in the airstream.

©PENN BARRY 2019

Domex

› DX12B Belt Drive Fan Curves

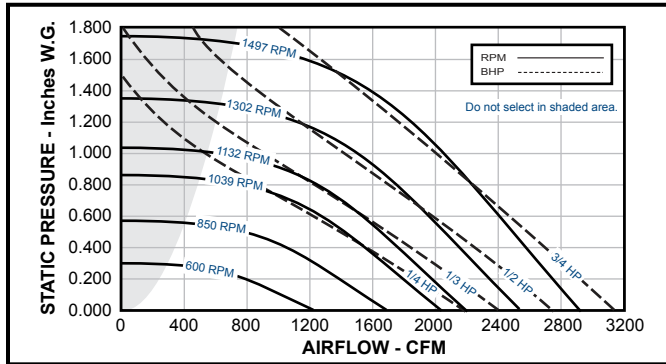

› DX12B Belt Drive Fan Dimensional Data

Galv. Steel Base = 16 Gage
Aluminum Base = 0.064"
Discharge Apron = 0.064"
Roof/Wall Opening = 16" SQ.
Damper Size = 15 3/4" SQ.
Max. Motor Frame Size = 56
Peak BHP = (RPM/1617) ³
Max. RPM = 2000 (1 1/2 HP)
Est. Ship Weight = 98 lbs.

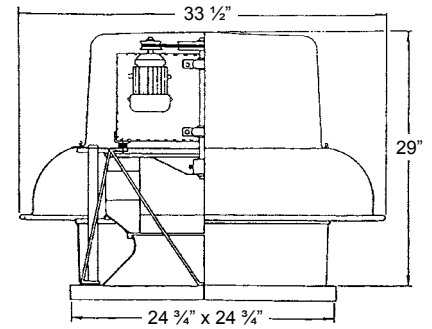

Centrifugal Fans

› DX12B Belt Drive Fan Performance Data

HP	RPM	Tip Speed FPM	0.000" SP		0.125" SP		0.250" SP		0.375" SP		0.500" SP		0.625" SP		0.750" SP		0.875" SP		1.000" SP		1.250" SP	
			Sones	BHP	Sones	BHP	Sones	BHP	Sones	BHP	Sones	BHP	Sones	BHP	Sones	BHP	Sones	BHP	Sones	BHP	Sones	BHP
1/4	400	1662	780	-	-	-	-	-	-	-	-	-	-	-	-	-	-	-	-	-	-	-
			2.9	0.01	-	-	-	-	-	-	-	-	-	-	-	-	-	-	-	-	-	-
	500	2078	975	-	-	-	-	-	-	-	-	-	-	-	-	-	-	-	-	-	-	-
			4.9	0.02	4.2	0.03	-	-	-	-	-	-	-	-	-	-	-	-	-	-	-	-
	600	2494	1170	-	-	-	-	538	-	-	-	-	-	-	-	-	-	-	-	-	-	-
			7.1	0.04	6.6	0.05	6.1	0.05	-	-	-	-	-	-	-	-	-	-	-	-	-	-
	700	2909	1365	-	-	-	-	903	-	-	-	-	-	-	-	-	-	-	-	-	-	-
			9.4	0.06	8.7	0.07	8.5	0.08	-	-	-	-	-	-	-	-	-	-	-	-	-	-
	800	3325	1561	-	-	-	-	1182	-	-	-	-	-	-	-	-	-	-	-	-	-	-
			11.0	0.09	10.2	0.11	10.0	0.12	9.6	0.12	-	-	-	-	-	-	-	-	-	-	-	-
850	3533	1658	-	-	-	-	1308	-	-	-	-	769	-	-	-	-	-	-	-	-	-	
		11.5	0.11	10.8	0.13	10.4	0.14	10.2	0.14	9.6	0.12	-	-	-	-	-	-	-	-	-	-	-
900	3740	1756	-	-	-	-	1425	-	-	-	985	-	-	-	-	-	-	-	-	-	-	
		12.2	0.13	11.5	0.15	11.0	0.16	10.8	0.17	10.3	0.17	-	-	-	-	-	-	-	-	-	-	-
950	3948	1853	-	-	-	-	1538	-	-	-	1155	-	858	-	-	-	-	-	-	-	-	
		12.9	0.16	12.3	0.17	11.6	0.18	11.4	0.19	11.0	0.20	10.4	0.19	-	-	-	-	-	-	-	-	-
1000	4156	1951	-	-	-	-	1650	-	-	-	1308	-	1076	-	553	-	-	-	-	-	-	
		13.3	0.18	12.8	0.20	12.1	0.21	11.7	0.22	11.4	0.23	11.1	0.23	10.1	0.19	-	-	-	-	-	-	-
1039	4318	2027	-	-	-	-	1737	-	-	-	1422	-	1219	-	930	-	-	-	-	-	-	
		13.7	0.21	13.2	0.22	12.6	0.24	12.2	0.25	11.7	0.26	11.6	0.26	11.2	0.25	-	-	-	-	-	-	-
1/3	1055	4385	2058	-	-	-	1774	-	-	-	1468	-	1269	-	1011	-	-	-	-	-	-	
			13.8	0.21	13.4	0.23	12.8	0.25	12.4	0.26	11.9	0.27	11.7	0.28	11.5	0.27	-	-	-	-	-	-
	1075	4468	2097	-	-	-	1819	-	-	-	1525	-	1331	-	1094	-	524	-	-	-	-	
			14.1	0.23	13.6	0.24	13.1	0.26	12.6	0.27	12.2	0.28	12.0	0.29	11.8	0.29	10.8	0.23	-	-	-	-
1100	4572	2146	-	-	-	1875	-	-	-	1591	-	1408	-	1197	-	855	-	-	-	-	-	
		14.5	0.24	13.9	0.26	13.4	0.28	12.9	0.29	12.5	0.30	12.3	0.31	12.2	0.31	11.7	0.29	-	-	-	-	
1132	4705	2208	-	-	-	1946	-	-	-	1673	-	1503	-	1316	-	1058	-	-	-	-	-	
		15.0	0.27	14.4	0.28	13.9	0.30	13.4	0.31	13.0	0.33	12.7	0.34	12.6	0.34	12.5	0.33	-	-	-	-	
1/2	1150	4779	2244	-	-	-	1986	-	-	-	1719	-	1556	-	1373	-	1136	-	572	-	-	
			15.3	0.28	14.7	0.29	14.2	0.31	13.7	0.33	13.3	0.34	12.9	0.35	12.9	0.36	12.9	0.35	12.0	0.28	-	-
	1175	4883	2292	-	-	-	2041	-	-	-	1782	-	1629	-	1451	-	1239	-	906	-	-	
			15.7	0.30	15.2	0.31	14.6	0.33	14.2	0.35	13.7	0.36	13.3	0.37	13.2	0.38	13.3	0.38	12.9	0.35	-	-
	1200	4987	2341	-	-	-	2096	-	-	-	1844	-	1700	-	1527	-	1341	-	1076	-	-	
			16.3	0.32	15.8	0.33	15.2	0.35	14.7	0.37	14.3	0.38	13.8	0.39	13.7	0.40	13.7	0.41	13.6	0.39	-	-
	1250	5195	2439	-	-	-	2206	-	-	-	1963	-	1831	-	1676	-	1507	-	1300	-	-	
			17.2	0.36	16.8	0.37	16.2	0.40	15.7	0.42	15.1	0.43	14.7	0.44	14.4	0.45	14.4	0.46	14.5	0.45	-	-
	1275	5299	2488	-	-	-	2260	-	-	-	2021	-	1895	-	1749	-	1585	-	1402	-	-	
			17.7	0.38	17.2	0.39	16.7	0.42	16.1	0.44	15.5	0.45	14.9	0.47	14.5	0.48	14.6	0.48	14.7	0.48	-	-
1302	5411	2540	-	-	-	2319	-	-	-	2082	-	1963	-	1827	-	1668	-	1503	-	869	-	
		18.1	0.40	17.6	0.42	17.1	0.44	16.6	0.46	16.0	0.48	15.4	0.49	14.7	0.51	14.7	0.52	14.9	0.52	14.5	0.45	
3/4	1325	5507	2585	-	-	-	2369	-	-	-	2134	-	2021	-	1891	-	1736	-	1576	-	1106	
			18.5	0.43	18.0	0.44	17.5	0.46	17.0	0.49	16.4	0.50	15.8	0.52	15.2	0.53	14.8	0.54	15.0	0.55	15.1	0.51
	1350	5611	2634	-	-	-	2423	-	-	-	2190	-	2083	-	1956	-	1810	-	1654	-	1248	
			18.9	0.45	18.4	0.47	17.9	0.49	17.4	0.51	16.8	0.53	16.3	0.54	15.7	0.56	15.2	0.57	15.1	0.58	15.6	0.56
	1400	5818	2731	-	-	-	2530	-	-	-	2302	-	2201	-	2084	-	1955	-	1807	-	1463	
			19.9	0.50	19.4	0.52	18.8	0.54	18.3	0.57	17.7	0.59	17.2	0.60	16.7	0.62	16.1	0.63	15.9	0.64	16.2	0.64
	1425	5922	2780	-	-	-	2584	-	-	-	2357	-	2258	-	2147	-	2026	-	1882	-	1566	
			20.0	0.53	19.9	0.55	19.3	0.57	18.7	0.60	18.2	0.62	17.7	0.63	17.2	0.65	16.6	0.66	16.2	0.67	16.3	0.68
	1450	6026	2829	-	-	-	2637	-	-	-	2413	-	2315	-	2210	-	2092	-	1955	-	1663	
			21.0	0.56	20.0	0.58	19.9	0.60	19.3	0.62	18.7	0.65	18.2	0.66	17.6	0.68	17.1	0.69	16.6	0.70	16.6	0.72
1497	6222	2921	-	-	-	2737	-	-	-	2520	-	2421	-	2327	-	2212	-	2091	-	1811		
		22.0	0.61	21.0	0.63	21.0	0.65	20.0	0.68	19.7	0.71	19.2	0.72	18.7	0.74	18.1	0.75	17.5	0.77	17.3	0.79	

Performance shown is for installation type A: Free Inlet, Free Outlet. Power rating (BHP) does not include drive losses. For further information on estimating belt drive losses and motor service factors see page 11. The sound ratings shown are for loudness values in fan sones at 50' (1.5m) in a hemispherical free field per AMCA Standard 301. Values shown are for installation Type A: free inlet sone levels. Performance ratings do not include the effects of appurtenances in the airstream.

Domex

Dimensional Information & Performance Data

Domex Centrifugal Fans | Belt Drive



DX14B

DX14B Belt Drive Fan Curves

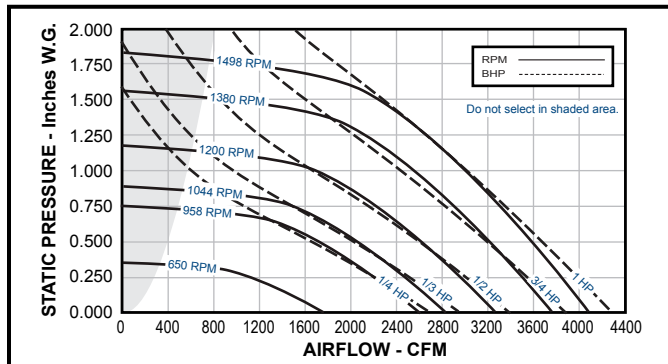

DX14B Belt Drive Fan Dimensional Data

Galv. Steel Base = 16 Gage
Aluminum Base = 0.064"
Discharge Apron = 0.064"
Roof/Wall Opening = 16" SQ.
Damper Size = 15 3/4" SQ.
Max. Motor Frame Size = 56
Peak BHP = (RPM/1493) ³
Max. RPM = 1793 (1 1/2 HP)
Est. Ship Weight = 98 lbs.

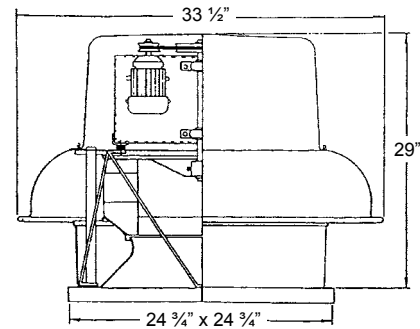

DX14B Belt Drive Fan Performance Data

HP	RPM	Tip Speed FPM	0.000" SP		0.125" SP		0.250" SP		0.375" SP		0.500" SP		0.625" SP		0.750" SP		1.000" SP		1.250" SP		1.500" SP			
			Sones	BHP	Sones	BHP	Sones	BHP	Sones	BHP	Sones	BHP	Sones	BHP	Sones	BHP	Sones	BHP	Sones	BHP	Sones	BHP	Sones	BHP
1/4	350	1455	952	-	-	-	-	-	-	-	-	-	-	-	-	-	-	-	-	-	-	-	-	
			1.6	0.01	-	-	-	-	-	-	-	-	-	-	-	-	-	-	-	-	-	-	-	-
	400	1662	1088	-	221	-	-	-	-	-	-	-	-	-	-	-	-	-	-	-	-	-	-	-
			2.5	0.02	3.0	0.01	-	-	-	-	-	-	-	-	-	-	-	-	-	-	-	-	-	-
	515	2140	1401	-	994	-	-	-	-	-	-	-	-	-	-	-	-	-	-	-	-	-	-	-
			4.8	0.04	4.5	0.04	-	-	-	-	-	-	-	-	-	-	-	-	-	-	-	-	-	-
	680	2826	1849	-	1582	-	1212	-	-	-	-	-	-	-	-	-	-	-	-	-	-	-	-	-
			7.3	0.08	6.7	0.09	6.0	0.09	-	-	-	-	-	-	-	-	-	-	-	-	-	-	-	-
842	3499	2290	-	2077	-	1835	-	1522	-	1104	-	-	-	-	-	-	-	-	-	-	-	-	-	
		9.7	0.15	9.0	0.17	8.3	0.18	7.4	0.18	6.3	0.17	-	-	-	-	-	-	-	-	-	-	-	-	-
910	3782	2475	-	2276	-	2070	-	1793	-	1495	-	831	-	-	-	-	-	-	-	-	-	-	-	
		10.7	0.19	10.1	0.21	9.5	0.22	8.8	0.23	7.6	0.22	6.9	0.18	-	-	-	-	-	-	-	-	-	-	-
958	3982	2606	-	2415	-	2226	-	1977	-	1699	-	1355	-	-	-	-	-	-	-	-	-	-	-	
		11.8	0.23	11.2	0.24	10.6	0.26	10.0	0.26	8.8	0.26	7.6	0.25	-	-	-	-	-	-	-	-	-	-	-
1/3	1000	4156	2720	-	2536	-	2360	-	2135	-	1870	-	1588	-	1033	-	-	-	-	-	-	-	-	
			12.6	0.26	12.0	0.27	11.4	0.29	10.8	0.30	9.8	0.30	8.5	0.29	7.9	0.25	-	-	-	-	-	-	-	-
	1020	4239	2774	-	2593	-	2424	-	2208	-	1949	-	1684	-	1250	-	-	-	-	-	-	-	-	-
			12.9	0.27	12.3	0.29	11.8	0.30	11.1	0.32	10.2	0.32	8.9	0.31	8.1	0.29	-	-	-	-	-	-	-	-
1044	4339	2840	-	2662	-	2499	-	2292	-	2044	-	1788	-	1445	-	-	-	-	-	-	-	-	-	
		13.1	0.29	12.6	0.31	12.1	0.33	11.4	0.34	10.7	0.34	9.4	0.34	8.4	0.32	-	-	-	-	-	-	-	-	-
1/2	1060	4405	2883	-	2708	-	2549	-	2348	-	2106	-	1854	-	1561	-	-	-	-	-	-	-	-	
			13.4	0.31	12.8	0.32	12.4	0.34	11.7	0.35	11.0	0.36	9.8	0.35	8.7	0.34	-	-	-	-	-	-	-	-
	1095	4551	2978	-	2809	-	2654	-	2469	-	2240	-	1998	-	1738	-	-	-	-	-	-	-	-	-
			14.2	0.34	13.7	0.35	13.2	0.37	12.6	0.39	11.9	0.39	10.7	0.39	9.5	0.38	-	-	-	-	-	-	-	-
	1130	4696	3074	-	2909	-	2758	-	2586	-	2373	-	2138	-	1901	-	610	-	-	-	-	-	-	-
			15.2	0.37	14.6	0.39	14.1	0.41	13.6	0.42	12.8	0.43	11.9	0.43	10.5	0.43	9.3	0.25	-	-	-	-	-	-
1160	4821	3155	-	2995	-	2847	-	2683	-	2484	-	2257	-	2027	-	1251	-	-	-	-	-	-	-	
		16.0	0.40	15.5	0.42	15.1	0.44	14.5	0.46	13.8	0.47	12.9	0.47	11.5	0.46	9.8	0.40	-	-	-	-	-	-	
1190	4946	3237	-	3081	-	2936	-	2780	-	2592	-	2373	-	2150	-	1556	-	-	-	-	-	-	-	
		17.0	0.44	16.4	0.45	16.0	0.47	15.5	0.49	14.8	0.50	14.0	0.51	12.6	0.50	10.4	0.47	-	-	-	-	-	-	
1200	4987	3264	-	3109	-	2965	-	2812	-	2627	-	2412	-	2191	-	1629	-	-	-	-	-	-	-	
		17.3	0.45	16.8	0.46	16.3	0.48	15.8	0.50	15.1	0.52	14.4	0.52	12.9	0.52	10.6	0.49	-	-	-	-	-	-	
3/4	1218	5062	3313	-	3160	-	3018	-	2869	-	2690	-	2481	-	2263	-	1759	-	-	-	-	-	-	
			17.7	0.47	17.2	0.48	16.7	0.50	16.2	0.52	15.6	0.54	14.8	0.54	13.5	0.54	11.0	0.52	-	-	-	-	-	-
	1285	5341	3495	-	3351	-	3213	-	3081	-	2921	-	2733	-	2528	-	2105	-	1072	-	-	-	-	-
			18.5	0.55	18.0	0.56	17.5	0.58	17.1	0.61	16.5	0.63	15.8	0.64	15.1	0.60	12.6	0.62	11.8	0.47	-	-	-	-
	1315	5465	3577	-	3435	-	3300	-	3173	-	3019	-	2844	-	2644	-	2238	-	1594	-	-	-	-	-
			18.7	0.59	18.2	0.60	17.7	0.62	17.3	0.65	16.8	0.67	16.2	0.68	15.5	0.68	13.3	0.67	12.2	0.62	-	-	-	-
1345	5590	3659	-	3520	-	3387	-	3262	-	3116	-	2949	-	2759	-	2363	-	1845	-	-	-	-	-	
		19.0	0.63	18.5	0.65	18.1	0.67	17.7	0.69	17.2	0.71	16.6	0.73	16.0	0.73	14.0	0.72	12.5	0.69	-	-	-	-	
1380	5735	3754	-	3619	-	3488	-	3367	-	3229	-	3071	-	2891	-	2507	-	2080	-	699	-	-	-	
		19.5	0.68	19.1	0.70	18.6	0.72	18.2	0.74	17.8	0.76	17.2	0.78	16.6	0.79	14.9	0.79	13.1	0.76	12.9	0.45	-	-	
1	1400	5818	3808	-	3675	-	3546	-	3426	-	3293	-	3140	-	2966	-	2587	-	2178	-	939	-	-	
			19.9	0.71	19.4	0.73	19.0	0.75	18.6	0.77	18.2	0.79	17.6	0.81	17.0	0.82	15.5	0.82	13.6	0.80	13.2	0.53	-	-
	1425	5922	3876	-	3746	-	3617	-	3500	-	3372	-	3226	-	3059	-	2687	-	2298	-	1579	-	-	-
			20.0	0.75	20.0	0.77	19.5	0.79	19.2	0.81	18.8	0.83	18.2	0.86	17.6	0.87	16.2	0.87	14.3	0.85	13.6	0.76	-	-
	1450	6026	3944	-	3816	-	3689	-	3574	-	3451	-	3309	-	3149	-	3786	-	2417	-	1848	-	-	-
			21.0	0.79	21.0	0.81	20.0	0.83	19.7	0.85	19.3	0.87	18.8	0.90	18.2	0.91	16.8	0.91	15.0	0.90	14.0	0.85	-	-
1475	6130	4012	-	3886	-	3761	-	3647	-	3530	-	3391	-	3236	-	2885	-	2523	-	2033	-	-	-	
		22.0	0.83	21.0	0.85	21.0	0.87	20.0	0.89	19.8	0.92	19.3	0.94	18.8	0.96	17.5	0.96	15.7	0.95	14.2	0.91	-	-	
1498	6226	4075	-	3951	-	3826	-	3714	-	3602	-	3465	-	3317	-	2974	-	2618	-	2200	-	-	-	
		22.0	0.87	22.0	0.89	21.0	0.91	21.0	0.93	20.0	0.96	19.8	0.98	19.3	1.00	18.1	1.01	16.3	1.00	14.6	0.97	-	-	

Performance shown is for installation type A: Free Inlet, Free Outlet. Power rating (BHP) does not include drive losses. For further information on estimating belt drive losses and motor service factors see page 11. The sound ratings shown are for loudness values in fan sones at 5'0" (1.5m) in a hemispherical free field per AMCA Standard 301. Values shown are for installation Type A: free inlet sone levels. Performance ratings do not include the effects of appurtenances in the airstream.

PENN BARRY 2009

› DX16B Belt Drive Fan Curves

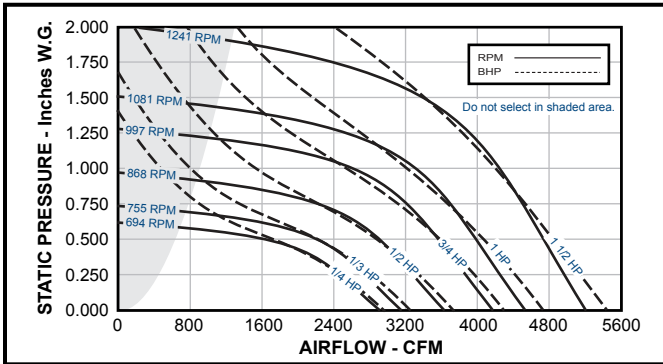

› DX16B Belt Drive Fan Dimensional Data

Galv. Steel Base = 14 Gage
Aluminum Base = 0.080"
Discharge Apron = 0.064"
Roof/Wall Opening = 20" SQ.
Damper Size = 19 3/4" SQ.
Max. Motor Frame Size = 145T
Peak BHP = (RPM/1078) ³
Max. RPM = 1631 (3 HP)
Est. Ship Weight = 131 lbs.

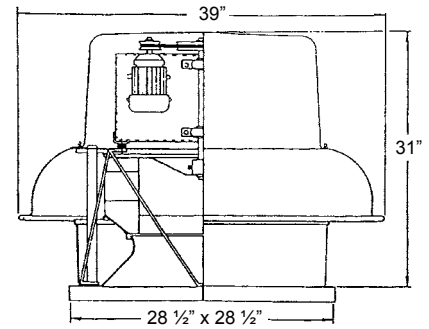

Centrifugal Fans

› DX16B Belt Drive Fan Performance Data

HP	RPM	Tip Speed FPM	0.000" SP		0.125" SP		0.250" SP		0.375" SP		0.500" SP		0.625" SP		0.750" SP		1.000" SP		1.250" SP		1.500" SP			
			Sones	BHP	Sones	BHP	Sones	BHP	Sones	BHP	Sones	BHP	Sones	BHP	Sones	BHP	Sones	BHP	Sones	BHP	Sones	BHP	Sones	BHP
1/4	300	1468	1248	-	-	-	-	-	-	-	-	-	-	-	-	-	-	-	-	-	-	-	-	
			3.1	0.02	-	-	-	-	-	-	-	-	-	-	-	-	-	-	-	-	-	-	-	
	450	2202	1873	-	1531	-	511	-	-	-	-	-	-	-	-	-	-	-	-	-	-	-	-	
			5.2	0.06	4.5	0.07	4.4	0.05	-	-	-	-	-	-	-	-	-	-	-	-	-	-	-	
	600	2936	2497	-	2250	-	1980	-	1465	-	-	-	-	-	-	-	-	-	-	-	-	-	-	
		8.8	0.15	8.3	0.16	7.9	0.17	7.4	0.16	-	-	-	-	-	-	-	-	-	-	-	-	-	-	
650	3180	2705	-	2478	-	2233	-	1935	-	1029	-	-	-	-	-	-	-	-	-	-	-	-	-	
		9.7	0.19	9.1	0.20	8.8	0.21	8.5	0.22	7.8	0.17	-	-	-	-	-	-	-	-	-	-	-	-	
694	3395	2889	-	2677	-	2450	-	2212	-	1707	-	-	-	-	-	-	-	-	-	-	-	-	-	
		10.4	0.23	10.0	0.24	9.7	0.26	9.3	0.27	8.8	0.25	-	-	-	-	-	-	-	-	-	-	-	-	
1/3	715	3498	2976	-	2772	-	2552	-	2323	-	1948	-	-	-	-	-	-	-	-	-	-	-	-	
			10.9	0.25	10.5	0.27	10.1	0.28	9.8	0.29	9.2	0.29	8.9	0.20	-	-	-	-	-	-	-	-	-	
	735	3596	3059	-	2861	-	2648	-	2426	-	2120	-	1302	-	-	-	-	-	-	-	-	-	-	
		11.5	0.27	11.0	0.29	10.6	0.30	10.2	0.31	9.7	0.32	9.2	0.26	-	-	-	-	-	-	-	-	-	-	
755	3694	3142	-	2950	-	2744	-	2528	-	2266	-	1620	-	-	-	-	-	-	-	-	-	-	-	
		11.9	0.30	11.6	0.31	11.1	0.33	10.7	0.34	10.3	0.34	9.7	0.31	-	-	-	-	-	-	-	-	-	-	
1/2	775	3792	3226	-	3039	-	2839	-	2629	-	2397	-	1897	-	766	-	-	-	-	-	-	-	-	
			12.3	0.32	11.9	0.34	11.6	0.35	11.2	0.36	10.7	0.37	10.1	0.35	9.9	0.22	-	-	-	-	-	-	-	
	800	3914	3330	-	3150	-	2957	-	2755	-	2546	-	2183	-	1334	-	-	-	-	-	-	-	-	
			12.8	0.35	12.4	0.37	12.0	0.38	11.7	0.40	11.3	0.41	10.6	0.40	10.3	0.40	-	-	-	-	-	-	-	-
	825	4036	3434	-	3259	-	3073	-	2878	-	2679	-	2396	-	1744	-	-	-	-	-	-	-	-	-
		13.3	0.39	12.9	0.40	12.5	0.42	12.2	0.43	11.8	0.45	11.2	0.45	10.7	0.40	-	-	-	-	-	-	-	-	
850	4159	3538	-	3368	-	3188	-	3001	-	2808	-	2575	-	2091	-	-	-	-	-	-	-	-	-	
		13.8	0.42	13.5	0.44	13.1	0.46	12.7	0.47	12.3	0.49	11.9	0.49	11.2	0.46	-	-	-	-	-	-	-	-	
868	4247	3613	-	3447	-	3271	-	3088	-	2900	-	2690	-	2314	-	-	-	-	-	-	-	-	-	
		14.3	0.45	13.9	0.47	13.5	0.49	13.2	0.50	12.8	0.51	12.3	0.52	11.6	0.51	-	-	-	-	-	-	-	-	
3/4	895	4379	3725	-	3564	-	3395	-	3218	-	3037	-	2850	-	2556	-	887	-	-	-	-	-	-	
			15.0	0.49	14.6	0.51	14.2	0.53	13.9	0.55	13.5	0.56	13.0	0.57	12.4	0.57	11.9	0.35	-	-	-	-	-	
	925	4526	3850	-	3694	-	3531	-	3362	-	3187	-	3009	-	2778	-	1563	-	-	-	-	-	-	
			15.8	0.54	15.4	0.56	15.0	0.58	14.7	0.60	14.3	0.62	13.9	0.63	13.3	0.63	12.5	0.50	-	-	-	-	-	
	950	4648	3954	-	3803	-	3644	-	3481	-	3311	-	3138	-	2941	-	1974	-	-	-	-	-	-	
		16.5	0.59	16.1	0.61	15.8	0.63	15.4	0.65	15.0	0.66	15.0	0.68	14.2	0.69	13.1	0.60	-	-	-	-	-	-	
975	4770	4058	-	3911	-	3757	-	3599	-	3433	-	3266	-	3090	-	2331	-	-	-	-	-	-	-	
		17.1	0.64	16.7	0.66	16.4	0.68	16.0	0.70	15.7	0.71	15.3	0.73	14.8	0.74	13.6	0.69	-	-	-	-	-	-	
997	4878	4150	-	4005	-	3856	-	3701	-	3540	-	3377	-	3212	-	2608	-	-	-	-	-	-	-	
		17.4	0.68	17.1	0.70	16.7	0.72	16.4	0.74	16.0	0.76	15.7	0.78	15.2	0.79	13.9	0.77	-	-	-	-	-	-	
1	1025	5015	4266	-	4126	-	3982	-	3831	-	3676	-	3518	-	3357	-	2880	-	1573	-	-	-	-	
			17.9	0.74	17.6	0.76	17.2	0.78	16.9	0.80	16.5	0.82	16.2	0.84	15.8	0.85	14.6	0.86	14.1	0.65	-	-	-	
	1055	5162	4391	-	4255	-	4116	-	3969	-	3820	-	3667	-	3511	-	3115	-	2100	-	-	-	-	
			18.5	0.81	18.1	0.83	17.8	0.85	17.4	0.87	17.1	0.89	16.7	0.91	16.3	0.93	15.4	0.94	14.4	0.81	-	-	-	
1081	5289	4500	-	4366	-	4231	-	4088	-	3943	-	3794	-	3643	-	3299	-	2484	-	-	-	-		
		18.9	0.87	18.6	0.89	18.3	0.92	17.9	0.94	17.6	0.96	17.2	0.97	16.8	0.99	15.9	1.01	14.7	0.93	-	-	-	-	
1 1/2	1115	5455	4641	-	4512	-	4382	-	4244	-	4104	-	3960	-	3814	-	3504	-	2920	-	1562	-	-	
			19.8	0.95	19.4	0.98	19.1	1.00	18.7	1.02	18.4	1.04	18.1	1.06	17.6	1.08	16.7	1.11	15.3	1.08	15.1	0.80	-	
	1150	5626	4787	-	4662	-	4536	-	4403	-	4268	-	4129	-	3989	-	3703	-	3256	-	2209	-	-	
			21.0	1.04	20.0	1.07	20.0	1.10	19.7	1.12	19.3	1.14	19.0	1.16	18.6	1.18	17.7	1.21	16.5	1.21	15.6	1.03	-	
	1180	5773	4912	-	4790	-	4668	-	4538	-	4407	-	4273	-	4136	-	3858	-	3486	-	2664	-	-	
		22.0	1.13	21.0	1.16	21.0	1.18	21.0	1.21	20.0	1.23	19.8	1.25	19.4	1.27	18.6	1.30	17.5	1.32	16.2	1.19	-		
1210	5920	5037	-	4918	-	4798	-	4673	-	4546	-	4416	-	4282	-	4012	-	3698	-	3056	-	-		
		22.0	1.22	22.0	1.24	22.0	1.27	21.0	1.30	21.0	1.32	21.0	1.34	20.0	1.36	19.3	1.40	18.4	1.42	16.8	1.36	-		
1241	6072	5166	-	5050	-	4933	-	4812	-	4688	-	4563	-	4432	-	4170	-	3884	-	3398	-	-		
		23.0	1.31	23.0	1.34	22.0	1.37	22.0	1.39	22.0	1.42	21.0	1.44	21.0	1.46	20.0	1.50	19.1	1.53	17.8	1.51	-	-	

Performance shown is for installation type A: Free Inlet, Free Outlet. Power rating (BHP) does not include drive losses. For further information on estimating belt drive losses and motor service factors see page 11. The sound ratings shown are for loudness values in fan sones at 50' (1.5m) in a hemispherical free field per AMCA Standard 301. Values shown are for installation Type A: free inlet sone levels. Performance ratings do not include the effects of appurtenances in the airstream.

Domex

Dimensional Information & Performance Data

Domex Centrifugal Fans | Belt Drive



DX18B

DX18B Belt Drive Fan Curves

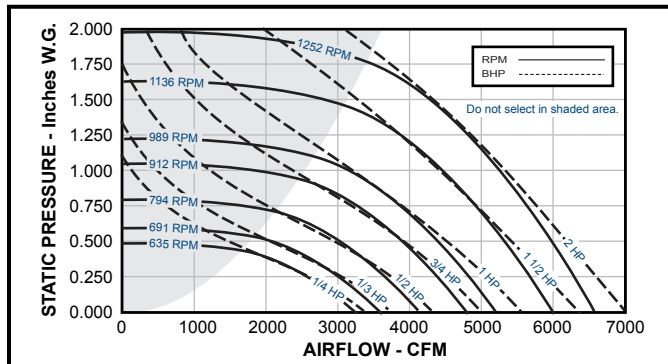

DX18B Belt Drive Fan Dimensional Data

Galv. Steel Base = 14 Gage
Aluminum Base = 0.080"
Discharge Apron = 0.064"
Roof/Wall Opening = 20" SQ.
Damper Size = 19 3/4" SQ.
Max. Motor Frame Size = 145T
Peak BHP = (RPM/986) ³
Max. RPM = 1326 (2 HP)
Est. Ship Weight = 132 lbs.

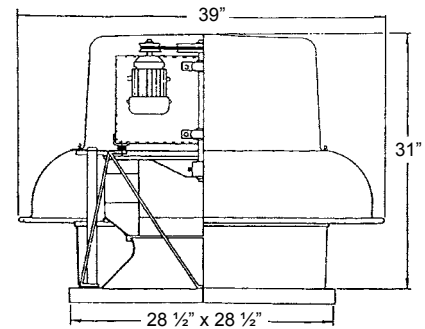

DX18B Belt Drive Fan Performance Data

HP	RPM	Tip Speed FPM	0.000" SP		0.125" SP		0.250" SP		0.375" SP		0.500" SP		0.625" SP		0.750" SP		1.000" SP		1.250" SP		1.500" SP	
			Sones	BHP	Sones	BHP	Sones	BHP	Sones	BHP	Sones	BHP	Sones	BHP	Sones	BHP	Sones	BHP	Sones	BHP	Sones	BHP
1/4	375	1988	1975		1402		-		-		-		-		-		-		-		-	
	549	2910	2892		2531		2138		-		-		-		-		-		-		-	
			8.0	0.14	7.7	0.16	7.1	0.17	-		-		-		-		-		-			
	590	3128	3108		2774		2417		1746		-		-		-		-		-		-	
8.9			0.18	8.5	0.20	7.9	0.21	7.4	0.20	-		-		-		-		-				
635	3366	3345		3037		2711		2291		-		-		-		-		-		-		
		10.1	0.22	9.7	0.24	9.1	0.26	8.3	0.26	-		-		-		-		-				
1/3	655	3472	3450		3153		2838		2478		1493		-		-		-		-		-	
	675	3578	10.4 0.24		10.0 0.26		9.4 0.28		8.7 0.29		8.2 0.24		-		-		-		-		-	
			3555		3268		2963		2638		1913		-		-		-		-		-	
691	3663	10.7 0.26		10.3 0.29		9.8 0.31		9.1 0.32		8.4 0.30		-		-		-		-		-		
		3640		3360		3062		2751		2162		-		-		-		-		-		
1/2	715	3791	3766		3497		3209		2911		2456		-		-		-		-		-	
			11.4 0.31		11.0 0.34		10.5 0.36		9.8 0.38		9.0 0.37		-		-		-		-		-	
	740	3923	3898		3639		3361		3075		2712		1852		-		-		-		-	
			12.1 0.35		11.7 0.37		11.2 0.39		10.4 0.41		9.7 0.42		9.1 0.37		-		-		-		-	
770	4082	4056		3808		3542		3271		2974		2383		-		-		-		-		
		13.1 0.39		12.7 0.42		12.2 0.44		11.5 0.46		10.6 0.48		9.7 0.46		-		-		-		-		
794	4209	4182		3943		3685		3424		3150		2684		1604		-		-		-		
		14.2 0.43		13.7 0.46		13.2 0.48		12.5 0.50		11.6 0.52		10.6 0.51		10.3 0.41		-		-		-		
3/4	825	4374	4345		4115		3868		3618		3357		3010		2313		-		-		-	
			15.2 0.48		14.8 0.51		14.2 0.53		13.7 0.56		12.6 0.58		11.6 0.58		10.8 0.54		-		-		-	
	855	4533	4503		4281		4045		3804		3555		3278		2763		-		-		-	
			15.5 0.53		15.1 0.57		14.6 0.59		14.1 0.62		13.2 0.64		12.2 0.65		11.2 0.64		-		-		-	
885	4692	4662		4447		4220		3987		3750		3504		3107		-		-		-		
		16.3 0.59		15.9 0.63		15.4 0.65		14.9 0.68		14.1 0.70		13.3 0.72		12.3 0.71		-		-		-		
912	4835	4804		4595		4376		4151		3923		3684		3376		1675		-		-		
		17.1 0.65		16.8 0.68		16.3 0.71		15.8 0.74		15.1 0.76		14.3 0.78		13.4 0.78		12.3 0.59		-		-		
1	930	4930	4899		4694		4480		4259		4036		3803		3536		2206		-		-	
			17.8 0.69		17.4 0.72		17.0 0.75		16.5 0.78		15.9 0.81		15.0 0.83		14.1 0.84		12.8 0.72		-		-	
	965	5116	5083		4886		4682		4469		4255		4034		3806		2875		-		-	
18.9 0.77			18.7 0.81		18.3 0.84		17.8 0.86		17.3 0.89		16.5 0.92		15.7 0.94		13.8 0.90		-		-			
989	5243	5209		5017		4819		4612		4403		4190		3969		3213		-		-		
		19.9 0.82		19.6 0.87		19.2 0.90		18.7 0.92		18.2 0.95		17.5 0.98		16.7 1.00		14.9 0.99		-		-		
1 1/2	1030	5460	5425		5241		5053		4853		4653		4451		4240		3671		2215		-	
			21.0 0.93		21.0 0.97		20.0 1.01		19.9 1.04		19.5 1.07		18.9 1.10		18.0 1.12		16.5 1.12		15.5 0.92		-	
	1065	5646	5610		5431		5251		5058		4865		4671		4470		4006		2984		-	
			22.0 1.03		21.0 1.07		21.0 1.12		21.0 1.14		20.0 1.17		19.5 1.20		18.7 1.23		17.3 1.25		15.9 1.17		-	
1100	5832	5794		5621		5448		5262		5075		4887		4697		4291		3517		-		
		22.0 1.13		22.0 1.18		22.0 1.23		21.0 1.25		21.0 1.28		20.0 1.31		19.5 1.34		18.1 1.39		16.5 1.36		-		
1136	6022	5984		5816		5649		5470		5289		5108		4925		4543		3945		2625		
		23.0 1.25		23.0 1.30		22.0 1.34		22.0 1.34		22.0 1.37		21.0 1.44		21.0 1.47		19.2 1.52		17.7 1.49		16.8 1.29		
2	1175	6229	6189		6027		5865		5694		5520		5345		5169		4802		4336		3414	
			24.0 1.38		24.0 1.43		24.0 1.48		23.0 1.51		23.0 1.54		22.0 1.57		22.0 1.61		20.0 1.67		19.1 1.67		17.6 1.60	
	1200	6362	6321		6162		6004		5838		5667		5495		5323		4967		4560		3786	
			25.0 1.47		25.0 1.52		24.0 1.57		24.0 1.61		23.0 1.64		23.0 1.67		23.0 1.71		21.0 1.77		20.0 1.80		18.3 1.77	
	1225	6494	6453		6297		6142		5980		5813		5645		5477		5153		4763		4100	
25.0 1.57			25.0 1.62		25.0 1.67		25.0 1.71		24.0 1.74		24.0 1.77		23.0 1.81		22.0 1.87		21.0 1.93		19.6 1.88			
1252	6637	6595		6443		6291		6134		5970		5806		5641		5307		4958		4399		
		26.0 1.67		26.0 1.73		26.0 1.78		26.0 1.82		25.0 1.85		25.0 1.88		24.0 1.92		23.0 1.99		22.0 2.05		21.0 2.00		

Performance shown is for installation type A: Free Inlet, Free Outlet. Power rating (BHP) does not include drive losses. For further information on estimating belt drive losses and motor service factors see page 11. The sound ratings shown are for loudness values in fan sones at 5'0" (1.5m) in a hemispherical free field per AMCA Standard 301. Values shown are for installation Type A: free inlet sone levels. Performance ratings do not include the effects of appurtenances in the airstream.

©PENN BARRY 2009

› DX24B Belt Drive Fan Curves

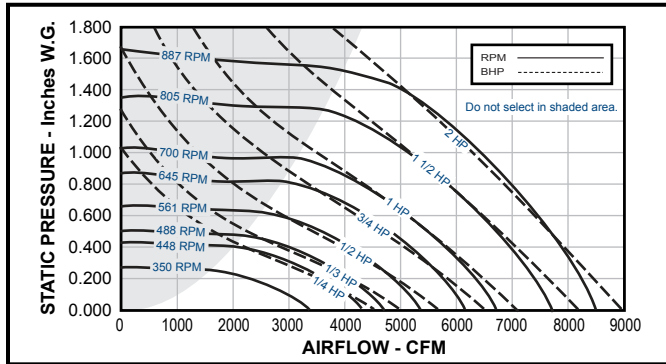

› DX24B Belt Drive Fan Dimensional Data

Galv. Steel Base = 14 Gage
Aluminum Base = 0.080"
Discharge Apron = 0.064"
Roof/Wall Opening = 25" SQ.
Damper Size = 24 3/4" SQ.
Max. Motor Frame Size = 184T
Peak BHP = (RPM/700) ³
Max. RPM = 1275 (5 HP)
Est. Ship Weight = 183 lbs.

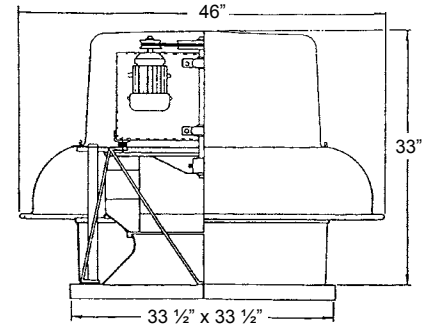

Centrifugal Fans

› DX24B Belt Drive Fan Performance Data

HP	RPM	Tip Speed FPM	0.000" SP		0.125" SP		0.250" SP		0.375" SP		0.500" SP		0.625" SP		0.750" SP		1.000" SP		1.250" SP		1.500" SP																		
			Sones	BHP	Sones	BHP	Sones	BHP	Sones	BHP	Sones	BHP	Sones	BHP	Sones	BHP	Sones	BHP	Sones	BHP	Sones	BHP	Sones	BHP															
1/4	265	1719	2547		1450		-		-		-		-		-		-		-		-																		
			3.1	0.05	1.4	0.05																																	
	399	2589	3835		3315		2531		-		-		-		-		-		-		-		-																
			7.6	0.15	7.0	0.18	5.5	0.18																															
430	2790	4133		3675		2998		-		-		-		-		-		-		-		-																	
		8.2	0.19	7.6	0.22	6.9	0.23																																
448	2906	4306		3873		3251		2278		-		-		-		-		-		-		-																	
		8.6	0.22	7.9	0.25	7.3	0.26	4.7	0.24																														
1/3	460	2984	4421		4003		3407		2534		-		-		-		-		-		-																		
			8.9	0.24	8.2	0.27	7.6	0.28	5.2	0.27																													
	475	3082	4565		4164		3600		2837		-		-		-		-		-		-		-																
9.3			0.26	8.7	0.29	8.0	0.31	6.1	0.30																														
488	3166	4690		4303		3766		3087		-		-		-		-		-		-		-																	
		9.7	0.28	9.1	0.32	8.4	0.34	6.9	0.33																														
1/2	520	3374	4998		4643		4163		3575		2688		-		-		-		-		-																		
			10.6	0.34	10.0	0.38	9.3	0.40	8.4	0.41	5.9	0.38																											
	530	3438	5094		4749		4283		3721		2901		-		-		-		-		-		-																
			10.8	0.36	10.2	0.40	9.5	0.42	8.8	0.43	6.5	0.41																											
540	3503	5190		4854		4402		3865		3107		-		-		-		-		-		-																	
		11.0	0.38	10.5	0.42	9.7	0.45	9.0	0.46	7.0	0.43																												
561	3640	5392		5075		4650		4142		3517		-		-		-		-		-		-																	
		11.6	0.43	11.0	0.47	10.4	0.49	9.6	0.51	8.2	0.50																												
3/4	600	3893	5767		5473		5104		4642		4122		3399		-		-		-		-		-																
			13.1	0.52	12.6	0.57	11.9	0.59	11.2	0.62	10.3	0.62	8.2	0.59																									
	625	4055	6007		5726		5384		4955		4484		3890		2988		-		-		-		-																
14.3			0.59	13.7	0.64	13.0	0.67	12.3	0.70	11.6	0.71	9.9	0.69	8.2	0.64																								
645	4185	6200		5926		5601		5196		4747		4226		3466		-		-		-		-																	
		14.5	0.65	14.0	0.71	13.4	0.73	12.6	0.76	11.9	0.78	10.8	0.76	8.8	0.73																								
1	663	4301	6373		6107		5795		5411		4980		4493		3838		-		-		-		-																
			14.7	0.71	14.2	0.76	13.7	0.79	13.0	0.82	12.3	0.85	11.4	0.84	9.7	0.80																							
	675	4379	6488		6227		5924		5553		5134		4669		4075		-		-		-		-																
			15.0	0.75	14.5	0.80	13.9	0.84	13.1	0.86	12.6	0.89	11.8	0.89	10.3	0.86																							
	685	4444	6584		6327		6031		5671		5261		4815		4268		-		-		-		-																
15.2			0.78	14.7	0.84	14.1	0.87	13.5	0.90	12.8	0.93	12.1	0.93	10.8	0.90																								
700	4541	6728		6477		6191		5847		5450		5031		4531		-		-		-		-																	
		15.5	0.83	15.0	0.89	14.5	0.93	13.9	0.96	13.3	0.99	12.6	1.00	11.5	0.97																								
1 1/2	750	4866	7209		6974		6721		6425		6063		5680		5269		4113		-		-		-																
			17.0	1.02	16.6	1.09	16.1	1.14	15.5	1.16	14.9	1.20	14.3	1.22	13.7	1.22	11.1	1.15																					
	775	5028	7449		7222		6984		6697		6360		5998		5619		4619		-		-		-																
			17.9	1.13	17.5	1.19	17.1	1.25	16.5	1.27	16.0	1.31	15.4	1.34	14.8	1.36	12.4	1.30																					
	790	5125	7593		7370		7141		6860		6537		6186		5815		4910		-		-		-																
18.6			1.20	18.2	1.26	17.7	1.32	17.2	1.34	16.6	1.38	16.0	1.42	15.5	1.43	13.4	1.39																						
805	5223	7738		7519		7298		7022		6713		6374		6009		5182		3788		-		-																	
		19.1	1.27	18.6	1.33	18.1	1.40	17.6	1.42	17.0	1.45	16.5	1.50	15.9	1.51	14.1	1.48	12.0	1.35																				
2	820	5320	7882		7667		7452		7183		6888		6556		6202		5407		4203		-		-																
			19.2	1.34	18.8	1.41	18.3	1.48	17.8	1.50	17.3	1.53	16.7	1.58	16.1	1.60	14.6	1.57	12.3	1.48																			
	850	5515	8170		7963		7756		7505		7235		6915		6583		5851		4836		-		-																
			19.6	1.49	19.2	1.56	18.8	1.63	18.3	1.66	17.8	1.69	17.2	1.74	16.7	1.77	15.5	1.77	13.5	1.69																			
	870	5644	8362		8160		7957		7718		7462		7152		6834		6142		5234		-		-																
20.0			1.60	20.0	1.67	19.5	1.74	19.0	1.78	18.5	1.80	17.9	1.85	17.4	1.89	16.3	1.91	14.3	1.84																				
887	5755	8526		8327		8129		7898		7648		7352		7046		6384		5561		4317		-		-															
		21.0	1.69	21.0	1.77	20.0	1.84	19.7	1.89	19.2	1.91	18.6	1.95	18.1	2.00	17.0	2.04	15.3	1.97	13.9	1.83																		

Performance shown is for installation type A: Free Inlet, Free Outlet. Power rating (BHP) does not include drive losses. For further information on estimating belt drive losses and motor service factors see page 11. The sound ratings shown are for loudness values in fan sones at 50' (1.5m) in a hemispherical free field per AMCA Standard 301. Values shown are for installation Type A: free inlet sone levels. Performance ratings do not include the effects of appurtenances in the airstream.

Domex

Dimensional Information & Performance Data

Domex Centrifugal Fans | Belt Drive



DX27B

DX27B Belt Drive Fan Curves

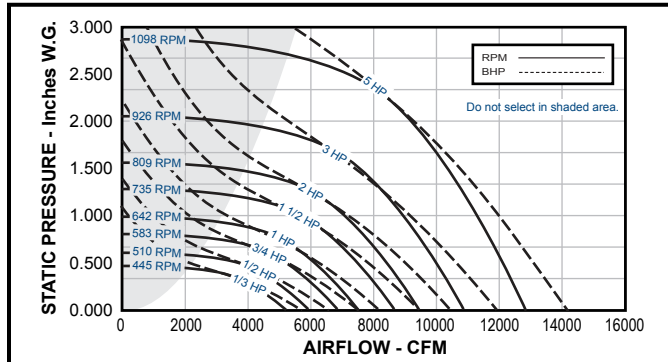

DX27B Belt Drive Fan Dimensional Data

Galv. Steel Base = 14 Gage
Aluminum Base = 0.102"
Discharge Apron = 0.080"
Roof/Wall Opening = 28" SQ.
Damper Size = 27 3/4" SQ.
Max. Motor Frame Size = 184T
Peak BHP = (RPM/642) ³
Max. RPM = 1210 (5 HP)
Est. Ship Weight = 210 lbs.

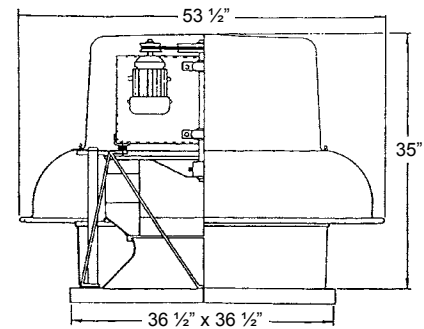

DX27B Belt Drive Fan Performance Data

HP	RPM	Tip Speed FPM	0.125" SP		0.250" SP		0.375" SP		0.500" SP		0.750" SP		1.000" SP		1.250" SP		1.500" SP		2.000" SP	
			Sones	BHP	Sones	BHP	Sones	BHP	Sones	BHP	Sones	BHP	Sones	BHP	Sones	BHP	Sones	BHP	Sones	BHP
1/3	445	3234	4748		4165		3314		-		-		-		-		-		-	
			8.1	0.29	7.3	0.32	6.8	0.33	-		-		-		-		-		-	
1/2	475	3451	5124		4604		3947		-		-		-		-		-		-	
			9.2	0.34	8.4	0.38	7.7	0.40	-		-		-		-		-		-	
	510	3703	5557		5102		4545		3731		-		-		-		-		-	
			10.3	0.42	9.5	0.46	8.8	0.46	8.4	0.50	-		-		-		-		-	
3/4	530	3850	5808		5386		4866		4180		-		-		-		-		-	
			10.9	0.47	10.2	0.51	9.5	0.54	9.0	0.56	-		-		-		-		-	
	560	4068	6178		5801		5321		4773		-		-		-		-		-	
			12.1	0.55	11.4	0.59	10.6	0.63	10.0	0.66	-		-		-		-		-	
	583	4239	6466		6121		5664		5166		-		-		-		-		-	
			13.3	0.62	12.5	0.66	11.6	0.70	10.9	0.73	-		-		-		-		-	
1	600	4359	6670		6345		5915		5430		3890		-		-		-		-	
			13.8	0.67	13.1	0.71	12.2	0.76	11.4	0.79	10.8	0.79	-		-		-		-	
	620	4504	6912		6593		6188		5744		4473		-		-		-		-	
			14.4	0.73	13.9	0.78	13.0	0.83	12.1	0.87	11.3	0.90	-		-		-		-	
	642	4666	7182		6875		6501		6079		4967		-		-		-		-	
			15.0	0.81	14.5	0.86	13.8	0.91	12.9	0.95	11.9	1.00	-		-		-		-	
1 1/2	660	4795	7398		7099		6748		6340		5356		-		-		-		-	
			15.4	0.87	15.0	0.93	14.3	0.98	13.5	1.02	12.4	1.09	-		-		-		-	
	685	4976	7701		7412		7093		6702		5830		4186		-		-		-	
			16.2	0.97	15.9	1.03	15.3	1.08	14.5	1.13	13.1	1.20	13.1	1.15	-		-		-	
	710	5158	8003		7724		7434		7061		6253		5029		-		-		-	
			17.2	1.08	16.9	1.14	16.4	1.19	15.7	1.24	14.2	1.33	13.7	1.21	-		-		-	
	735	5341	8306		8036		7775		7417		6654		5594		-		-		-	
			18.3	1.19	18.1	1.25	17.7	1.31	17.0	1.37	15.6	1.46	14.7	1.50	-		-		-	
2	750	5449	8484		8220		7975		7624		6888		5921		-		-		-	
			18.9	1.26	18.7	1.33	18.4	1.38	17.7	1.44	16.3	1.54	15.2	1.64	-		-		-	
	770	5594	8724		8467		8210		7901		7201		6339		4824		-		-	
			19.7	1.36	19.5	1.43	19.0	1.49	18.5	1.55	17.2	1.65	15.9	1.72	15.8	1.65	-		-	
	790	5739	8964		8713		8463		8177		7497		6714		5514		-		-	
			20.0	1.47	20.0	1.54	19.9	1.60	19.4	1.66	18.0	1.77	16.7	1.85	16.3	1.99	-		-	
	809	5877	9192		8947		8702		8437		7775		7046		5967		-		-	
			21.0	1.57	21.0	1.64	20.0	1.71	20.0	1.77	18.7	1.88	17.4	1.97	16.9	1.99	-		-	
3	840	6102	9562		9326		9091		8856		8224		7543		6652		5163		-	
			22.0	1.75	22.0	1.83	22.0	1.90	21.0	1.96	20.0	2.08	18.9	2.18	17.9	2.24	18.1	2.13	-	
	870	6320	9920		9692		9465		9238		8654		8016		7259		6171		-	
			24.0	1.94	23.0	2.02	23.0	2.09	23.0	2.16	22.0	2.29	21.0	2.40	19.0	2.47	19.0	2.49	-	
	900	6538	10278		10057		9838		9618		9078		8476		7805		6843		-	
			25.0	2.15	25.0	2.23	25.0	2.30	24.0	2.37	24.0	2.51	22.0	2.63	21.0	2.72	20.0	2.75	-	
	926	6727	10587		10373		10159		9946		9441		8858		8224		7414		-	
			27.0	2.33	27.0	2.42	26.0	2.49	26.0	2.56	25.0	2.71	24.0	2.84	23.0	2.93	21.0	2.99	-	
5	960	6974	10992		10785		10579		10373		9910		9353		8763		8082		5611	
			29.0	2.59	29.0	2.68	28.0	2.76	28.0	2.84	27.0	2.98	26.0	3.12	25.0	3.24	23.0	3.27	23.0	3.14
	1000	7265	11467		11268		11078		10872		10458		9927		9385		8778		7000	
			31.0	2.92	30.0	3.02	30.0	3.10	30.0	3.18	29.0	3.33	28.0	3.48	27.0	3.62	25.0	3.71	24.0	3.75
	1040	7555	11941		11750		11559		11369		10889		10493		9973		9416		7919	
			32.0	3.28	31.0	3.38	31.0	3.47	31.0	3.55	30.0	3.71	29.0	3.87	28.0	4.01	27.0	4.13	25.0	4.24
	1098	7977	12627		12447		12266		12086		11726		11299		10812		10318		9135	
			34.0	3.84	34.0	3.95	34.0	4.05	33.0	4.14	33.0	4.61	32.0	4.48	31.0	4.63	30.0	4.78	27.0	4.98

Performance shown is for installation type A: Free Inlet, Free Outlet. Power rating (BHP) does not include drive losses. For further information on estimating belt drive losses and motor service factors see page 11. The sound ratings shown are for loudness values in fan sones at 5'0" (1.5m) in a hemispherical free field per AMCA Standard 301. Values shown are for installation Type A: free inlet sone levels. Performance ratings do not include the effects of appurtenances in the airstream.

©PENN BARRY 2009

DX30B Belt Drive Fan Curves

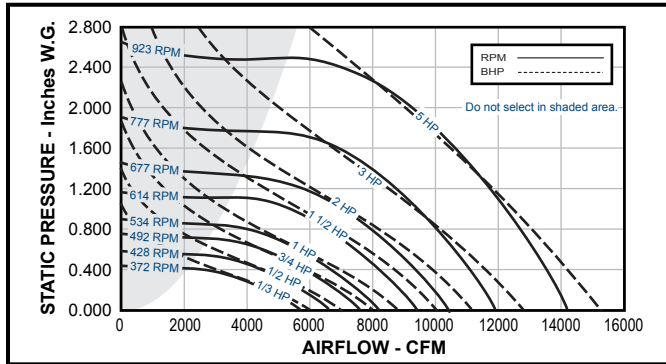

DX30B Belt Drive Fan Dimensional Data

Galv. Steel Base = 14 Gage
Aluminum Base = 0.102"
Discharge Apron = 0.080"
Roof Opening = 28" SQ.
Damper Size = 27 3/4" SQ.
Max. Motor Frame Size = 184T
Peak BHP = (RPM/534) ³
Max. RPM = 999 (5 HP)
Est. Ship Weight = 210 lbs.

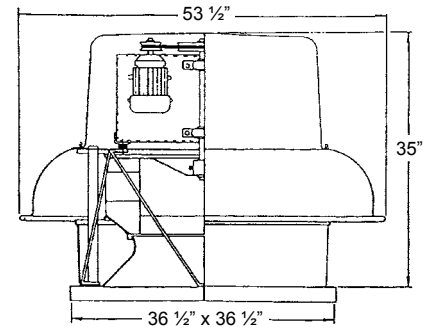

Centrifugal Fans

DX30B Belt Drive Fan Performance Data

HP	RPM	Tip Speed FPM	0.000" SP		0.125" SP		0.250" SP		0.375" SP		0.500" SP		0.625" SP		0.750" SP		1.000" SP		1.250" SP		1.500" SP			
			Sones	BHP	Sones	BHP	Sones	BHP	Sones	BHP	Sones	BHP	Sones	BHP	Sones	BHP	Sones	BHP	Sones	BHP	Sones	BHP	Sones	BHP
1/3	225	1804	3480	2165	-	-	-	-	-	-	-	-	-	-	-	-	-	-	-	-	-	-	-	
			2.9	0.06	2.0	0.07	-	-	-	-	-	-	-	-	-	-	-	-	-	-	-	-	-	-
	300	2405	4640	3849	2423	-	-	-	-	-	-	-	-	-	-	-	-	-	-	-	-	-	-	-
5.8			0.14	5.1	0.17	4.3	0.17	-	-	-	-	-	-	-	-	-	-	-	-	-	-	-	-	-
1/2	372	2983	5753	5164	4386	3184	-	-	-	-	-	-	-	-	-	-	-	-	-	-	-	-	-	
			8.7	0.27	8.0	0.30	7.4	0.33	6.6	0.32	-	-	-	-	-	-	-	-	-	-	-	-	-	-
	405	3247	6264	5732	5073	4186	-	-	-	-	-	-	-	-	-	-	-	-	-	-	-	-	-	-
9.7			0.35	8.9	0.38	8.2	0.42	7.5	0.43	-	-	-	-	-	-	-	-	-	-	-	-	-	-	-
3/4	460	3688	6619	6120	5514	4747	3627	-	-	-	-	-	-	-	-	-	-	-	-	-	-	-	-	
			10.4	0.41	9.7	0.45	9.0	0.49	8.3	0.51	7.4	0.49	-	-	-	-	-	-	-	-	-	-	-	-
	480	3848	7114	6653	6114	5468	4618	-	-	-	-	-	-	-	-	-	-	-	-	-	-	-	-	-
11.7			0.51	10.8	0.55	10.0	0.59	9.3	0.63	8.5	0.63	-	-	-	-	-	-	-	-	-	-	-	-	-
1	520	4169	7424	6985	6478	5897	5147	4103	-	-	-	-	-	-	-	-	-	-	-	-	-	-	-	-
			12.6	0.57	11.5	0.62	10.5	0.66	9.9	0.71	9.0	0.72	8.4	0.70	-	-	-	-	-	-	-	-	-	-
	534	4281	7609	7183	6695	6136	5430	4490	-	-	-	-	-	-	-	-	-	-	-	-	-	-	-	-
13.1			0.62	12.1	0.67	11.0	0.71	10.3	0.76	9.4	0.78	8.7	0.76	-	-	-	-	-	-	-	-	-	-	-
1 1/2	560	4490	8042	7642	7195	6674	6071	5324	4225	-	-	-	-	-	-	-	-	-	-	-	-	-	-	-
			14.1	0.73	13.3	0.79	12.4	0.83	11.6	0.87	10.8	0.91	9.9	0.92	8.9	0.87	-	-	-	-	-	-	-	-
	580	4650	8259	7871	7443	6939	6375	5691	4760	-	-	-	-	-	-	-	-	-	-	-	-	-	-	-
14.7			0.79	13.9	0.85	13.2	0.89	12.4	0.94	11.6	0.98	10.6	1.00	9.5	0.97	-	-	-	-	-	-	-	-	-
2	640	5131	8661	8295	7890	7427	6927	6303	5559	-	-	-	-	-	-	-	-	-	-	-	-	-	-	-
			15.4	0.91	14.8	0.98	14.2	1.02	13.4	1.06	12.7	1.12	11.8	1.14	10.7	1.14	-	-	-	-	-	-	-	-
	660	5292	8971	8617	8229	7792	7315	6757	6115	-	-	-	-	-	-	-	-	-	-	-	-	-	-	-
16.1			1.01	15.5	1.08	14.9	1.13	14.2	1.17	13.5	1.23	12.7	1.26	11.7	1.28	-	-	-	-	-	-	-	-	-
3	710	5693	9280	8938	8566	8153	7698	7192	6590	4847	-	-	-	-	-	-	-	-	-	-	-	-	-	-
			16.8	1.12	16.2	1.19	15.6	1.24	15.0	1.29	14.3	1.34	13.5	1.39	12.5	1.41	10.4	1.33	-	-	-	-	-	-
	735	5893	9496	9162	8801	8405	7964	7493	6917	5412	-	-	-	-	-	-	-	-	-	-	-	-	-	-
17.4			1.20	16.9	1.27	16.2	1.32	15.6	1.37	14.9	1.43	14.2	1.49	13.2	1.50	10.9	1.47	-	-	-	-	-	-	-
5	815	6534	9899	9578	9234	8868	8452	8015	7504	6230	-	-	-	-	-	-	-	-	-	-	-	-	-	-
			18.4	1.36	17.9	1.44	17.3	1.49	16.8	1.54	16.1	1.59	15.3	1.66	14.5	1.69	12.3	1.69	-	-	-	-	-	-
	845	6775	10208	9897	9567	9222	8820	8400	7937	6798	4544	-	-	-	-	-	-	-	-	-	-	-	-	-
19.1			1.49	18.6	1.57	18.1	1.63	17.6	1.68	17.0	1.73	16.2	1.80	15.4	1.85	13.4	1.88	11.5	1.62	-	-	-	-	-
5	875	7015	10471	10168	9848	9513	9129	8724	8302	7235	5744	-	-	-	-	-	-	-	-	-	-	-	-	-
			19.5	1.61	19.0	1.69	18.6	1.75	18.2	1.80	17.7	1.86	16.9	1.92	16.1	1.99	14.2	2.03	12.5	1.96	-	-	-	-
	905	7256	10981	10692	10392	10073	9723	9346	8952	8011	6801	-	-	-	-	-	-	-	-	-	-	-	-	-
20.0			1.86	19.9	1.94	19.5	2.01	19.1	2.06	18.7	2.12	18.1	2.18	17.3	2.26	15.6	2.32	14.0	2.30	-	-	-	-	-
5	923	7400	11368	11089	10802	10494	10169	9808	9431	8577	7519	5947	-	-	-	-	-	-	-	-	-	-	-	-
			21.0	2.06	21.0	2.15	20.0	2.22	20.0	2.28	19.6	2.33	19.1	2.39	18.3	2.47	16.8	2.56	15.0	2.59	13.8	2.45	-	-
	923	7400	11755	11485	11210	10912	10611	10263	9905	9120	8163	6886	-	-	-	-	-	-	-	-	-	-	-	-
22.0			2.28	22.0	2.37	21.0	2.45	21.0	2.51	21.0	2.56	20.0	2.63	19.4	2.70	17.9	2.83	16.3	2.87	14.8	2.79	-	-	-
5	815	6534	12018	11754	11488	11196	10905	10569	10224	9485	8564	7426	-	-	-	-	-	-	-	-	-	-	-	-
			23.0	2.44	22.0	2.53	22.0	2.61	22.0	2.67	21.0	2.73	21.0	2.79	20.0	2.86	18.7	3.01	17.1	3.06	15.5	3.01	-	-
	845	6775	12605	12354	12102	11827	11549	11249	10924	10244	9441	8513	-	-	-	-	-	-	-	-	-	-	-	-
24.0			2.81	24.0	2.91	23.0	3.00	23.0	3.06	23.0	3.12	23.0	3.19	22.0	3.25	21.0	3.42	18.8	3.50	17.2	3.55	-	-	-
5	875	7015	13069	12827	12584	12323	12055	11781	11467	10819	10095	9237	-	-	-	-	-	-	-	-	-	-	-	-
			25.0	3.14	25.0	3.23	25.0	3.33	25.0	3.40	25.0	3.46	24.0	3.53	24.0	3.60	23.0	3.76	21.0	3.89	18.5	3.94	-	-
	905	7256	13533	13299	13065	12817	12558	12299	12006	11389	10739	9937	-	-	-	-	-	-	-	-	-	-	-	-
26.0			3.48	26.0	3.58	26.0	3.68	26.0	3.76	26.0	3.83	26.0	3.89	26.0	3.96	24.0	4.12	23.0	4.30	20.0	4.34	-	-	-
5	815	6534	13997	13771	13544	13308	13058	12808	12540	11952	11333	10610	-	-	-	-	-	-	-	-	-	-	-	-
			28.0	3.85	28.0	3.96	28.0	4.06	27.0	4.15	27.0	4.22	27.0	4.28	27.0	4.35	26.0	4.50	24.0	4.70	22.0	4.79	-	-
	923	7400	14276	14054	13831	13603	13357	13112	12859	12284	11680	11001	-	-	-	-	-	-	-	-	-	-	-	-
29.0			4.09	29.0	4.19	29.0	4.30	28.0	4.39	28.0	4.46	28.0	4.53	28.0	4.60	27.0	4.75	25.0	4.95	23.0	5.07	-	-	-

Performance shown is for installation type A: Free Inlet, Free Outlet. Power rating (BHP) does not include drive losses. For further information on estimating belt drive losses and motor service factors see page 11. The sound ratings shown are for loudness values in fan sones at 50' (1.5m) in a hemispherical free field per AMCA Standard 301. Values shown are for installation Type A: free inlet sone levels. Performance ratings do not include the effects of appurtenances in the airstream.

Dimensional Information & Performance Data

Domex Centrifugal Fans | Belt Drive



DX36B

DX36B Belt Drive Fan Curves

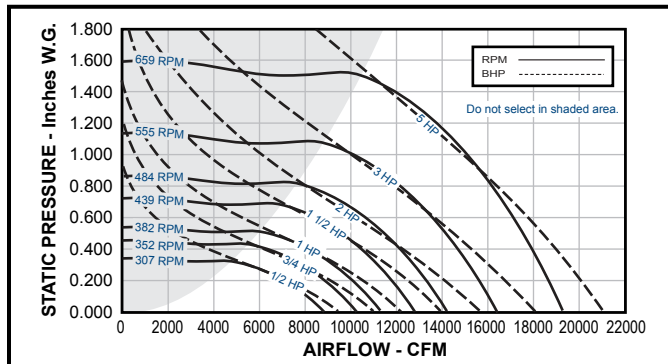

DX36B Belt Drive Fan Dimensional Data

Galv. Steel Base = 12 Gage
Aluminum Base = 0.102"
Discharge Apron = 0.080"
Roof Opening = 36" SQ.
Damper Size = 35 1/2" SQ.
Max. Motor Frame Size = 213T
Peak BHP = (RPM/381) ³
Max. RPM = 810 (7 1/2 HP)
Est. Ship Weight = 420 lbs.

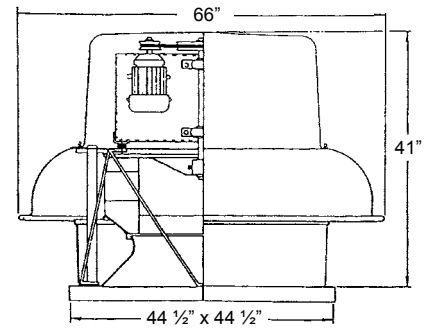

DX36B Belt Drive Fan Performance Data

HP	RPM	Tip Speed FPM	0.000" SP		0.125" SP		0.250" SP		0.375" SP		0.500" SP		0.625" SP		0.750" SP		1.000" SP		1.250" SP		1.500" SP		
			Sones	BHP	Sones	BHP	Sones	BHP	Sones	BHP	Sones	BHP	Sones	BHP	Sones	BHP	Sones	BHP	Sones	BHP	Sones	BHP	Sones
1/2	215	2093	6343	0.13	4855	0.18	-	-	-	-	-	-	-	-	-	-	-	-	-	-	-	-	-
	261	2541	7700	0.24	6555	0.30	4707	0.31	-	-	-	-	-	-	-	-	-	-	-	-	-	-	-
			9057	0.39	8105	0.46	6994	0.51	-	-	-	-	-	-	-	-	-	-	-	-	-	-	-
3/4	325	3164	9588	0.46	8714	0.53	7701	0.60	6101	0.61	-	-	-	-	-	-	-	-	-	-	-	-	-
	340	3310	10031	0.53	9216	0.59	8248	0.68	6922	0.71	-	-	-	-	-	-	-	-	-	-	-	-	-
			10385	0.58	9613	0.65	8675	0.74	7497	0.79	-	-	-	-	-	-	-	-	-	-	-	-	-
1	365	3553	10768	0.65	10037	0.72	9130	0.82	8086	0.87	6338	0.85	-	-	-	-	-	-	-	-	-	-	-
	375	3651	11063	0.71	10362	0.78	9469	0.88	8523	0.94	7027	0.93	-	-	-	-	-	-	-	-	-	-	-
			11270	0.75	10589	0.82	9705	0.92	8809	0.99	7438	1.00	-	-	-	-	-	-	-	-	-	-	-
1 1/2	400	3894	11801	0.86	11169	0.93	10314	1.04	9503	1.11	8351	1.16	-	-	-	-	-	-	-	-	-	-	-
	415	4040	12243	0.96	11643	1.04	10821	1.14	10050	1.23	9052	1.26	7592	1.26	-	-	-	-	-	-	-	-	-
			12686	1.06	12115	1.15	11324	1.26	10586	1.35	9711	1.42	8478	1.42	-	-	-	-	-	-	-	-	-
	430	4186	12951	1.13	12397	1.23	11627	1.33	10904	1.43	10089	1.50	8939	1.53	-	-	-	-	-	-	-	-	-
2	455	4430	13423	1.26	12896	1.36	12168	1.46	11453	1.57	10719	1.65	9706	1.71	8341	1.66	-	-	-	-	-	-	-
	470	4576	13866	1.39	13364	1.50	12671	1.58	11959	1.71	11271	1.80	10386	1.87	9229	1.86	-	-	-	-	-	-	-
			14279	1.52	13798	1.63	13139	1.71	12432	1.85	11778	1.95	10998	2.02	9945	2.06	-	-	-	-	-	-	-
3	505	4916	14899	1.72	14449	1.85	13830	1.92	13143	2.07	12523	2.18	11839	2.26	10942	2.34	-	-	-	-	-	-	-
	525	5111	15489	1.94	15061	2.07	14481	2.14	13814	2.29	13212	2.42	12584	2.51	11822	2.58	9607	2.55	-	-	-	-	-
			15931	2.11	15515	2.24	14968	2.32	14319	2.46	13718	2.60	13128	2.71	12449	2.78	10507	2.81	-	-	-	-	-
	555	5403	16374	2.29	15969	2.43	15452	2.50	14826	2.65	14223	2.80	13662	2.91	13039	3.00	11292	3.09	-	-	-	-	-
5	575	5598	16964	2.55	16573	2.69	16091	2.77	15498	2.90	14902	3.07	14364	3.20	13781	3.30	12252	3.45	9844	3.30	-	-	-
	595	5793	17554	2.82	17177	2.97	16721	3.06	16166	3.17	15575	3.36	15043	3.46	14505	3.62	13160	3.79	11240	3.74	-	-	-
			18144	3.12	17779	3.27	17349	3.37	16824	3.48	16245	3.66	15715	3.82	15214	4.13	14033	4.19	12346	4.19	-	-	-
	630	6133	18586	3.35	18230	3.51	17818	3.62	17314	3.72	16753	3.90	16225	4.07	15740	4.21	14630	4.41	13087	4.53	10793	4.34	-
			19029	3.59	18681	3.75	18286	3.87	17801	3.97	17260	4.14	16733	4.32	16249	4.48	15218	4.69	13799	4.87	11892	4.74	-
	645	6279	19442	3.83	19101	4.00	18722	4.13	18255	4.22	17730	4.38	17205	4.57	16722	4.74	15732	4.97	14438	5.17	12737	5.10	-
	659	6416	20000	4.00	19500	4.13	19000	4.22	18500	4.38	18000	4.57	17500	4.74	17000	4.97	16500	5.17	16000	5.17	15500	5.10	-

Performance shown is for installation type A: Free Inlet, Free Outlet. Power rating (BHP) does not include drive losses. For further information on estimating belt drive losses and motor service factors see page 11. The sound ratings shown are for loudness values in fan sones at 5' (1.5m) in a hemispherical free field per AMCA Standard 301. Values shown are for installation Type A: free inlet sone levels. Performance ratings do not include the effects of appurtenances in the airstream.

KB420 Belt Drive Fan Curves

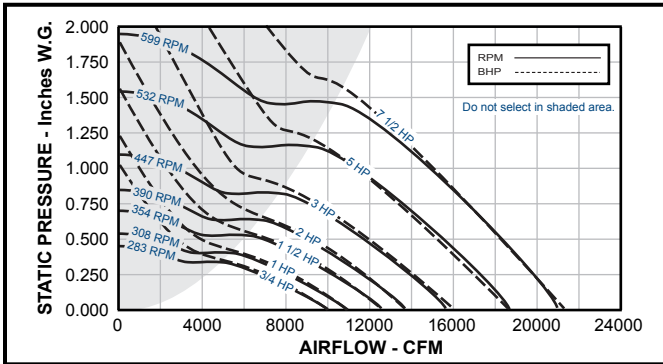

KB420 Belt Drive Fan Dimensional Data

Galv. Steel Base = N/A
Aluminum Base = 0.125"
Discharge Apron = 0.080"
Roof Opening = 44" SQ.
Damper Size = 43 1/2" SQ.
Max. Motor Frame Size = 213T
Peak BHP = (RPM/315) ³
Max. RPM = 600 (7 1/2 HP)
Est. Ship Weight = 600 lbs.

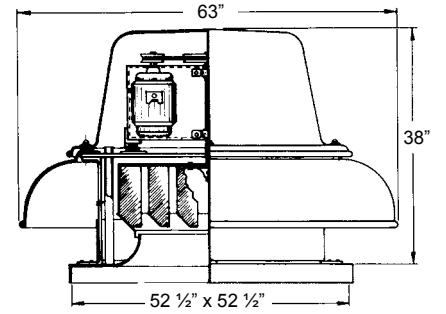

Centrifugal Fans

KB420 Belt Drive Fan Performance Data

HP	RPM	Tip Speed FPM	0.000" SP		0.125" SP		0.250" SP		0.375" SP		0.500" SP		0.625" SP		0.750" SP		1.000" SP		1.250" SP									
			Sones	BHP	Sones	BHP	Sones	BHP	Sones	BHP	Sones	BHP	Sones	BHP	Sones	BHP	Sones	BHP	Sones	BHP								
3/4	240	2733	8452		6624		-		-		-		-		-		-		-									
			6.2	0.48	6.1	0.49	-		-		-		-		-		-		-									
	260	2961	9157		7503		5322		-		-		-		-		-		-									
6.9			0.61	6.7	0.61	6.4	0.59	-		-		-		-		-		-										
1	283	3223	9967		8479		6607		-		-		-		-		-		-									
			7.6	0.77	7.4	0.78	7.1	0.77	-		-		-		-		-		-									
			10389		8970		7252		-		-		-		-		-		-		-							
1	300	3416	10566		9173		7514		-		-		-		-		-		-									
			8.2	0.92	7.9	0.93	7.6	0.92	-		-		-		-		-		-									
			10847		9497		7905		5889		-		-		-		-		-		-							
1 1/2	330	3758	11622		10376		8942		7177		-		-		-		-		-									
			9.1	1.21	8.7	1.23	8.4	1.23	8.0	1.19	-		-		-		-		-									
			12150		10959		9619		8005		-		-		-		-		-		-							
1 1/2	345	3929	9.5	1.38	9.1	1.40	8.8	1.40	8.3	1.37	-		-		-		-		-									
			12467		11307		10017		8492		6700		-		-		-		-		-							
			9.8	1.49	9.4	1.51	9.0	1.51	8.6	1.49	8.4	1.42	-		-		-		-		-							
2	365	4157	12855		11729		10495		9078		7365		-		-		-		-									
			10.2	1.63	9.9	1.65	9.5	1.65	9.1	1.64	8.8	1.58	-		-		-		-									
			13383		12302		11139		9817		8229		-		-		-		-		-							
2	380	4328	10.8	1.84	10.4	1.86	10.0	1.86	9.6	1.85	9.2	1.80	-		-		-		-									
			13735		12682		11565		10299		8785		7013		-		-		-		-							
			11.2	1.98	10.7	2.01	10.3	2.01	10.0	2.00	9.6	1.96	9.5	1.86	-		-		-		-							
3	420	4783	14792		13813		12800		11667		10405		8927		-		-		-									
			12.2	2.47	11.8	2.49	11.3	2.51	11.0	2.50	10.7	2.48	10.4	2.42	-		-		-		-							
			15144		14188		13205		12112		10908		9488		7987		-		-		-		-					
3	430	4897	12.6	2.65	12.1	2.67	11.6	2.69	11.3	2.68	11.1	2.67	10.8	2.61	10.8	2.51	-		-		-							
			15496		14562		13609		12549		11394		10040		8597		-		-		-		-					
			13.0	2.83	12.5	2.86	12.0	2.88	11.6	2.87	11.4	2.86	11.2	2.81	11.1	2.72	-		-		-							
3	440	5011	15743		14824		13889		12852		11732		10422		9019		-		-		-							
			13.2	2.97	12.7	2.99	12.2	3.01	11.8	3.01	11.6	3.00	11.4	2.95	11.3	2.87	-		-		-							
			16201		15307		14409		13412		12342		11123		9775		-		-		-		-					
5	460	5239	13.6	3.23	13.2	3.26	12.7	3.28	12.2	3.27	12.0	3.27	11.9	3.23	11.7	3.16	-		-		-							
			16905		16049		15193		14263		13249		12158		10889		-		-		-		-					
			14.3	3.67	13.8	3.69	13.3	3.72	12.7	3.72	12.6	3.71	12.5	3.69	12.3	3.63	-		-		-							
5	500	5694	17610		16788		15966		15089		14138		13128		11976		9436		-		-		-					
			14.9	4.14	14.4	4.17	13.9	4.20	13.3	4.20	13.1	4.19	13.0	4.18	12.9	4.13	12.8	3.94	-		-		-					
			18314		17524		16733		15904		15007		14059		13033		10644		-		-		-		-			
5	520	5922	15.5	4.65	15.0	4.68	14.4	4.71	13.9	4.72	13.6	4.71	13.5	4.70	13.4	4.68	13.3	4.52	-		-		-					
			18737		17964		17192		16390		15523		14603		13621		11334		-		-		-		-			
			15.9	4.97	15.3	5.01	14.8	5.04	14.2	5.05	13.8	5.04	13.8	5.03	13.7	5.02	13.6	4.87	-		-		-		-			
7 1/2	555	6320	19547		18806		18066		17313		16501		15631		14730		12614		10301		-		-		-			
			16.7	5.64	16.1	5.68	15.5	5.71	14.9	5.73	14.3	5.72	14.3	5.71	14.2	5.71	14.2	5.59	14.2	5.35	-		-		-			
			20075		19354		18633		17910		17122		16286		15417		13432		11218		-		-		-		-	
7 1/2	570	6491	17.2	6.11	16.6	6.14	16.0	6.18	15.3	6.21	14.7	6.20	14.6	6.19	14.5	6.18	14.5	6.09	14.5	5.88	-		-		-			
			20603		19901		19198		18496		17737		16935		16097		14238		12116		-		-		-		-	
			17.8	6.60	17.2	6.64	16.6	6.67	16.0	6.71	15.4	6.70	15.1	6.69	15.1	6.68	15.1	6.61	15.1	6.44	-		-		-		-	
7 1/2	585	6662	21096		20410		19724		19038		18306		17535		16725		14978		12909		-		-		-		-	
			18.5	7.08	17.9	7.12	17.3	7.16	16.7	7.19	16.1	7.19	15.7	7.18	15.7	7.17	15.7	7.13	15.7	6.95	-		-		-		-	

Performance shown is for installation type A: Free Inlet, Free Outlet. Power rating (BHP) does not include drive losses. For further information on estimating belt drive losses and motor service factors see page 11. The sound ratings shown are for loudness values in fan sones at 5'0" (1.5m) in a hemispherical free field per AMCA Standard 301. Values shown are for installation Type A: free inlet sone levels. Performance ratings do not include the effects of appurtenances in the airstream.

Dimensional Information & Performance Data

Domex Centrifugal Fans | Belt Drive



JB48

Centrifugal Fans

JB48 Belt Drive Fan Curves

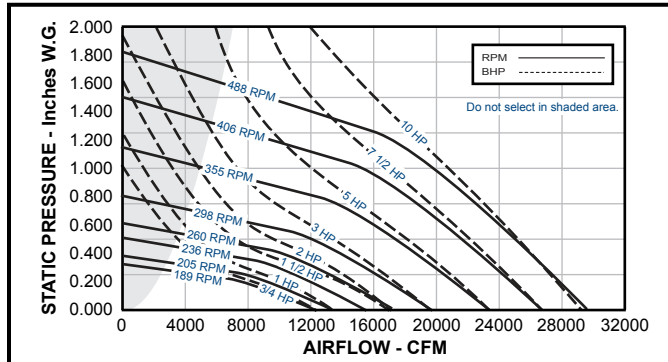

JB48 Belt Drive Fan Dimensional Data

Galv. Steel Base = N/A
Aluminum Base = 0.125"
Discharge Apron = 0.102"
Roof Opening = 50" SQ.
Damper Size = 49 1/2" SQ.
Max. Motor Frame Size = 215T
Peak BHP = (RPM/206) ³
Max. RPM = 449 (10 HP)
Est. Ship Weight = 775 lbs.

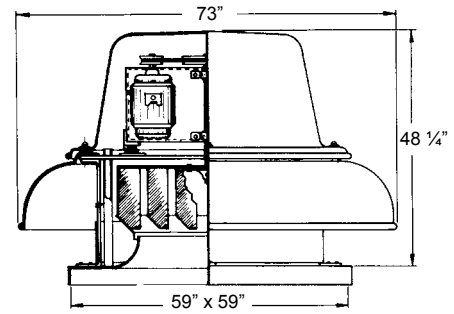

JB48 Belt Drive Fan Performance Data

HP	RPM	Tip Speed FPM	0.000" SP		0.125" SP		0.250" SP		0.375" SP		0.500" SP		0.625" SP		0.750" SP		1.000" SP		1.250" SP		1.500" SP																					
			Sones	BHP	Sones	BHP	Sones	BHP	Sones	BHP	Sones	BHP	Sones	BHP	Sones	BHP	Sones	BHP	Sones	BHP	Sones	BHP	Sones	BHP																		
3/4	160	2105	11842		7937		-		-		-		-		-		-		-		-																					
			4.6	0.47	4.4	0.42	-		-		-		-		-		-		-		-																					
	175	2302	12953		9473		-		-		-		-		-		-		-		-		-																			
5.4			0.62	5.2	0.57	-		-		-		-		-		-		-		-		-																				
1	189	2486	13989		10828		5936		-		-		-		-		-		-		-		-																			
			6.0	0.78	5.7	0.73	5.7	0.55	-		-		-		-		-		-		-		-																			
			14433		11397		7183		-		-		-		-		-		-		-		-		-																	
1	200	2631	14803		11865		8089		-		-		-		-		-		-		-		-																			
			6.5	0.92	6.2	0.88	6.0	0.75	-		-		-		-		-		-		-		-																			
			15173		12308		8799		-		-		-		-		-		-		-		-		-																	
1 1/2	215	2828	15913		13183		9999		-		-		-		-		-		-		-		-																			
			7.2	1.14	6.8	1.10	6.6	0.99	-		-		-		-		-		-		-		-																			
			16654		14046		11088		5724		-		-		-		-		-		-		-		-																	
1 1/2	225	2960	7.6	1.31	7.2	1.26	6.9	1.16	6.8	0.80	-		-		-		-		-		-																					
			17468		14983		12267		8231		-		-		-		-		-		-		-																			
2	245	3223	18134		15742		13155		9914		-		-		-		-		-		-		-																			
			8.5	1.69	8.0	1.65	7.7	1.56	7.3	1.38	-		-		-		-		-		-		-																			
			18874		16577		14131		11319		5416		-		-		-		-		-		-		-																	
2	255	3355	8.9	1.90	8.4	1.86	8.0	1.78	7.6	1.63	7.6	1.01	-		-		-		-		-		-																			
			19244		16992		14615		11878		6656		-		-		-		-		-		-		-																	
			9.1	2.02	8.6	1.98	8.2	1.89	7.8	1.74	7.7	1.24	-		-		-		-		-		-																			
3	270	3552	19984		17817		15572		12978		8983		-		-		-		-		-		-																			
			9.5	2.26	9.0	2.22	8.6	2.14	8.1	1.99	7.9	1.66	-		-		-		-		-		-																			
			20725		18637		16515		14055		11032		4757		-		-		-		-		-		-																	
			9.9	2.52	9.5	2.48	9.0	2.40	8.5	2.26	8.1	2.04	8.1	1.10	-		-		-		-		-																			
			21465		19457		17414		15124		12455		7271		-		-		-		-		-		-																	
3	280	3684	22057		20091		18116		15911		13468		9191		-		-		-		-		-																			
			11.0	3.04	10.4	3.00	9.9	2.92	9.5	2.79	9.0	2.61	8.9	2.13	-		-		-		-		-																			
			23315		21458		19589		17568		15336		12614		7315		-		-		-		-		-																	
5	315	4144	11.8	3.59	11.3	3.55	10.8	3.47	10.2	3.36	9.8	3.18	9.5	2.93	9.5	2.06	-		-		-		-																			
			24425		22655		20871		19007		16935		14702		10848		-		-		-		-		-																	
			12.6	4.13	12.0	4.09	11.4	4.00	10.9	3.90	10.5	3.73	10.1	3.53	10.0	3.00	-		-		-		-																			
			25536		23842		22138		20420		18461		16365		13809		-		-		-		-		-																	
			13.4	4.72	12.7	4.68	12.1	4.59	11.6	4.49	11.1	4.33	10.8	4.13	10.6	3.84	-		-		-		-																			
7 1/2	335	4670	26276		24629		22975		21312		19437		17450		15230		6228		-		-		-																			
			13.9	5.14	13.3	5.10	12.6	5.01	12.0	4.91	11.4	4.78	11.2	4.57	11.0	4.32	11.0	2.31	-		-		-																			
			27386		25805		24222		22626		20891		19045		17054		9969		-		-		-		-																	
			14.7	5.82	14.0	5.77	13.3	5.70	12.7	5.59	12.0	5.46	11.7	5.26	11.6	5.04	11.5	3.71	-		-		-																			
			28496		26976		25458		23923		22322		20569		18696		13361		-		-		-		-																	
7 1/2	370	4868	15.3		6.56		14.7		6.51		14.0		6.44		13.4		6.33		12.7		6.20		12.2		6.01		12.1		5.80		11.9		4.94		-		-					
			29237		27756		26276		24781		23263		21544		19772		15418		6502		-		-		-		-		-		-		-		-							
			15.8	7.08	15.1	7.03	14.5	6.96	13.8	6.85	13.1	6.73	12.5	6.57	12.4	6.34	12.3	5.70	12.3	3.00	-		-		-		-		-		-		-									
10	406	5341	30051		28611		27181		25718		24263		22617		20941		17033		9283		-		-		-		-		-		-		-									
			16.3	7.69	15.6	7.64	14.9	7.59	14.3	7.46	13.6	7.34	12.9	7.18	12.8	6.95	12.6	6.39	12.6	4.36	-		-		-		-		-		-		-									
			31457		30084		28700		27320		25931		24440		22849		19444		13785		-		-		-		-		-		-		-		-		-					
10	425	5591	17.3		8.82		16.5		8.76		15.8		8.71		15.1		8.59		14.4		8.47		13.8		8.32		13.3		8.12		13.2		7.61		13.2		6.37		-			
			33160		31860		30548		29239		27920		26602		25090		21961		18201		10947		-		-		-		-		-		-		-		-		-			
10	448	5894	18.5		10.33		17.8		10.27		17.2		10.22		16.7		10.10		16.1		9.98		15.6		9.85		15.1		9.67		14.9		9.17		14.9		8.47		14.9		6.18	

Performance shown is for installation type A: Free Inlet, Free Outlet. Power rating (BHP) does not include drive losses. For further information on estimating belt drive losses and motor service factors see page 11. The sound ratings shown are for loudness values in fan sones at 5'0" (1.5m) in a hemispherical free field per AMCA Standard 301. Values shown are for installation Type A: free inlet sone levels. Performance ratings do not include the effects of appurtenances in the airstream.

› MB542 Belt Drive Fan Curves

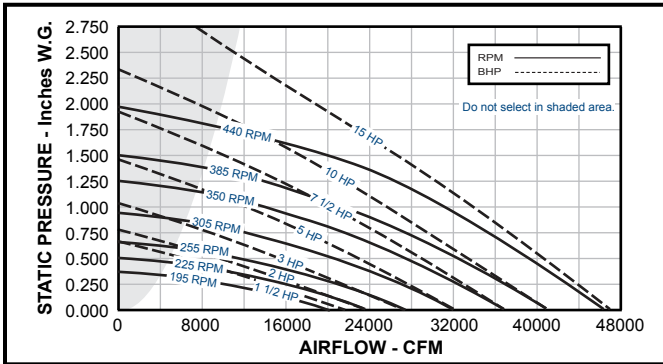

› MB542 Belt Drive Fan Dimensional Data

Galv. Steel Base = N/A
Aluminum Base = 0.125
Discharge Apron = 0.188"
Roof Opening = 55" SQ.
Damper Size = 54 1/2" SQ.
Max. Motor Frame Size = 254T
Peak BHP = (RPM/182) ³
Max. RPM = 440 (15 HP)
Est. Ship Weight = 1500 lbs.

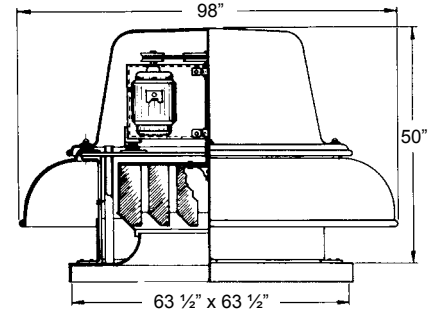

Centrifugal Fans

› MB542 Belt Drive Fan Performance Data

HP	RPM	Tip Speed FPM	0.000" SP		0.125" SP		0.250" SP		0.375" SP		0.500" SP		0.625" SP		0.750" SP		1.000" SP		1.250" SP		1.500" SP		
			Sones	BHP	Sones	BHP	Sones	BHP	Sones	BHP	Sones	BHP	Sones	BHP	Sones	BHP	Sones	BHP	Sones	BHP	Sones	BHP	Sones
1 1/2	165	2505	17490		12624		3878		-		-		-		-		-		-		-		-
			6.0	0.77	5.8	0.72	5.4	0.49	-	-	-	-	-	-	-	-	-	-	-	-	-	-	-
	175	2657	18550		14026		6748		-		-		-		-		-		-		-		-
			6.6	0.92	6.3	0.89	5.9	0.68	-	-	-	-	-	-	-	-	-	-	-	-	-	-	-
2	185	2809	19610		15355		9323		-		-		-		-		-		-		-		-
			7.1	1.08	6.8	1.07	6.4	0.87	-	-	-	-	-	-	-	-	-	-	-	-	-	-	-
	195	2961	20670		16635		11589		-		-		-		-		-		-		-		-
			7.6	1.27	7.3	1.26	6.9	1.11	-	-	-	-	-	-	-	-	-	-	-	-	-	-	-
3	215	3265	22790		19135		15017		8447		-		-		-		-		-		-		-
			8.6	1.70	8.2	1.71	7.8	1.54	7.5	1.23	-	-	-	-	-	-	-	-	-	-	-	-	-
	220	3341	23320		19749		15820		9760		-		-		-		-		-		-		-
			8.9	1.82	8.5	1.84	8.1	1.67	7.6	1.38	-	-	-	-	-	-	-	-	-	-	-	-	-
5	225	3416	23849		20359		16614		11025		-		-		-		-		-		-		-
			9.1	1.95	8.7	1.97	8.3	1.80	7.8	1.55	-	-	-	-	-	-	-	-	-	-	-	-	-
	235	3568	24909		21569		18094		13452		6014		-		-		-		-		-		-
			9.6	2.22	9.2	2.25	8.8	2.10	8.2	1.92	8.1	1.44	-	-	-	-	-	-	-	-	-	-	-
7 1/2	240	3644	25440		22170		18810		14419		7452		-		-		-		-		-		-
			9.8	2.36	9.4	2.40	9.0	2.26	8.5	2.07	8.2	1.60	-	-	-	-	-	-	-	-	-	-	-
	245	3720	25970		22768		19496		15357		8861		-		-		-		-		-		-
			10.1	2.51	9.6	2.55	9.2	2.43	8.7	2.23	8.4	1.77	-	-	-	-	-	-	-	-	-	-	-
10	255	3872	27030		23958		20852		17032		11516		-		-		-		-		-		-
			10.6	2.83	10.1	2.89	9.7	2.79	9.2	2.53	8.7	2.17	-	-	-	-	-	-	-	-	-	-	-
	265	4024	28090		25139		22150		18663		14018		7387		-		-		-		-		-
			11.3	3.18	10.8	3.25	10.3	3.15	9.8	2.89	9.2	2.63	9.2	2.10	-	-	-	-	-	-	-	-	-
15	275	4176	29150		26311		23428		20259		16240		10205		-		-		-		-		-
			11.8	3.55	11.3	3.63	10.8	3.54	10.3	3.29	9.8	3.10	9.6	2.52	-	-	-	-	-	-	-	-	-
	295	4479	31270		28630		25940		23184		19758		15358		9427		-		-		-		-
			13.0	4.39	12.4	4.49	11.8	4.40	11.3	4.21	10.9	3.92	10.4	3.60	10.4	2.98	-	-	-	-	-	-	-
20	305	4631	32330		29777		27177		24551		21390		17681		12202		-		-		-		-
			13.6	4.85	13.0	4.96	12.3	4.88	11.7	4.72	11.4	4.40	11.1	4.20	10.9	3.53	-	-	-	-	-	-	-
	320	4859	33920		31488		29011		26541		23780		20452		16042		-		-		-		-
			14.6	5.60	13.8	5.72	13.1	5.66	12.5	5.54	12.1	5.21	11.8	4.98	11.5	4.51	-	-	-	-	-	-	-
25	330	5011	34980		32623		30222		27827		25249		22120		18478		7756		-		-		-
			15.2	6.14	14.4	6.26	13.7	6.22	13.0	6.10	12.6	5.80	12.3	5.49	12.0	5.24	11.9	3.92	-	-	-	-	-
	340	5163	36040		33753		31423		29099		26683		23753		20505		10704		-		-		-
			15.7	6.72	15.0	6.85	14.2	6.82	13.5	6.69	13.0	6.43	12.8	6.09	12.6	5.89	12.4	4.55	-	-	-	-	-
30	350	5315	37100		34879		32620		30360		28052		25357		22313		13496		-		-		-
			16.3	7.33	15.6	7.46	14.8	7.45	14.0	7.33	13.4	7.12	13.3	6.74	13.1	6.51	12.8	5.27	-	-	-	-	-
	365	5542	38690		36561		34400		32230		30063		27653		24807		17395		-		-		-
			17.2	8.31	16.4	8.46	15.5	8.47	14.8	8.35	14.0	8.20	13.8	7.80	13.7	7.46	13.4	6.53	-	-	-	-	-
35	375	5694	39750		37679		35579		33464		31355		29105		26431		19883		10514		-		-
			17.8	9.01	16.9	9.16	16.0	9.20	15.3	9.08	14.5	8.93	14.2	8.58	14.1	8.20	13.8	7.47	13.8	5.95	-	-	-
	385	5846	40810		38793		36752		34669		32636		30501		28031		22210		13344		-		-
			18.4	9.75	17.5	9.91	16.6	9.96	15.7	9.84	15.0	9.69	14.5	9.40	14.4	8.99	14.2	8.44	14.1	6.79	-	-	-
40	410	6226	43460		41568		39661		37716		35789		33860		31769		26747		19931		11292		-
			19.8	11.78	18.9	11.95	17.9	12.06	17.0	11.95	16.1	11.80	15.3	11.63	15.1	11.20	15.1	10.50	15.0	9.34	15.0	7.75	-
	420	6377	44520		42674		40812		38916		37034		33860		31769		26747		19931		11292		-
			20.0	12.66	19.4	12.85	18.5	12.96	17.5	12.86	16.6	12.72	15.7	12.55	15.4	12.18	15.4	11.34	15.4	10.53	15.4	8.74	-
430	6529	45580		43778		41959		40110		38270		36431		34539		30034		24745		16894		-	
		21.0	13.58	20.0	13.78	19.2	13.90	18.3	13.82	17.4	13.68	16.5	13.51	15.9	13.22	15.9	12.32	15.9	11.76	15.9	9.84	-	-
440	6681	46640		44879		43102		41299		39498		37701		35893		31641		26675		19521		-	
		22.0	14.55	21.0	14.75	20.0	14.88	19.1	14.82	18.2	14.68	17.3	14.51	16.5	14.31	16.5	13.35	16.5	12.80	16.5	11.05	-	-

Performance shown is for installation type A: Free Inlet, Free Outlet. Power rating (BHP) does not include drive losses. For further information on estimating belt drive losses and motor service factors see page 11. The sound ratings shown are for loudness values in fan sones at 50' (1.5m) in a hemispherical free field per AMCA Standard 301. Values shown are for installation Type A: free inlet sone levels. Performance ratings do not include the effects of appurtenances in the airstream.

Domex

Engineering Specifications

› Model

DX = Downblast Roof Exhauster
 KB = Downblast Roof Exhauster
 JB = Downblast Roof Exhauster
 MB = Downblast Roof Exhauster

› Unit Size

06	08	10	11	12	14	16
18	24	27	30	36	420	48
542						

› Drive Type

D = Direct Drive
 B = Belt Drive

› Motor Tap

Q = 1725 RPM
 R = 1550 RPM
 S = 1300 RPM
 V = 1050 RPM
 Q1 = 1650 RPM
 Q2 = 1725 RPM

› Motor Speed

1 = Single Speed
 2 = 2S2W Single & Three Phase
 3 = 2S1W Three Phase

› Horse Power

1/100	1/50	1/30	1/25	1/20
1/12	1/11	1/7	1/6	1/5
1/4	1/3	1/2	3/4	1
1 1/2	2	5	5	7 1/2
10	15			

› Enclosure

O = Open Drip Proof
 T = Totally Enclosed
 E = Explosion Proof
 X = Special

› Voltage

A = 110V	G = 230V	N = 440V
B = 115V	H = 240V	P = 460V
C = 120V	J = 277V	Q = 480V
D = 200V	K = 380V	R = 575V
E = 208V	L = 400V	S = 600V
F = 220V	M = 415V	X = Special

› Phase

1 = Single
 3 = Three

› Cycle

5 = 50 Hz
 6 = 60 Hz

› Efficiency

S = Standard
 H = High Efficiency

› Paint / Coating

Sizes 06 - 36

0 = None
 F = Epoxy Powder Coat*
 G = Epoxy Powder Coat with UV*
 H = Hi-Temp Powder Coat*
 J = Non-stick Powder Coat*
 K = Phenolic Powder Coat*
 L = Phenolic Powder Coat with UV*
 N = Polyester Powder Coat
 X = Special
** Not available with choice of color.*

Sizes KB, JB, & MB

0 = None
 B = Epoxy*
 C = Heresite
 D = Heresite with UV*
 Q = Enamel*
 X = Special
** Not available with choice of color.*

› Color

0 = None
 50 = Chrome Green
 53 = Williamsburg Blue
 55 = Pale Green
 56 = Dove Gray
 61 = White
 63 = Oxford Beige
 65 = Dover White
 66 = Desert Tan
 70 = Black
 73 = Smoke Gray
 77 = Brick Red
 79 = Peppercorn
 81 = Pale Brown
 83 = Chocolate Brown
 85 = Timeless Bronze
 94 = Charcoal
 X = Special

› AMCA Spark Rating

0 = None
 C = Standard
 B = Optional

› Damper

0 = None
 BDD = Gravity Backdraft Damper
 MD1 = Gravity Backdraft Damper 115V
 MD2 = Gravity Backdraft Damper 230V
 MD4 = Gravity Backdraft Damper 460V
 ED1 = Explosion Proof Motor
 Operated Damper 115V

› Screen

0 = None
 B = Bird Screen (Standard)
 S = Insect/Bird Screen

› Roof Curb

0 = None	K = UCA18	V = UG18
A = UCG8	L = UG12	W = URA12
B = UCG12	M = SA16	Y = URA18
C = UCG18	N = SFG12	1 = URG12
D = UCA8	P = SFG18	10 = SFA8
E = UCA12	Q = SG16	11 = USCG
F = SFA12	R = SRA16	12 = USCA
G = SFA18	S = SRG16	2 = URG18
H = SCG16	T = UA12	4 = UVA18
J = SCA16	U = UA18	5 = UVG18

› Slope

0 = None
 S = Single
 D = Double

› Metal Liner

0 = None
 L = Metal Liner

› Damper Holding Plate

0 = None
 P = Damper Holding Plate

› Neoprene Gasket

0 = None
 G = Gasket

› No Wooden Nailer

0 = None
 N = No Wooden Nailer

› Curb Paint/Coating

0 = None
 B = Air Dried Epoxy
 Q = Enamel

› Hinged Sub-base

0 = None
 H = Hinged Sub-base

› Mounting Pedestal

0 = None
 P = Mounting Pedestal

› Aluminum Base

0 = None
 A = Aluminum Base

› Thermal Overload Protection

0 = None
 P = Thermal Overload Protection

Continued, next page.

› Disconnect Switch

- 0 = None
- 1 = NEMA 1 Disconnect Switch
- 3R = NEMA 3R Disconnect Switch
- 4 = NEMA 4 Disconnect Switch
- 7 = NEMA 7 Disconnect Switch
- 9 = NEMA 9 Disconnect Switch

› Internal Wiring

- 0 = None
- 1 = NEMA 1 Internal Wiring
- 3R = NEMA 3R Internal Wiring

› Transformer

- 0 = None
- T = Transformer

› Speed Controller

- 0 = None
- L = Loose
- M = Mounted

› Firestat Switch

- 0 = None
- F = Firestat Switch

› Wall Mount

- 0 = None
- W = Wall Mount

› High Pressure Wheel

- 0 = None
- H = High Pressure Wheel

› High Wind Construction

- 0 = None
- M = Miami Dade Approved

› Belt Drive Fans

Belt driven centrifugal roof exhaust fan shall be Domex DX, KB, JB, MB manufactured by PennBarry, Richardson, TX 75081.

The housing shall be weatherproof, utilize heavy gauge spun aluminum construction with a large rolled bead for strength, with galvanized (aluminum optional DX) base, and with rigid galvanized steel internal support structures. Housing shall not provide any of the internal structural support. Units shall be equipped with an oversized electrical conduit chase through the curb cap and into the motor compartment for ease of wiring (except Explosion Proof). Units shall be pre-wired to a junction box mounted in the motor compartment & equipped with an electrical disconnect device (except Explosion Proof).

Statically and dynamically balanced backward inclined, centrifugal wheels shall be aluminum, spark-resistant, non-overloading, and matched to deeply spun venturis. Motors shall be continuous duty, ball bearing design, permanently lubricated, mounted out of the main airstream, and furnished at the specified voltage, phase, and enclosure.

Shafts shall be turned, ground, polished, and rust protected. Heavy duty ball bearings are rated for a minimum L50 life exceeding 200,000 hours. Pulleys shall be adjustable, cast iron, machined, keyed, securely attached, and sized for 150% of the horsepower at its rated maximum speed.

Each fan shall bear the AMCA Licensed Ratings Seal for Air and Sound Performance (DX) or for Air performance (KB, JB, MB), and shall be UL and CSA listed.

› Direct Drive Fans

Direct drive centrifugal roof exhaust fan shall be Domex DX, manufactured by PennBarry, Richardson, TX 75081.

The housing shall be weatherproof, utilize heavy-gauge spun aluminum construction with a large rolled bead for strength, with galvanized (aluminum optional) base, and with rigid galvanized steel internal support structures. Housing shall not provide any of the internal structural support. Units shall be equipped with an oversized electrical conduit chase through the curb cap and into the motor compartment for ease of wiring (except Explosion Proof). Units shall be pre-wired to a junction box mounted in the motor compartment & equipped with an electrical disconnect device (except Explosion Proof).

Statically and dynamically balanced backward inclined, centrifugal wheels shall be aluminum, spark-resistant, non-overloading, and matched to deeply spun venturis. Motors shall be continuous duty, permanently lubricated, multi-speed (for applicable models), have thermal overload protection, mounted out of the main airstream, be easily accessible for service, and furnished at the specified voltage, phase.

Each fan shall bear the AMCA Licensed Ratings Seal for Air and Sound Performance, and shall be UL and CSA listed.

› Product Configuration

Reference PennBarry's selection software to configure a Domex product today.

1-Year Limited Manufacturer Warranty

Centrifugal Fans

› Products Covered

PennBarry Fans and Ventilators (each, a “PennBarry Product”)

› One Year Limited Warranty For PennBarry Products

PennBarry warrants to the original commercial purchaser that the PennBarry Products will be free from defects in material and workmanship for a period of one (1) year from the date of shipment.

› Exclusive Remedy

PennBarry will, at its option, repair or replace (without removal or installation) the affected components of any defective PennBarry Product; repair or replace (without removal or installation) the entire defective PennBarry Product; or refund the invoice price of the PennBarry Product. In all cases, a reasonable time period must be allowed for warranty repairs to be completed.

› What You Must Do

In order to make a claim under these warranties:

- You must be the original commercial purchaser of the PennBarry Product.
- You must promptly notify us, within the warranty period, of any defect and provide us with any substantiation that we may reasonably request.
- The PennBarry Product must have been installed and maintained in accordance with good industry practice and any specific PennBarry recommendations.

› Exclusions

These warranties do not cover defects caused by:

- Improper design or operation of the system into which the PennBarry Product is incorporated.
- Improper installation.
- Accident, abuse or misuse.
- Unreasonable use (including any use for non-commercial purposes, failure to provide reasonable and necessary maintenance as specified by PennBarry, misapplication and operation in excess of stated performance characteristics).
- Components not manufactured by PennBarry.

› Limitations

- In all cases, PennBarry reserves the right to fully satisfy its obligations under the Limited Warranties by refunding the invoice price of the defective PennBarry Product (or, if the PennBarry Product has been discontinued, of the most nearly comparable current product).
- PennBarry reserves the right to furnish a substitute or replacement component or product in the event a PennBarry Product or any component of the product is discontinued or otherwise unavailable.
- PennBarry’s only obligation with respect to components not manufactured by PennBarry shall be to pass through the warranty made by the manufacturer of the defective component.

› General

The foregoing warranties are exclusive and in lieu of all other warranties except that of title, whether written, oral or implied, in fact or in law (including any warranty of merchantability or fitness for a particular purpose).

PennBarry hereby disclaims any liability for special, punitive, indirect, incidental or consequential damages, including without limitation lost profits or revenues, loss of use of equipment, cost of capital, cost of substitute products, facilities or services, downtime, shutdown or slowdown costs.

The remedies of the original commercial purchaser set forth herein are exclusive and the liability of PennBarry with respect to the PennBarry Products, whether in contract, tort, warranty, strict liability or other legal theory shall not exceed the invoice price charged by PennBarry to its customer for the affected PennBarry Product at the time the claim is made.

Inquiries regarding these warranties should be sent to: PennBarry, 1401 North Plano Road, Richardson, TX 75081

Other PennBarry Products

Centrifugal Products



› **Domex**
Centrifugal
Roof Exhausters



› **Fumex Fatrap**
Kitchen Hood Centrifugal
Roof Exhausters



› **Zephyr**
Ceiling and Inline Fans

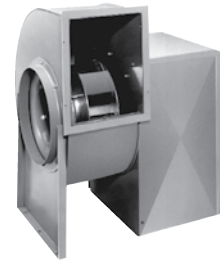

› **Dynamo**
Centrifugal Blowers

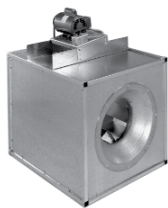

› **Centrex Inliner**
Centrifugal Inline Fan



› **LC Dynafan**
Low Contour Centrifugal
Roof Exhausters



› **ESI**
Efficient Silent
Inline Fan



› **Fume Exhaust**
Curb Mounted
Centrifugal Fans

Axial / Gravity Products

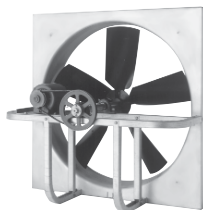

› **Breezeway**
Propeller Wall Fan



› **Hi-Ex**
Power Roof Ventilator

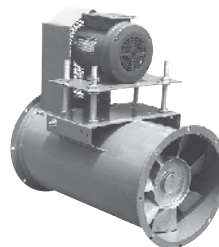

› **Tubeaxial**
Inline Fans



› **Vaneaxial**
Inline Fans

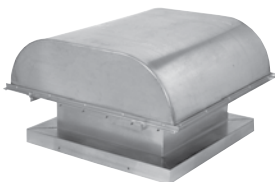

› **Powered Airette**
Axial Roof Ventilators

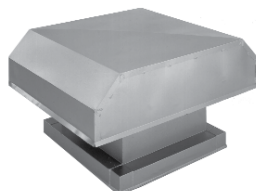

› **Airette**
Gravity Intake/Relief Hood



› **Domex Axial**
Axial Roof Ventilators



› **Axcentrix**
Bifurcator Fan

